



Government Gazette

OF THE STATE OF
NEW SOUTH WALES

Number 33
Friday, 8 March 2013

Published under authority by the Department of Premier and Cabinet

LEGISLATION

Online notification of the making of statutory instruments

Week beginning 25 February 2013

THE following instruments were officially notified on the NSW legislation website (www.legislation.nsw.gov.au) on the dates indicated:

Proclamations commencing Acts

- Environmental Planning and Assessment Amendment Act 2012 No 93 (2013-78) — published LW 1 March 2013
- Firearms Amendment (Ammunition Control) Act 2012 No 34 (2013-70) — published LW 1 March 2013
- Water Management Amendment Act 2010 No 133 (2013-71) — published LW 1 March 2013

Regulations and other statutory instruments

- Building Professionals Amendment Regulation 2013 (2013-80) — published LW 1 March 2013
- Children and Young Persons (Care and Protection) Amendment (Code of Conduct) Regulation 2013 (2013-72) — published LW 1 March 2013
- Environmental Planning and Assessment Amendment Regulation 2013 (2013-79) — published LW 1 March 2013
- Firearms Amendment (Ammunition and Club Armourers) Regulation 2013 (2013-73) — published LW 1 March 2013
- Industrial Relations (General) Amendment (Registration) Regulation 2013 (2013-69) — published LW 27 February 2013
- Mining Amendment (Minimum Security Deposits) Regulation 2013 (2013-74) — published LW 1 March 2013
- Order regarding volunteers taking part in emergency operations (2013-83) — published LW 1 March 2013
- Racing Administration Amendment (Fees) Regulation 2013 (2013-75) — published LW 1 March 2013
- Revocation of Order under the State Emergency and Rescue Management Act 1989 (2013-81) — published LW 1 March 2013
- Revocation of Order under the State Emergency and Rescue Management Act 1989 (2013-82) — published LW 1 March 2013

Environmental Planning Instruments

- Great Lakes Local Environmental Plan 1996 (Amendment No 82) (2013-77) — published LW 1 March 2013
- State Environmental Planning Policy Amendment (Minmi–Newcastle Link Road) 2013 (2013-76) — published LW 1 March 2013

Assents to Acts

ACT OF PARLIAMENT ASSENTED TO

Legislative Assembly Office, Sydney 28 February 2013

IT is hereby notified, for general information, that Her Excellency the Governor has, in the name and on behalf of Her Majesty, this day assented to the undermentioned Act passed by the Legislative Assembly and Legislative Council of New South Wales in Parliament assembled, viz.:

Act No. 1 – An Act to make miscellaneous amendments to certain legislation with respect to courts and juries, civil and criminal procedure, the exchange of information by certain government agencies and the enforcement of fines and to effect minor statute law revision; and to repeal the Inebriates Act 1912. [**Courts and Other Legislation Further Amendment Bill**]

Legislative Assembly Office, Sydney 4 March 2013

IT is hereby notified, for general information, that Her Excellency the Governor has, in the name and on behalf of Her Majesty, this day assented to the undermentioned Acts passed by the Legislative Assembly and Legislative Council of New South Wales in Parliament assembled, viz.:

Act No. 2 – An Act to establish the Civil and Administrative Tribunal of New South Wales and to provide for its membership and functions. [**Civil and Administrative Tribunal Bill**]

Act No. 3 – An Act to amend the Property, Stock and Business Agents Act 2002 to make further provision with respect to agency agreements, trust accounts, unclaimed trust money and stock auctions; and for other purposes. [**Property, Stock and Business Agents Amendment Bill**]

RONDA MILLER,
Clerk of the Legislative Assembly

OFFICIAL NOTICES

Appointments

SYDNEY OLYMPIC PARK AUTHORITY ACT 2001

Education and Communities NSW

Appointment of Member to the Board of the Sydney
Olympic Park Authority.

I, GRAHAM ANNESLEY, M.P., Minister for Sport and Recreation, in pursuance of section 61 of the Sydney Olympic Park Authority Act 2001, have re-appointed the following person to the office of Chair of the Board of the Sydney Olympic Park Authority for a term of office commencing on 1 July 2013 and terminating on 30 June 2016:

Mr Michael KNIGHT, A.O.

GRAHAM ANNESLEY, M.P.,
Minister for Sport and Recreation

Department of Planning

ENVIRONMENTAL PLANNING AND ASSESSMENT ACT 1979

Instrument of Delegation

I, the Minister for Planning and Infrastructure, pursuant to section 23 of the Environmental Planning and Assessment Act 1979 (the Act) delegate:

1. the functions identified in Column 2 of Schedule 1, subject to the specified limitations (and all other functions under the Act and any other Act as are incidental or related to the exercise of those functions) to the staff holding the positions in the Department of Planning and Infrastructure referred to in Column 3 of Schedule 1; and
2. the powers and functions listed in Column 2 of Schedule 2 to this Instrument (and any functions under the Act or any other Act as are incidental or related to the exercise of those functions), in relation to applications and requests specified in Column 3 of Schedule 2 to this Instrument, to the persons holding the positions listed in Column 4 of Schedule 2 to this Instrument.

The terms and expressions used in Schedules 1 and 2 of this Instrument of Delegation have the meanings set out in the definitions in Schedule 3 of this Instrument of Delegation.

This delegation is in addition to, and is not intended to revoke or affect, the delegation of my functions by the Instrument of Delegation published in the *New South Wales Government Gazette* on 28 September 2011 or 27 July 2012.

Dated: 27 February 2013.

The Hon. BRAD HAZZARD, M.P.,
Minister for Planning and Infrastructure

SCHEDULE 1

Delegation to Staff of the Department of Planning and Infrastructure (DP&I)

<i>Column 1 Item</i>	<i>Column 2 Function</i>	<i>Column 3 Delegate</i>
Functions under the Environmental Planning and Assessment Act 1979		
1.	Amending or revoking the declaration of a project under section 75B of the Act.	(a) Deputy Director-General Planning Operations and Regional Delivery; (b) Deputy Director-General Planning Strategies, Housing and Infrastructure; and (c) Executive Director, Development Assessment Systems and Approvals
2.	Approving or disapproving the carrying out of a project under section 75J of the Act. This delegation applies only to applications where: (a) the relevant local council has not made an objection, and (b) a political disclosure statement has not been made, and (c) there are less than 25 public submissions in the nature of objections.	(a) Deputy Director-General Planning Operations and Regional Delivery; (b) Deputy Director-General Planning Strategies, Housing and Infrastructure; and (c) Executive Director, Development Assessment Systems and Approvals
3.	Giving or refusing to give approval for a concept plan for a project under section 75O of the Act. This delegation applies only to applications (including single applications under section 75M (3A)) where: (a) the project the subject of the application is consistent (in the opinion of the delegate) with the Metropolitan Plan for Sydney or a relevant Regional Strategy or Sub-Regional Strategy prepared by the DP&I and endorsed by the Minister, and (b) the relevant local council has not made an objection, and	(a) Deputy Director-General Planning Operations and Regional Delivery; (b) Deputy Director-General Planning Strategies, Housing and Infrastructure; and (c) Executive Director, Development Assessment Systems and Approvals

<i>Column 1 Item</i>	<i>Column 2 Function</i>	<i>Column 3 Delegate</i>
3. (cont'd)	(c) a political disclosure statement has not been made, and (d) there are less than 25 public submissions in the nature of objections.	
4.	My functions under section 75P of the Act. <i>Note.</i> These functions are only exercisable if approval is given for a concept plan for a project under section 75O.	(a) Deputy Director-General Planning Operations and Regional Delivery; (b) Deputy Director-General Planning Strategies, Housing and Infrastructure; and (c) Executive Director, Development Assessment Systems and Approvals
5.	Determining a modification request under section 75W of the Act. This delegation applies only to modification requests where: (a) the relevant local council has not made an objection, and (b) a political disclosure statement has not been made, and (c) there are less than 25 public submissions in the nature of objections.	(a) Deputy Director-General Planning Operations and Regional Delivery; (b) Deputy Director-General Planning Strategies, Housing and Infrastructure; and (c) Executive Director, Development Assessment Systems and Approvals
6.	Determining development applications under section 80 of the Act. This delegation applies only to applications where: (a) the relevant local council has not made an objection, and (b) a political disclosure statement has not been made, and (c) there are less than 25 public submissions in the nature of objections.	(a) Deputy Director-General Planning Operations and Regional Delivery; (b) Deputy Director-General Planning Strategies, Housing and Infrastructure; and (c) Executive Director, Development Assessment Systems and Approvals
7.	My functions under section 89D of the Act. <i>Note.</i> These functions are only exercisable where a staged development application is made in respect of State significant development.	(a) Deputy Director-General Planning Operations and Regional Delivery; (b) Deputy Director-General Planning Strategies, Housing and Infrastructure; and (c) Executive Director, Development Assessment Systems and Approvals
8.	Determining development applications for State significant development under section 89E of the Act. This delegation applies only to applications where: (a) the relevant local council has not made an objection, and (b) a political disclosure statement has not been made, and (c) there are less than 25 public submissions in the nature of objections.	(a) Deputy Director-General Planning Operations and Regional Delivery; (b) Deputy Director-General Planning Strategies, Housing and Infrastructure; and (c) Executive Director, Development Assessment Systems and Approvals
9.	Determining applications to extend the lapsing period of development consents under section 95A of the Act.	(a) Deputy Director-General Planning Operations and Regional Delivery; (b) Deputy Director-General Planning Strategies, Housing and Infrastructure; and (c) Executive Director, Development Assessment Systems and Approvals

<i>Column 1 Item</i>	<i>Column 2 Function</i>	<i>Column 3 Delegate</i>
10.	Determining modification applications under sections 96 and 96AA of the Act. This delegation applies only to applications where: (a) the relevant local council has not made an objection, and (b) a political disclosure statement has not been made, and (c) there are less than 25 public submissions in the nature of objections.	(a) Deputy Director-General Planning Operations and Regional Delivery; (b) Deputy Director-General Planning Strategies, Housing and Infrastructure; and (c) Executive Director, Development Assessment Systems and Approvals
11.	My functions as a certifying authority under Part 4A of the Act.	(a) Deputy Director-General Planning Operations and Regional Delivery; (b) Deputy Director-General Planning Strategies, Housing and Infrastructure; and (c) Executive Director, Development Assessment Systems and Approvals
12.	Approving or disapproving the carrying out of State significant infrastructure under section 115ZA of the Act. This delegation applies only to applications where: (a) the relevant local council has not made an objection, and (b) a political disclosure statement has not been made, and (c) there are less than 25 public submissions in the nature of objections.	(a) Deputy Director-General Planning Operations and Regional Delivery; (b) Deputy Director-General Planning Strategies, Housing and Infrastructure; and (c) Executive Director, Development Assessment Systems and Approvals
13.	Determining a modification request under section 115ZI of the Act. This delegation applies only to modification requests where: (a) the relevant local council has not made an objection, and (b) a political disclosure statement has not been made, and (c) there are less than 25 public submissions in the nature of objections.	(a) Deputy Director-General Planning Operations and Regional Delivery; (b) Deputy Director-General Planning Strategies, Housing and Infrastructure; and (c) Executive Director, Development Assessment Systems and Approvals
14.	My functions under Divisions 2A, 2B and 2C of Part 6 of the Act.	(a) Deputy Director-General Planning Operations and Regional Delivery; (b) Deputy Director-General Planning Strategies, Housing and Infrastructure; and (c) Executive Director, Development Assessment Systems and Approvals
Functions under the Environmental Planning and Assessment Regulation 2000		
15.	Determining whether to reject applications under clause 8D of the Regulation.	(a) Deputy Director-General Planning Operations and Regional Delivery; (b) Deputy Director-General Planning Strategies, Housing and Infrastructure; and (c) Executive Director, Development Assessment Systems and Approvals

<i>Column 1 Item</i>	<i>Column 2 Function</i>	<i>Column 3 Delegate</i>
16.	Determining whether to direct that an application be determined as if the amendments made by Schedule 1 to the Environmental Planning and Assessment (Infrastructure and Other Planning Reform) Act 2005 had not been made under clauses 8J (4A) or 8J (5) of the Regulation.	(a) Deputy Director-General Planning Operations and Regional Delivery; (b) Deputy Director-General Planning Strategies, Housing and Infrastructure; and (c) Executive Director, Development Assessment Systems and Approvals
17.	Forming an opinion that development was State significant development under clause 8J (7) of the Regulation. Note. The reference to State significant development refers to the meaning that term had before the commencement of Part 3A and not to its current meaning in the Act.	(a) Deputy Director-General Planning Operations and Regional Delivery; (b) Deputy Director-General Planning Strategies, Housing and Infrastructure; and (c) Executive Director, Development Assessment Systems and Approvals
18.	Determining whether to approve a development consent being treated as a Part 3A approval for the purposes of section 75W of the Act under clause 8J (8) of the Regulation.	(a) Deputy Director-General Planning Operations and Regional Delivery; (b) Deputy Director-General Planning Strategies, Housing and Infrastructure; and (c) Executive Director, Development Assessment Systems and Approvals
19.	My functions under clause 8M (2) of the Regulation. This delegation only extends to matters where the delegate exercising these functions has (as delegate) revoked the declaration of a project under Part 3A.	(a) Deputy Director-General Planning Operations and Regional Delivery; (b) Deputy Director-General Planning Strategies, Housing and Infrastructure; and (c) Executive Director, Development Assessment Systems and Approvals
20.	My functions as either a planning authority, consent authority or certifying authority under the following Parts or Schedules of the Regulation: (a) Part 4, (b) Part 6, (c) Part 8, (d) Part 9, (e) Part 15, and (f) Schedule 3. <i>Note 1.</i> These functions relate to development contributions including the giving of public notice of proposed planning agreements, procedures for development applications, certification of development, fire safety matters and fees. <i>Note 2.</i> Some of the functions relate to Part 3A of the Act (see section 75R (4) of the Act).	(a) Deputy Director-General Planning Operations and Regional Delivery; (b) Deputy Director-General Planning Strategies, Housing and Infrastructure; and (c) Executive Director, Development Assessment Systems and Approvals
Functions under Sydney Regional Environmental Plan No. 26 – City West		
21.	My functions as consent authority in relation to urban development plans and master plans under the following clauses in Sydney Regional Environmental Plan No. 26 – City West: (a) clause 38, (b) clause 40, and (c) clause 44.	(a) Deputy Director-General Planning Operations and Regional Delivery; (b) Deputy Director-General Planning Strategies, Housing and Infrastructure; and (c) Executive Director, Development Assessment Systems and Approvals

<i>Column 1 Item</i>	<i>Column 2 Function</i>	<i>Column 3 Delegate</i>
Functions under Sydney Local Environmental Plan 2005		
22.	My functions as consent authority in relation to master plans under the following clauses in Sydney Local Environmental Plan 2005: (a) clause 106, and (b) clause 110.	(a) Deputy Director-General Planning Operations and Regional Delivery; (b) Deputy Director-General Planning Strategies, Housing and Infrastructure; and (c) Executive Director, Development Assessment Systems and Approvals

SCHEDULE 2

<i>Column 1</i>	<i>Column 2</i>	<i>Column 3</i>	<i>Column 4</i>
1.	Approving or disapproving the carrying out of a project application under section 75J of the Act (as continued in force by Schedule 6A to the Act). This delegation applies only to project applications where: (a) a political disclosure statement has not been made, and (b) there are less than 25 public submissions in the nature of objections, and (c) the delegate, being a person in a position listed in column 4 of this item, forms the opinion that the project application if approved would be generally consistent with the approved Barangaroo Concept Plan (MP 06_0162) current at the time of determination, and (d) the delegate, being a person listed in column 4 of this item, forms the opinion that any submission made about the application by the Council of the City of Sydney has been considered in the assessment of the application.	Any application for approval of a project lodged before or after the date of this Instrument under Part 3A of the Act to carry out development on any land identified as the "Barangaroo Site" in State Environmental Planning Policy (Major Development) 2005 at the time the delegation is exercised.	Executive Director, Development Assessment Systems and Approvals
2.	Determining a modification request under section 75W of the Act (as continued in force by Schedule 6A to the Act). This delegation applies only to modification requests where: (a) a political disclosure statement has not been made, and (b) there are less than 25 public submissions in the nature of objections, and (c) the delegate, being a person in a position listed in column 4 of this item, forms the opinion that the approval if modified would be generally consistent with the approved Barangaroo Concept Plan (MP 06_0162) current at the time of determination, and (d) the delegate, being a person listed in column 4 of this item, forms the opinion that any submission made about the request by the Council of the City of Sydney has been considered in the assessment of the request.	Any request lodged before or after the date of this Instrument under section 75W of the Act for the Minister to modify an approval granted under section 75J of the Act to carry out development on any land identified as the "Barangaroo Site" in State Environmental Planning Policy (Major Development) 2005 at the time the delegation is exercised.	Executive Director, Development Assessment Systems and Approvals

Column 1	Column 2	Column 3	Column 4
3	<p>Determining development applications under section 80 of the Act.</p> <p>This delegation applies only to development applications where:</p> <p>(a) a political disclosure statement has not been made, and</p> <p>(b) there are less than 25 public submissions in the nature of objections, and</p> <p>(c) the delegate, being a person in a position listed in column 4 of this item, forms the opinion that the development application if approved would be generally consistent with the approved Barangaroo Concept Plan (MP 06_0162) current at the time of determination, and</p> <p>(d) the delegate, being a person listed in column 4 of this item, forms the opinion that any submission made about the application by the Council of the City of Sydney has been considered in the assessment of the application.</p>	<p>Any development application lodged before or after the date of this Instrument under Part 4 of the Act for development on any land identified as the "Barangaroo Site" in State Environmental Planning Policy (Major Development) 2005 at the time the delegation is exercised.</p>	<p>Executive Director, Development Assessment Systems and Approvals</p>
4	<p>Determining modification applications under section 96 and 96AA of the Act.</p> <p>This delegation applies only to modification applications where:</p> <p>(a) a political disclosure statement has not been made, and</p> <p>(b) there are less than 25 public submissions in the nature of objections, and</p> <p>(c) the delegate, being a person in a position listed in column 4 of this item, forms the opinion that the development consent if modified would be generally consistent with the approved Barangaroo Concept Plan (MP 06_0162) current at the time of determination, and</p> <p>(d) the delegate, being a person listed in column 4 of this item, forms the opinion that any submission made about the application by the Council of the City of Sydney has been considered in the assessment of the application.</p>		<p>Executive Director, Development Assessment Systems and Approvals</p>

SCHEDULE 3

Definitions:

In Schedule 1 and Schedule 2

Objection means a submission in the nature of an objection, and does not include draft conditions requested to be imposed by the relevant local council on the consent or approval.

Political disclosure statement means a statement required to be made under section 147 of the Act, and includes a statement made in respect of a previous related application.

Previous related application means:

In respect of Part 4 of the Act

- the application for consent to any previous stage of a staged development application within the meaning of section 83B of the Act; and
- for modification applications, the application for development consent the subject of the modification application or a previous modification application to modify that consent.

In respect of Part 5.1 of the Act

- the application for approval of any previous stage of a staged infrastructure application within the meaning of section 115ZD of the Act; and
- for requests to modify an approval, the application for approval of State significant infrastructure the subject of the modification request or a previous modification request to modify that approval.

In respect of Part 3A of the Act

- the application for approval to carry out a part project for which an application for approval to carry out another part of the project is made under section 75E of the Act;
- for applications to carry out a project (or part project), the application for approval of the concept plan for the project; and
- for requests to modify an approval to carry out a project (or part project) or an approval of a concept plan, any previous application or request made under Part 3A of the Act in respect of the relevant project.

Public submissions refers to submissions received from the general public during the statutory exhibition process of applications, and does not include any submissions received from public authorities.

Note: A petition or a single submission that is signed by multiple parties is taken to be one submission for the purposes of Schedules 1 and 2.

ENVIRONMENTAL PLANNING AND ASSESSMENT ACT 1979

Instrument of Delegation

I, the Director-General of the Department of Planning and Infrastructure, under section 23 of the Environmental Planning and Assessment Act 1979 (the Act) delegate the functions identified in Column 2 of Schedule 1 (and all other functions under the Act, the Environmental Planning and Assessment Regulation 2000 and environmental planning instruments as are incidental or related to the exercise of those functions) to the staff of the Department identified in Column 3 of Schedule 1.

This delegation is in addition to, and is not intended to revoke or affect, the delegation of my functions by the Instrument of Delegation published in the *New South Wales Government Gazette* on 28 September 2011.

Dated: 22 February 2013.

SAM HADDAD,

Director-General, Department of Planning and Infrastructure

SCHEDULE 1

<i>Item</i>	<i>Function</i>	<i>Delegate</i>
Environmental Planning and Assessment Act 1979		
1.	My functions under Part 3A, Part 4 and Part 5.1 of the Act.	(a) Deputy Director-General Planning Operations and Regional Delivery; (b) Deputy Director-General Planning Strategies, Housing and Infrastructure; and (c) Executive Director, Development Assessment Systems and Approvals
Environmental Planning and Assessment Regulation 2000		
1.	My functions under the following Parts or Schedules of the Regulation: (a) Part 1A, (b) Part 4, (c) Part 6, (d) Part 10, (e) Part 15 (other than my functions under clause 262B), and (f) Schedule 2.	(a) Deputy Director-General Planning Operations and Regional Delivery; (b) Deputy Director-General Planning Strategies, Housing and Infrastructure; and (c) Executive Director, Development Assessment Systems and Approvals
2.	My functions under clause 164A of the Regulation.	(a) Deputy Director-General Planning Operations and Regional Delivery; (b) Deputy Director-General Planning Strategies, Housing and Infrastructure; and (c) Executive Director, Development Assessment Systems and Approvals

<i>Item</i>	<i>Function</i>	<i>Delegate</i>
State Environmental Planning Policy (State and Regional Development) 2011 (State and Regional Development SEPP)		
3.	My functions under the following clauses of the State and Regional Development SEPP: (a) Clause 8 (2); and (b) Clause 14 (2).	(a) Deputy Director-General Planning Operations and Regional Delivery; (b) Deputy Director-General Planning Strategies, Housing and Infrastructure; and (c) Executive Director, Development Assessment Systems and Approvals
State Environmental Planning Policy (Major Development) 2005 (Major Development SEPP)		
4.	My functions under Schedule 3 of the Major Development SEPP, other than my function of certifying that satisfactory arrangements have been made for the provision of designated State public infrastructure.	(a) Deputy Director-General Planning Operations and Regional Delivery; (b) Deputy Director-General Planning Strategies, Housing and Infrastructure; and (c) Executive Director, Development Assessment Systems and Approvals
5.	My functions under clause 14 of Part 10 of Schedule 3 of the Major Development SEPP.	(a) Deputy Director-General Planning Strategies, Housing and Infrastructure; and (b) Executive Director, Development Assessment Systems and Approvals
Miscellaneous		
6.	My functions under the following: (a) conditions of a project approval under section 75J (4) and 75W of the Act, (b) terms of a concept plan approved under section 75O of the Act or a modification of a concept plan under section 75W of the Act, (c) conditions of consent under Part 4 of the Act, and (d) conditions of an approval for State significant infrastructure under sections 115ZB and 115ZI of the Act	(a) Deputy Director-General Planning Operations and Regional Delivery; (b) Deputy Director-General Planning Strategies, Housing and Infrastructure; and (c) Executive Director, Development Assessment Systems and Approvals

ENVIRONMENTAL PLANNING AND ASSESSMENT ACT 1979

Instrument of Delegation

I, Bradley Hazzard, Minister for Planning and Infrastructure, under section 23 of the Environmental Planning and Assessment Act 1979 (Planning Act) hereby delegate my functions referred to in the Table to this Instrument of Delegation to the officers of the Department of Planning and Infrastructure for the time being holding the positions described in the Table to this Instrument of Delegation.

This delegation is in addition to, and is not intended to revoke or affect, the delegation of my functions by any current Instrument of Delegation.

Dated: 27 February 2013.

BRADLEY HAZZARD, M.P.,
Minister for Planning and Infrastructure

TABLE

<i>Item</i>	<i>Functions under the Environmental Planning and Assessment Act 1979 (Planning Act)</i>	<i>Delegate</i>
1	Making a determination, under section 56 (2) of the Planning Act.	<ul style="list-style-type: none"> • Director-General • Deputy Directors-General • Executive Director with principal responsibility for plan making

<i>Item</i>	<i>Functions under the Environmental Planning and Assessment Act 1979 (Planning Act)</i>	<i>Delegate</i>
2	<p>Arranging for the review of a planning proposal (or part of a planning proposal) to be conducted by, or with the assistance of, the Planning Assessment Commission or a joint regional planning panel:</p> <ul style="list-style-type: none"> • if there has been any delay in the matter being finalised, or • if for any other reason the delegate considers it appropriate to do so, <p>under section 56 (5) of the Planning Act.</p>	<ul style="list-style-type: none"> • Director-General • Deputy Directors-General • Executive Director with principal responsibility for plan making
3	<p>Altering a determination made under section 56 (2), under section 56 (7) of the Planning Act.</p>	<ul style="list-style-type: none"> • Director-General • Deputy Directors-General • Executive Director with principal responsibility for plan making
4	<p>Determining that a planning proposal not proceed, at the request of the relevant planning authority, under section 58 (4) of the Planning Act.</p>	<ul style="list-style-type: none"> • Director-General • Deputy Directors-General • Executive Director with principal responsibility for plan making
5	<p>Following the completion of community consultation</p> <p>(a) making a local environmental plan (with or without variation of the proposals submitted by the relevant planning authority) in the terms the delegate considers appropriate or</p> <p>(b) deciding not to make the proposed local environmental plan, under section 59 (2) of the Planning Act.</p> <p><i>Note:</i> Only the Director-General should exercise the functions under section 59 (2) of the Planning Act in relation to a standard instrument comprehensive local environmental plan.</p>	<ul style="list-style-type: none"> • Director-General • Deputy Directors-General • Executive Director with principal responsibility for plan making
6	<p>Deferring the inclusion of a matter in a local environmental plan, under section 59 (3) of the Planning Act.</p>	<ul style="list-style-type: none"> • Director-General • Deputy Directors-General • Executive Director with principal responsibility for plan making
7	<p>Specifying which procedures under Division 4 of Part 3 of the Planning Act the relevant planning authority must comply with before the matter is reconsidered by the Minister, under section 59 (4) of the Planning Act.</p>	<ul style="list-style-type: none"> • Director-General • Deputy Directors-General • Executive Director with principal responsibility for plan making
8	<p>Forming the opinion that a matter does not warrant compliance with the conditions precedent for the making of the instrument because it will not have any significant adverse impact on the environment or adjoining land, under section 73A (1) (c) of the Planning Act.</p>	<ul style="list-style-type: none"> • Director-General • Deputy Directors-General • Executive Director with principal responsibility for plan making
9	<ul style="list-style-type: none"> • Forming the opinion that an environmental planning instrument was in the course of preparation before the commencement of clause 122 of Schedule 6 to the Planning Act; and • dispensing with any conditions precedent to the making of an environmental planning instrument under Division 4 of Part 3 of the Planning Act, <p>under clause 122 (2) of Schedule 6 to the Planning Act</p>	<ul style="list-style-type: none"> • Director-General • Deputy Directors-General • Executive Director with principal responsibility for plan making

Roads and Maritime Services

ROAD TRANSPORT (GENERAL) ACT 2005

Notice under Clause 20 of the Road Transport (Mass, Loading and Access) Regulation 2005

ALBURY CITY COUNCIL, in pursuance of Division 4 of Part 2 of the Road Transport (Mass, Loading, Access) Regulation 2005, by this Notice, specify the routes and areas on or in which 25 metre B-Doubles may be used subject to any requirements or conditions set out in the Schedule.

Dated: 13 February 2013.

MICHAEL KEYS,
Acting General Manager,
Albury City Council
(by delegation from the Minister for Roads)

SCHEDULE

1. Citation

This Notice may be cited Albury City Council 25 Metre B-Double Route Notice No. 01/2013.

2. Commencement

This Notice takes effect on the date of gazettal.

3. Effect

This Notice remains in force until 1 September 2015, unless it is amended or repealed earlier.

4. Application

This Notice applies to those 25 metre B-Double vehicles which comply with Schedule 1 of the Road Transport (Mass, Loading and Access) Regulation 2010 and Schedule 2 of the Road Transport (Vehicle Registration) Regulation 2007.

5. Routes

<i>Type</i>	<i>Road Name</i>	<i>Starting Point</i>	<i>Finishing Point</i>	<i>Conditions</i>
25m.	Gerogery Road.	Hub Road.	Albury City Council/Greater Hume Shire Council LGA Boundary.	Permanent Gazettal for incident management use in one direction only during an emergency.

ROAD TRANSPORT (GENERAL) ACT 2005

Notice under the Road Transport (Mass, Loading and Access) Regulation 2005

CAMDEN COUNCIL, pursuant to Clause 20 of the Road Transport (Mass, Loading and Access) Regulation 2005, hereby amend the Class 2 B-Double Notice 2010, as published in the *NSW Government Gazette* No. 108 on 27 August 2010 at pages 4033 to 4284, as set out in the Schedule of this Notice.

NICOLE MAGURREN,
Acting General Manager,
Camden Council
(by delegation from the Minister for Roads)

SCHEDULE

1. Citation

This Notice may be cited as the Camden Council B-Double (Amendment) Notice No. 1/2012.

2. Commencement

This Notice takes effect on and from the date of publication in the *NSW Government Gazette*.

3. Effect

This Notice remains in force up to and including 7 April 2013 unless it is repealed earlier.

4. Amendment

Insert the following routes for the council into the table at Appendix 1

<i>Type</i>	<i>Road No.</i>	<i>Road Name</i>	<i>Starting Point</i>	<i>Finishing Point</i>	<i>Conditions</i>
25m		Dwyer Road	Camden Valley Way (MR620), Leppington	Hulls Road, Leppington	Left turn only into Camden Valley Way No access between 6:00am to 10:30pm and 1:30pm to 5:00pm
25m		Hulls Road	Dwyer Road, Leppington	George Road, Leppington	No access between 6:00am to 10:30pm and 1:30pm to 5:00pm

ROAD TRANSPORT (GENERAL) ACT 2005

Notice under the Road Transport (Mass, Loading and Access) Regulation 2005

LIVERPOOL CITY COUNCIL, pursuant to Clause 20 of the Road Transport (Mass, Loading and Access) Regulation 2005, hereby amend the Class 2 B-Double Notice 2010, as published in the *New South Wales Government Gazette* No. 108 on 27 August 2010, at pages 4033 to 4284, as set out in the Schedule of this Notice.

FAROOQ PORTELLI,
General Manager,
Liverpool City Council
(by delegation from the Minister for Roads)

SCHEDULE
1. Citation

This Notice may be cited as the Liverpool City Council B-Double (Amendment) Notice No. 11/2012.

2. Commencement

This Notice takes effect on and from the date of publication in the *New South Wales Government Gazette*.

3. Effect

This Notice remains in force up to and including 1 September 2015, unless it is repealed earlier.

4. Amendment

Insert the following routes for the council into the table at Appendix 1.

<i>Type</i>	<i>Road Name</i>	<i>Starting Point</i>	<i>Finishing Point</i>
25.	Airfield Drive.	MR648 Cowpasture Road, Cecil Hills.	Aviation Road.
25.	Aviation Road.	Airfield Drive, Cecil Hills.	Blackbird Close.
	Blackbird Close.	Aviation Road, Cecil Hills.	End of Blackbird Close.

ROAD TRANSPORT (GENERAL) ACT 2005

Notice under the Road Transport (Mass, Loading and Access) Regulation 2005

I, Peter Duncan, Chief Executive Roads and Maritime Services, pursuant to Clause 25 of the Road Transport (Mass, Loading and Access) Regulation 2005, hereby amend the 4.6 Metre High Vehicle Notice 2013, as published in *NSW Government Gazette* No. 130 on 21 December 2012 at pages 5109 to 5206, as set out in the Schedule of this Notice.

PETER DUNCAN,
Chief Executive,
Roads and Maritime Services

SCHEDULE

1. Citation

This Notice is the Roads and Maritime Services 4.6 Metre High Vehicle (Amendment) Notice No. 2/2013.

2. Commencement

This Notice takes effect on and from the date of publication in the *NSW Government Gazette*.

3. Effect

This Notice remains in force up to and including 31 December 2017 unless it is repealed earlier.

4. Amendment

Insert the following route into the table at Appendix 1, under the heading Sydney Region.

<i>Type</i>	<i>Road No.</i>	<i>Road Name</i>	<i>Starting Point</i>	<i>Finishing Point</i>	<i>Condition</i>
4.6m	MR154	The Old Northern Road	Camden Valley Way (MR178), Narellan	The Northern Road (MR154), Narellan	
4.6m	MR178	Camden Valley Way	The Northern Road (MR154), Narellan	The Old Northern Road (MR154), Narellan	

ROAD TRANSPORT (SAFETY AND TRAFFIC MANAGEMENT) ACT 1999 – ORDER

Thomas Frederick Bathurst, Lieutenant-Governor.

I, the Honourable Thomas Frederick Bathurst, Lieutenant-Governor of the State of New South Wales, with the advice of the Executive Council, and in pursuance of the Road Transport (Safety and Traffic Management) Act 1999 (the Act), (including section 57C, Approval of devices for multiple detection functions) do, by this Order, approve the following type of multiple detection device described hereunder as a:

speed measuring device, designed to perform the detection functions referred to in section 44 of the Act;

camera recording device, designed to perform the detection functions referred to in section 45 (1) of the Act, and which is capable of recording images in the form of digitalised, electronic or computer generated images, in accordance with the terms of section 45 (2) of the Act;

camera detection device, designed to perform the detection functions referred in section 56 of the Act; and

traffic lane camera device, designed to photograph a vehicle driven in a traffic lane in accordance with section 57A of the Act.

Type of device:

The multiple detection device, **Redflex SR 102**.

Signed and sealed at Sydney, this 27th day of February 2013.

By His Excellency's Command,

DUNCAN GAY, M.L.C.,
Minister for Roads and Ports

Explanatory Note

ROAD TRANSPORT (SAFETY AND TRAFFIC MANAGEMENT) ACT 1999 – ORDER

Section 57C of the Road Transport (Safety and Traffic Management) Act 1999 provides that a device may be approved for use as an approved device for the purpose of 2 or more device approval provisions, by order of the Governor and published in the *New South Wales Government Gazette*.

The attached order approves the Redflex SR 102 for the purpose of multiple detection functions.

Department of Trade and Investment, Regional Infrastructure and Services

COAL MINE HEALTH AND SAFETY ACT 2002

Instrument of Appointment

I, BRAD MULLARD, Executive Director, Mineral Resources, Department of Trade and Investment, Regional Infrastructure and Services, pursuant to section 145 (1) (b) of the Coal Mine Health and Safety Act 2002, hereby appoint Gregory Lee EATON as an Inspector.

Dated this 22nd day of February 2013.

BRAD MULLARD,
Executive Director,
Mineral Resources,
Department of Trade and Investment, Regional
Infrastructure and Services
(under subdelegation from Director-General
of authority delegated by
Minister for Resources and Energy)

(T13-1034)

No. 4773, FORCE RESOURCES PTY LIMITED (ACN 154 507 310), area of 55 units, for Group 1, dated 4 March 2013. (Cobar Mining Division).

(T13-1035)

No. 4774, Lincoln McCLATCHIE, area of 4 units, for Group 1, dated 4 March 2013. (Sydney Mining Division).

(T13-1036)

No. 4775, OCHRE RESOURCES PTY LTD (ACN 112 833 351), area of 19 units, for Group 1, dated 5 March 2013. (Wagga Wagga Mining Division).

(T13-1037)

No. 4776, OCHRE RESOURCES PTY LTD (ACN 112 833 351), area of 10 units, for Group 1, dated 5 March 2013. (Wagga Wagga Mining Division).

The Hon. CHRIS HARTCHER, M.P.,
Minister for Resources and Energy

MINE HEALTH AND SAFETY ACT 2004

Instrument of Appointment

I, BRAD MULLARD, Executive Director, Mineral Resources, Department of Trade and Investment, Regional Infrastructure and Services, pursuant to section 127 (1) (b) of the Mine Health and Safety Act 2004, hereby appoint Robert Ian MALLINSON as an Inspector.

Dated this 22nd day of February 2013.

BRAD MULLARD,
Executive Director,
Mineral Resources,
Department of Trade and Investment, Regional
Infrastructure and Services
(under subdelegation from Director-General
of authority delegated by
Minister for Resources and Energy)

NOTICE is given that the following applications have been granted:

EXPLORATION LICENCE APPLICATIONS

(T12-1069)

No. 4522, now Exploration Licence No. 8060, PEAK GOLD MINES PTY LTD (ACN 001 533 777), County of Mouramba, Map Sheet (8133, 8134), area of 36 units, for Group 1, dated 20 February 2013, for a term until 20 February 2015.

(T12-1145)

No. 4598, now Exploration Licence No. 8057, OCHRE RESOURCES PTY LTD (ACN 112 833 351), Counties of Canbelego, Flinders, Mouramba and Robinson, Map Sheet (8134, 8135), area of 100 units, for Group 1, dated 12 February 2013, for a term until 12 February 2015.

(T12-1178)

No. 4628, now Exploration Licence No. 8059, FORGE RESOURCES LTD (ACN 139 886 187), County of Goulburn, Map Sheet (8326), area of 21 units, for Group 1, dated 25 February 2013, for a term until 25 February 2015.

(T12-1196)

No. 4645, now Exploration Licence No. 8056, IRGS NORTHERN GOLD PTY LTD (ACN 149 177 999), Counties of Inglis, Parry and Vernon, Map Sheet (9135), area of 100 units, for Group 1, dated 12 February 2013, for a term until 12 February 2016.

MINING LEASE APPLICATION

(T11-0118)

Orange No. 399, now Mining Lease No. 1684 (Act 1992), TOMINGLEY GOLD OPERATIONS PTY LTD (ACN 149 040 371), Parish of Bulgandramine, County of Narromine and Parish of Gundong, County of Narromine, Map Sheet (8532-4-N), area of 733.7 hectares, to mine for antimony, arsenic, bismuth, copper, gold, lead, silver and zinc, dated 11 February 2013, for a term until 11 February 2034. As

MINERAL RESOURCES

NOTICE is given that the following applications have been received:

EXPLORATION LICENCE APPLICATIONS

(T13-1030)

No. 4770, OCHRE RESOURCES PTY LTD (ACN 112 833 351), area of 76 units, for Group 1, dated 27 February 2013. (Cobar Mining Division).

(T13-1031)

No. 4771, RICHARD RYDING (trading as RICHARD RYDING EARTHMOVING), area of 1 units, for Group 2, dated 27 February 2013. (Coffs Harbour Mining Division).

(T13-1033)

No. 4772, HARVEST EXPLORATION PTY LTD (ACN 003 069 501), area of 20 units, for Group 1, dated 3 March 2013. (Sydney Mining Division).

a result of the grant of this title, Exploration Licence No. 5675 and Exploration Licence No. 5830 have partly ceased to have effect.

The Hon. CHRIS HARTCHER, M.P.,
Minister for Resources and Energy

NOTICE is given that the following applications for renewal have been received:

(05-0249)

Exploration Licence No. 6726, ARK MINES LIMITED (ACN 123 668 717), area of 12 units. Application for renewal received 27 February 2013.

(06-4176)

Exploration Licence No. 6728, MINCOR COPPER PTY LTD (ACN 120 024 777), area of 79 units. Application for renewal received 4 March 2013.

(T08-0132)

Exploration Licence No. 7313, STANDARD IRON PTY LTD (ACN 131 971 438), area of 100 units. Application for renewal received 26 February 2013.

(T08-0133)

Exploration Licence No. 7314, STANDARD IRON PTY LTD (ACN 131 971 438), area of 100 units. Application for renewal received 26 February 2013.

(T08-0135)

Exploration Licence No. 7316, STANDARD IRON PTY LTD (ACN 131 971 438), area of 100 units. Application for renewal received 26 February 2013.

(T08-0248)

Exploration Licence No. 7319, SILVER CITY MINERALS LIMITED (ACN 130 933 309), area of 87 units. Application for renewal received 27 February 2013.

(T08-0240)

Exploration Licence No. 7320, GOLDEN CROSS OPERATIONS PTY. LTD. (ACN 050 212 827), area of 39 units. Application for renewal received 6 March 2013.

(T10-0246)

Exploration Licence No. 7728, Peter Warren ENGLISH, area of 1 units. Application for renewal received 5 March 2013.

(T10-0280)

Exploration Licence No. 7729, IDYLWAY VENTURE PTY LTD (ACN 141 397 006), area of 9 units. Application for renewal received 27 February 2013.

(11-3567)

Petroleum Exploration Licence No. 454, APEX ENERGY NL (ACN 097 997 914) and SYDNEY BASIN CBM PTY LTD (ACN 105 706 894), area of 4 blocks. Application for renewal received 27 February 2013.

(13-1044)

Mining Lease No. 1308 (Act 1992), TAHMOOR COAL PTY LTD (ACN 076 663 968), area of 13.16 hectares. Application for renewal received 4 March 2013.

The Hon. CHRIS HARTCHER, M.P.,
Minister for Resources and Energy

RENEWAL OF CERTAIN AUTHORITIES

NOTICE is given that the following authority has been renewed:

(T07-0496)

Exploration Licence No. 7066, KOKONG HOLDINGS PTY LTD (ACN 008 622 348), County of Clarke, Map Sheet (9336, 9337), area of 25 units, for a further term until 5 February 2014. Renewal effective on and from 8 November 2012.

The Hon. CHRIS HARTCHER, M.P.,
Minister for Resources and Energy

WITHDRAWAL OF APPLICATIONS FOR RENEWAL

NOTICE is given that the applications for renewal in respect of the following authorities have been withdrawn:

(T08-0072)

Exploration Licence No. 7184, SCORPIO RESOURCES PTY LTD (ACN 109 158 769), County of Clarke, Map Sheet (9237, 9337), area of 44 units. The authority ceased to have effect on 28 February 2013.

(T96-1216)

Mining Claim converted to Lease No. 248 (Act 1992), Ian WATERS, Parish of Moonan, County of Durham, Map Sheet (9134-2-S, 9134-2-S), area of 1.598 hectares. The authority ceased to have effect on 5 March 2013.

The Hon. CHRIS HARTCHER, M.P.,
Minister for Resources and Energy

PRIMARY INDUSTRIES

APIARIES ACT 1985

Appointment of Inspector

I, ANDREW COLIN SANGER, Director, Agricultural Compliance, with the delegated authority of the Director General of the Department of Trade and Investment, Regional Infrastructure and Services pursuant to section 47A of the Apiaries Act 1985 (“the Act”) and pursuant to section 5 (1) of the Act, do by this notification hereby appoint Michael Leslie THOMPSON as an inspector for the purposes of the Act

Dated this 4th day of March 2013.

A. C. SANGER,
Director, Agricultural Compliance,
Department of Primary Industries
(an office within the Department of Trade and Investment, Regional Infrastructure and Services)

FISHERIES MANAGEMENT ACT 1994

Sections 227 and 228 (2)

Instrument of Delegation from Minister to Director-General

I, KATRINA ANN HODGKINSON, M.P., Minister for Primary Industries, do by this instrument:

1. pursuant to section 227 (1) of the Fisheries Management Act 1994 (“the Act”), delegate to the Director General the functions conferred or imposed on me under the Act, as specified in Column 2 of the Schedule to this instrument of delegation;
2. pursuant to section 228 (2) of the Act, authorise the Director General to subdelegate to any authorised person any function delegated to the Director General under this instrument of delegation.

In this instrument of delegation:

The summary of function delegated in Column 1 of the Schedule is only for general explanation and does not limit the delegation of functions under the provision identified in Column 2 of the Schedule.

“*authorised person*” has the same meaning as in section 228 (3) of the Act.

“*Director General*” means the Director General of the Department of Trade and Investment, Regional Infrastructure and Services.

“*function*” includes power, authority or duty.

Dated this 26th day of February 2013.

KATRINA ANN HODGKINSON, M.P.,
Minister for Primary Industries

SCHEDULE

Delegation by Minister to Director General of Ministerial Functions under the Fisheries Management Act 1994	
<i>Column 1</i> <i>Part/Division of Fisheries Management Act 1994 – Summary of function delegated</i>	<i>Column 2</i> <i>Section</i>
Part 6 Aquaculture management	
<i>Division 4 Diseased fish and marine vegetation</i>	
Urgent publication of order declaring quarantine area because of the presence or suspected presence of a declared disease	183 (3)
Part 7 Protection of aquatic habitats	
<i>Division 6 Noxious fish and noxious marine vegetation</i>	
Declare a quarantine area because of the presence or suspected presence of noxious fish or noxious marine vegetation	209C (1)
Urgent publication of order declaring quarantine area because of the presence or suspected presence of noxious fish or noxious marine vegetation	209C (3)
Take action if person fails to take action under a quarantine order and then recover costs of taking action as a debt	209C (11) (b)
Issue a permit to release live noxious fish or noxious marine vegetation into waters	209D (1)

PLANT DISEASES ACT 1924

Appointment of Inspectors

I, ANDREW COLIN SANGER, Director, Agricultural Compliance, with the delegated authority of the Director General of the Department of Trade and Investment, Regional Infrastructure and Services, pursuant to section 28C of the Plant Diseases Act 1924 (“the Act”) and pursuant to section 11 (1) of the Act, hereby appoint the persons named in the Schedule below as inspectors for the purposes of the Act.

SCHEDULE

Alicia MELLBERG
Lauren Kate DONALDSON

Dated this 4th day of March 2013.

A. C. SANGER,
Director, Agricultural Compliance,
Department of Primary Industries
(an office within the Department of Trade and Investment, Regional Infrastructure and Services)

PLANT DISEASES ACT 1924

Revocation of Appointment of Inspectors

I, ANDREW COLIN SANGER, Director, Agricultural Compliance, with the delegated authority of the Director General of the Department of Trade and Investment, Regional Infrastructure and Services, pursuant to section 28C of the Plant Diseases Act 1924 (“the Act”) do hereby pursuant to section 3 (2) (a) and 11 (1) of the Act, revoke the appointment of each person named in Column 1 of the Schedule as an inspector under the Act, as published in the New South Wales Government Gazette with the reference set out in Column 2 of the Schedule and at the page specified in Column 3 of the Schedule and any appointment revived as a result of this revocation.

SCHEDULE

<i>Column 1</i>	<i>Column 2</i>	<i>Column 3</i>
Gillian Elizabeth ANDERSON	No. 143 of 9 October 2009	5354
Neil BARKER	No. 135 of 17 December 2012	5864
Sharon Lea BERRYMAN	No. 143 of 9 October 2009	5354
Andrew Noel BRASTRUP	No. 109 of 11 November 2011	6558
Robert Malcolm CAMERON	No. 2 of 14 January 2011	26
Mark William CASHEN	No. 160 of 24 December 2008	13122
Shane John CLANCY	No. 189 of 4 December 2009	5978
Brian Harvey CLEAVER	No. 170 of 29 October 2004	8233
Thomas CLOHESSY	No. 109 of 11 November 2011	6558
Chris Kelvin COCHRANE	No. 109 of 11 November 2011	6558
Vince Charles DERRICO	No. 170 of 29 October 2004	8233
Jodie Lee DICKSON	No. 53 of 16 May 2008	3923
Peter Norman DIXON	No. 170 of 29 October 2004	8233
Erin Louise DOERING	No. 109 of 11 November 2011	6558
Jamie David DORSETT	No. 13 of 16 January 2009	347
Marian Louise DORSETT	No. 160 of 24 December 2008	13122
John Ravenshaw EDWARDS	No. 31 of 25 March 2011	2286
Monika EHRMANN	No. 109 of 11 November 2011	6558
Sudeth EKANAUAKE	No. 189 of 4 December 2009	5978
Peter FENU	No. 145 of 24 November 2006	9976
Jacob Allen FERRIER	No. 31 of 25 March 2011	2286

<i>Column 1</i>	<i>Column 2</i>	<i>Column 3</i>
Peter Sam FINIS	No. 32 of 10 March 2006	1192
Nathan Craig GERVASI	No. 135 of 30 December 2011	7425
Neil Robert KING	No. 189 of 4 December 2009	5978
Sara Darlene LEWIS	No. 53 of 16 May 2008	3923
Peter Allen MARTIN	No. 32 of 10 March 2006	1192
Stephen NANGLE	No. 109 of 11 November 2011	6558
Michael NEMTSAS	No. 170 of 29 October 2004	8233
Steven O'KEEFE	No. 189 of 4 December 2009	5978
Nicole O'REILLY	No. 109 of 11 November 2011	6558
Gary Don PEDDER	No. 48 of 2 May 2008	2997
Judith Lynn POULIOT	No. 10 of 25 January 2008	186
Peter Raymond PRYOR	No. 145 of 24 November 2006	9967
David Paul REID	No. 160 of 24 December 2008	13122
Patrick John RUSSELL	No. 189 of 4 December 2009	5978
John Andrew WINTERBOTTOM	No. 50 of 20 My 2011	2891
Peter Joseph AINLEY	No. 67 of 1 July 2011	4681
Andrew Malcolm ALDERTON	No. 44 of 6 May 2011	2743
Hussin AL HASSNAWY	No. 135 of 17 December 2010	5864
Sejad ALI	No. 20 of 25 February 2011	1331
Hussein ALLAMI	No. 31 of 25 March 2011	2286
Martin Thomas ALLCROFT	No. 78 of 29 July 2011	5076
Brian ALLEN	No. 67 of 1 July 2011	4681
Maree ANNAND	No. 31 of 25 March 2011	2286
Aaron ARGAET	No. 31 of 25 March 2011	2286
Damien BAILEY	No. 31 of 25 March 2011	2286
Robert John BAIN	No. 78 of 29 July 2011	5076
Elnour BAKHIET	No. 67 of 1 July 2011	4681
Len Irwin BARTLESON	No. 111of 18 November 2011	6602
John BAWDEN	No. 12 of 3 February 2012	236
Alan John BELL	No. 109 of 11 November 2011	6558
Ashley BETTS	No. 44 of 6 May 2011	2743
John BROGAN	No. 44 of 6 May 2011	2743
Craig Anthony BROWN	No. 103 of 28 October 2011	6181
Tomas Wesley BROWN	No. 20 of 25 February 2011	1331
Peter Roy BYRNES	No. 103 of 28 October 2011	6181
Frances Kathleen CAIN	No. 20 of 25 February 2011	1331
Scott Paul CAMERON	No. 44 of 6 May 2011	2743
John Bernard CARROLL	No. 143 of 9 October 2009	5354
Nayyar Hussain CHANGAZI	No. 31 of 25 March 2011	2286
Mark CHENTRENS	No. 103 of 28 October 2011	6181
Luke David CLARKE	No. 31 of 25 March 2011	2286

<i>Column 1</i>	<i>Column 2</i>	<i>Column 3</i>
John Charles CLAYTON	No. 44 of 6 May 2011	2743
Jennifer-Ann COLLETT	No. 31 of 25 March 2011	2286
Matthew CONNOLLY	No. 63 of 4 May 2007	2652
Anne-Marie COOKSEY	No. 20 of 25 February 2011	1331
Peter William DAVIS	No. 103 of 28 October 2011	6181
John Thomas DAWS	No. 78 of 29 July 2011	5076
John Arnold DICKSON	No. 78 of 29 July 2011	5076
Alexander Paul DODD	No. 31 of 25 March 2011	2286
Ellen Irene FEAR	No. 111 of 18 November 2011	6602
Samantha FOUNTAIN	No. 78 of 29 July 2011	5076
John Alan FRAZER	No. 31 of 25 March 2011	2286
Luke David FULTON	No. 44 of 6 May 2011	2743
Damien Marc GAHAN	No. 31 of 25 March 2011	2286
Leah Nicole GERCOVICH	No. 31 of 25 March 2011	2286
Dale Leslie GIBLIN	No. 20 of 25 February 2011	1331
Christopher GILBERT	No. 44 of 6 May 2011	2743
Caitlin Sarah GILLETT	No. 44 of 6 May 2011	2743
Thomas GOLDBACH	No. 109 of 11 November 2011	6558
Colin Andrew GOODE	No. 44 of 6 May 2011	2743
Faye Beverley GRIGOROPOULOS-SINCLAIR	No. 44 of 6 May 2011	2743
Adam John R GUPPY	No. 67 of 1 July 2011	4681
Robert HALL	No. 44 of 6 May 2011	2743
Robert James HALL	No. 20 of 25 February 2011	1331
Colin Richard HAMMOND	No. 12 of 3 February 2012	236
Dean Noel HANDY	No. 103 of 28 October 2011	6181
Vanessa Anne HARRIS	No. 12 of 3 February 2012	236
Neil Owen HARTLEY	No. 109 of 11 November 2011	6558
Sarah Jayne HAYE	No. 78 of 29 July 2011	5076
Mathew John HENSCHKE	No. 111 of 18 November 2011	6602
David John HERBERT	No. 67 of 29 June 2012	3076
Darryn John HERDY	No. 67 of 1 July 2011	4681
Peter James HEYWOOD	No. 31 of 25 March 2011	2286
Scott Thomas HOLLOWAY	No. 67 of 1 July 2011	4681
Maureen HOLZBERGER	No. 31 of 25 March 2011	2286
Maxwell David IRVING	No. 78 of 29 July 2011	5076
Sally IVONE	No. 31 of 25 March 2011	2286
Edwin Keith JENNER	No. 31 of 25 March 2011	2286
Stephen John JINNETTE	No. 67 of 1 July 2011	4681
Douglas Roy JONES	No. 44 of 6 May 2011	2743
Patrick Brian JONES	No. 44 of 6 May 2011	2743
Scone KEI	No. 44 of 6 May 2011	2743

<i>Column 1</i>	<i>Column 2</i>	<i>Column 3</i>
Michael Richard KNUDSEN	No. 31 of 25 March 2011	2286
Tupounaviivii Akama KIRIRUA	No. 103 of 28 October 2011	6181
Lee MACDONELL	No. 78 of 29 July 2011	5076
Jamie MANNERS	No. 67 of 29 June 2012	3076
Dwayne Neville MANSFIELD	No. 67 of 1 July 2011	4681
James Kevin MARCHIONI	No. 111 of 18 November 2011	6602
Liteasha Maree MATTSCHOSS	No. 31 of 25 March 2011	2286
Nicole Jade MATTSCHOSS	No. 44 of 6 May 2011	2743
Robert McCRAE	No. 31 of 25 March 2011	2286
Peter Anthony McDOUGALL	No. 135 of 17 December 2010	5864
Christopher Stephen McGARR	No. 20 of 25 February 2011	1331
Ryan David MILLER	No. 44 of 6 May 2011	2743
Blake John MONTGOMERY	No. 31 of 25 March 2011	2286
Baden MOORE	No. 31 of 25 March 2011	2286
Damien NASH	No. 44 of 6 May 2011	2743
Shelley Leanne NUTTING	No. 67 of 1 July 2011	4681
James Peter O'BRIEN	No. 78 of 29 July 2011	5076
Cynthia O'DONNELL	No. 31 of 25 March 2011	2286
Benjamin O'DONOVAN	No. 44 of 6 May 2011	2743
Maria Ann O'HARA	No. 48 of 2 May 2008	2997
Nathan OLASZ	No. 31 25 March 2011	2286
Helen Maree O'SULLIVAN	No. 20 25 February 2011	1331
Cezmi OZKARA	No. 44 of 6 May 2011	2743
Sheryn Lee PAGE	No. 44 of 6 May 2011	2743
Angela Kathleen PALLANTE	No. 20 of 25 February 2011	1331
Scott John PATULLO	No. 103 of 28 October 2011	6181
Veronika PESA	No. 31 of 25 March 2011	2286
Jarryd John PETERS	No. 44 of 6 May 2011	2743
Adam Anthony PICHLER	No. 143 of 9 October 2009	5354
Harley James PITT	No. 109 of 11 November 2011	6558
Danny Dran PLANT	No. 20 of 25 February 2011	1331
Rocco POPPA	No. 143 of 9 October 2009	5354
Ian John POLEY	No. 31 of 25 March 2011	2286
Peter John PRINGLE	No. 44 of 6 May 2011	2743
Malcolm RATCLIFFE	No. 67 of 1 July 2011	4681
Chantal Alesh RETALLICK	No. 109 of 11 November 2011	6558
Darren Russell RICHARDSON	No. 44 of 6 May 2011	2743
Alexander Darcy ROSS	No. 44 of 6 May 2011	2743
Wesley Jon SHEIL	No. 78 of 29 July 2011	5076
Anthony Robert SMITH	No. 44 of 6 May 2011	2743
Craig Alan SPERLING	No. 67 of 1 July 2011	4681

<i>Column 1</i>	<i>Column 2</i>	<i>Column 3</i>
Stephen STEWART	No. 103 of 28 October 2011	6181
Steven SULLIVAN	No. 44 of 6 May 2011	2743
Stephen Leonard SUTTON	No. 20 of 25 February 2011	1331
Colin Richard SWEET	No. 44 of 6 May 2011	2743
Daniel Christopher THAKE	No. 103 of 28 October 2011	6181
Dennis James THOMPSON	No. 78 of 29 July 2011	5076
Aaron Glenn THORNE	No. 31 of 25 March 2011	2286
Matt Jacob TIMMIS	No. 103 of 28 October 2011	6181
Darren Jeffrey TRICKER	No. 109 of 11 November 2011	6558
Dion Lee TURNER KIRBY	No. 103 of 28 October 2011	6181
James Leslie A TYACK	No. 44 of 6 May 2011	2743
Elizabeth WADDINGTON	No. 67 of 1 July 2011	4681
Ian Edward WALDRON	No. 109 of 11 November 2011	6558
Craig Douglas WARD	No. 109 of 11 November 2011	6558
James A WATSON	No. 67 of 29 June 2012	3076
Peter John WATSON	No. 31 of 25 March 2011	2286
Andrew John WATTS	No. 20 of 25 February 2011	1331
Christopher Lee WEBSTER	No. 111 of 18 November 2011	6602
Irene WELLS	No. 67 of 1 July 2011	4681
Richard WHITE	No. 44 of 6 May 2011	2743
Jolene Pearl WILLIAMS	No. 44 of 6 May 2011	2743
Valerie Anne E WILSON	No. 103 of 28 October 2011	6181
Andrew John WORTHY	No. 31 of 25 March 2011	2286
Darryl WRIGHT	No. 78 of 29 July 2011	5076
Larry James ZAFFINA	No. 103 of 28 October 2011	6181

Dated this the 4th day of March 2013.

A. C. SANGER,
Director, Agricultural Compliance,
Department of Primary Industries
(an office within the Department of Trade and Investment, Regional Infrastructure and Services)

STOCK DISEASES ACT 1923

Appointment of Inspector

Notification No. 546

I, ANDREW COLIN SANGER, Director, Agricultural Compliance, with the delegated authority of the Director General of the Department of Trade and Investment, Regional Infrastructure and Services, pursuant to section 22C of the Stock Diseases Act 1923 ("the Act") and pursuant to section 6 (1) of the Act, hereby appoint Tiffany Jane FELTON as an inspector for the purposes of the Act.

Dated this 4th day of March 2013.

A. C. SANGER,
Director, Agricultural Compliance,
Department of Primary Industries
(an office within the Department of Trade and Investment, Regional Infrastructure and Services)

PLANT DISEASES (FRUIT FLY OUTBREAK AND SUSPENSION AREAS) (NO. 2) ORDER 2013

under the Plant Diseases Act 1924

I, KATHRYN PHYLLIS GOTT, Acting Director, Plant Biosecurity, with the delegated authority of the Minister for Primary Industries in pursuance of section 3A of the Plant Diseases Act 1924 (“the Act”), and in pursuance of sections 3 (2) and 4 of the Act being of the opinion that the importation, introduction or bringing of host fruit into specified portions of New South Wales is likely to introduce the pest Queensland fruit fly (*Bactrocera tryoni*) into specified portions of New South Wales, make the following Order regulating the importation, introduction or bringing of host fruit into specified portions of New South Wales.

1 Name of Order

This Order is the Plant Diseases (Fruit Fly Outbreak and Suspension Areas) (No. 2) Order 2013.

2 Commencement

This Order commences on the date it is published in the *NSW Government Gazette*.

3 Interpretation

(1) In this Order:

approved systems approach means the risk management measures relevant to the type of host fruit, as specified in Schedule 7.

approved treatment means the treatment and manner and timing of harvest and packing relevant to the type of host fruit, as specified in Schedule 6.

APVMA means the Australian Pesticides and Veterinary Medicines Authority.

assorted tropical and sub-tropical fruits – inedible peel means the host fruit specified in Schedule 2, being host fruit classified as such in accordance with the Codex Classification of Foods and Animal Feeds.

cart note means a written document that, in relation to the wine grapes that are the subject of the consignment, includes (at least) the following information:

- (a) the quantity of wine grapes being supplied;
- (b) the variety of wine grapes being supplied;
- (c) the name and contact details of the grower of the wine grapes;
- (d) the physical address of the property on which the wine grapes were grown;
- (e) the name and physical address of the winery receiving the wine grapes;
- (f) the name and signature of the person signing the cart note; and
- (g) the date the cart note is signed.

Certification Assurance Arrangement means an arrangement approved by the Department of Primary Industries which enables a business accredited under the arrangement to certify that certain quarantine requirements have been satisfied for the movement of host fruit to interstate and/or intrastate markets.

Note: An example of an approved Certification Assurance Arrangement is the Interstate Certification Assurance (ICA) Scheme.

citrus fruits means the host fruit specified in Schedule 3, being host fruit classified as such in accordance with the Codex Classification of Foods and Animal Feeds.

Codex Classification of Foods and Animal Feeds means the listing of food commodities in trade classified into groups on the basis of the commodity’s similar potential for pesticides residues, as published by the Joint Food and Agriculture Organization of the United Nations (FAO)/World Health Organisation (WHO) Food Standards Programme Codex Alimentarius Commission (publication available at <http://www.codexalimentarius.net>).

composite lots means a consignment comprising packages of different types of host fruit sourced from one or more suppliers.

free of broken skin means the skin has no pre-harvest cracks, punctures, pulled stems or other breaks which penetrate through the skin and that have not healed with callus tissue.

Greater Sunraysia (NSW Portion) Pest Free Area means the portion of New South Wales known as the Greater Sunraysia (NSW Portion) Pest Free Area, as specified in the Plant Diseases (NSW Fruit Fly Exclusion Zone and Greater Sunraysia Pest Free Area) (No. 3) Order 2012 (having the Department’s reference O-434) published on the Department’s internet website on 20 December 2012 and published in *NSW Government Gazette* No. 1 of 4 January 2013 at pages 4-29, excluding an Outbreak Area and a Suspension Area.

host fruit means fruit of a type specified in Schedule 1 that is fresh, but does not include processed fruit.

lot means a discrete quantity of fruit received from one grower at one time.

NTN means national trap number.

Outbreak Area means an area described in Column 1 of Schedule 4.

Plant Health Assurance Certificate means a certificate (known as a Plant Health Assurance Certificate) issued by a business accredited under a Certification Assurance Arrangement.

Plant Health Certificate means a certificate (known as a Plant Health Certificate) issued by:

- (a) an inspector or a person authorised pursuant to section 11 (3) of the Act; or
- (b) a person authorised to issue such a certificate under a law of another State or Territory that relates to plant biosecurity.

processed fruit means fruit that has been subjected to a processing activity such as cooking, drying, canning, juicing or freezing and includes pre-prepared fresh fruit that has been chopped, sliced or shredded, and packaged.

Queensland fruit fly means the pest *Bactrocera tryoni* (Froggatt).

Suspension Area means an area described in Column 2 of Schedule 4.

the Act means the Plant Diseases Act 1924.

Note: *Department, covering or package, inspector, occupier* and *owner* all have the same meaning as in the Act.

(2) In this Order, longitude and latitude coordinates are decimal degrees based upon the GDA 94 datum.

4 Revocation of Plant Diseases (Fruit Fly Outbreak and Suspension Areas) Order 2013

Pursuant to sections 4 and 3 (2) of the Act, the Plant Diseases (Fruit Fly Outbreak and Suspension Areas) Order 2013 (having the Department's reference O-436) published in *NSW Government Gazette* No. 6 of 25 January 2013 at pages 145-181, is revoked (as is any instrument revived as a result of this revocation).

5 Regulation of the movement of host fruit (excluding wine grapes)

(1) Pursuant to section 4 (1) of the Act, the importation, introduction or bringing of host fruit (excluding wine grapes) into specified portions of New South Wales is regulated as specified in this clause.

(2) Host fruit (excluding wine grapes) that originates from or has moved through an Outbreak Area or a Suspension Area must not be moved into the Greater Sunraysia (NSW Portion) Pest Free Area unless the movement is as specified in Schedule 5 and complies with the relevant conditions of exception set out in Schedule 5.

6 Certification requirements for the movement of host fruit (excluding wine grapes)

The movement of any host fruit (excluding wine grapes) in accordance with Schedule 5 must be accompanied by:

- (a) a Plant Health Certificate certifying:
 - (i) the origin of the host fruit; and
 - (ii) that the host fruit has received an approved treatment; or
 - (iii) that the host fruit has been grown and packed in accordance with an approved systems approach; or
- (b) a Plant Health Assurance Certificate issued under a Certification Assurance Arrangement.

7 Regulation of the movement of wine grapes

(1) Pursuant to section 4 (1) of the Act, the importation, introduction or bringing of wine grapes into specified portions of New South Wales is regulated as specified in this clause.

(2) Wine grapes that originate from or have moved through an Outbreak Area or a Suspension Area must not be moved into the Greater Sunraysia (NSW Portion) Pest Free Area unless:

- (a) the owner or occupier of the property or facility from which the wine grapes originate ensures the wine grapes are loaded on the transport vehicle in a way that prevents spillage during transportation; and
- (b) the wine grapes are processed within 24 hours of receipt by the winery receiving the wine grapes; or
- (c) the movement is as specified in Schedule 5 and complies with the relevant conditions of exception set out in Schedule 5.

8 Certification requirements for the movement of wine grapes

(1) The movement of wine grapes in accordance with clause 7 (2) (a) and (b) must be accompanied by a cart note.

(2) A cart note that is required by this clause to accompany a movement of wine grapes must:

- (a) be retained by the winery receiving the wine grapes for at least 2 years from receipt of the wine grapes; and
- (c) upon request by an authorised person, be made available to the authorised person.

(3) The movement of wine grapes in accordance with Schedule 5 must be accompanied by:

- (a) a Plant Health Certificate certifying:
 - (i) the origin of the wine grapes; and
 - (ii) that the wine grapes have received an approved treatment; or
 - (iii) that the wine grapes have been grown and packed in accordance with an approved systems approach; or
- (b) a Plant Health Assurance Certificate issued under a Certification Assurance Arrangement.

SCHEDULE 1 – Host Fruit

Abiu	Chilli	Loganberry	Plum
Acerola	Citron	Longan	Plumcot
Apple	Cumquat	Loquat	Pomegranate
Apricot	Custard apple	Lychee (Litchi)	Prickly pear
Avocado	Date	Mandarin	Pummelo (Pomelo)
Babaco	Durian	Mango	Quince
Banana	Eggplant	Mangosteen	Rambutan
Black sapote	Feijoa	Medlar	Raspberry
Blackberry	Fig	Miracle fruit	Rollinia
Blueberry	Granadilla	Mulberry	Rose apple
Boysenberry	Grape	Nashi	Santol
Brazil cherry (Grumichama)	Grapefruit	Nectarine	Sapodilla
Breadfruit	Guava	Orange	Shaddock
Caimito (Star apple)	Hog plum	Passionfruit	Soursop
Cape gooseberry	Jaboticaba	Papaya	Sweetsop (Sugar apple)
Capsicum	Jackfruit	Peach	Strawberry
Carambola (Starfruit)	Jew plum	Peacharine	Tamarillo
Cashew Apple	Ju jube	Pear	Tangelo
Casimiro (White sapote)	Kiwifruit	Pepino	Tomato
Cherimoya	Lemon	Persimmon	Wax jambus
Cherry	Lime		

SCHEDULE 2 – Assorted Tropical and Sub-Tropical Fruits – Inedible Peel

Avocado	Durian	Longan	Pomegranate
Banana	Feijoa	Lychee (Litchi)	Prickly pear
Black sapote	Granadilla	Mango	Rambutan
Breadfruit	Guava (inedible peel varieties only)	Mangosteen	Sapodilla
Caimito (Star apple)	Jackfruit	Passionfruit	Soursop
Casimiro (White sapote)	Jackfruit	Papaya	Sweetsop (Sugar apple)
Cherimoya	Kiwifruit (inedible peel varieties only)	Persimmon (inedible peel varieties only)	Wax jambus
Custard apple			

SCHEDULE 3 – Citrus Fruits

Citron	Lime	Orange	Shaddock
Grapefruit	Mandarin	Pummelo (Pomelo)	Tangelo
Lemon			

SCHEDULE 4 – Outbreak Areas and Suspension Areas

<i>Item</i>	<i>Column 1 Outbreak Area</i>	<i>Column 2 Suspension Area</i>
O219	Bringan Street, Griffith, NSW	
	The area within a 1.5 km radius of the coordinates decimal degrees -34.287032 South and 146.027183 East (“the Bringan Street, Griffith Outbreak Area”).	The area within a 15 km radius of coordinates decimal degrees -34.287032 South and 146.027183 East, excluding the Bringan Street, Griffith Outbreak Area.
O220	Macarthur Street, Griffith, NSW	
	The area within a 1.5 km radius of the coordinates decimal degrees -34.279600 South and 146.051633 East (“the Macarthur Street, Griffith Outbreak Area”).	The area within a 15 km radius of coordinates decimal degrees -34.279600 South and 146.051633 East, excluding the Macarthur Street, Griffith Outbreak Area.
O221	Griffith NTN 2017, NSW	
	The area within a 1.5 km radius of the coordinates decimal degrees -34.274836 South and 146.070094 East (“the Griffith NTN 2017 Outbreak Area”).	The area within a 15 km radius of coordinates decimal degrees -34.274836 South and 146.070094 East, excluding the Griffith NTN 2017 Outbreak Area.
O222	Yoogali NTN 2195, NSW	
	The area within a 1.5 km radius of the coordinates decimal degrees -34.307517 South and 146.08448 East (“the Yoogali NTN 2195 Outbreak Area”).	The area within a 15 km radius of coordinates decimal degrees -34.307517 South and 146.08448 East, excluding the Yoogali NTN 2195 Outbreak Area.

<i>Item</i>	<i>Column 1 Outbreak Area</i>	<i>Column 2 Suspension Area</i>
O224	Gronn Road, Hanwood, NSW	
	The area within a 1.5 km radius of the coordinates decimal degrees -34.301251 South and 146.029297 East ("the Gronn Road, Hanwood Outbreak Area").	The area within a 15 km radius of coordinates decimal degrees -34.301251 South and 146.029297 East, excluding the Gronn Road, Hanwood Outbreak Area.
O225	Beelbangera NTN 2091, NSW	
	The area within a 1.5 km radius of the coordinates decimal degrees -34.221067 South and 146.112667 East ("the Beelbangera NTN 2091 Outbreak Area").	The area within a 15 km radius of coordinates decimal degrees -34.221067 South and 146.112667 East, excluding the Beelbangera NTN 2091 Outbreak Area.
O226	Fivebough Road, Leeton, NSW	
	The area within a 1.5 km radius of the coordinates decimal degrees -34.543750 South and 146.421900 East ("the Fivebough Road, Leeton Outbreak Area").	The area within a 15 km radius of coordinates decimal degrees -34.543750 South and 146.421900 East, excluding the Fivebough Road, Leeton Outbreak Area.
O227	Hillston NTN 2333, NSW	
	The area within a 1.5 km radius of the coordinates decimal degrees -33.47242 South and 145.626784 East ("the Hillston NTN 2333 Outbreak Area").	The area within a 15 km radius of coordinates decimal degrees -33.47242 South and 145.626784 East, excluding the Hillston NTN 2333 Outbreak Area.
O228	Waratah Street, Leeton, NSW	
	The area within a 1.5 km radius of the coordinates -degrees -34.547673 South and 146.409555 East ("the Waratah Street, Leeton Outbreak Area").	The area within a 15 km radius of coordinates decimal degrees - 34.547673 South and 146.409555 East, excluding the Waratah Street, Leeton Outbreak Area.
O229	Tharbogang NTN 2240, NSW	
	The area within a 1.5 km radius of the coordinates decimal degrees -34.255633 South and 146.014983 East ("the Tharbogang NTN 2240 Outbreak Area").	The area within a 15 km radius of coordinates decimal degrees -34.255633 South and 146.014983 East, excluding the Tharbogang NTN 2240 Outbreak Area.
O230	Nericon NTN 2249, NSW	
	The area within a 1.5 km radius of the coordinates decimal degrees -34.210550 South and 146.053917 East ("the Nericon NTN 2249 Outbreak Area").	The area within a 15 km radius of coordinates decimal degrees -34.210550 South and 146.053917 East, excluding the Nericon NTN 2249 Outbreak Area.
O232	Leeton NTN 2400, NSW	
	The area within a 1.5 km radius of the coordinates decimal degrees -34.555052 South and 146.390549 East ("the Leeton NTN 2400 Outbreak Area").	The area within a 15 km radius of coordinates decimal degrees -34.555052 South and 146.390549 East, excluding the Leeton NTN 2400 Outbreak Area.
O233	Hay NTN 4917, NSW	
	The area within a 1.5 km radius of the coordinates decimal degrees -34.518968 South and 144.845323 East ("the Hay NTN 4917 Outbreak Area").	The area within a 15 km radius of coordinates decimal degrees -34.518968 South and 144.845323 East, excluding the Hay NTN 4917 Outbreak Area.
O234	Mahonga Street, Jerilderie, NSW	
	The area within a 1.5 km radius of the coordinates decimal degrees -35.358124 South and 145.732777 East ("the Mahonga Street, Jerilderie Outbreak Area").	The area within a 15 km radius of coordinates decimal degrees -35.358124 South and 145.732777 East, excluding the Mahonga Street, Jerilderie Outbreak Area.
O235	Yenda NTN 2123, NSW	
	The area within a 1.5 km radius of the coordinates decimal degrees -34.252118 South and 146.193466 East ("the Yenda NTN 2123 Outbreak Area").	The area within a 15 km radius of coordinates decimal degrees -34.252118 South and 146.193466 East, excluding the Yenda NTN 2123 Outbreak Area.

<i>Item</i>	<i>Column 1 Outbreak Area</i>	<i>Column 2 Suspension Area</i>
O236	Yanco NTN 2465, NSW	
	The area within a 1.5 km radius of the coordinates decimal degrees -34.59358 South and 146.40522 East (“the Yanco NTN 2465 Outbreak Area”).	The area within a 15 km radius of coordinates decimal degrees -34.59358 South and 146.40522 East, excluding the Yanco NTN 2465 Outbreak Area.
O237	Wamoon NTN 2431, NSW	
	The area within a 1.5 km radius of the coordinates decimal degrees -34.52335 South and 146.33330 East (“the Wamoon NTN 2431 Outbreak Area”).	The area within a 15 km radius of coordinates decimal degrees -34.52335 South and 146.33330 East, excluding the Wamoon NTN 2431 Outbreak Area.
O238	Narrandera NTN 2537, NSW	
	The area within a 1.5 km radius of the coordinates decimal degrees -34.74958 South and 146.54890 East (“the Narrandera NTN 2537 Outbreak Area”).	The area within a 15 km radius of coordinates decimal degrees -34.74958 South and 146.54890 East, excluding the Narrandera NTN 2537 Outbreak Area.
O239	Barellan NTN 2602, NSW	
	The area within a 1.5 km radius of the coordinates decimal degrees -34.28988 South and 146.57465 East (“the Barellan NTN 2602 Outbreak Area”).	The area within a 15 km radius of coordinates decimal degrees -34.28988 South and 146.57465 East, excluding the Barellan NTN 2602 Outbreak Area.
O240	Yenda NTN 2139, NSW	
	The area within a 1.5 km radius of the coordinates decimal degrees -34.246017 South and 146.2181 East (“the Yenda NTN 2139 Outbreak Area”).	The area within a 15 km radius of coordinates decimal degrees -34.246017 South and 146.2181 East, excluding the Yenda NTN 2139 Outbreak Area.
O241	Nericon NTN 2255, NSW	
	The area within a 1.5 km radius of the coordinates decimal degrees -34.148967 South and 146.038617 East (“the Nericon NTN 2255 Outbreak Area”).	The area within a 15 km radius of coordinates decimal degrees -34.148967 South and 146.038617 East, excluding the Nericon NTN 2255 Outbreak Area.
O242	Nericon NTN 2780, NSW	
	The area within a 1.5 km radius of the coordinates decimal degrees -34.189833 South and 146.030367 East (“the Nericon NTN 2780 Outbreak Area”).	The area within a 15 km radius of coordinates decimal degrees -34.189833 South and 146.030367 East, excluding the Nericon NTN 2780 Outbreak Area.
O243	Lake Wyangan NTN 2258, NSW	
	The area within a 1.5 km radius of the coordinates decimal degrees -34.248367 South and 146.04295 East (“the Lake Wyangan NTN 2258 Outbreak Area”).	The area within a 15 km radius of coordinates decimal degrees -34.248367 South and 146.04295 East, excluding the Lake Wyangan NTN 2258 Outbreak Area.
O244	Merungle Hill NTN 2470, NSW	
	The area within a 1.5 km radius of the coordinates decimal degrees -34.591283 South and 146.432633 East (“the Merungle Hill NTN 2470 Outbreak Area”).	The area within a 15 km radius of coordinates decimal degrees -34.591283 South and 146.432633 East, excluding the Merungle Hill NTN 2470 Outbreak Area.
O245	Bilbul NTN 2201, NSW	
	The area within a 1.5 km radius of the coordinates decimal degrees -34.270923 South and 146.127076 East (“the Bilbul NTN 2201 Outbreak Area”).	The area within a 15 km radius of coordinates decimal degrees -34.270923 South and 146.127076 East, excluding the Bilbul NTN 2201 Outbreak Area.
O246	Griffith NTN 2042, NSW	
	The area within a 1.5 km radius of the coordinates decimal degrees -34.271833 South and 146.025683 East (“the Griffith NTN 2042 Outbreak Area”).	The area within a 15 km radius of coordinates decimal degrees -34.271833 South and 146.025683 East, excluding the Griffith NTN 2042 Outbreak Area.

<i>Item</i>	<i>Column 1 Outbreak Area</i>	<i>Column 2 Suspension Area</i>
O247	Yenda NTN 2132, NSW	
	The area within a 1.5 km radius of the coordinates decimal degrees -34.2242 South and 146.20045 East ("the Yenda NTN 2132 Outbreak Area").	The area within a 15 km radius of coordinates decimal degrees -34.2242 South and 146.20045 East, excluding the Yenda NTN 2132 Outbreak Area.
O248	Orr Street, Yarrawonga, Vic	
	The area within a 1.5 km radius of the coordinates decimal degrees -36.013244 South and 146.003703 East ("the Orr Street, Yarrawonga Outbreak Area").	The area within a 15 km radius of coordinates decimal degrees -36.013244 South and 146.003703 East, excluding the Orr Street, Yarrawonga Outbreak Area.
O250	Hillston NTN 2289, NSW	
	The area within a 1.5 km radius of the coordinates decimal degrees -33.495336 South and 145.570515 East ("the Hillston NTN 2289 Outbreak Area").	The area within a 15 km radius of coordinates decimal degrees -33.495336 South and 145.570515 East, excluding the Hillston NTN 2289 Outbreak Area.
O251	Hanwood NTN 2168, NSW	
	The area within a 1.5 km radius of the coordinates decimal degrees - 34.331532 South and 146.038459 East ("the Hanwood NTN 2168 Outbreak Area").	The area within a 15 km radius of coordinates decimal degrees - 34.331532 South and 146.038459 East, excluding the Hanwood NTN 2168 Outbreak Area.
O252	Hanwood NTN 2162, NSW	
	The area within a 1.5 km radius of the coordinates decimal degrees -34.316927 South and 146.04881 East ("the Hanwood NTN 2162 Outbreak Area").	The area within a 15 km radius of coordinates decimal degrees -34.316927 South and 146.04881 East, excluding the Hanwood NTN 2162 Outbreak Area.
O253	Yoogali NTN 2760, NSW	
	The area within a 1.5 km radius of the coordinates decimal degrees -34.288049 South and 146.092247 East ("the Yoogali NTN 2760 Outbreak Area").	The area within a 15 km radius of coordinates decimal degrees -34.288049 South and 146.092247 East, excluding the Yoogali NTN 2760 Outbreak Area.
O254	Corbie Hill NTN 2485, NSW	
	The area within a 1.5 km radius of the coordinates decimal degrees -34.57695 South and 146.48285 East ("the Corbie Hill NTN 2485 Outbreak Area").	The area within a 15 km radius of coordinates decimal degrees -34.57695 South and 146.48285 East, excluding the Corbie Hill NTN 2485 Outbreak Area.
O255	Hanwood NTN 2089, NSW	
	The area within a 1.5 km radius of the coordinates decimal degrees -34.30613 South and 146.052598 East ("the Hanwood NTN 2089 Outbreak Area").	The area within a 15 km radius of coordinates decimal degrees -34.30613 South and 146.052598 East, excluding the Hanwood NTN 2089 Outbreak Area.
O256	Hillston NTN 2322, NSW	
	The area within a 1.5 km radius of the coordinates decimal degrees -33.291091 South and 145.549399 East ("the Hillston NTN 2322 Outbreak Area").	The area within a 15 km radius of coordinates decimal degrees -33.291091 South and 145.549399 East, excluding the Hillston NTN 2322 Outbreak Area.
O258	Nanguina Street, Barooga, NSW	
	The area within a 1.5 km radius of the coordinates decimal degrees -35.908626 South and 145.694366 East ("the Nanguina Street, Barooga Outbreak Area").	The area within a 15 km radius of coordinates decimal degrees -35.908626 South and 145.694366 East, excluding the Nanguina Street, Barooga Outbreak Area.
O259	Whitton NTN 2443, NSW	
	The area within a 1.5 km radius of the coordinates decimal degrees -34.5152 South and 146.1842 East ("the Whitton NTN 2443 Outbreak Area").	The area within a 15 km radius of coordinates decimal degrees -34.5152 South and 146.1842 East, excluding the Whitton NTN 2443 Outbreak Area.

<i>Item</i>	<i>Column 1 Outbreak Area</i>	<i>Column 2 Suspension Area</i>
O260	Beelbangera, NSW	
	The area within a 1.5 km radius of the coordinates decimal degrees -34.25415 South and 146.101033 East (“the Beelbangera Outbreak Area”).	The area within a 15 km radius of coordinates decimal degrees -34.25415 South and 146.101033 East, excluding the Beelbangera Outbreak Area.
O261	Goolgowi, NSW	
	The area within a 1.5 km radius of the coordinates decimal degrees -33.960234 South and 145.710948 East (“the Goolgowi Outbreak Area”).	The area within a 15 km radius of coordinates decimal degrees -33.960234 South and 145.710948 East, excluding the Goolgowi Outbreak Area.
O262	Hillston, NSW	
	The area within a 1.5 km radius of the coordinates decimal degrees -33.486617 South and 145.528323 East (“the Hillston Outbreak Area”).	The area within a 15 km radius of coordinates decimal degrees -33.486617 South and 145.528323 East, excluding the Hillston Outbreak Area.
O263	Strathmerton, Vic	
	The area within a 1.5 km radius of the coordinates decimal degrees -35.92504 South and 145.50378 East (“the Strathmerton Outbreak Area”).	The area within a 15 km radius of coordinates decimal degrees -35.92504 South and 145.50378 East, excluding the Strathmerton Outbreak Area.
O264	Cobram South, Vic	
	The area within a 1.5 km radius of the coordinates decimal degrees -35.97041 South and 145.64723 East (“the Cobram South Outbreak Area”).	The area within a 15 km radius of coordinates decimal degrees -35.97041 South and 145.64723 East, excluding the Cobram South Outbreak Area.
O265	Darlington Point NTN 2587, NSW	
	The area within a 1.5 km radius of the coordinates decimal degrees -34.570117 South and 145.987083 East (“the Darlington Point NTN 2587 Outbreak Area”).	The area within a 15 km radius of coordinates decimal degrees -34.570117 South and 145.987083 East, excluding the Darlington Point NTN 2587 Outbreak Area.
O266	Tharbogang NTN 2236, NSW	
	The area within a 1.5 km radius of the coordinates decimal degrees -34.2572 South and 145.995867 East (“the Tharbogang NTN 2236 Outbreak Area”).	The area within a 15 km radius of coordinates decimal degrees -34.2572 South and 145.995867 East, excluding the Tharbogang NTN 2236 Outbreak Area.
O267	Murray Valley Hwy, Boundary Bend, Vic	
	The area within a 1.5 km radius of the coordinates decimal degrees -34.722036 South and 143.179314 East (“the Murray Valley Hwy, Boundary Bend Outbreak Area”).	The area within a 15 km radius of coordinates decimal degrees -34.722036 South and 143.179314 East excluding the Murray Valley Hwy, Boundary Bend Outbreak Area.
O270	Merriwagga NTN 2285, NSW	
	The area within a 1.5 km radius of the coordinates decimal degrees -33.818401 South and 145.6246 East (“the Merriwagga NTN 2285 Outbreak Area”).	The area within a 15 km radius of coordinates decimal degrees -33.818401 South and 145.6246 East, excluding the Merriwagga NTN 2285 Outbreak Area.
O271	Griffith NTN 2271, NSW	
	The area within a 1.5 km radius of the coordinates decimal degrees -34.229067 South and 145.961733 East (“the Griffith NTN 2271 Outbreak Area”).	The area within a 15 km radius of coordinates decimal degrees -34.229067 South and 145.961733 East, excluding the Griffith NTN 2271 Outbreak Area.
O272	Berrigan NTN 4769, NSW	
	The area within a 1.5 km radius of the coordinates decimal degrees -35.65885 South and 145.8084 East (“the Berrigan NTN 4769 Outbreak Area”).	The area within a 15 km radius of coordinates decimal degrees -35.65885 South and 145.8084 East, excluding the Berrigan NTN 4769 Outbreak Area.

<i>Item</i>	<i>Column 1 Outbreak Area</i>	<i>Column 2 Suspension Area</i>
O273	Yenda NTN 2117, NSW	
	The area within a 1.5 km radius of the coordinates decimal degrees -34.23445 South and 146.1569 East ("the Yenda NTN 2117 Outbreak Area").	The area within a 15 km radius of coordinates decimal degrees -34.23445 South and 146.1569 East, excluding the Yenda NTN 2117 Outbreak Area.
O274	Hanwood NTN 2176, NSW	
	The area within a 1.5 km radius of the coordinates decimal degrees -34.35409 South and 146.055591 East ("the Hanwood NTN 2176 Outbreak Area").	The area within a 15 km radius of coordinates decimal degrees -34.35409 South and 146.055591 East, excluding the Hanwood NTN 2176 Outbreak Area.
O277	Coleambally NTN 2592, NSW	
	The area within a 1.5 km radius of the coordinates decimal degrees -34.803717 South and 145.877633 East ("the Coleambally NTN 2592 Outbreak Area").	The area within a 15 km radius of coordinates decimal degrees -34.803717 South and 145.877633 East, excluding the Coleambally NTN 2592 Outbreak Area.
O280	Bromide Street, Broken Hill, NSW	
	The area within a 1.5 km radius of the coordinates decimal degrees -31.94188 South and 141.4468 East ("the Bromide Street, Broken Hill Outbreak Area").	The area within a 15 km radius of coordinates decimal degrees -31.94188 South and 141.4468 East, excluding the Bromide Street, Broken Hill Outbreak Area.
O282	Hanwood NTN 2087, NSW	
	The area within a 1.5 km radius of the coordinates decimal degrees -34.294331 South and 146.063394 East ("the Hanwood NTN 2087 Outbreak Area").	The area within a 15 km radius of coordinates decimal degrees -34.294331 South and 146.063394 East, excluding the Hanwood NTN 2087 Outbreak Area.
O283	Leeton NTN 2459, NSW	
	The area within a 1.5 km radius of the coordinates decimal degrees -34.5711 South and 146.403833 East ("the Leeton NTN 2459 Outbreak Area").	The area within a 15 km radius of coordinates decimal degrees -34.5711 South and 146.403833 East, excluding the Leeton NTN 2459 Outbreak Area.
O284	Tharbogang NTN 2232, NSW	
	The area within a 1.5 km radius of the coordinates decimal degrees -34.23555 South and 145.9717 East ("the Tharbogang NTN 2232 Outbreak Area").	The area within a 15 km radius of coordinates decimal degrees -34.23555 South and 145.9717 East, excluding the Tharbogang NTN 2232 Outbreak Area.
O285	Echuca, Vic	
	The area within a 1.5 km radius of the coordinates decimal degrees -36.14054 South and 144.755360 East ("the Echuca Outbreak Area").	The area within a 15 km radius of coordinates decimal degrees -36.14054 South and 144.755360 East, excluding the Echuca Outbreak Area.
O286	Yenda NTN 2150, NSW	
	The area within a 1.5 km radius of the coordinates decimal degrees -34.26145 South and 146.218033 East ("the Yenda NTN 2150 Outbreak Area").	The area within a 15 km radius of coordinates decimal degrees -34.26145 South and 146.218033 East, excluding the Yenda NTN 2150 Outbreak Area.
O287	Hanwood NTN 2170, NSW	
	The area within a 1.5 km radius of the coordinates decimal degrees -34.410889 South and 146.039534 East ("the Hanwood NTN 2170 Outbreak Area").	The area within a 15 km radius of coordinates decimal degrees -34.410889 South and 146.039534 East, excluding the Hanwood NTN 2170 Outbreak Area.
O288	Hanwood NTN 2092, NSW	
	The area within a 1.5 km radius of the coordinates decimal degrees -34.41977 South and 145.989041 East ("the Hanwood NTN 2092 Outbreak Area").	The area within a 15 km radius of coordinates decimal degrees -34.41977 South and 145.989041 East, excluding the Hanwood NTN 2092 Outbreak Area.
O289	Carramer Drive, Gol Gol, NSW	
	The area within a 1.5 km radius of the coordinates decimal degrees -34.18113 South and 142.20536 East ("the Carramer Drive, Gol Gol Outbreak Area").	The area within a 15 km radius of coordinates decimal degrees -34.18113 South and 142.20536 East, excluding the Carramer Drive, Gol Gol Outbreak Area.

<i>Item</i>	<i>Column 1 Outbreak Area</i>	<i>Column 2 Suspension Area</i>
O291	Tuppal Street, Tocomwal, NSW	
	The area within a 1.5 km radius of the coordinates decimal degrees -35.81468 South and 145.56619 East (“the Tuppal Street, Tocomwal Outbreak Area”).	The area within a 15 km radius of coordinates decimal degrees -35.81468 South and 145.56619 East, excluding the Tuppal Street, Tocomwal Outbreak Area.
O292	Smithers Road, Tocomwal East, NSW	
	The area within a 1.5 km radius of the coordinates decimal degrees -35.86356 South and 145.61078 East (“the Smithers Road, Tocomwal East Outbreak Area”).	The area within a 15 km radius of coordinates decimal degrees -35.86356 South and 145.61078 East, excluding the Smithers Road, Tocomwal East Outbreak Area.
O294	Murray Valley Hwy, Boundary Bend Township, NSW	
	The area within a 1.5 km radius of the coordinates decimal degrees -34.71538 South and 143.14876 East (“the Murray Valley Hwy, Boundary Bend Township Outbreak Area”).	The area within a 15 km radius of coordinates decimal degrees -34.71538 South and 143.14876 East, excluding the Murray Valley Hwy, Boundary Bend Township Outbreak Area.
O296	Pyke Street, Bundalong, NSW	
	The area within a 1.5 km radius of the coordinates decimal degrees -36.0357 South and 146.16502 East (“the Pyke Street, Bundalong Outbreak Area”).	The area within a 15 km radius of coordinates decimal degrees -36.0357 South and 146.16502 East, excluding the Pyke Street, Bundalong Outbreak Area.
O298	Hay NTN 4912, NSW	
	The area within a 1.5 km radius of the coordinates decimal degrees -34.5053 South and 144.84305 East (“the Hay NTN 4912 Outbreak Area”).	The area within a 15 km radius of the coordinates decimal degrees -34.5053 South and 144.84305 East, excluding the Hay NTN 4912 Outbreak Area.
O299	Hogans Road, Woodlands East, NSW	
	The area within a 1.5 km radius of the coordinates decimal degrees -36.0087 South and 146.0487 East (“the Hogans Road, Woodlands East Outbreak Area”).	The area within a 15 km radius of the coordinates decimal degrees -36.0087 South and 146.0487 East, excluding the Hogans Road, Woodlands East Outbreak Area.
O303	Yanco NTN 2494, NSW	
	The area within a 1.5 km radius of the coordinates decimal degrees -34.61675 South and 146.398183 East (“the Yanco NTN 2494 Outbreak Area”).	The area within a 15 km radius of the coordinates decimal degrees -34.61675 South and 146.398183 East, excluding the Yanco NTN 2494 Outbreak Area.
O305	Berry Street, Moama, NSW	
	The area within a 1.5 km radius of the coordinates decimal degrees -36.11612 South and 144.76033 East (“the Berry Street, Moama Outbreak Area”).	The area within a 15 km radius of coordinates decimal degrees -36.11612 South and 144.76033 East, excluding the Berry Street, Moama Outbreak Area.
O306	Rankin Springs NTN 2113, NSW	
	The area within a 1.5 km radius of the coordinates decimal degrees -33.84075 South and 146.260567 East (“the Rankin Springs NTN 2113 Outbreak Area”).	The area within a 15 km radius of coordinates decimal degrees -33.84075 South and 146.260567 East, excluding the Rankin Springs NTN 2113 Outbreak Area.
O307	Sepphelts Road, Barooga East, NSW	
	The area within a 1.5 km radius of the coordinates decimal degrees -35.93781 South and 145.7274 East (“the Sepphelts Road, Barooga East Outbreak Area”).	The area within a 15 km radius of coordinates decimal degrees -35.93781 South and 145.7274 East, excluding the Sepphelts Road, Barooga East Outbreak Area.
O308	Tharbogang NTN 2270, NSW	
	The area within a 1.5 km radius of the coordinates decimal degrees -34.22155 South and 145.958367 East (“the Tharbogang NTN 2270 Outbreak Area”).	The area within a 15 km radius of coordinates decimal degrees -34.22155 South and 145.958367 East, excluding the Tharbogang NTN 2270 Outbreak Area.

<i>Item</i>	<i>Column 1 Outbreak Area</i>	<i>Column 2 Suspension Area</i>
O309	Yenda NTN 2155, NSW	
	The area within a 1.5 km radius of the coordinates decimal degrees -34.24195 South and 146.174783 East ("the Yenda NTN 2155 Outbreak Area").	The area within a 15 km radius of coordinates decimal degrees -34.24195 South and 146.174783 East, excluding the Yenda NTN 2155 Outbreak Area.
O311	Rice Street, Barmah, NSW	
	The area within a 1.5 km radius of the coordinates decimal degrees -36.01589 South and 144.96014 East ("the Rice Street, Barmah Outbreak Area").	The area within a 15 km radius of coordinates decimal degrees -36.01589 South and 144.96014 East, excluding the Rice Street, Barmah Outbreak Area.
O313	Paynters Siding NTN 2550, NSW	
	The area within a 1.5 km radius of the coordinates decimal degrees -34.69385 South and 146.5254 East ("the Paynters Siding NTN 2550 Outbreak Area").	The area within a 15 km radius of coordinates decimal degrees -34.69385 South and 146.5254 East, excluding the Paynters Siding NTN 2550 Outbreak Area.
O314	Lake Wyangan NTN 2273, NSW	
	The area within a 1.5 km radius of the coordinates decimal degrees -34.2297 South and 146.05515 East ("the Lake Wyangan NTN 2273 Outbreak Area").	The area within a 15 km radius of coordinates decimal degrees -34.2297 South and 146.05515 East, excluding the Lake Wyangan NTN 2273 Outbreak Area.
O315	Teague Street, Koondrook, NSW	
	The area within a 1.5 km radius of the coordinates decimal degrees -35.6373 South and 144.12347 East ("the Teague Street, Koondrook Outbreak Area").	The area within a 15 km radius of coordinates decimal degrees -35.6373 South and 144.12347 East, excluding the Teague Street, Koondrook Outbreak Area.
O316	Cobram, Vic	
	The area within a 1.5 km radius of the coordinates decimal degrees -35.9124 South and 145.64984 East ("the Cobram Outbreak Area").	The area within a 15 km radius of coordinates decimal degrees -35.9124 South and 145.64984 East, excluding the Cobram Outbreak Area.
O317	River Road, Cobram East, Vic	
	The area within a 1.5 km radius of the coordinates decimal degrees -35.92666 South and 145.67301 East ("the River Road, Cobram East Outbreak Area").	The area within a 15 km radius of coordinates decimal degrees -35.92666 South and 145.67301 East, excluding the River Road, Cobram East Outbreak Area.
O318	Koonoomoo, NSW	
	The area within a 1.5 km radius of the coordinates decimal degrees -35.87141 South and 145.57721 East ("the Koonoomoo Outbreak Area").	The area within a 15 km radius of coordinates decimal degrees -35.87141 South and 145.57721 East, excluding the Koonoomoo Outbreak Area.
O321	Langan Road, Cobram East, Vic	
	The area within a 1.5 km radius of the coordinates decimal degrees -35.96845 South and 145.71346 East ("the Langan Road, Cobram East Outbreak Area").	The area within a 15 km radius of coordinates decimal degrees -35.96845 South and 145.71346 East, excluding the Langan Road, Cobram East Outbreak Area.
O322	Hanwood NTN 2188, NSW	
	The area within a 1.5 km radius of the coordinates decimal degrees -34.333605 South and 146.080026 East ("the Hanwood NTN 2188 Outbreak Area").	The area within a 15 km radius of coordinates decimal degrees -34.333605 South and 146.080026 East, excluding the Hanwood NTN 2188 Outbreak Area.
O324	Finley NTN 4825, NSW	
	The area within a 1.5 km radius of the coordinates decimal degrees -35.645817 South and 145.5721 East ("the Finley NTN 4825 Outbreak Area").	The area within a 15 km radius of coordinates decimal degrees -35.645817 South and 145.5721 East, excluding the Finley NTN 4825 Outbreak Area.
O325	Moulamein NTN 4701, NSW	
	The area within a 1.5 km radius of the coordinates decimal degrees -35.0924 South and 144.036733 East ("the Moulamein NTN 4701 Outbreak Area").	The area within a 15 km radius of coordinates decimal degrees -35.0924 South and 144.036733 East, excluding the Moulamein NTN 4701 Outbreak Area.

<i>Item</i>	<i>Column 1 Outbreak Area</i>	<i>Column 2 Suspension Area</i>
O326	Moulamein NTN 4927, NSW	
	The area within a 1.5 km radius of the coordinates decimal degrees -35.0808 South and 143.914583 East (“the Moulamein NTN 4927 Outbreak Area”).	The area within a 15 km radius of coordinates decimal degrees -35.0808 South and 143.914583 East, excluding the Moulamein NTN 4927 Outbreak Area.
O327	Nericon NTN 2783, NSW	
	The area within a 1.5 km radius of the coordinates decimal degrees -34.180733 South and 146.056833 East (“the Nericon NTN 2783 Outbreak Area”).	The area within a 15 km radius of coordinates decimal degrees -34.180733 South and 146.056833 East, excluding the Nericon NTN 2783 Outbreak Area.
O328	Kamarah NTN 2613, NSW	
	The area within a 1.5 km radius of the coordinates decimal degrees -34.326117 South and 146.783033 East (“the Kamarah NTN 2613 Outbreak Area”).	The area within a 15 km radius of coordinates decimal degrees -34.326117 South and 146.783033 East, excluding the Kamarah NTN 2613 Outbreak Area.
O330	Tharbogang NTN 2782, NSW	
	The area within a 1.5 km radius of the coordinates decimal degrees -34.126433 South and 146.0108 East (“the Tharbogang NTN 2782 Outbreak Area”).	The area within a 15 km radius of coordinates decimal degrees -34.126433 South and 146.0108 East, excluding the Tharbogang NTN 2782 Outbreak Area.
O331	Cudgel NTN 2488, NSW	
	The area within a 1.5 km radius of the coordinates decimal degrees -34.6687 South and 146.45015 East (“the Cudgel NTN 2488 Outbreak Area”).	The area within a 15 km radius of coordinates decimal degrees -34.6687 South and 146.45015 East, excluding the Cudgel NTN 2488 Outbreak Area.
O333	Yenda NTN 2143, NSW	
	The area within a 1.5 km radius of the coordinates decimal degrees -34.260533 South and 146.238867 East (“the Yenda NTN 2143 Outbreak Area”).	The area within a 15 km radius of coordinates decimal degrees -34.260533 South and 146.238867 East, excluding the Yenda NTN 2143 Outbreak Area.
O334	Hanwood NTN 2213, NSW	
	The area within a 1.5 km radius of the coordinates decimal degrees -34.338069 South and 146.00939 East (“the Hanwood NTN 2213 Outbreak Area”).	The area within a 15 km radius of coordinates decimal degrees -34.338069 South and 146.00939 East, excluding the Hanwood NTN 2213 Outbreak Area.
O338	Leeton NTN 2454, NSW	
	The area within a 1.5 km radius of the coordinates decimal degrees -34.534067 South and 146.396933 East (“the Leeton NTN 2454 Outbreak Area”).	The area within a 15 km radius of coordinates decimal degrees -34.534067 South and 146.396933 East, excluding the Leeton NTN 2454 Outbreak Area.
O339	Tharbogang NTN 2278, NSW	
	The area within a 1.5 km radius of the coordinates decimal degrees -34.121683 South and 145.984533 East (“the Tharbogang NTN 2278 Outbreak Area”).	The area within a 15 km radius of coordinates decimal degrees -34.121683 South and 145.984533 East, excluding the Tharbogang NTN 2278 Outbreak Area.
O340	Yenda NTN 2145, NSW	
	The area within a 1.5 km radius of the coordinates decimal degrees -34.276933 South and 146.24465 East (“the Yenda NTN 2145 Outbreak Area”).	The area within a 15 km radius of coordinates decimal degrees -34.276933 South and 146.24465 East, excluding the Yenda NTN 2145 Outbreak Area.
O341	Narrandera NTN 2547, NSW	
	The area within a 1.5 km radius of the coordinates decimal degrees -34.72795 South and 146.556867 East (“the Narrandera NTN 2547 Outbreak Area”).	The area within a 15 km radius of coordinates decimal degrees -34.72795 South and 146.556867 East, excluding the Narrandera NTN 2547 Outbreak Area.
O342	Hillston NTN 2334, NSW	
	The area within a 1.5 km radius of the coordinates decimal degrees -33.49415 South and 145.5455 East (“the Hillston NTN 2334 Outbreak Area”).	The area within a 15 km radius of coordinates decimal degrees -33.49415 South and 145.5455 East, excluding the Hillston NTN 2334 Outbreak Area.

<i>Item</i>	<i>Column 1 Outbreak Area</i>	<i>Column 2 Suspension Area</i>
O343	Romney Street, Mulwala, NSW	
	The area within a 1.5 km radius of the coordinates decimal degrees -35.98487 South and 146.00007 East ("the Romney Street, Mulwala Outbreak Area").	The area within a 15 km radius of coordinates decimal degrees -35.98487 South and 146.00007 East, excluding the Romney Street, Mulwala Outbreak Area.
O345	Stanbridge NTN 2435, NSW	
	The area within a 1.5 km radius of the coordinates decimal degrees -34.512417 South and 146.2446 East ("the Stanbridge NTN 2435 Outbreak Area").	The area within a 15 km radius of coordinates decimal degrees -34.512417 South and 146.2446 East, excluding the Stanbridge NTN 2435 Outbreak Area.
O347	Wamoon NTN 2422, NSW	
	The area within a 1.5 km radius of the coordinates decimal degrees -34.549717 South and 146.371 East ("the Wamoon NTN 2422 Outbreak Area").	The area within a 15 km radius of coordinates decimal degrees -34.549717 South and 146.371 East, excluding the Wamoon NTN 2422 Outbreak Area.
O348	Stanbridge NTN 2504, NSW	
	The area within a 1.5 km radius of the coordinates decimal degrees -34.493383 South and 146.238733 East ("the Stanbridge NTN 2504 Outbreak Area").	The area within a 15 km radius of coordinates decimal degrees -34.493383 South and 146.238733 East, excluding the Stanbridge NTN 2504 Outbreak Area.
O349	Stoney Point NTN 2450, NSW	
	The area within a 1.5 km radius of the coordinates decimal degrees -34.4799 South and 146.4169 East ("the Stoney Point NTN 2450 Outbreak Area").	The area within a 15 km radius of coordinates decimal degrees -34.4799 South and 146.4169 East, excluding the Stoney Point NTN 2450 Outbreak Area.
O350	Paynters Siding NTN 2546, NSW	
	The area within a 1.5 km radius of the coordinates decimal degrees -34.721817 South and 146.5377 East ("the Paynters Siding NTN 2546 Outbreak Area").	The area within a 15 km radius of coordinates decimal degrees -34.721817 South and 146.5377 East, excluding the Paynters Siding NTN 2546 Outbreak Area.
O352	Yenda NTN 2149, NSW	
	The area within a 1.5 km radius of the coordinates decimal degrees -34.167083 South and 146.154817 East ("the Yenda NTN 2149 Outbreak Area").	The area within a 15 km radius of coordinates decimal degrees -34.167083 South and 146.154817 East, excluding the Yenda NTN 2149 Outbreak Area.
O353	Quicks Road, Tocumwal South, NSW	
	The area within a 1.5 km radius of the coordinates decimal degrees -35.84677 South and 145.59633 East ("the Quicks Road, Tocumwal South Outbreak Area").	The area within a 15 km radius of coordinates decimal degrees -35.84677 South and 145.59633 East, excluding the Quicks Road, Tocumwal South Outbreak Area.
O354	Churchill Road, Cobram West, Vic	
	The area within a 1.5 km radius of the coordinates decimal degrees -35.95523 South and 145.60521 East ("the Churchill Road, Cobram West Outbreak Area").	The area within a 15 km radius of coordinates decimal degrees -35.95523 South and 145.60521 East, excluding the Churchill Road, Cobram West Outbreak Area.
O355	Beek Street, Katamatite, Vic	
	The area within a 1.5 km radius of the coordinates decimal degrees -36.07781 South and 145.68917 East ("the Beek Street, Katamatite Outbreak Area").	The area within a 15 km radius of coordinates decimal degrees -36.07781 South and 145.68917 East, excluding the Beek Street, Katamatite Outbreak Area.
O357	Cottons Road, Cobram East, Vic	
	The area within a 1.5 km radius of the coordinates decimal degrees -35.95478 South and 145.6774 East ("the Cottons Road, Cobram East Outbreak Area").	The area within a 15 km radius of coordinates decimal degrees -35.95478 South and 145.6774 East, excluding Cottons Road, Cobram East the Outbreak Area.

<i>Item</i>	<i>Column 1 Outbreak Area</i>	<i>Column 2 Suspension Area</i>
O358	Yoogali NTN 2196, NSW	
	The area within a 1.5 km radius of the coordinates decimal degrees -34.293815 South and 146.114973 East (“the Yoogali NTN 2196 Outbreak Area”).	The area within a 15 km radius of coordinates decimal degrees -34.293815 South and 146.114973 East, excluding the Yoogali NTN 2196 Outbreak Area.
O359	Yanco NTN 2495, NSW	
	The area within a 1.5 km radius of the coordinates decimal degrees -34.6148 South and 146.4182 East (“the Yanco NTN 2495 Outbreak Area”).	The area within a 15 km radius of coordinates decimal degrees -34.6148 South and 146.4182 East, excluding the Yanco NTN 2495 Outbreak Area.
O361	Lifford’s Lane, Barham, NSW	
	The area within a 1.5 km radius of the coordinates decimal degrees -35.61861 South and 144.14619 East (“the Lifford’s Lane, Barham Outbreak Area”).	The area within a 15 km radius of coordinates decimal degrees -35.61861 South and 144.14619 East, excluding the Lifford’s Lane, Barham Outbreak Area.
O362	Narrandera NTN 2552, NSW	
	The area within a 1.5 km radius of the coordinates decimal degrees -34.759783 South and 146.536717 East (“the Narrandera NTN 2552 Outbreak Area”).	The area within a 15 km radius of coordinates decimal degrees -34.759783 South and 146.536717 East, excluding the Narrandera NTN 2552 Outbreak Area.
O364	Stoney Point NTN 2451, NSW	
	The area within a 1.5 km radius of the coordinates decimal degrees -34.495 South and 146.42245 East (“the Stoney Point NTN 2451 Outbreak Area”).	The area within a 15 km radius of coordinates decimal degrees -34.495 South and 146.42245 East, excluding the Stoney Point NTN 2451 Outbreak Area.
O367	Wamoon NTN 2425, NSW	
	The area within a 1.5 km radius of the coordinates decimal degrees -34.536667 South and 146.350717 East (“the Wamoon NTN 2425 Outbreak Area”).	The area within a 15 km radius of coordinates decimal degrees -34.536667 South and 146.350717 East, excluding the Wamoon NTN 2425 Outbreak Area.
O368	Stoney Point NTN 2448, NSW	
	The area within a 1.5 km radius of the coordinates decimal degrees -34.46765 South and 146.3957 East (“the Stoney Point NTN 2448 Outbreak Area”).	The area within a 15 km radius of coordinates decimal degrees -34.46765 South and 146.3957 East, excluding the Stoney Point NTN 2448 Outbreak Area.
O369	Yanco NTN 2464, NSW	
	The area within a 1.5 km radius of the coordinates decimal degrees -34.584317 South and 146.391833 East (“the Yanco NTN 2464 Outbreak Area”).	The area within a 15 km radius of coordinates decimal degrees -34.584317 South and 146.391833 East, excluding the Yanco NTN 2464 Outbreak Area.
O370	Muckatah, South Cobram, Vic	
	The area within a 1.5 km radius of the coordinates decimal degrees -35.99185 South and 145.60681 East (“the Muckatah, South Cobram Outbreak Area”).	The area within a 15 km radius of coordinates decimal degrees -35.99185 South and 145.60681 East, excluding the Muckatah, South Cobram Outbreak Area.
O372	Lockharts Road, Goodnight, NSW	
	The area within a 1.5 km radius of the coordinates decimal degrees -34.96676 South and 143.33529 East (“the Lockharts Road, Goodnight Outbreak Area”).	The area within a 15 km radius of coordinates decimal degrees -34.96676 South and 143.33529 East, excluding the Lockharts Road, Goodnight Outbreak Area.
O373	Murray Valley Hwy, Strathmerton, Vic	
	The area within a 1.5 km radius of the coordinates decimal degrees -35.92475 South and 145.47952 East (“the Murray Valley Hwy, Strathmerton Outbreak Area”).	The area within a 15 km radius of coordinates decimal degrees -35.92475 South and 145.47952 East, excluding the Murray Valley Hwy, Strathmerton Outbreak Area.

<i>Item</i>	<i>Column 1 Outbreak Area</i>	<i>Column 2 Suspension Area</i>
O374	Broken Hill NTN 4057, NSW	
	The area within a 1.5 km radius of the coordinates decimal degrees -31.9667978 South and 141.4417807 East ("the Broken Hill NTN 4057 Outbreak Area").	The area within a 15 km radius of coordinates decimal degrees -31.9667978 South and 141.4417807 East, excluding the Broken Hill NTN 4057 Outbreak Area.
O376	Darlington Point NTN 2577, NSW	
	The area within a 1.5 km radius of the coordinates decimal degrees -34.5678 South and 146.007917 East ("the Darlington Point NTN 2577 Outbreak Area").	The area within a 15 km radius of coordinates decimal degrees -34.5678 South and 146.007917 East, excluding the Darlington Point NTN 2577 Outbreak Area.
O377	Corbie Hill NTN 2476, NSW	
	The area within a 1.5 km radius of the coordinates decimal degrees -34.5693 South and 146.448683 East ("the Corbie Hill NTN 2476 Outbreak Area").	The area within a 15 km radius of coordinates decimal degrees -34.5693 South and 146.448683 East, excluding the Corbie Hill NTN 2476 Outbreak Area.
O378	Pevensey Place, Echuca, Vic	
	The area within a 1.5 km radius of the coordinates decimal degrees -36.13605 South and 144.73233 East ("the Pevensey Place, Echuca Outbreak Area").	The area within a 15 km radius of coordinates decimal degrees -36.13605 South and 144.73233 East, excluding the Pevensey Place, Echuca Outbreak Area.
O379	Chester Street, Barham, NSW	
	The area within a 1.5 km radius of the coordinates decimal degrees -35.63273 South and 144.13378 East ("the Chester Street, Barham Outbreak Area").	The area within a 15 km radius of coordinates decimal degrees -35.63273 South and 144.13378 East, excluding the Chester Street, Barham Outbreak Area.
O381	Deniliquin, NSW	
	The area within a 1.5 km radius of the coordinates decimal degrees -35.527468 South and 144.970742 East ("the Deniliquin Outbreak Area").	The area within a 15 km radius of coordinates decimal degrees -35.527468 South and 144.970742 East, excluding the Deniliquin Outbreak Area.
O382	Rutherglen, Vic	
	The area within a 1.5 km radius of the coordinates decimal degrees -36.056888 South and 146.463611 East ("the Rutherglen Outbreak Area").	The area within a 15 km radius of coordinates decimal degrees -36.056888 South and 146.463611 East, excluding the Rutherglen Outbreak Area.
O383	Corowa, NSW	
	The area within a 1.5 km radius of the coordinates decimal degrees -36.001100 South and 146.384600 East ("the Corowa Outbreak Area").	The area within a 15 km radius of coordinates decimal degrees -36.001100 South and 146.384600 East, excluding the Corowa Outbreak Area.
O386	Pooley Street, Buronga, NSW	
	The area within a 1.5 km radius of the coordinates decimal degrees -34.16898 South and 142.18479 East ("the Pooley Street, Buronga Outbreak Area").	The area within a 15 km radius of coordinates decimal degrees -34.16898 South and 142.18479 East, excluding the Pooley Street, Buronga Outbreak Area.
O387	Boynton Lane, Balranald, NSW	
	The area within a 1.5 km radius of the coordinates decimal degrees -34.63696 South and 143.5573 East ("the Boynton Lane, Balranald Outbreak Area").	The area within a 15 km radius of coordinates decimal degrees -34.63696 South and 143.5573 East, excluding the Boynton Lane, Balranald Outbreak Area.
O388	Wakool Junction Road, Goodnight North, NSW	
	The area within a 1.5 km radius of the coordinates decimal degrees -34.9332099 South and 143.3441534 East ("the Wakool Junction Road, Goodnight North Outbreak Area").	The area within a 15 km radius of coordinates decimal degrees -34.9332099 South and 143.3441534 East, excluding the Wakool Junction Road, Goodnight North Outbreak Area.

<i>Item</i>	<i>Column 1 Outbreak Area</i>	<i>Column 2 Suspension Area</i>
O389	Little Forest Lane, Barham East, NSW	
	The area within a 1.5 km radius of the coordinates decimal degrees -35.643103 South and 144.167898 East (“the Little Forest Lane, Barham East Outbreak Area”).	The area within a 15 km radius of coordinates decimal degrees -35.643103 South and 144.167898 East, excluding the Little Forest Lane, Barham East Outbreak Area.
O391	Campbell Street, Swan Hill, Vic	
	The area within a 1.5 km radius of the coordinates decimal degrees -35.352436 South and 143.555952 East (“the Campbell Street, Swan Hill Outbreak Area”).	The area within a 15 km radius of coordinates decimal degrees -35.352436 South and 143.555952 East, excluding the Campbell Street, Swan Hill Outbreak Area.
O393	Darlington Point NTN 2582, NSW	
	The area within a 1.5 km radius of the coordinates decimal degrees -34.616900 South and 145.903767 East (“the Darlington Point NTN 2582 Outbreak Area”).	The area within a 15 km radius of coordinates decimal degrees -34.616900 South and 145.903767 East, excluding the Darlington Point NTN 2582 Outbreak Area.
O394	Kockart Road, Goodnight, NSW	
	The area within a 1.5 km radius of the coordinates decimal degrees -34.991020 South and 143.329390 East (“the Kockart Road, Goodnight Outbreak Area”).	The area within a 15 km radius of coordinates decimal degrees -34.991020 South and 143.329390 East, excluding the Kockart Road, Goodnight Outbreak Area.
O395	Grong Grong NTN 2565, NSW	
	The area within a 1.5 km radius of the coordinates decimal degrees -34.737800 South and 146.783600 East (“the Grong Grong NTN 2565 Outbreak Area”).	The area within a 15 km radius of coordinates decimal degrees -34.737800 South and 146.783600 East, excluding the Grong Grong NTN 2565 Outbreak Area.
O397	Ivanhoe Road, Menindee, NSW	
	The area within a 1.5 km radius of the coordinates decimal degrees -32.399620 South and 142.434550 East (“the Ivanhoe Road, Menindee Outbreak Area”).	The area within a 15 km radius of coordinates decimal degrees -32.399620 South and 142.434550 East, excluding the Ivanhoe Road, Menindee Outbreak Area.
O398	Wentworth Road, Menindee, NSW	
	The area within a 1.5 km radius of the coordinates decimal degrees -32.398900 South and 142.412900 East (“the Wentworth Road, Menindee Outbreak Area”).	The area within a 15 km radius of coordinates decimal degrees -32.398900 South and 142.412900 East, excluding the Wentworth Road, Menindee Outbreak Area.
O400	River Road, Murrabit, Vic	
	The area within a 1.5 km radius of the coordinates decimal degrees -35.504460 South and 143.961320 East (“the River Road, Murrabit Outbreak Area”).	The area within a 15 km radius of coordinates decimal degrees -35.504460 South and 143.961320 East, excluding the River Road, Murrabit Outbreak Area.
O402	Hillston NTN 2320, NSW	
	The area within a 1.5 km radius of the coordinates decimal degrees -33.358284 South and 145.683155 East (“the Hillston NTN 2320 Outbreak Area”).	The area within a 15 km radius of coordinates decimal degrees -33.358284 South and 145.683155 East, excluding the Hillston NTN 2320 Outbreak Area.
O403	Darlington Point NTN 2596, NSW	
	The area within a 1.5 km radius of the coordinates decimal degrees -34.696233 South and 146.029983 East (“the Darlington Point NTN 2596 Outbreak Area”).	The area within a 15 km radius of coordinates decimal degrees -34.696233 South and 146.029983 East, excluding the Darlington Point NTN 2596 Outbreak Area.

<i>Item</i>	<i>Column 1 Outbreak Area</i>	<i>Column 2 Suspension Area</i>
O407	Darlington Point NTN 2583, NSW	
	The area within a 1.5 km radius of the coordinates decimal degrees -34.621450 South and 146.030067 East (“the Darlington Point NTN 2583 Outbreak Area”).	The area within a 15 km radius of coordinates decimal degrees -34.621450 South and 146.030067 East, excluding the Darlington Point NTN 2583 Outbreak Area.
O410	Euroly, NSW	
	The area within a 1.5 km radius of the coordinates decimal degrees -34.692963 South and 146.397629 East (“the Euroly Outbreak Area”).	The area within a 15 km radius of coordinates decimal degrees -34.692963 South and 146.397629 East, excluding the Euroly Outbreak Area.
O412	Menindee North, NSW	
	The area within a 1.5 km radius of the coordinates decimal degrees -32.3429887 South and 142.4396719 East (“the Menindee North Outbreak Area”).	The area within a 15 km radius of coordinates decimal degrees -32.3429887 South and 142.4396719 East, excluding the Menindee North Outbreak Area.
O414	Darlington Point NTN 2581, NSW	
	The area within a 1.5 km radius of the coordinates decimal degrees -34.613283 South and 145.827533 East (“the Darlington Point NTN 2581 Outbreak Area”).	The area within a 15 km radius of coordinates decimal degrees -34.613283 South and 145.827533 East, excluding the Darlington Point NTN 2581 Outbreak Area.
O415	Mathoura NTN 4851, NSW	
	The area within a 1.5 km radius of the coordinates decimal degrees -35.818733 South and 144.904983 East (“the Mathoura NTN 4851 Outbreak Area”).	The area within a 15 km radius of coordinates decimal degrees -35.818733 South and 144.904983 East, excluding the Mathoura NTN 4851 Outbreak Area.
O416	Augustine Road, Cohuna, Vic	
	The area within a 1.5 km radius of the coordinates decimal degrees -35.800610 South and 144.216010 East (“the Augustine Road, Cohuna Outbreak Area”).	The area within a 15 km radius of coordinates decimal degrees -35.800610 South and 144.216010 East, excluding the Augustine Road, Cohuna Outbreak Area.
O419	Darlington Point NTN 2597, NSW	
	The area within a 1.5 km radius of the coordinates decimal degrees -34.713467 South and 146.022883 East (“the Darlington Point NTN 2597 Outbreak Area”).	The area within a 15 km radius of coordinates decimal degrees -34.713467 South and 146.022883 East, excluding the Darlington Point NTN 2597 Outbreak Area.
O420	Fisher Drive, Narrung, Vic	
	The area within a 1.5 km radius of the coordinates decimal degrees -34.780190 South and 143.249360 East (“the Fisher Drive, Narrung Outbreak Area”).	The area within a 15 km radius of coordinates decimal degrees -34.780190 South and 143.249360 East, excluding the Fisher Drive, Narrung Outbreak Area.
O421	Murray Valley Highway, Boundary Bend West, Vic	
	The area within a 1.5 km radius of the coordinates decimal degrees -34.707720 South and 143.075990 East (“the Murray Valley Highway, Boundary Bend West Outbreak Area”).	The area within a 15 km radius of coordinates decimal degrees -34.707720 South and 143.075990 East, excluding the Murray Valley Highway, Boundary Bend West Outbreak Area.
O422	Cadell and Scott Street, Tooleybuc Town, NSW	
	The area within a 1.5 km radius of the coordinates decimal degrees -35.0293923 South and 143.3375838 East (“the Cadell and Scott Street, Tooleybuc Town Outbreak Area”).	The area within a 15 km radius of coordinates decimal degrees -35.0293923 South and 143.3375838 East, excluding the Cadell and Scott Street, Tooleybuc Town Outbreak Area.

<i>Item</i>	<i>Column 1 Outbreak Area</i>	<i>Column 2 Suspension Area</i>
O423	Goodnight Road, Goodnight North, NSW	
	The area within a 1.5 km radius of the coordinates decimal degrees -34.9094929 South and 143.3422788 East (“the Goodnight Road, Goodnight North Outbreak Area”).	The area within a 15 km radius of coordinates decimal degrees -34.9094929 South and 143.3422788 East, excluding the Goodnight Road, Goodnight North Outbreak Area.

SCHEDULE 5 – Exceptions for movement of host fruit

Host fruit that has received an approved treatment or that has been grown and packed in accordance with an approved systems approach

Movement of host fruit that has, prior to movement, received an approved treatment or that has been grown and packed in accordance with an approved systems approach, subject to the following conditions:

- (a) The owner or occupier of the property or facility from which the host fruit originates must ensure the host fruit remains under secure conditions which prevent infestation by Queensland fruit fly, from post harvest to the time of dispatch and transport; and
- (b) Prior to movement, the owner or occupier of the property or facility where the host fruit is packed must ensure that:
 - (i) any used packaging or coverings containing host fruit are free of soil, plant residues and other organic matter; and
 - (ii) in the case of host fruit that has been consigned:
 - (A) as a lot for the purpose of producing smaller packs of host fruit and has been repacked in smaller packs; or
 - (B) as a packed lot for the purpose of producing composite lots, the host fruit has been received, handled, stored and repacked under secure conditions which prevent infestation by Queensland fruit fly; and
 - (iii) any individual package contains only one kind of host fruit; and
 - (iv) all previous incorrect information displayed on the outer covering of the package is removed and the outer covering is legibly marked with the following information:
 - (A) the district of production; and
 - (B) the name, address, postcode and the State or Territory of both the grower and the packer; or where the packer is sourcing from multiple growers, the name, address, postcode and the State or Territory of the packer; and
 - (C) a brief description of the contents of the package; or
 - (v) where the property or facility is owned or occupied by a business accredited under a Certification Assurance Arrangement, the host fruit is packed and labelled in accordance with the Certification Assurance Arrangement.

SCHEDULE 6 – Approved treatments for host fruit

1 Definitions

In this Schedule:

hard condition, in the case of avocados, means the flesh is not soft or softening, the skin is not cracked and there is no unbroken skin.

hard green condition, in the case of bananas, means the fruit is hard and green, with no sign of colouration when assessed over the entire surface area and there is no unbroken skin.

immature green condition, in the case of babaco and papaya (excluding defective flower-end type papaya), means the fruit is hard and green and has no ripe colouration.

mature green condition, in the case of:

- (a) babaco and papaya (excluding defective flower-end type papaya), means the fruit is hard and has no more than 25 % of ripe colouring at the time of packing.
- (b) bananas, means the flesh is hard and not flexible, the skin is green and shows no yellow colouration except for areas towards the flower end of a fruit where the sun has bleached the skin but the flesh beneath is still hard, and has no pre-harvest cracks, splits, punctures or other breaks that penetrate through to the flesh.
- (c) black sapote, means the skin is free from any black colouring and there is no unbroken skin.
- (d) passionfruit, means the skin is smooth and unwrinkled and there is no unbroken skin.
- (e) Tahitian lime, means the skin has no yellow colouration and there is no unbroken skin.

unbroken skin means the skin has no pre-harvest cracks, punctures, pulled stems or other breaks which penetrate through the skin and that have not healed with callus tissue.

2 Dimethoate Dip

- (1) Assorted tropical and sub-tropical fruits – inedible peel (excluding black sapote, breadfruit, jackfruit, longan, defective flower-end type papaya, mango, persimmon, custard apple, cherimoya, soursop, sweetsop and other *Annona* spp.), abiu, chilli, rollinia, santol and tamarillo:
 - (a) treated postharvest by full immersion in a dip containing 400 mg/L dimethoate for:
 - (i) a period of 1 minute; or
 - (ii) in the case of passionfruit, dipping for a period of 10 seconds provided the fruit remains wet for a further 60 seconds; and
 - (b) dipping must be the final treatment before packing.
- (2) Citrus fruits:
 - (a) treated postharvest by full immersion in a dip containing 400 mg/L dimethoate for a period of 1 minute; and
 - (b) dipping must be the final treatment before packing, except where a non-recovery gloss coating (wax) and/or compatible fungicide may be added within 24 hours of treatment.
- (3) Mangoes (Kensington Pride, Calypso, R2E2 and Honey Gold varieties only):
 - (a) a sample of the lot inspected before treatment and found free of Queensland fruit fly larvae; and
 - (b) treated postharvest by full immersion in a dip containing 400 mg/L dimethoate for a period of 1 minute; and
 - (c) dipping must be the final treatment before packing.

Note: The procedure under an approved Certification Assurance Arrangement is ICA-01 Dipping with dimethoate or fenthion.

3 Dimethoate Flood Spray

- (1) Assorted tropical and sub-tropical fruits – inedible peel (excluding black sapote, breadfruit, jackfruit, longan, defective flower-end type papaya, mango, persimmon, custard apple, cherimoya, soursop, sweetsop and other *Annona* spp.), abiu, rollinia, santol and tamarillo:
 - (a) treated postharvest by flood spraying in a single layer with a mixture containing 400 mg/L dimethoate at a rate of at least 16 L/minute/m² of the area being flood sprayed, providing complete coverage of the fruit for a minimum of 10 seconds after which the fruit must remain wet for a further 60 seconds; and
 - (b) spraying must be the final treatment before packing.
- (2) Citrus fruits:
 - (a) treated postharvest by flood spraying in a single layer with a mixture containing 400 mg/L dimethoate at a rate of at least 16 L/minute/m² of the area being flood sprayed, providing complete coverage of the fruit for a minimum of 10 seconds after which the fruit must remain wet for a further 60 seconds; and
 - (b) spraying must be the final treatment before packing, except where a non-recovery gloss coating (wax) and/or compatible fungicide may be added within 24 hours of treatment.
- (3) Mangoes (Kensington Pride, Calypso, R2E2 and Honey Gold varieties only):
 - (a) a sample of the lot is inspected before treatment and found free of Queensland fruit fly larvae; and
 - (b) treated postharvest by flood spraying in a single layer with a mixture containing 400 mg/L dimethoate with a rate of at least 16 L/minute/m² of the area being flood sprayed, providing complete coverage of the fruit for a minimum of 10 seconds after which the fruit must remain wet for a further 60 seconds; and
 - (c) spraying must be the final treatment before packing.

Note: The procedure under an approved Certification Assurance Arrangement is ICA-02 Flood spraying with dimethoate or fenthion.

4 Fenthion Dip

- (1) Assorted tropical and sub-tropical fruits – inedible peel (excluding caimito, mango, persimmon, custard apple, cherimoya, soursop, sweetsop and other *Annona* spp. and defective flower-end type papaya):
 - (a) treated postharvest by full immersion in a dip containing 412.5 mg/L fenthion for:
 - (i) a period of 1 minute; or
 - (ii) in the case of longan, lychee, passionfruit and rambutan, dipping for a period of 10 seconds provided the fruit remains wet for a further 60 seconds; and
 - (b) dipping must be the final treatment before packing.
- (2) Chilli (excluding hollow fruited chilli):
 - (a) treated postharvest by full immersion in a dip containing 412.5 mg/L fenthion for a period of 1 minute; and
 - (b) dipping must be the final treatment before packing.
- (3) Mangoes (Kensington Pride, Calypso, R2E2 and Honey Gold varieties only):
 - (a) a sample of the lot inspected before treatment and found free of Queensland fruit fly larvae; and
 - (b) treated postharvest by full immersion in a dip containing 412.5 mg/L fenthion for a period of 1 minute; and

- (c) dipping must be the final treatment before packing.

Note: The procedure under an approved Certification Assurance Arrangement is ICA-01 Dipping with dimethoate or fenthion.

5 Fenthion Flood Spray

- (1) Assorted tropical and sub-tropical fruits – inedible peel (excluding mango, persimmon, custard apple, cherimoya, soursop, sweetsop and other *Annona* spp. and defective flower-end type papaya) and chilli:
- treated postharvest by flood spraying, in a single layer with a mixture containing 412.5 mg/L fenthion at a rate of at least 16 L/minute/m² of the area being flood sprayed, providing complete coverage of the host fruit for a minimum of 10 seconds after which the host fruit must remain wet for a further 60 seconds; and
 - spraying must be the final treatment before packing.
- (2) Mangoes (Kensington Pride, Calypso, R2E2 and Honey Gold varieties only):
- a sample of the lot inspected before treatment and found free of Queensland fruit fly larvae; and
 - treated postharvest by flood spraying in a single layer with a mixture containing 412.5 mg/L fenthion at a rate of at least 16 L/minute/m² of the area being flood sprayed, providing complete coverage of the host fruit for a minimum of 10 seconds after which the host fruit must remain wet for a further 60 seconds; and
 - spraying must be the final treatment before packing.

Note: The procedure under an approved Certification Assurance Arrangement is ICA-02 Flood spraying with dimethoate or fenthion.

6 Fenthion Non-Recirculating Spray

- (1) Avocados treated in a single layer non-recirculating system with a mixture containing 412.5 mg/L fenthion at a rate of at least 0.6 L/minute/m², providing complete coverage of the host fruit for a minimum of 10 seconds after which the host fruit must remain wet for a further 60 seconds.
- (2) Mangoes (Kensington Pride, Calypso, R2E2 and Honey Gold varieties only):
- a sample of the lot inspected before treatment and found free of Queensland fruit fly larvae; and
 - treated in a single layer non-recirculating system with a mixture containing 412.5 mg/L fenthion at a rate of at least 1.2 L/minute/m², providing complete coverage of the host fruit for a minimum of 10 seconds after which the host fruit must remain wet for a further 60 seconds.

Note: The procedure under an approved Certification Assurance Arrangement is ICA-03 Low volume non-recirculated spraying with fenthion.

7 Methyl Bromide Fumigation

- (1) Any host fruit:
- fumigated postharvest with a fumigant containing 1000 g/kg methyl bromide as its only active constituent for 2 hours at the following rates:
 - 10.0°C – 14.9°C at 48 g/m³; or
 - 15.0°C – 20.9°C at 40 g/m³; or
 - 21.0°C + at 32 g/m³; and
 - in the case of defective flower end-type papaya, is in a mature green condition.
- (2) In this clause:

mature green condition means the fruit is hard and has no more than 25% ripe colouring at the time of packing.

Note: The procedure under an approved Certification Assurance Arrangement is ICA-04 Fumigating with methyl bromide.

8 Postharvest Cold Treatment

- (1) Any host fruit (excluding lemons), treated postharvest at a temperature of:
- 0°C ± 0.5°C for a minimum of 14 days; or
 - 1.0°C ± 0.5°C to 3.0°C ± 0.5°C for a minimum of 16 days.
- (2) Lemons treated post harvest at a temperature of 0.0°C ± 0.5°C to 3.0°C ± 0.5°C for a minimum of 14 days.

Note: The procedure under an approved Certification Assurance Arrangement is ICA-07 Cold treatment.

9 Hot Water Treatment

Mangoes treated by full immersion in hot water at a temperature of 46.0°C for a minimum of 10 minutes, as measured in the water and at or as near as practicable to the seed of 3 fruits.

Note: The procedure under an approved Certification Assurance Arrangement is ICA-10 Hot water treatment of mangoes.

10 High Temperature Forced Air

Papaya treated in a hot air chamber, at a temperature of 47.2°C for at least 3.5 hours as measured in the seed cavity.

11 Vapour Heat Treatment

Mangoes treated by vapour heat at a temperature of:

- (a) 46.5°C for 20 minutes; or
- (b) 47.0°C for 15 minutes.

Note: The procedure under an approved Certification Assurance Arrangement is ICA-05 Vapour heat treatment of mangoes under AQIS supervision.

12 Gamma Irradiation

Any host fruit approved for irradiation by the Food Standards Australia New Zealand (FSANZ) treated post harvest with gamma irradiation at a minimum dose of 150Gy.

Note: The procedure under an approved Certification Assurance Arrangement is ICA-55 Irradiation treatment.

13 Mature green condition

(1) Black sapote, passionfruit and Tahitian lime harvested and packed in a mature green condition.

Note: The procedure under an approved Certification Assurance Arrangement is ICA-15 Mature green condition of passionfruit, Tahitian limes and black sapotes.

(2) Banana harvested and packed in a mature green condition.

Note: The procedure under an approved Certification Assurance Arrangement is ICA-16 Certification of mature green condition of bananas.

14 Immature green condition

Papaya (excluding defective flower-end type papaya) and babaco harvested and packed in an immature green condition.

Note: The procedure under an approved Certification Assurance Arrangement is ICA-08 Mature green condition and immature green condition of papaw and babaco.

15 Hard green condition

Bananas (Cavendish variety only) in a hard green condition at the time of packing.

Note: The procedure under an approved Certification Assurance Arrangement is ICA-06 Certification of hard green bananas.

16 Hard condition

Avocados (Hass and Lamb Hass cultivars only) harvested in a hard condition and stored in secured conditions within 24 hours of harvest.

Note: The procedure under an approved Certification Assurance Arrangement is ICA-30 Hard condition of avocado for Mediterranean fruit fly and Queensland fruit fly.

17 Unbroken skins

Durian, jaboticaba, jackfruit, longan, lychee, mangosteen, pomegranate and rambutan harvested and packed with unbroken skin.

Note: The procedure under an approved certification assurance arrangement is ICA-13 Unbroken skin condition of approved fruits.”

SCHEDULE 7 – Approved systems approaches for host fruit

1 Pre-harvest treatment and postharvest inspection

(1) Capsicum and chilli:

(a) treated pre-harvest with:

- (i) dimethoate in accordance with all label and APVMA permit directions for the in-field control of Queensland fruit fly; or
- (ii) a program of cover sprays with a chemical containing 500 g/L trichlorfon or 440 g/L maldison (capsicum only) applied a minimum of 21 days prior to harvest in accordance with all label and APVMA permit directions for the control of Queensland fruit fly; or
- (iii) for capsicum only, grown in Queensland or the Northern Territory and treated with a program of fenthion cover sprays in accordance with all label and APVMA permit directions for the control of Queensland fruit fly; and

(b) inspected postharvest, where a sample of the lot is inspected and found free of Queensland fruit fly.

Note: The procedure under an approved Certification Assurance Arrangement is ICA-26 Pre-harvest treatment and postharvest inspection of tomatoes, capsicums, chillies and eggplant.

(2) Eggplant and tomato:

- (a) treated pre-harvest with a program of cover sprays with a chemical containing 500 g/L trichlorfon applied a minimum of 21 days prior to harvest in accordance with all label and APVMA permit directions for the control of Queensland fruit fly; and

(b) inspected postharvest, where a sample of the lot is inspected and found free of Queensland fruit fly.

Note: The procedure under an approved Certification Assurance Arrangement is ICA-26 Pre-harvest treatment and postharvest inspection of tomatoes, capsicums, chillies and eggplant.

(3) Tomato:

(a) treated pre-harvest with a program of cover sprays with a chemical containing 500 g/L trichlorfon applied a minimum of 21 days prior to harvest in accordance with all label and APVMA permit directions for the control of Queensland fruit fly; and

(b) harvested and packed in a mature green condition.

(c) In subclause (3) (b):

mature green condition means the tomato has no more than a 2 cm diameter area of pink to red colour at the stylar end at the time of colour sorting after harvest.

Note: The procedure under an approved Certification Assurance Arrangement is ICA-27 Mature green condition of tomatoes.

(4) Blueberry:

(a) treated pre-harvest with a program of cover sprays with a chemical containing:

(i) 400 g/L dimethoate; or

(ii) 500 g/L trichlorfon; or

(iii) 440 g/L maldison,

in accordance with all label and APVMA permit directions for the control of Queensland fruit fly; and

(b) sampled and inspected postharvest and found free of Queensland fruit fly larvae.

Note: The procedure under an approved Certification Assurance Arrangement is ICA-21 Pre-harvest treatment and inspection of stonefruit, blueberries, persimmon and pomefruit.

(5) Stonefruit (except cherries):

(a) treated pre-harvest with a program of cover sprays with a chemical containing:

(i) 500 g/L trichlorfon; or

(ii) 440 g/L maldison,

in accordance with all label directions for the control of Queensland fruit fly; or

(b) treated pre-harvest with a program of cover sprays with a chemical containing 550 g/L fenthion and followed with at least two (2) cover sprays with a chemical containing:

(i) 500 g/L trichlorfon; or

(ii) 440 g/L maldison,

in accordance with all label directions for the control of Queensland fruit fly; and

(c) inspected postharvest at the rate of 1 package in every 100 and found free of Queensland fruit fly larvae and free of broken skins.

Note: The procedure under an approved Certification Assurance Arrangement is ICA-21 Pre-harvest treatment and inspection of stonefruit, blueberries, persimmon and pomefruit.

(6) Cherries:

(a) treated pre-harvest with a program of cover sprays with a chemical containing:

(i) 500 g/L trichlorfon; or

(ii) 440 g/L maldison,

in accordance with all label directions for the control of Queensland fruit fly; and

(b) inspected postharvest at the rate of 1 package in every 100 and found free of Queensland fruit fly larvae and free of broken skins.

Note: The procedure under an approved Certification Assurance Arrangement is ICA-21 Pre-harvest treatment and inspection of stonefruit, blueberries, persimmon and pomefruit.

(7) Persimmon and pomefruit:

(a) treated pre-harvest with a program of cover sprays with a chemical containing 500 g/L trichlorfon in accordance with all label directions for the control of Queensland fruit fly; and

(b) inspected postharvest at the rate of 1 package in every 100 and found free of Queensland fruit fly larvae and free of broken skins.

Note: The procedure under an approved Certification Assurance Arrangement is ICA-21 Pre-harvest treatment and inspection of stonefruit, blueberries, persimmon and pomefruit.

- (8) Table grape:
- (a) treated pre-harvest with a program of:
 - (i) bait sprays applied to every alternate row of vines at the rate of at least 100 mL per 8 m of vine, at a maximum interval of 7 days commencing 6 weeks prior to harvest to the completion of harvest with:
 - (A) an insecticide containing 15.4 L of 0.24 g/L spinosad per 100 L of water; or
 - (B) a mixture containing 2 L yeast autolysate protein and 435 mL of 1150 g/L maldison per 100 L of water; or
 - (ii) cover sprays applied to all vines with a chemical containing:
 - (A) 500 g/L trichlorfon; or
 - (B) 440 g/L maldison; or
 - (C) 550 g/L fenthion followed with at least three (3) cover sprays with a chemical containing 500 g/L trichlorfon or 440 g/L maldison,
in accordance with all label and APVMA permit directions for the control of Queensland fruit fly; or
 - (b) treated with a combined program of bait sprays and cover sprays applied in accordance with all the requirements of (i) and (ii) above, at intervals determined by the type of spray in the most recent application; and
 - (c) inspected postharvest where a sample of the fruit is inspected and found free of Queensland fruit fly larvae.

Note: The procedure under an approved Certification Assurance Arrangement is ICA-20 Pre-harvest treatment and inspection of grapes.

- (9) Strawberries grown in south east Queensland:
- (a) treated with a program of Male Annihilation Technique (MAT) devices placed on the perimeter of the source property at 20 metre intervals; and
 - (b) treated with a program of bait sprays using a mixture of 15.4 L of 0.24 g/L spinosad per 100 L of water in accordance with all label requirements:
 - (i) at a rate of 1 litre per hectare applied to the perimeter of all strawberry blocks on the source property; and
 - (ii) at a maximum interval of 7 days commencing from:
 - (A) the time of planting; or
 - (B) in the case of ratoon crops (being the second or later crops taken from the regrowth of a crop after it has been harvested once) – 1 May; and
 - (iii) applied to the strawberry blocks until:
 - (A) the completion of harvest of all strawberries from the source property; or
 - (B) all strawberries have been removed from the block; or
 - (C) all strawberry plants have been sprayed out or removed from the block; or
 - (D) the pre-harvest cover spray program specified in clause 1 (9) (c) has commenced; and
 - (c) treated with a program of cover sprays applied to each block of strawberries grown on the property at an interval of every 7 to 10 days, commencing prior to 10 August until the completion of harvest:
 - (i) with a chemical containing:
 - (A) 500 g/L trichlorfon; or
 - (B) 440 g/L maldison; or
 - (C) 1000 g/L maldison; or
 - (D) 1150 g/L maldison,
in accordance with all APVMA permit directions for the control of Queensland fruit fly; or
 - (ii) with:
 - (A) a chemical containing 120 g/L spinetoram applied at the maximum rate of 400 mL per hectare of plants and in accordance with APVMA permit and label directions; and
 - (B) a program of bait sprays applied in accordance with clause 1 (9) (b); and
 - (d) grown under a field hygiene program including:
 - (i) the disposal of infested or untreated fruit; and
 - (ii) the management of abandoned or spent strawberry blocks,
in a manner generally accepted as likely to prevent the spread of Queensland fruit fly; and
 - (e) inspected during harvest and postharvest in accordance with the specifications of ICA-34 Pre-harvest field control and inspection of strawberries and found free from live Queensland fruit fly infestation.

Note: The procedure under an approved Certification Assurance Arrangement is ICA-34 Pre-harvest field control and inspection of strawberries.

2 Pre-harvest treatment and inspection, and post harvest treatment

(1) Custard apple, cherimoya, soursop, sweetsop and other *Annona* spp:

- (a) treated pre-harvest with a program of:
 - (i) cover sprays applied to all host fruit trees at a maximum interval of 14 days commencing 6 weeks prior to harvest to the completion of harvest with a mixture containing:
 - (A) 75 mL of 550 g/L fenthion per 100 L of mixture; or
 - (B) 75 mL of 400 g/L dimethoate per 100 L of mixture; or
 - (ii) bait sprays applied at the rate of at least 100 mL to all host fruit trees at a maximum interval of 7 days commencing 6 weeks prior to harvest to the completion of harvest with a mixture containing:
 - (A) 2 L yeast autolysate protein and 435 mL of 1150 g/L maldison per 100 L of water; or
 - (B) 2 L yeast autolysate protein and 780 mL of 500 g/L trichlorfon per 100 L of water; or
 - (C) 15.4 L of 0.24 g/L spinosad per 100 L of water; and
- (b) inspected postharvest where a sample of the lot is inspected and found free of Queensland fruit fly larvae and free of broken skins; and
- (c) treated postharvest (final treatment before packing):
 - (i) by full immersion for a period of 1 minute in a dip containing:
 - (A) 400 mg/L dimethoate; or
 - (B) 412.5 mg/L fenthion; or
 - (ii) by flood spraying in a single layer at a rate of at least 16 L/minute/m² of the area being flood sprayed, providing complete coverage of the fruit for a minimum of 10 seconds after which the fruit must remain wet for a further 60 seconds with a mixture containing:
 - (A) 400 mg/L dimethoate; or
 - (B) 412.5 mg/L fenthion.

Note: The procedure under an approved Certification Assurance Arrangement is ICA-18 Treatment and inspection of custard apple and other *Annona* spp., in conjunction with ICA-01 Dipping with dimethoate or fenthion or ICA-02 Flood spraying with dimethoate or fenthion.

(2) Mangoes (excluding Kensington Pride, Calypso, R2E2 and Honey Gold varieties):

- (a) treated pre-harvest with a program of:
 - (i) cover sprays applied to all host fruit trees at a maximum interval of 14 days commencing 6 weeks prior to harvest to the completion of harvest with a mixture containing:
 - (A) 75 mL of 550 g/L fenthion per 100 L of mixture; or
 - (B) 75 mL of 400 g/L dimethoate per 100 L of mixture; or
 - (ii) bait sprays applied at the rate of at least 100 mL to all host fruit trees at a maximum interval of 7 days commencing 6 weeks prior to harvest to the completion of harvest with a mixture containing:
 - (A) 15.4 L of 0.24 g/L spinosad per 100 L of water; or
 - (B) 2 L yeast autolysate protein and 435 mL of 1150 g/L maldison per 100 L of water; and
- (b) inspected postharvest where a sample of the lot is inspected and found free of Queensland fruit fly larvae; and
- (c) treated postharvest (final treatment prior to packing):
 - (i) by full immersion for a period of 1 minute in a dip containing:
 - (A) 400 mg/L dimethoate; or
 - (B) 412.5 mg/L fenthion; or
 - (ii) by flood spraying in a single layer at a rate of at least 16 L/minute/m² of the area being flood sprayed, providing complete coverage of the fruit for a minimum of 10 seconds after which the fruit must remain wet for a further 60 seconds with a mixture containing:
 - (A) 400 mg/L dimethoate; or
 - (B) 412.5 mg/L fenthion,
 - (iii) in a single layer non-recirculating system with a mixture containing 412.5 mg/L fenthion at a rate of at least 1.2 L/minute/m², providing complete coverage of the host fruit for a minimum of 10 seconds after which the host fruit must remain wet for a further 60 seconds.

Note: The procedure under an approved Certification Assurance Arrangement is ICA-19 Treatment and inspection of mangoes, in conjunction with ICA-01 Dipping with dimethoate or fenthion or ICA-02 Flood spraying with dimethoate or fenthion or ICA-03 Low volume non-recirculated spraying with fenthion.

3 Fruit fly monitoring, pre-harvest baiting, and postharvest inspection

(1) Citrus fruits (excluding Meyer lemons) grown in Queensland, west of the coastal ranges and south of latitude 22 south and harvested during the period 1 March to 25 August inclusive:

- (a) treated with a program of bait sprays applied to all host fruit trees in accordance with all label requirements at a maximum interval of 7 days commencing 12 weeks prior to harvest to the completion of harvest with:
 - (i) a mixture containing 2 L yeast autoylsate protein; and
 - (A) 435 mL of 1150 g/L maldison per 100 L of water; or

- (B) 400 g of 500 g/kg chlorpyrifos per 100 L of water; or
- (C) 400 mL of 500 g/L chlorpyrifos per 100 L of water; or
- (D) 780 mL of 500 g/L trichlorofon per 100 L of water; or
- (ii) a mixture containing 15.4 L of spinosad per 100 L of water; and
- (b) treated with a program of Queensland fruit fly trapping and monitoring using at least 2 Lynfield or approved equivalent traps, placed so that every tree within the orchard is within 400 m of a trap, which are inspected at least every 7 days and found free of Queensland fruit flies; and
- (c) inspected postharvest where a sample of the lot is inspected after packing and found free of Queensland fruit fly larvae.

Note: The procedure under an approved Certification Assurance Arrangement is ICA-28 Pre-harvest treatment (bait spraying) and inspection of citrus.

- (2) Host fruit grown and packed within a suspension area (excluding an outbreak area) which is under an active eradication program:
- (a) treated with a program of Queensland fruit fly trapping and monitoring with at least one Queensland fruit fly trap installed on the property, monitored in accordance with the Code of Practice for the Management of Queensland fruit fly; and
 - (b) treated with a program of bait sprays applied:
 - (i) a minimum of 2 weeks prior to harvest to the completion of harvest; and
 - (ii) to all host fruit trees with fruit at a stage susceptible to Queensland fruit fly (unless receiving an alternative program of cover sprays), and
 - (iii) in accordance with all label and APVMA permit directions; and
 - (iv) with a mixture containing:
 - (A) 435 mL of 1150 g/L maldison with 2 litres of yeast autolysate protein lure per 100 litres of water; or
 - (B) 15.4 L of 0.24 g/L spinosad per 100 L of water; and
 - (c) inspected postharvest in accordance with the specification of ICA-56 Pre-harvest baiting and inspection protocol for Pest Free Areas and found free of Queensland fruit fly infestation.

Note: The procedure under an approved Certification Assurance Arrangement is ICA-56 Pre-harvest baiting and inspection protocol for Pest Free Areas.

4 Untreated wine grapes for processing

Wine grapes:

- (a) contained in bins or containers cleaned free from all plant debris and soil prior to packing and loading; and
- (b) transported in a vehicle (“the transport vehicle”):
 - (i) cleaned free from all plant debris and soil prior to movement; and
 - (ii) secured so as to prevent infestation by Queensland fruit fly and spillage during transportation by:
 - (A) covering with a tarpaulin, shade cloth, bin cover or other covering; or
 - (B) containing within the transport vehicle; and
 - (iii) travelling by the most direct route to the receiving processor; and
- (c) upon receipt at the receiving processor:
 - (i) processed within 24 hours of receipt; and
 - (ii) all measures to avoid spillage of host fruit are taken and where spillages occur, are disposed of in a manner generally accepted as likely to prevent the spread of Queensland fruit fly; and
 - (iii) all processing wastes are disinfested by heat or freezing, or are buried.

Note: The procedure under an approved certification assurance arrangement is ICA-33 Movement of Wine Grapes.

Dated this 28th day of February 2013.

KATHRYN PHYLLIS GOTT,
Acting Director, Plant Biosecurity,
Department of Primary Industries

(an office within the Department of Trade and Investment, Regional Infrastructure and Services)

Notes:

1. The Department’s reference is O-437.
2. Section 26 (1) of the Plant Diseases Act 1924 makes it an offence, with a maximum penalty of 100 penalty units, to sell or move host fruit with the knowledge that the host fruit is infested with Queensland fruit fly.

LANDS

ARMIDALE CROWN LANDS OFFICE
108 Faulkner Street (PO Box 199A), Armidale NSW 2350
Phone: (02) 6770 3100 Fax (02) 6771 5348

ROADS ACT 1993

ORDER

Transfer of Crown Roads to a Council

IN pursuance of the provisions of section 151, Roads Act 1993, the Crown public roads specified in each Schedule 1 are transferred to the Roads Authority specified in the corresponding Schedule 2 hereunder, as from the date of publication of this notice and as from that date, the roads specified in each Schedule 1, cease to be Crown public roads.

ANDREW STONER, M.P.,
 Minister for Regional Infrastructure and Services

SCHEDULE 1

*Village of Liston; Parish – Wylie; County – Buller;
 Land District – Tenterfield; L.G.A. – Tenterfield*

Crown roads 30.175m wide and variable at Liston known as Tenterfield Street, Stanthorpe Street, Maryland Street, Acacia Street and Clarence Street, as shown by solid black shading on the diagram hereunder.

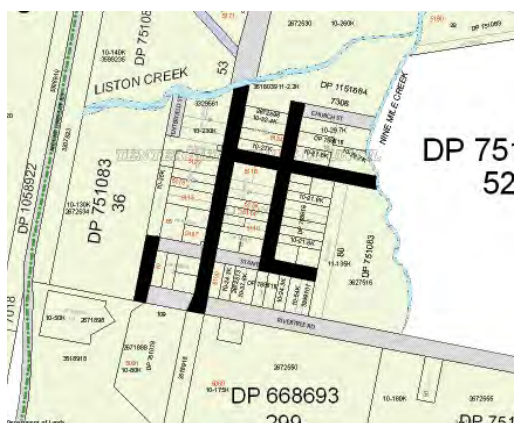

SCHEDULE 2

Roads Authority: Tenterfield Shire Council.

File Nos: 12/08303 and W511738.

Council's Reference: John Martin.

DUBBO CROWN LANDS OFFICE
45 Wingewarra Street (PO Box 1840), Dubbo NSW 2830
Phone: (02) 6883 3300 Fax: (02) 6884 2067

ROADS ACT 1993**ORDER**

Transfer of Crown Roads to a Council

IN pursuance of the provisions of section 151, Roads Act 1993, the Crown roads specified in Schedule 1 are transferred to the Roads Authority specified in Schedule 2 hereunder, as from the date of publication of this notice and as from that date, the roads specified in Schedule 1 cease to be Crown road.

ANDREW STONER, M.P.,
 Minister for Regional Infrastructure and Services

SCHEDULE 1

The section of Crown public road running north – south through Lot 4, DP 776858, Parish of Hawkins, County of Phillip.

SCHEDULE 2

Road Authority: Mid-Western Regional Council.

File No.: W511599.

Council's Reference: Powells Road.

SCHEDULE 1

The Crown public roads through Lots 31 and 8 (southernmost and central), DP 753226; Lots 16 and 20, DP 753219 and east of Lot 7002, DP 1020621, Parishes of Caloma and Belmore, County of Gordon.

SCHEDULE 2

Road Authority: Dubbo City Council.

File No.: W511227.

Council's Reference: Tanners Creek Road.

SCHEDULE 1

The Crown roads through Lot 2, DP 712742; north of Lot 101, DP 755792 and separating Lot 2, DP 712742 from Lot 3, DP 1111210 and Lot 40, DP 755792 (exclusive of the southernmost 67m), Parish of Tabrabucca, County of Roxburgh.

SCHEDULE 2

Road Authority: Mid-Western Regional Council.

File No.: W511166.

Council's Reference: Bombandi Road.

REVOCATION OF RESERVATION OF CROWN LAND

PURSUANT to section 90 of the Crown Lands Act 1989, the reservation of Crown Land specified in Column 1 of the Schedule hereunder, is revoked to the extent specified opposite thereto in Column 2 of the Schedule.

ANDREW STONER, M.P.,
 Minister for Regional Infrastructure and Services

SCHEDULE*Column 1*

Land District: Cooma.
 Local Government Area:
 Cooma-Monaro Shire
 Council.

Locality: Cooma.

Reserve No.: 96979.

Public Purpose: Future
 public requirements.

Notified: 30 September 1983.

File No.: 12/06782.

Note: Sale of Special Lease 71480 to Trinder Alpine
 Constructions Pty Ltd.

Column 2

The whole being Lot 406, DP
 No. 750535, Parish Cooma,
 County Beresford, of an area
 of 4.047 hectares.

GRAFTON OFFICE
49-51 Victoria Street (PO Box 272), Grafton NSW 2460
Phone: (02) 6640 3400 Fax: (02) 6642 5375

APPOINTMENT OF TRUST BOARD MEMBERS

PURSUANT to section 93 of the Crown Lands Act 1989, the persons whose names are specified in Column 1 of the Schedule hereunder, are appointed for the terms of office specified, as members of the trust board for the reserve trust specified opposite thereto in Column 2, which has been established and appointed as trustee of the reserve referred to opposite thereto in Column 3 of the Schedule.

ANDREW STONER, M.P.,
 Minister for Regional Infrastructure and Services

SCHEDULE

<i>Column 1</i>	<i>Column 2</i>	<i>Column 3</i>
Geoffrey Arthur MILLER (re-appointment).	Clarenza Flood Refuge and Water Reserve Trust.	Reserve No.: 33013. Public Purpose: Refuge in time of flood and water supply.
Brian William EGGINS (re-appointment).		Notified: 20 July 1901.
Kenneth Ernest DAWES (re-appointment).		File No.: GF80 R 227.

Term of Office

For a term commencing the date of this notice and expiring 7 March 2018.

ROADS ACT 1993

ORDER

Transfer of a Crown Road to a Council

IN pursuance of the provisions of section 151, Roads Act 1993, the Crown roads specified in Schedule 1 are hereby transferred to the Roads Authority specified in Schedule 2 hereunder and as from the date of publication of this notice, the road specified in Schedule 1 ceases to be Crown road.

ANDREW STONER, M.P.,
 Minister for Regional Infrastructure and Services

SCHEDULE 1

*Parish – Capeen; County – Buller;
 Shire – Kyogle Shire Council*

Crown public road within Lots 17 and 29, DP 751050 at Duck Creek.

Width to be Transferred: Whole width.

SCHEDULE 2

Roads Authority: Kyogle Shire Council.

Council's Reference: GAK-PCP/10-119.

Crown References: GF05 H 312 and GF04 H 118.

NOTIFICATION OF CLOSING OF A ROAD

IN pursuance of the provisions of the Roads Act 1993, the road hereunder described is closed and the lands comprised therein cease to be public road and the rights of passage and access that previously existed in relation to the road is extinguished. Upon closing, title to the land, comprising the former public road, vests in the body specified in the Schedule hereunder.

ANDREW STONER, M.P.,
 Minister for Regional Infrastructure and Services

Description

*Parish – Ulmarra; County – Clarence;
 Land District – Grafton; L.G.A. – Clarence Valley*

Road Closed: Lot 2, DP 1178589.

File No.: 07/6215.

Schedule

On closing, the land within Lot 2, DP 1178589 remains vested in the State of New South Wales as Crown Land.

Description

*Parish – Billinudgel; County – Rous;
 Land District – Murwillumbah; L.G.A. – Byron*

Road Closed: Lot 1, DP 1177790.

File No.: GF05 H 368.

Schedule

On closing, the land within Lot 1, DP 1177790 remains vested in the State of New South Wales as Crown Land.

Description

*Parish – Tabulam; County – Drake;
 Land District – Casino; L.G.A. – Kyogle*

Road Closed: Lot 1, DP 1178605.

File No.: 07/3646.

Schedule

On closing, the land within Lot 1, DP 1178605 remains vested in the State of New South Wales as Crown Land.

Description

*Parish – Qwyarigo; County – Clarence;
 Land District – Grafton; L.G.A. – Clarence Valley*

Road Closed: Lot 1, DP 1178482.

File No.: 11/00915.

Schedule

On closing, the land within Lot 1, DP 1178482 remains vested in the State of New South Wales as Crown Land.

Description

*Parish – Lismore; County – Rous;
Land District – Lismore; L.G.A. – Lismore*

Road Closed: Lot 1, DP 1178652.

File No.: GF05 H 325.

Schedule

On closing, the land within Lot 1, DP 1178652 remains vested in the State of New South Wales as Crown Land.

Description

*Parish – Terania; County – Rous;
Land District – Lismore; L.G.A. – Lismore*

Road Closed: Lot 3, DP 1172892.

File No.: 11/02634.

Schedule

On closing, the land within Lot 3, DP 1172892 remains vested in the State of New South Wales as Crown Land.

Description

*Parish – South Gundurimba; County – Rous;
Land District – Lismore; L.G.A. – Lismore*

Road Closed: Lot 6, DP 1178608.

File No.: 12/01620.

Schedule

On closing, the land within Lot 6, DP 1178608 remains vested in the State of New South Wales as Crown Land.

Description

*Parish – Kremnos; County – Fitzroy;
Land District – Grafton; L.G.A. – Clarence Valley*

Road Closed: Lot 1, DP 1176313.

File No.: 08/0462.

Schedule

On closing, the land within Lot 1, DP 1176313 remains vested in the State of New South Wales as Crown Land.

Description

*Parish – Condong; County – Rous;
Land District – Murwillumbah; L.G.A. – Tweed*

Road Closed: Lot 4, DP 1181853.

File No.: 12/03787.

Schedule

On closing, the land within Lot 4, DP 1181853 remains vested in the State of New South Wales as Crown Land.

GRIFFITH OFFICE
2nd Floor, Griffith City Plaza,
120–130 Banna Avenue (PO Box 1030), Griffith NSW 2680
Phone: (02) 6960 3600 Fax: (02) 6962 5670

APPOINTMENT OF TRUST BOARD MEMBERS

PURSUANT to section 93 of the Crown Lands Act 1989, the persons whose names are specified in Column 1 of the Schedule hereunder, are appointed for the terms of office specified, as members of the trust board for the reserve trust specified opposite thereto in Column 2, which has been established and appointed as trustee of the reserve referred to opposite thereto in Column 3 of the Schedule.

ANDREW STONER, M.P.,
 Minister for Regional Infrastructure and Services

SCHEDULE

<i>Column 1</i>	<i>Column 2</i>	<i>Column 3</i>
Peter James	Narrandera	Dedication No.: 559011.
Robert ROYLE (new member).	Racecourse Trust.	Public Purpose: Racecourse. Notified: 2 February 1889.
William Daniel ADAMS (re-appointment).		File No.: GH02 R 6.
Kerry SPROSTON (new member).		
Graeme John MATHIESON (re-appointment).		
Kenneth Martin MURPHY (re-appointment).		

Term of Office

For a term commencing the date of this notice and expiring
 7 March 2018.

MAITLAND OFFICE**Corner Newcastle Road and Banks Street (PO Box 6), East Maitland NSW 2323****Phone: (02) 4937 9300 Fax: (02) 4934 2252****APPOINTMENT OF TRUST BOARD MEMBERS**

PURSUANT to section 93 of the Crown Lands Act 1989, the persons whose names are specified in Column 1 of the Schedule hereunder, are appointed for the terms of office specified, as members of the trust board for the reserve trust specified opposite thereto in Column 2, which has been established and appointed as trustee of the reserve referred to opposite thereto in Column 3 of the Schedule.

ANDREW STONER, M.P.,
Minister for Regional Infrastructure and Services

SCHEDULE

<i>Column 1</i>	<i>Column 2</i>	<i>Column 3</i>
Neil ROSE (new member).	Norah Head Lighthouse	Reserve No.: 1003869. Public Purpose: Heritage
Gary DEAN (re-appointment).	Reserve Trust.	purposes, public recreation and coastal environmental protection.
John BURNAPP (new member).		Notified: 6 September 2002.
Colin PAULSON (new member).		File No.: MD02 R 25-003.
The person for the time being holding the office of Manager, Sport Leisure and Recreation, Wyang Shire Council (ex-officio member).		
Joyce Margaret GROVES (re-appointment).		
Jacqueline Maria SPRING (re-appointment).		
Douglas Ian FORD (new member).		
The person for the time being holding the office of Senior Manager Hunter Area, Trade and Investment, Crown Lands Division (ex-officio member).		

Term of Office

For a term commencing the date of this notice and expiring
7 March 2018.

NEWCASTLE OFFICE

437 Hunter Street, Newcastle NSW 2300 (PO Box 2185, Dangar NSW 2309)

Phone: (02) 4925 4104 Fax: (02) 4925 3517

NOTIFICATION OF CLOSING OF A ROAD

IN pursuance of the provisions of the Roads Act 1993, the road hereunder described is closed and the lands comprised therein cease to be public road and the rights of passage and access that previously existed in relation to the road is extinguished. Upon closing, title to the land, comprising the former public road, vests in the body specified in the Schedule hereunder.

ANDREW STONER, M.P.,
Minister for Regional Infrastructure and Services

Description

*Parish – Forbes; County – Wellington;
Land District – Orange; L.G.A. – Cabonne*

Road Closed: Lot 1, DP 1182385.

File No.: 08/3374.

Schedule

On closing, the land within Lot 1, DP 1182385 remains vested in the State of New South Wales as Crown Land.

Description

*Parishes – Vane and Goorangoola; County – Durham;
Land District – Singleton; L.G.A. – Singleton*

Road Closed: Lots 1-4, DP 1072124.

File No.: MD99 H 226.

Schedule

On closing, the land within Lots 1-4, DP 1072124 remains vested in the State of New South Wales as Crown Land.

Description

*Parishes – Vane and Goorangoola; County – Durham;
Land District – Singleton; L.G.A. – Singleton*

Road Closed: Lots 1-4, DP 1180252.

File No.: MD04 H 192.

Schedule

On closing, the land within Lots 1-4, DP 1180252 remains vested in the State of New South Wales as Crown Land.

Description

*Parish – Collie; County – Ewenmar;
Land District – Dubbo; L.G.A. – Warren*

Road Closed: Lot 1, DP 1182090.

File No.: 12/07558.

Schedule

On closing, the land within Lot 1, DP 1182090 remains vested in the State of New South Wales as Crown Land.

Description

*Parishes – Morongla and Wattamondara;
County – Forbes;
Land District – Cowra; L.G.A. – Cowra*

Road Closed: Lots 1-3, DP 1182388.

File No.: CL/00292.

Schedule

On closing, the land within Lots 1-3, DP 1182388 remains vested in the State of New South Wales as Crown Land.

Description

*Parish – Lindsay; County – Bathurst;
Land District – Blayney; L.G.A. – Blayney*

Road Closed: Lot 1, DP 1160670.

File No.: CL/00483.

Schedule

On closing, the land within Lot 1, DP 1160670 remains vested in the State of New South Wales as Crown Land.

Description

*Parishes – St Aubins and Balmoral; County – Durham;
Land District – Muswellbrook; L.G.A. – Muswellbrook*

Road Closed: Lot 1, DP 1170738 and Lots 1-2, DP 1181588.

File No.: 10/09972.

Schedule

On closing, the land within Lot 1, DP 1170738 and Lots 1-2, DP 1181588 remains vested in the State of New South Wales as Crown Land.

Description

*Parish – Cathcart; County – Wellesley;
Land District – Bombala; L.G.A. – Bombala*

Road Closed: Lot 1, DP 1182542.

File No.: 07/5199: JT.

Schedule

On closing, the land within Lot 1, DP 1182542 remains vested in the State of New South Wales as Crown Land.

Description

*Parish – Emu Plains; County – Cunningham;
Land District – Condobolin; L.G.A. – Lachlan*

Road Closed: Lot 1, DP 1182046.

File No.: 12/05453.

Schedule

On closing, the land within Lot 1, DP 1182046 remains vested in the State of New South Wales as Crown Land.

Description

*Parish – South Condobolin; County – Gipps;
Land District – Condobolin; L.G.A. – Lachlan*

Road Closed: Lot 1, DP 1181855.

File No.: 10/08071.

Schedule

On closing, the land within Lot 1, DP 1181855 remains vested in the State of New South Wales as Crown Land.

Description

*Parish – Euglo South; County – Gipps;
Land District – Condobolin; L.G.A. – Lachlan*

Road Closed: Lot 5, DP 1181795.

File No.: CL/00555.

Schedule

On closing, the land within Lot 5, DP 1181795 remains vested in the State of New South Wales as Crown Land.

Description

*Parishes – Baxter and Wilkie;
Counties – Monteagle and Harden;
Land District – Young; L.G.A. – Harden*

Road Closed: Lots 3 and 5, DP 1182631 (subject to right of carriageway created by Deposited Plan 1182631).

File Nos: 12/04897 and 07/4949: JT.

Schedule

On closing, the land within Lots 3 and 5, DP 1182631 remains vested in the State of New South Wales as Crown Land.

Description

*Parish – Balabla; County – Bland;
Land District – Young; L.G.A. – Young*

Road Closed: Lot 3, DP 1182628.

File No.: 12/04197: JT.

Schedule

On closing, the land within Lot 3, DP 1182628 remains vested in the State of New South Wales as Crown Land.

Description

*Parish – Melrose; County – Roxburgh;
Land District – Bathurst; L.G.A. – Bathurst Regional*

Road Closed: Lots 1 and 2, DP 1182093.

File No.: CL/00486.

Schedule

On closing, the land within Lots 1 and 2, DP 1182093 remains vested in the State of New South Wales as Crown Land.

Description

*Parish – Milpose; County – Ashburnham;
Land District – Parkes; L.G.A. – Parkes*

Road Closed: Lots 1 and 2, DP 1182820.

File No.: CL/00399.

Schedule

On closing, the land within Lots 1 and 2, DP 1182820 remains vested in the State of New South Wales as Crown Land.

**NOTICE OF PUBLIC PURPOSE PURSUANT TO
SECTION 34A (2) (b) OF THE CROWN LANDS ACT
1989**

PURSUANT to section 34A(2)(b) of the Crown Lands Act 1989, the Crown reserve specified in Column 1 of the Schedule is to be occupied for the additional purpose specified in Column 2 of the Schedule.

ANDREW STONER, M.P.,
Minister for Regional Infrastructure and Services

SCHEDULE

Column 1

Reserve No.: 81019.
Public Purpose: Public recreation.
Notified: 29 August 1958.
Parish: South Colah.
County: Cumberland.

Column 2

Communication facilities.

ORANGE OFFICE
92 Kite Street (PO Box 2146), Orange NSW 2800
Phone: (02) 6391 4300 Fax: (02) 6362 3896

**APPOINTMENT OF CORPORATION TO MANAGE
RESERVE TRUST**

PURSUANT to section 95 of the Crown Lands Act 1989, the corporation specified in Column 1 of the Schedule hereunder, is appointed to manage the affairs of the reserve trust specified opposite thereto in Column 2, which is trustee of the reserve referred to in Column 3 of the Schedule.

ANDREW STONER, M.P.,
Minister for Regional Infrastructure and Services

SCHEDULE

<i>Column 1</i>	<i>Column 2</i>	<i>Column 3</i>
Blayney Shire Council.	Blayney Shire Community Centre Reserve Trust.	Dedication No.: 1000284. Public Purpose: Community purposes. Notified: 30 September 1960. File No.: 11/04472.

For a term commencing this day

ESTABLISHMENT OF RESERVE TRUST

PURSUANT to section 92(1) of the Crown Lands Act 1989, the reserve trust specified in Column 1 of the Schedule hereunder, is established under the name stated in that Column and is appointed as trustee of the reserve specified opposite thereto in Column 2 of the Schedule.

ANDREW STONER, M.P.,
Minister for Regional Infrastructure and Services

SCHEDULE

<i>Column 1</i>	<i>Column 2</i>
Blayney Shire Community Centre Reserve Trust.	Dedication No.: 1000284. Public Purpose: Community purposes. Notified: 30 September 1960. File No.: 11/04472.

TAREE OFFICE
98 Victoria Street (PO Box 440), Taree NSW 2430
Phone: (02) 6591 3500 Fax: (02) 6552 2816

NOTIFICATION OF CLOSING OF ROAD

IN pursuance of the provisions of the Roads Act 1993, the road hereunder described is closed and the land comprised therein ceases to be a public road and the rights of passage and access that previously existed in relation to the road are extinguished. On road closing, title to the land comprising the former public road vests in the body specified in the Schedule hereunder.

ANDREW STONER, M.P.,
 Minister for Regional Infrastructure and Services

Description

*Land District – Kempsey;
 L.G.A. – Port Macquarie Hastings Council*

Roads Closed: Lot 104, DP 1173567 at Port Macquarie, Parish Macquarie, County Macquarie.

DPI File Reference: 10/17223,

Schedule

On closing, the land within Lot 104, DP 1173567 remains vested in Port Macquarie Hastings Council as operational land for the purposes of the Local Government Act 1993.

Councils Reference: 31: 2012.001.

Description

*Parish – Warbro; County – Dudley;
 Land District – Kempsey; L.G.A. – Kempsey*

Road Closed: Lot 1, DP 1176291.

File No.: 07/3295.

Schedule

On closing, the land within Lot 1, DP 1176291 remains vested in the State of New South Wales as Crown Land.

Description

*Parish – Dawson; County – Macquarie;
 Land District – Taree; L.G.A. – Greater Taree*

Road Closed: Lot 6, DP 1178651.

File No.: TE05 H 83.

Schedule

On closing, the land within Lot 6, DP 1178651 remains vested in the State of New South Wales as Crown Land.

WESTERN REGION OFFICE
45 Wingewarra Street (PO Box 1840), Dubbo NSW 2830
Phone: (02) 6883 5400 Fax: (02) 6884 2067

ERRATUM

IN the *New South Wales Government Gazette* of 3 March 2006, Folio 1064, under the heading "REMOVAL OF RESTRICTIONS ON WESTERN LANDS LEASES" the reference to Western Lands Lease 7769 should have included Folio Identifiers 6/4/758905 and 10/4/758905.

ANDREW STONER, M.P.,
Minister for Regional Infrastructure and Services

WATER**WATER ACT 1912**

APPLICATIONS for licences under Part 2, Section 10 of the Water Act 1912 within a Proclaimed (declared) Local Area under section 5 (4) has been received from:

Richard DOYLE for 1 x 380 mm axial flow pump on Whalan Creek, Lots 71 and 72, DP 756029, Parish Whalan, County Stapylton, for stock, domestic and irrigation of 162 hectares (90SL50480) and 2 x 380 mm axial flow pumps on Whalan Creek, Lot 44, DP 756009, Parish Merriwa, County Stapylton, for stock, domestic and irrigation of 162 hectares (90SL50481)

Any inquiries should be directed to (02) 6701 9620. Written objections, from any local occupier or statutory authority, specifying grounds and how their interests are affected, must be lodged with the NSW Office of Water, PO Box 550, Tamworth NSW 2400 within 28 days of this publication.

DAVID THOMAS,
Senior Water Regulation Officer

Other Notices

ASSOCIATIONS INCORPORATION ACT 2009

Cancellation of Incorporation Pursuant to Section 72

TAKE notice that the incorporation of the following associations is cancelled by this notice pursuant to section 72 of the Associations Incorporation Act 2009.

Holistic Nurses Association of N.S.W. Incorporated – Inc9876787

Kyogle Masonic Centre Incorporated – Y3059031

Macedonian Community Television of NSW Incorporated – Inc9880730

Middle Harbour Public School P & C Association Incorporated – Y2948930

Millbank Hall Committee Inc – Y1694110

Compassion without Borders Foundation Incorporated – Inc9894264

Student Workplace Learning Program Incorporated – Inc9874124

Quirindi Selling Agents' Association Incorporated – Y2136147

Sapphire City Combat Incorporated – Inc9893490

Rotary Club of Lismore Central Incorporated – Y0532935

Australian Institute of Homoeopathy Incorporated – Y1633137

Murwillumbah Ladies Bowling Club Incorporated – Y1800932

Gumnut House Centre for Early Learning Incorporated – Y0142510

Jacaranda Doll Society Incorporated – Y1967833

Tourism Action Group Incorporated – Inc9892743

New South Wales Rope Skipping Association Incorporated – Inc9883717

Portuguese Speaking Communities Association (PSCA) Incorporated – Inc9895586

Wingecarribee Family Centre Incorporated – Inc9887661

New Day Kinnect Incorporated – Inc9891401

Parables for Kids Incorporated – Inc9890563

Mallan Parents & Citizens Assoc. Inc. – Inc9879882

CTC Bulahdelah Incorporated – Inc9887160

Australian French Association for Science & Technology (NSW) Incorporated – Inc9877604

Hannam Vale Landcare Group Incorporated – Y2099805

Barwon Darling Alliance Incorporated – Y2783204

Cancellation is effective as at the date of gazettal.

Dated 5th day of March 2013.

ROBYNE LUNNEY,
Manager, Case Management Unit,
Registry Services,
NSW Fair Trading,
Department of Finance & Services

ASSOCIATIONS INCORPORATION ACT 2009

Reinstatement of Cancelled Association Pursuant to Section 84

TAKE notice that the incorporation of THE SHOALHAVEN DIVISION OF GENERAL PRACTICE INCORPORATED (Y2059135) cancelled on 23 March 2012 is reinstated pursuant to section 84 of the Associations Incorporation Act 2009.

Dated this 5th day of March 2013.

ROBYNE LUNNEY,
Manager, Case Management Unit,
Registry Services,
NSW Fair Trading,
Department of Finance & Services

ASSOCIATIONS INCORPORATION ACT 2009

Reinstatement of Cancelled Association Pursuant to Section 84

TAKE notice that the incorporation of AUSTRALIAN LEBANESE HISTORICAL SOCIETY INCORPORATED (INC9874543) cancelled on 21 January 2011 is reinstated pursuant to section 84 of the Associations Incorporation Act 2009.

Dated this 6th day of March 2013.

ROBYNE LUNNEY,
Manager, Case Management,
Registry Services,
NSW Fair Trading,
Department of Finance & Services

ASSOCIATIONS INCORPORATION ACT 2009

Reinstatement of Cancelled Association Pursuant to Section 84

TAKE notice that the incorporation of RIVERINA ALPINE SKI CLUB INCORPORATED (Y0970709) cancelled on 10 October 2008 is reinstated pursuant to section 84 of the Associations Incorporation Act 2009.

Dated this 6th day of March 2013.

ROBYNE LUNNEY,
Manager, Case Management,
Registry Services,
NSW Fair Trading,
Department of Finance & Services

BOARDING HOUSES ACT 2012

Consultation about the Draft Boarding Houses Regulation 2013

IN 2012 the NSW Government passed the Boarding Houses Act 2012. This Act establishes a regulatory framework for all boarding houses in NSW, both “general” boarding houses that provide beds to five or more residents, and “assisted” boarding houses that provide accommodation to two or more residents with additional needs (people who need care and

support services as a result of old age, disability or mental illness).

A draft regulation under the Act, the Boarding Houses Regulation 2013, has now been prepared for public consultation. The Draft Regulation provides details about service and accommodation standards for assisted boarding houses, as well as further information required for the Register of Boarding Houses, and information about penalties.

The Draft Regulation, a Regulatory Impact Statement and further information about the consultation process are available at www.adhc.nsw.gov.au/boardinghouse or by calling (02) 9248 0835.

Ageing Disability and Home Care and NSW Fair Trading invite interested individuals and organisations to make written submissions on the Draft Regulation. Submissions should be sent to boardinghousereform@facfs.nsw.gov.au or Boarding House Reform, Law & Justice Directorate, Ageing Disability and Home Care, Department of Family and Community Services, Level 4, 83 Clarence Street, Sydney 2000.

Comments are also being sought on a standard occupancy agreement for general boarding houses to be approved by the Commissioner for Fair Trading under section 29 of the Boarding House Act 2012. For more information, please see www.fairtrading.nsw.gov.au/About_us/Have_your_say.html.

The closing date for all comments and submissions is 5pm Monday, 15 April 2013.

Submissions may be made publicly available or referred to in a public report unless you advise that you wish all or part of your submission to be treated as confidential.

CHARITABLE TRUSTS ACT 1993

Order Under Section 12

Administrative Scheme Relating to UTS Law Alumni Foundation

THE trustees of the UTS Law Alumni Foundation Fund ('the Trust'), which was established to benefit law students at University of Technology, Sydney ('UTS'), asked the Attorney General to establish a scheme, under the Charitable Trusts Act 1993 ('CTA'), to allow them to transfer the administration of the trust, including a number of scholarships awarded by it, to the UTS Foundation ('the Foundation').

The Foundation is an internal unit of the UTS, governed by the UTS Council, which fund raises for UTS generally. It is intended that UTS, which is a statutory corporation established under the University of Technology Sydney Act 1993 ('the UTS Act'), will replace the current trustee (Board of Trustees) and that the Council of the University, which is the organ of governance of UTS under the UTS Act, will exercise the powers and responsibilities of UTS as trustee. As at 31 December 2011, the total value of all the funds managed by the Trust was \$255,041.20.

The reason for the transfer is said to be that it will provide the Trust with the benefit of the Foundation's resources, fund raising expertise and economies of scale, including removing the separate deductible gift recipient reporting and audit obligations. It will also align the Trust with the Foundation, rather than continuing to operate potentially in conflict with it, as it currently does.

It appears to be expedient to transfer its administration to the Foundation, provided that separate ledgers are maintained for the general trust and the scholarship trusts which are administered by the Trust. This would permit the Foundation to combine the management and administration of the Trust with that of the Foundation, to use common premises, employ common staff in the administration of the trusts and to pool the trust property for the purpose of investment.

I have formed a view that the UTS Law Alumni Foundation Fund is a trust for charitable purposes, being for the advancement of education. I consider that the original trust can no longer operate effectively and that this is an appropriate matter in which the Attorney General should approve an administrative scheme under section 12 (1) (b) of the Charitable Trusts Act 1993 so as to vary the mode of administration of the original trust.

Pursuant to that section, I hereby order:

1. the appointment of the University of Technology, Sydney as the trustee of the Trust, vesting in the University all the assets of the Trust;
2. the University of Technology, Sydney to use premises and staff of the University in administering, and raising funds for, the Trust; and
3. the University of Technology, Sydney to:
 - (a) use common premises;
 - (b) employ common staff;
 - (c) pool Trust property for the purpose of investment;
 - (d) combine administrative functions
 with the University of Technology, Sydney Foundation, provided that the Trust funds are separately.

This Order will take effect 21 days after its publication in the *NSW Government Gazette*, in accordance with section 16 (2) of the Charitable Trusts Act 1993.

Date of Order: 5 March 2013.

N. ADAMS, S.C.,
Deputy Solicitor General
(under delegation from the Attorney General)

DAMS SAFETY ACT 1978 AND MINING ACT 1992

Order under Section 369 of the Mining Act 1992

Woolandra West Notification Area

THE Dams Safety Committee pursuant to Section 369 of the Mining Act 1992, hereby declares that with regard to Woolandra West, being a prescribed dam under Dams Safety Act 1978, the land described in the schedule hereto is the notification area of the said dam.

SCHEDULE

The area bounded by straight lines joining the following 4 ordered points on map DUNEDOO 8733N 1:50000; the points are specified by Map Grid of Australia 1994 co-ordinates in Zone 55:

Point	MGAEast	MGANorth
1	716900	6438400
2	716900	6441800
3	714600	6441800
4	714600	6438400

Map Grid Australia (MGA) co-ordinates for the above points, as well as plan NA-237 showing the area, are available from the Dams Safety Committee.

BRIAN COOPER,
Chairman

Dams Safety Committee,
PO Box 3720,
Parramatta NSW 2124

DAMS SAFETY ACT 1978 AND MINING ACT 1992

Order under Section 369 of the Mining Act 1992

Wambo South Notification Area

THE order published in *NSW Government Gazette* No. 67 of 29 June 2012 is revoked.

BRIAN COOPER,
Chairman

Dams Safety Committee,
PO Box 3720,
Parramatta NSW 2124

DAMS SAFETY ACT 1978 AND MINING ACT 1992

Order under Section 369 of the Mining Act 1992

Cataract Notification Area

THE order published in *NSW Government Gazette* No. 127 of 16 December 2011 is revoked.

BRIAN COOPER,
Chairman

Dams Safety Committee,
PO Box 3720,
Parramatta NSW 2124

LOCAL GOVERNMENT ACT 1993

Cancellation of Registration of Party

IT is hereby notified that pursuant to section 320 of the Local Government Act 1993 that the registration of the following party is cancelled:

AUSTRALIAN PROTECTIONIST PARTY

Date: 27 February 2013.

COLIN BARRY,
Electoral Commissioner,

NSW Electoral Commission,
Level 25, 201 Kent Street,
Sydney NSW 2000

NATIONAL PARKS AND WILDLIFE ACT 1974

Tabbimoble Swamp Nature Reserve

Draft Plan of Management

A draft plan of management for Tabbimoble Swamp Nature Reserve has been prepared and is on exhibition until Monday, 17 June 2013.

The plan may be viewed at the NPWS Service, Northern Rivers Region, Colonial Arcade, 75 Main Street, Alstonville NSW. The plan is also available for download from the website: www.environment.nsw.gov.au (use the 'quicklinks' to 'park management plans').

Written submissions on the plan must be received by: The Ranger, Tabbimoble Swamp Nature Reserve, NPWS, PO Box 856, Alstonville NSW 2477; through the website or at northernrivers.region@environment.nsw.gov.au by Monday, 17 June 2013.

All submissions received by NPWS are a matter of public record and are available for public inspection upon request. Your comments on this plan may contain information that is defined as "personal information" under the NSW Privacy and Personal Information Protection Act 1998. The submission of personal information with your comments is voluntary.

NATIONAL PARKS AND WILDLIFE ACT 1974

Bargo River State Conservation Area

Draft Plan of Management

A draft plan of management for Tabbimoble Swamp Nature Reserve has been prepared and is on exhibition until Monday, 24 June 2013.

The plan may be viewed at the Wollondilly Shire Council, Frank McKay Building, 62-64 Menangle Street, PO Box 21, Picton NSW 2571; the Wingecarribee Shire Council, Civic Centre, Elizabeth Street, Moss Vale NSW 2577; Tourism Southern Highlands & Visitors Information Centre, 62-70, Main Street, Mittagong NSW 2575; and Wollondilly Visitor Information Centre, "Old Picton Post Office", cnr Argyle and Menangle Streets, Picton NSW 2571. The plan is also available for download from the website: www.environment.nsw.gov.au (use the 'quicklinks' to 'park management plans').

Written submissions on the plan must be received by: The Planner, Bargo River State Conservation Area, NPWS, PO Box 44, Sutherland NSW 1499; through the website or at maw.planning@environment.nsw.gov.au by Monday, 24 June 2013.

All submissions received by NPWS are a matter of public record and are available for public inspection upon request. Your comments on this plan may contain information that is defined as "personal information" under the NSW Privacy and Personal Information Protection Act 1998. The submission of personal information with your comments is voluntary.

POISONS AND THERAPEUTIC GOODS ACT 1966

Order Under Clause 175 (1),

Poisons and Therapeutic Goods Regulation 2008

Withdrawal of Drug Authority

IN accordance with the provisions of clause 175 (1) of the Poisons and Therapeutic Goods Regulation 2008 an Order has been made on Alison Nicole MENZIES (NMW0001346732) of 2A Ellerslie Road, Adamstown Heights NSW, prohibiting her, until further notice, as a nurse from having possession of and supplying drugs of addiction as authorised by clauses 101 and 103 of the Regulation.

This Order is to take effect on and from 8 March 2013.

Dated at Sydney, 5 March 2013.

Dr MARY FOLEY,
Director-General,
Ministry of Health, New South Wales

**PARENTS AND CITIZENS ASSOCIATIONS
INCORPORATION ACT 1976**

Incorporation of Parents and Citizens Associations

THE following association is hereby incorporated under the Parents and Citizens Associations Incorporation Act 1976:

1. YOUNG HIGH SCHOOL

ADRIAN PICCOLI, M.P.,
Minister for Education

POISONS AND THERAPEUTIC GOODS ACT 1966

Order Under Clause 175 (1),
Poisons and Therapeutic Goods Regulation 2008

Withdrawal of Drug Authority

IN accordance with the provisions of Clause 175 (1) of the Poisons and Therapeutic Goods Regulation 2008 an Order has been made on Dr Richard John Charles SCOTT (Registration Number 2612), of 1 Palm Road, Newport NSW 2106, prohibiting him until further notice, as a Veterinary Practitioner from supplying, having possession of and issuing a prescription for drugs of addiction as authorised by Clauses 101 and 77 of the Regulation.

This Order is to take effect on and from 4 March 2013.

Dated at Sydney, 25 February 2013.

Dr MARY FOLEY,
Director-General,
Ministry of Health New South Wales

RURAL FIRES ACT 1997

Local Bush Fire Danger Period Variation

PURSUANT to section 82 of the Rural Fires Act 1997, as amended, the Commissioner of the NSW Rural Fire Service, following consultation with the local stakeholders, declares the following Local Bush Fire Danger Period Variation:

Area of Variation:

Northern Rivers incorporating:
Kyogle Council,
Lismore City Council, and
Richmond Valley Council.

The Local Bush Fire Danger period has been revoked for the period 16 February until 31 March 2013.

During this period permits pursuant to section 87 of the Rural Fires Act 1997, as amended, will not be required for the lighting of fire for the purposes of land clearance or fire breaks.

Dated: 26 February 2013.

ROB ROGERS, AFSM,
Deputy Commissioner,
Director Operational Services
(Delegate)

RURAL FIRES ACT 1997

Local Bush Fire Danger Period Variation

PURSUANT to section 82 of the Rural Fires Act 1997, as amended, the Commissioner of the NSW Rural Fire Service, following consultation with the local stakeholders, declares the following Local Bush Fire Danger Period Variation:

Area of Variation:

Clarence Valley incorporating:
Clarence Valley Council.

The Local Bush Fire Danger period has been revoked for the period 16 February until 31 March 2013.

During this period permits pursuant to section 87 of the Rural Fires Act 1997, as amended, will not be required for the lighting of fire for the purposes of land clearance or fire breaks.

Dated: 26 February 2013.

ROB ROGERS, AFSM,
Deputy Commissioner,
Director Operational Services
(Delegate)

RURAL FIRES ACT 1997

Local Bush Fire Danger Period Variation

PURSUANT to section 82 of the Rural Fires Act 1997, as amended, the Commissioner of the NSW Rural Fire Service, following consultation with the local stakeholders, declares the following Local Bush Fire Danger Period Variation:

Area of Variation:

Far North Coast incorporating:
Ballina Shire Council,
Byron Shire Council, and
Tweed Shire Council.

The Local Bush Fire Danger period has been revoked for the period 16 February until 31 March 2013.

During this period permits pursuant to section 87 of the Rural Fires Act 1997, as amended, will not be required for the lighting of fire for the purposes of land clearance or fire breaks.

Dated: 26 February 2013.

ROB ROGERS, AFSM,
Deputy Commissioner,
Director Operational Services
(Delegate)

RURAL FIRES ACT 1997

Local Bush Fire Danger Period Variation

PURSUANT to section 82 of the Rural Fires Act 1997, as amended, the Commissioner of the NSW Rural Fire Service, following consultation with the local stakeholders, declares the following Local Bush Fire Danger Period Variation:

Area of Variation:

Mid Coast incorporating:
Greater Taree City Council, and
Port Macquarie-Hastings Council.

The Local Bush Fire Danger period has been revoked for the period 1 March until 31 March 2013.

During this period permits pursuant to section 87 of the Rural Fires Act 1997, as amended, will not be required for the lighting of fire for the purposes of land clearance or fire breaks.

Dated: 26 February 2013.

ROB ROGERS, AFSM,
Deputy Commissioner,
Director Operational Services
(Delegate)

RURAL FIRES ACT 1997

Local Bush Fire Danger Period Variation

PURSUANT to section 82 of the Rural Fires Act 1997, as amended, the Commissioner of the NSW Rural Fire Service, following consultation with the local stakeholders, declares the following Local Bush Fire Danger Period Variation:

Area of Variation:

Lower North Coast incorporating:
Kempsey Shire Council, and
Nambucca Shire Council.

The Local Bush Fire Danger period has been revoked for the period 4 March until 31 March 2013.

During this period permits pursuant to section 87 of the Rural Fires Act 1997, as amended, will not be required for the lighting of fire for the purposes of land clearance or fire breaks.

Dated: 28 February 2013.

ROB ROGERS, AFSM,
Deputy Commissioner,
Director Operational Services
(Delegate)

RURAL FIRES ACT 1997

Local Bush Fire Danger Period Variation

PURSUANT to section 82 of the Rural Fires Act 1997, as amended, the Commissioner of the NSW Rural Fire Service, following consultation with the local stakeholders, declares the following Local Bush Fire Danger Period Variation:

Area of Variation:

Mid North Coast incorporating:
Bellingen Shire Council, and
Coffs Harbour City Council.

The Local Bush Fire Danger period has been revoked for the period 4 March until 31 March 2013.

During this period permits pursuant to section 87 of the Rural Fires Act 1997, as amended, will not be required for the lighting of fire for the purposes of land clearance or fire breaks.

Dated: 28 February 2013.

ROB ROGERS, AFSM,
Deputy Commissioner,
Director Operational Services
(Delegate)

RURAL FIRES ACT 1997

Local Bush Fire Danger Period Variation

PURSUANT to section 82 of the Rural Fires Act 1997, as amended, the Commissioner of the NSW Rural Fire Service, following consultation with the local stakeholders, declares the following Local Bush Fire Danger Period Variation:

Area of Variation:

Gloucester Great Lakes incorporating:
Gloucester Shire Council, and
Great Lakes Council.

The Local Bush Fire Danger period has been revoked for the period 1 March until 31 March 2013.

During this period permits pursuant to section 87 of the Rural Fires Act 1997, as amended, will not be required for the lighting of fire for the purposes of land clearance or fire breaks.

Dated: 28 February 2013.

ROB ROGERS, AFSM,
Deputy Commissioner,
Director Operational Services
(Delegate)

VEXATIOUS PROCEEDINGS ACT 2008

Notification of Orders Concerning Vexatious Litigants

Anthony Gilbert Martin

ON 5 March 2013, Justice Hidden ordered that:

1. That, pursuant to section 8 (7) (a) of the Vexatious Proceedings Act 2008, all of the proceedings in New South Wales already instituted by the defendant are stayed with the exception of the outstanding issue of costs in the Land Environment Court proceedings 80006/2010.
2. That, pursuant to section 8 (7) (b) of the Vexatious Proceedings Act 2008, the defendant be prohibited from instituting proceedings in New South Wales without the leave of this court.
3. The defendant is to pay the plaintiff's costs of the proceedings.

These orders may be entered forthwith.

VEXATIOUS PROCEEDINGS ACT 2008

Notification of Orders Concerning Vexatious Litigants

Tareq Altaranesi

ON 15 February 2013, Justice Slattery ordered that:

- (1) Except to the extent provided for in Order (3), all and every part of proceedings brought by the defendant in New South Wales are stayed;
- (2) The defendant is prohibited from instituting proceedings in New South Wales without leave of the Court;
- (3) The defendant may continue to conduct the proceedings No. 2012/00337720 in the Local Court up to judgment or other resolution at first instance
- (4) Order the defendant to pay the plaintiff's costs of these proceedings.

PRIVATE ADVERTISEMENTS

COUNCIL NOTICES

BATHURST REGIONAL COUNCIL

Roads Act 1993
Naming of Roads

NOTICE is hereby given that Bathurst Regional Council, in pursuance of section 162 of the Roads Act 1993, has named the roads as follows:

<i>Location</i>	<i>New Street Name</i>
Proposed name change from Perthville Road to O'Regans Road for the road running from the end of Prince Street in the village of Perthville across to The Lagoon Road.	O'Regans Road.

Authorised by resolution of the Council on 26 September 2012. Mr DAVID SHERLEY, General Manager, Bathurst Regional Council, Private Mail Bag 17, Bathurst NSW 2795. [6923]

BEGA VALLEY SHIRE COUNCIL

Pesticides Use Notification Plan 2013-2018

BEGA VALLEY SHIRE COUNCIL, at its meeting of 27 February 2013, adopted its Pesticides Use Notification Plan for 2013-2018 in accordance with the provisions of the Pesticides Act and Regulation 1995. The PUNP has been advertised in local media and is available on council's website www.begavalley.nsw.gov.au. PETER TEGART, General Manager, Bega Valley Shire Council, PO Box 492, Bega NSW 2550. [6924]

CLARENCE VALLEY COUNCIL

Local Government Act 1993

Land Acquisition (Just Terms Compensation) Act 1991

Notice of Compulsory Acquisition of Land

CLARENCE VALLEY COUNCIL declares with the approval of Her Excellency the Governor that the easement described in the Schedule below, excluding any mines or deposits of minerals in the land, is acquired by compulsory process in accordance with the provisions of the Land Acquisition (Just Terms Compensation) Act 1991, for a flood penstock. Dated at Grafton, this 26th day of February 2013. SCOTT GREENSILL, General Manager, Clarence Valley Council, Locked Bag 23, Grafton NSW 2460.

SCHEDULE

Easement for Penstock shown as "A" Variable Width as shown in DP 1171741. [6925]

GREAT LAKES COUNCIL

Local Government Act 1993 – Section 50 (4)

Public Garden and Recreation Space and
Drainage Reserves Provided for in Subdivisions
Approved Before 15 June 1964

NOTICE is hereby given that Great Lakes Council, pursuant to the aforementioned Act notifies that the land described hereunder is vested in Great Lakes Council as a Public Drainage Reserve and further classified as Community Land – Natural Area, Watercourse. GLENN HANDFORD, General Manager, Great Lakes Council, Breese Parade, Forster NSW 2428.

Property Description

Strip of land between SP 35163 and Lot 9, Section 11 in Deposited Plan 759005 at Tuncurry, Local Government Area of Great Lakes, Parish of Forster, County of Gloucester.

[6926]

LAKE MACQUARIE CITY COUNCIL

Renaming of Roads

LAKE MACQUARIE CITY COUNCIL advises that in accordance with section 162.1 of the Roads Act 1993 and Part 2, Division 2, Clauses 7-10, Roads Regulations 2008, it renamed the following roads:

<i>Location/Description</i>	<i>Proposed Road Name</i>
Re-naming of Calder Court at Lakelands known locally as Colton Crescent. Shown on DP 791730, fronting Lots 144-151.	Colton Crescent.
Re-naming of Glen Gory Avenue at Buttaba. Shown on DP 11287. To correct the spelling to the intended name	Glen Cory Avenue.
Re-naming of Kona Road at Bonnells Bay, known locally as Kona Crescent. Fronting Lots 109-117 and Lots 128-131, DP 749085 and Lots 155-161, DP 776411	Kona Crescent.
Re-naming of Kirkland Court at Lakelands, known locally as Kirkland Close. Shown on DP 791730. Fronting Lots 401-404, DP 792874 and Lots 1-4, DP 802571.	Kirkland Close.

No objections to the proposed names were received within the advertising period. BRIAN BELL, General Manager, Lake Macquarie City Council, Box 1906, Hunter Region Mail Centre NSW 2310. [6927]

LEETON SHIRE COUNCIL

Section 162, Roads Act 1993
Part 2, Division 2, Regulation 7
Roads (General) Regulation 2000

Renaming and Naming of Public Roads

NOTICE is hereby given that the Leeton Shire Council, under the above Act, resolved to re-name the road as shown hereunder:

Present Name:

Uroly Road, from Irrigation Way (MR80) to Council Boundary.

Proposed Name:

Euroley Road, from Irrigation Way (MR80) to Council Boundary.

Authorised by resolution (04/535) of Council on 25 August 2004. J. BATCHELOR, General Manager, Leeton Shire Council, 23-25 Chelmsford Place, Leeton NSW 2705.

[6928]

MURRUMBIDGEE SHIRE COUNCIL

THE Murrumbidgee Shire Council gives public notice of a proposed resolution to reclassify land owned by Council (Lot 2 of DP 1081623), which abuts the western side of Young Street in Darlington Point as Operational Land in accordance with section 34 of the Local Government Act 1993.

The proposed resolution will be placed on public exhibition for a period of 28 days from Friday, 8 March, until Friday, 5 April 2013, at the following locations:

- Darlington Point Council Office – 21 Carrington Street, Darlington Point.
Monday to Friday, 8.30am – 5.00pm.
- Coleambally Council Office – 39 Brolga Place, Coleambally.
Monday to Friday, 9.00am – 5.00pm.
- Council's website: <http://www.murrumbidgee.local-e.nsw.gov.au/> under 'Council', 'Public Notices'.

Submissions are invited on this matter and will close at 5.00pm, Friday, 5 April 2013.

Following the exhibition, a public hearing relating to the reclassification of the land will be held. Details of the date and time for the public hearing will be advertised. CAROLYN UPSTON, General Manager, Murrumbidgee Shire Council, PO Box 5, Darlington Point NSW 2706.

[6929]

PORT STEPHENS COUNCIL

Section 162 (1), Roads Act 1993

Road Naming

PURSUANT to section 162 (1) and having received no objections after advertising Council has assigned the name as described below:

<i>Location</i>	<i>Road Name</i>
At Boat Harbour – PSC2011-01343, being an unnamed lane running east from Blanch Street to Kingsley Drive (crossing Coryule Street).	Windsong Way.

P. GESLING, General Manager, Port Stephens Council,
PO Box 42, Raymond Terrace NSW 2324.

[6930]

TWEED SHIRE COUNCIL

Roads Act 1993, Section 10

Dedication of Land as Public Road

NOTICE is hereby given that the Tweed Shire Council, by resolution of Council, dated 25 September 2012, has resolved to dedicate the land described hereunder as public road pursuant to section 10 of the Roads Act 1993. DAVID KEENAN, General Manager, Tweed Shire Council, PO Box 816, Murwillumbah NSW 2484.

SCHEDULE

Lot 1, DP 1178428. [6931]

WOOLLAHRA MUNICIPAL COUNCIL

Notification of Order in Accordance with
Section 31 of the Roads Act 1993

ON 14 January 2013, Woollahra Municipal Council decided in accordance with section 31 of the Roads Act 1993, to vary the existing levels of Kiaora Lane, Double Bay as provided in the Plans referred to below held by Woollahra Municipal Council:

<i>Reference</i>	<i>Description</i>	<i>Author/ Drawn</i>	<i>Date(s)</i>
001-B, 002-B, 003-B, 004-B, 005-B and 007-B;	Architectural Plans	Nettleton Tribe Partnership Pty Limited	25/10/2012
006-C;			26/3/2012
009-A;			12/6/2012
010-B			26/10/2012

Dated: 5 March 2013. GARY LEONARD JAMES,
General Manager, Woollahra Municipal Council, PO Box
61, Double Bay NSW 1360. [6932]

COMPANY NOTICES

NOTICE of final meeting of members. – In the matter of the Corporations Act 2001 and in the matter of TYDONNA PTY LIMITED (In Liquidation) ACN: 000 794 758. – Notice is hereby given pursuant to section 509 of the Corporations Act 2001, that the final meeting of the members of the abovenamed company will be held on 8 April 2013 at 9am in the office of Crosbie Warren Sinclair, cnr Pacific Highway and Warabrook Boulevard, Warabrook NSW 2304, for the purpose of having an account laid before them showing the manner in which the winding up has been conducted and the property of the Company disposed of and hearing any explanation that may be given by the liquidator. Dated 4 March 2013. BRENT ANTONY PERKINS, Liquidator, Crosbie Warren Sinclair, Box 29, Hunter Region Mail Centre NSW 2310, tel.: (02) 4923 4000. [6933]

OTHER NOTICES**AUSGRID**

Electricity Supply Act 1995

Land Acquisition (Just Terms Compensation) Act 1991

Notice of Compulsory Acquisition of Easement/Land
at West Gosford

AUSGRID declares, with the approval of Her Excellency the Governor and the Executive Council, that the interest in land described in Schedule 1 of this notice affecting the land described in Schedule 2 of this notice is acquired by compulsory process in accordance with the provisions of the Land Acquisition (Just Terms Compensation) Act 1991, for the purposes of the Electricity Supply Act 1995. In so far as any Native Title rights and interests may exist over any of the Land described in Schedule 2, the 'non-extinguishment principle' as defined in section 238 of the Native Title Act 1993 (Cth) applies to the acquisition.

Dated: 6 March 2013.

Signed for and on behalf of Ausgrid of 570 George Street, Sydney, by Lisa MAFFINA its duly constituted Attorney pursuant to Power of Attorney registered Book 4641, No. 639.

SCHEDULE 1

Easement for electricity purposes on the terms set out in Memorandum No. AG 823691 filed at Land and Property Management Authority New South Wales as if the easement was an easement for electricity works.

SCHEDULE 2

All that piece or parcel of land at Gosford, in the local government area of Gosford, in the Parish of Gosford and County of Northumberland, being the site of the proposed easement for electricity purposes 3.3 wide and variable width affecting Lot 7306, DP 1162518 and designated (E) on DP 1171077. [6934]

ISSN 0155-6320

Authorised to be printed
TONY DUCKMANTON, Government Printer.