



## *Government Gazette*

OF THE STATE OF  
NEW SOUTH WALES

**Number 49**  
**Friday, 19 April 2013**

Published under authority by the Department of Premier and Cabinet

## LEGISLATION

### **Online notification of the making of statutory instruments**

Week beginning 8 April 2013

THE following instruments were officially notified on the NSW legislation website ([www.legislation.nsw.gov.au](http://www.legislation.nsw.gov.au)) on the dates indicated:

#### **Regulations and other statutory instruments**

Firearms Amendment (Approval of Club) Regulation 2013 (2013-145) — published LW 12 April 2013

Supreme Court Rules (Amendment No 422) 2013 (2013-146) — published LW 12 April 2013

Water Sharing Plan for the Lower Gwydir Groundwater Source Amendment Order 2013 (2013-147) — published LW 12 April 2013

---

## Assents to Acts

---

### ACTS OF PARLIAMENT ASSENTED TO

Legislative Assembly Office, Sydney 3 April 2013

IT is hereby notified, for general information, that His Excellency the Lieutenant-Governor has, in the name and on behalf of Her Majesty, this day assented to the undermentioned Acts passed by the Legislative Assembly and Legislative Council of New South Wales in Parliament assembled, viz.:

Act No. 12 – An Act to amend the Crimes (Criminal Organisations Control) Act 2012 with respect to the control of criminal organisations and their members. [**Crimes (Criminal Organisations Control) Amendment Bill**]

Act No. 13 – An Act to amend the Election Funding, Expenditure and Disclosures Act 1981 with respect to claims on the Administration Fund; and for other purposes. [**Election Funding, Expenditure and Disclosures Amendment (Administrative Funding) Bill**]

Act No. 14 – An Act to amend the Independent Commission Against Corruption Act 1988 with respect to evidence in disciplinary proceedings after findings of corrupt conduct. [**Independent Commission Against Corruption Amendment (Disciplinary Proceedings) Bill**]

Act No. 15 – An Act to facilitate a trial of sobering up centres for intoxicated persons; and for related purposes. [**Intoxicated Persons (Sobering Up Centres Trial) Bill**]

Act No. 16 – An Act to amend the Law Enforcement (Controlled Operations) Act 1997 to make provision for the role of a secondary law enforcement officer in controlled operations and to amend the Surveillance Devices Act 2007 to make further provision with respect to the use of listening devices in controlled operations. [**Law Enforcement (Controlled Operations) Amendment Bill**]

Act No. 17 – An Act to amend the Public Interest Disclosures Act 1994 to make further provision for the public officials covered by that Act, disclosures and other matters. [**Public Interest Disclosures Amendment Bill**]

Act No. 18 – An Act to make provision with respect to road transport law in New South Wales. [**Road Transport Bill**]

Act No. 19 – An Act to repeal and amend certain legislation consequent on the enactment of the Road Transport Act 2013. [**Road Transport Legislation (Repeal and Amendment) Bill**]

Act No. 20 – An Act to amend certain statutory rules under the existing road transport legislation consequent on the enactment of the Road Transport Act 2013 and Road Transport Legislation (Repeal and Amendment) Act 2013; and to provide for the terms of the Road Transport (General) Regulation 2013. [**Road Transport (Statutory Rules) Bill**]

RONDA MILLER,  
Clerk of the Legislative Assembly

---

**OFFICIAL NOTICES**

---

**Appointments**

---

**TEACHER HOUSING AUTHORITY ACT 1975**

Appointment of a Board Member to the  
Teacher Housing Authority

HER Excellency the Governor, with the advice of the Executive Council, has approved, pursuant to section 7 1(a) and 7(2)(a) of the Teacher Housing Authority Act 1975, the appointment of Paul LOXLEY as Member of the Teacher Housing Authority Board, from 18 March 2013, for a term of two years.

BARRY O'FARRELL, M.P.,  
Premier

## Department of Planning

### ENVIRONMENTAL PLANNING AND ASSESSMENT ACT 1979

Order under Section 89C(3)

#### ORDER

I, the Minister for Planning and Infrastructure, with the advice of the Planning Assessment Commission (dated 27 March 2013 and made publicly available on 2 April 2013), declare the development specified in Schedule 1 on the land specified in Schedule 2 to be State significant development under section 89C(3) and for the purposes of the Environmental Planning and Assessment Act 1979.

Dated: 11 April 2013.

This Order takes effect upon publication in the *New South Wales Government Gazette*.

BRAD HAZZARD, M.P.,  
Minister for Planning and Infrastructure

#### SCHEDULE 1

Development for the purposes of the construction, operation and maintenance of a concrete batching plant as described in JBA Urban Planning Consultants Pty Ltd's request for SSD Call-in, submitted to the Department of Planning and Infrastructure and dated 14 December 2012.

#### SCHEDULE 2

Land within the State Significant Development Sites Map – Barangaroo within the City of Sydney Local Government Area.

### ENVIRONMENTAL PLANNING AND ASSESSMENT ACT 1979

Instrument of Delegation

I, the Minister for Planning and Infrastructure, pursuant to section 23 of the Environmental Planning and Assessment Act 1979 (the Act), delegate the functions identified in Column 2 of Schedule 1, subject to the specified limitations (and all other functions under the Act and any other Act as are incidental or related to the exercise of those functions) to the staff holding the positions in the Department of Planning and Infrastructure referred to in Column 3 of Schedule 1.

The terms and expressions used in Schedule 1 of this Instrument of Delegation have the meanings set out in the definitions in Schedule 2 of this Instrument of Delegation.

This delegation is in addition to, and is not intended to revoke or affect, the delegation of my functions by the Instruments of Delegation published in the *New South Wales Government Gazette* on 28 September 2011, 27 July 2012 or 8 March 2013.

Dated: 4 April 2013.

The Hon. BRAD HAZZARD, M.P.,  
Minister for Planning and Infrastructure

#### SCHEDULE 1

Delegation to staff of the Department of Planning and Infrastructure (DP&I)

Item	Function	Delegate
<i>Column 1</i>	<i>Column 2</i>	<i>Column 3</i>
Functions under the Environmental Planning and Assessment Act 1979		
1.	Determining a modification request under section 75W of the Act.  This delegation applies only to modification requests where: (a) the relevant local council has not made an objection, and (b) a political disclosure statement has been made, but only in respect of a previous related application, and (c) there are less than 10 public submissions in the nature of objections.	(a) Deputy Director-General Planning Operations and Regional Delivery; (b) Deputy Director-General Planning Strategies, Housing and Infrastructure; and (c) Executive Director, Development Assessment Systems and Approvals.

2.	<p>Determining modification applications under section 96 and 96AA of the Act.</p> <p>This delegation applies only to modification applications where:</p> <p>(a) the relevant local council has not made an objection, and</p> <p>(b) a political disclosure statement has been made, but only in respect of a previous related application, and</p> <p>(c) there are less than 10 public submissions in the nature of objections.</p>	<p>(a) Deputy Director-General Planning Operations and Regional Delivery;</p> <p>(b) Deputy Director-General Planning Strategies, Housing and Infrastructure; and</p> <p>(c) Executive Director, Development Assessment Systems and Approvals.</p>
3.	<p>Determining a modification request under section 115ZI of the Act.</p> <p>This delegation applies only to modification requests where:</p> <p>(a) the relevant local council has not made an objection, and</p> <p>(b) a political disclosure statement has been made, but only in respect of a previous related application, and</p> <p>(c) there are less than 10 public submissions in the nature of objections.</p>	<p>(a) Deputy Director-General Planning Operations and Regional Delivery;</p> <p>(b) Deputy Director-General Planning Strategies, Housing and Infrastructure; and</p> <p>(c) Executive Director, Development Assessment Systems and Approvals.</p>

---

SCHEDULE 2

**Definitions:**

In Schedule 1:

**Objection** means a submission in the nature of an objection, and does not include draft conditions requested to be imposed by the relevant local council on the consent or approval.

**Political disclosure statement** means a statement required to be made under section 147 of the Act, and includes a statement made in respect of a previous related application.

**Previous related application** means:

In respect of Part 4 of the Act

- the application for consent to any previous stage of a staged development application within the meaning of section 83B of the Act; and
- for modification applications, the application for development consent the subject of the modification application or a previous modification application to modify that consent.

In respect of Part 5.1 of the Act

- the application for approval of any previous stage of a staged infrastructure application within the meaning of section 115ZD of the Act; and
- for requests to modify an approval, the application for approval of State significant infrastructure the subject of the modification request or a previous modification request to modify that approval.

In respect of Part 3A of the Act

- the application for approval to carry out a part project for which an application for approval to carry out another part of the project is made under section 75E of the Act;
- for applications to carry out a project (or part project), the application for approval of the concept plan for the project; and
- for requests to modify an approval to carry out a project (or part project) or an approval of a concept plan, any previous application or request made under Part 3A of the Act in respect of the relevant project.

**Public submissions** refers to submissions received from the general public during the statutory exhibition process of applications, and does not include any submissions received from public authorities.

**Note:** A petition or a single submission that is signed by multiple parties is taken to be one submission for the purposes of Schedules 1 and 2.

# Roads and Maritime Services

## ROAD TRANSPORT (GENERAL) ACT 2005

Ministerial Declaration (Two Axle Bus Mass Exemption) Order 2013

I, DUNCAN GAY, M.L.C., Minister for Roads and Ports, pursuant to section 16 of the Road Transport (General) Act 2005 make the following Order.

Dated this 21st day of March 2013.

DUNCAN GAY, M.L.C.,  
Minister for Roads and Ports

### PART 1 – PRELIMINARY

#### 1. Citation

This Order may be cited as the Ministerial Declaration (Two Axle Bus Mass Exemption) Order 2013.

#### 2. Commencement

This Order takes effect on and from 19 April 2013.

#### 3. Effect

This Order remains in effect until it is revoked.

#### 4. Interpretation

Unless stated otherwise, words and expressions used in this Order have the same meaning as those defined in the Road Transport (General) Act 2005.

#### 5. Definitions

In this Order:

*complying bus* has the same meaning as in the Road Transport (Mass, Loading and Access) Regulation 2005.

*ultra-low floor bus* has the same meaning as in the Road Transport (Mass, Loading and Access) Regulation 2005.

*controlled access bus* has the same meaning as in the Road Transport (Vehicle Registration) Regulation 2007.

#### 6. Declaration

The axle mass limits in Table 1 and the total vehicle mass limits in clause 6 of Schedule 1 to the Road Transport (Mass, Loading and Access) Regulation 2005 are declared not to apply to a vehicle described in Part 2 of this Order, provided the vehicle complies with the mass limits set out in Part 3 of this Order and the operating and travel requirements set out in Part 4 of this Order.

### PART 2 – APPLICATION

#### 7. Eligible vehicles

The following types of vehicles may operate in accordance with this Order:

- Two axle complying buses with single tyres on the single steer axle and dual tyres on the single rear (drive) axle;
- Two axle ultra-low floor buses with single tyres on the single steer axle and dual tyres on the single rear (drive) axle;
- Two axle controlled access buses with single tyres on the single steer axle and dual tyres on the single rear (drive) axle.

### PART 3 – MASS LIMITS

#### 8. Vehicle mass limit

The laden mass of a vehicle operating in accordance with this Order must not exceed the lowest of the following:

- the vehicle's Gross Vehicle Mass (GVM) limit specified by the manufacturer, or
- 18.0 tonnes.

#### 9. Axle mass limits

The laden mass of an axle on a vehicle operating in accordance with this Order must not exceed the limits set out in Table A of this Order.

Table A – Axle mass limits

<i>Description of Single Axle</i>	<i>Mass Limit</i>
Single steer axle with 2 tyres	7.0 tonnes
Single rear (drive) axle with 4 tyres	12.0 tonnes

## PART 4 – OPERATING AND TRAVEL REQUIREMENTS

**10. Braking and Stability Control Requirements**

- 10.1 Vehicles operating in accordance with this Order must be fitted with a properly functioning:
- (a) Anti-lock Braking System and Electronic Braking System; or
  - (b) Electronic Stability Control.
- 10.2 Compliance with the requirements for an Anti-lock Braking System and Electronic Braking System or Electronic Stability Control must be verified by either:
- (a) An Identification Plate issued by a person authorised by an Australian Road Authority to affix an Identification Plate; or
  - (b) A certificate verifying modifications issued by a person authorised by an Australian Road Authority to certify heavy vehicle modifications; or
  - (c) An original letter from the manufacturer of the vehicle stating the vehicle complies with paragraph 10.1; which system is installed; the model and Vehicle Identification Number (VIN) of the vehicle chassis.

**11. Operating conditions**

- 11.1 When operating under this Order, a copy of this Order must be carried in the driving compartment of the vehicle and the driver must produce it if requested to do so by a Police Officer or an Authorised Officer.
- 11.2 If issued, the certificate or letter referred to in paragraph 10.2 must be carried in the driving compartment of the vehicle.

## ROAD TRANSPORT (GENERAL) ACT 2005

### Class 3 Complying Bus Mass Limit Exemption Amendment Notice 2013

I, PETER DUNCAN, Chief Executive of Roads and Maritime Services, pursuant to Clause 20 of the Road Transport (Mass, Loading and Access) Regulation 2005, hereby amend the Class 3 Complying Bus Mass Limit Exemption Notice 2011, that was published on 18 February 2011, in the *New South Wales Government Gazette* No. 15 at page 769 as set out in the Schedule of this Notice.

PETER DUNCAN,  
Chief Executive,  
Roads and Maritime Services

### SCHEDULE

The Class 3 Complying Bus Mass Limit Exemption Notice 2011, published on 18 February 2011, in the *New South Wales Government Gazette* No. 15 at page 769 remains in force subject to the following amendment:

**[1] Delete after paragraph 1.4.1:**

1.4.2 An identification plate has the same meaning as a compliance plate and may be a label.

**[2] Delete after Part 4 – Mass Conditions:**

**4.1 Mass Limits**

4.1.1 The sum of the mass on the axle groups and single axles on a vehicle operating under this Notice must not exceed:

- (a) if the complying bus has two axles – 16.5 tonnes, and
- (b) if the complying bus has a rear tandem axle group fitted with single tyres on one axle and dual tyres on the other axle – 20.5 tonnes, and
- (c) if the complying bus has a rear tandem axle group fitted with dual tyres upon both axles – 23.0 tonnes.

4.1.2 This Notice does not exempt vehicles from the mass limits which apply to single axles and axle groups as set out in Table 1 of Schedule 1 to the Regulation.

**4.2 Braking and Stability Control Requirements**

4.2.1 A vehicle operating under this Notice must be fitted and effectively operating with:

- (a) Anti-lock Braking System and Electronic Braking System, or
- (b) Electronic Stability Control.

4.2.2 Compliance with the requirements of Anti-lock Braking Systems and Electronic Braking Systems, or Electronic Stability Controls must be verified by either:

- (a) An Approval Plate, affixed to the vehicle cabin and in the proximity of the vehicle's identification plate. The Approval Plate must be clearly visible to, and readable by, a Police Officer or an Authorised Officer; or
- (b) An original letter from the manufacturer of the vehicle that declares the vehicle complies with Clause 4.2.1, states which system is installed, and identifies the make, model and Vehicle Identification Number (VIN) of the vehicle.

4.2.3 The letter referred to in Clause 4.2.2 (b) must be carried in the driving area of the vehicle.

**Part 5 Definitions**

**“Approval Plate”** means a decal, label or plate issued by a Competent Entity that is made of a material and fixed in such a way that it cannot be removed without being damaged or destroyed.

**“Competent Entity”** means:

1. A heavy vehicle manufacturer, issued with a Compliance Plate Approval by the Department of Infrastructure and Transport.
2. A person listed in Vehicle Standards Information 15, published by the Roads and Traffic Authority, as being authorised to certify that a heavy vehicle is compliant with the applicable road transport regulations for that vehicle.

**[3] Insert after Part 4 – Mass Conditions:**

**4.1 Mass Limits**

4.1.1 The sum of the mass on the axle groups on a vehicle operating under this Notice must not exceed:

- (a) if the complying bus has a rear tandem axle group fitted with single tyres on one axle and dual tyres on the other axle – 20.5 tonnes, and
- (b) if the complying bus has a rear tandem axle group fitted with dual tyres upon both axles – 23.0 tonnes.



**4.2 Braking and Stability Control Requirements**

4.2.1 Vehicles operating in accordance with this Notice must be fitted with a properly functioning:

- (a) Anti-lock Braking System and Electronic Braking System; or
- (b) Electronic Stability Control.

4.2.2 Compliance with the requirements for an Anti-lock Braking System and Electronic Braking System or Electronic Stability Control must be verified by either:

- (a) an Identification Plate issued by a person authorised by an Australian Road Authority to affix an Identification Plate; or
- (b) a certificate verifying modifications issued by a person authorised by an Australian Road Authority to certify heavy vehicle modifications; or
- (c) an original letter from the manufacturer of the vehicle stating the vehicle complies with paragraph 4.2.1; which system is installed; the model and Vehicle Identification Number (VIN) of the vehicle chassis.

4.2.3 Where a person operating under this Notice relies on a certificate or letter referred to in paragraph 4.2.2 that certificate or letter must be carried in the driving compartment of the vehicle.

**Note:** The Ministerial Declaration (Two Axle Bus Mass Exemption) Order 2013 was issued by the Minister for Roads and Ports on 19 April 2013 providing for increased masses for complying buses with two axles.

**ROAD TRANSPORT (GENERAL) ACT 2005**

Notice under Clause 20 of the Road Transport (Mass, Loading and Access) Regulation 2005

ALBURY CITY COUNCIL in pursuance of Division 4 of Part 2 of the Road Transport (Mass, Loading, Access) Regulation 2005, by this Notice, specify the routes and areas on or in which 4.6 metre High Vehicles may be used subject to any requirements or conditions set out in the Schedule.

Dated: 5 April 2013.

Mr FRANK ZAKNICH,  
General Manager,  
Albury City Council  
(by delegation from the Minister for Roads)

---

**SCHEDULE**
**1. Citation**

This Notice may be cited as Albury City Council 4.6 Metre High Vehicle Route Notice No. 01/2013.

**2. Commencement**

This Notice takes effect on the date of gazettal.

**3. Effect**

This Notice remains in force until 31 December 2017, unless it is amended or repealed earlier.

**4. Application**

This Notice applies to those 4.6 metre high vehicles which comply with Schedule 1 of the Road Transport (Mass, Loading and Access) Regulation 2005 and Schedule 2 of the Road Transport (Vehicle Registration) Regulation 2007.

**5. Routes**

<i>Type</i>	<i>Road Name</i>	<i>Starting Point</i>	<i>Finishing Point</i>
4.6m.	Trout Farm Road.	Murray Road.	Heywoods Bridge.
4.6.	Murray Road.	HW20 Riverina Highway.	Trout Farm Road.

**ROAD TRANSPORT (GENERAL) ACT 2005**

Notice under Clause 20 the Road Transport (Mass, Loading and Access) Regulation 2005

GILGANDRA SHIRE COUNCIL, in pursuance of Division 4 of Part 2 of the Road Transport (Mass, Loading, Access) Regulation 2005, by this Notice, specify the routes and areas on or in 25metre B-Doubles may be used subject to any requirements or conditions set out in the Schedule.

Date: 19 April 2013.

P. A. MANN,  
General Manager,  
Gilgandra Shire Council  
(by delegation from the Minister for Roads)

**SCHEDULE****1. Citation**

This Notice may be cited as Gilgandra Shire Council 25 Metre B-Double Route Notice No. 2/2013.

**2. Commencement**

This Notice takes effect on the date of gazettal.

**3. Effect**

This Notice remains in force until 1 September 2015 unless it is amended or repealed earlier.

**4. Application**

This Notice applies to those 25 metre B-Double vehicles which comply with Schedule 1 of the Road Transport (Mass, Loading and Access) Regulation 2005 and Schedule 2 of the Road Transport (Vehicle Registration) Regulation 2007.

**5. Routes**

<i>Type</i>	<i>Road No.</i>	<i>Road Name</i>	<i>Conditions</i>
25	000	Access to all shire rural roads west of the Newell Highway within Gilgandra Shire Council area.	Travel by B doubles is not allowed on school days from 7.45am to 9am and from 3.30pm to 4.45pm. That no B double has access rights over the bridges sign posted as having weight bearing limits.

**ROAD TRANSPORT (GENERAL) ACT 2005**

Notice under Clause 20 the Road Transport (Mass, Loading and Access) Regulation 2005

GILGANDRA SHIRE COUNCIL, in pursuance of Division 4 of Part 2 of the Road Transport (Mass, Loading, Access) Regulation 2005, by this Notice, specify the routes and areas on or in Road Trains may be used subject to any requirements or conditions set out in the Schedule.

Date: 19 April 2013.

P. A. MANN,  
General Manager,  
Gilgandra Shire Council  
(by delegation from the Minister for Roads)

**SCHEDULE****1. Citation**

This Notice may be cited as Gilgandra Shire Council Road Train route Notice No. 3/2013.

**2. Commencement**

This Notice takes effect on the date of gazettal.

**3. Effect**

This Notice remains in force until 31 July 2017 unless it is amended or repealed earlier.

**4. Application**

This Notice applies to those Road Train vehicles which comply with Schedule 1 of the Road Transport (Mass, Loading and Access) Regulation 2005 and Schedule 2 of the Road Transport (Vehicle Registration) Regulation 2007.

**5. Routes**

<i>Type</i>	<i>Road No.</i>	<i>Road Name</i>	<i>Conditions</i>
36.5	000	Access to all shire rural roads west of the Newell Highway within Gilgandra Shire Council area.	Travel by Road Trains is not allowed on school days from 7.45am to 9am and from 3.30pm to 4.45pm. That no Road Train has access rights over the bridges sign posted as having weight bearing limits

**ROAD TRANSPORT (GENERAL) ACT 2005**

Notice under Clause 20 of the Road Transport (Mass, Loading and Access) Regulation 2005

TUMUT COUNCIL in pursuance of Division 4 of Part 2 of the Road Transport (Mass, Loading, Access) Regulation 2005, by this Notice, specify the routes and areas on or in which 25 metre B-Doubles may be used subject to any requirements or conditions set out in the Schedule.

Dated: 17 April 2013.

BOB STEWART,  
General Manager,  
Tumut Council  
(by delegation from the Minister for Roads)

---

**SCHEDULE**
**1. Citation**

This Notice may be cited Tumut Council 25 Metre B-Double Route Notice No. 01/2013.

**2. Commencement**

This Notice takes effect on the date of gazettal.

**3. Effect**

This Notice remains in force until 3 May 2013, unless it is amended or repealed earlier.

**4. Application**

This Notice applies to those 25 metre B-Double vehicles which comply with Schedule 1 of the Road Transport (Mass, Loading and Access) Regulation 2010 and Schedule 2 of the Road Transport (Vehicle Registration) Regulation 2007.

**5. Routes**

<i>Type</i>	<i>Road No.</i>	<i>Road Name</i>	<i>Starting Point</i>	<i>Finishing Point</i>	<i>Conditions</i>
25m.	MR278.	Wee Jasper Road.	Jeremiah Road.	Forestry NSW plantation entrance Buccleuch Forest 120m north east of Jeremiah Road.	The route is managed under traffic control conditions for timber salvage operations by FNSW.

## Department of Trade and Investment, Regional Infrastructure and Services

### MINERALS

NOTICE is given that the following applications have been received:

#### EXPLORATION LICENCE APPLICATIONS

(T13-1048)

No. 4788, GOLD AND COPPER RESOURCES PTY LIMITED (ACN 124 534 863), area of 3 units, for Group 1, dated 11 April 2013. (Orange Mining Division).

(T13-1049)

No. 4789, CANTERBURY EXPLORATION PTY LIMITED (ACN 153 459 137), area of 100 units, for Group 1, dated 12 April 2013. (Armidale Mining Division).

(T13-1050)

No. 4790, THARSIS MINING PTY LTD (ACN 135 552 742), area of 4 units, for Group 1, dated 12 April 2013. (Orange Mining Division).

(T13-1051)

No. 4791, ALKANE RESOURCES LTD (ACN 000 689 216), area of 13 units, for Group 1, dated 16 April 2013. (Orange Mining Division).

The Hon. CHRIS HARTCHER, M.P.,  
Minister for Resources and Energy

NOTICE is given that the following applications have been granted:

#### EXPLORATION LICENCE APPLICATIONS

(T12-1122)

No. 4575, now Exploration Licence No. 8071, PEEL MINING LIMITED (ACN 119 343 734), County of Mouramba, Map Sheet (8033), area of 78 units, for Group 1, dated 8 April 2013, for a term until 8 April 2015.

(T12-1173)

No. 4623, now Exploration Licence No. 8073, GREENBURY PTY LIMITED (ACN 123 076 442), County of Wellesley, Map Sheet (8723), area of 10 units, for Group 1, dated 10 April 2013, for a term until 10 April 2015.

(T12-1187)

No. 4636, now Exploration Licence No. 8076, SILVER CITY MINERALS LIMITED (ACN 130 933 309), County of Yancowinna, Map Sheet (7133, 7233), area of 9 units, for Group 1, dated 15 April 2013, for a term until 15 April 2016.

(T12-1197)

No. 4646, now Exploration Licence No. 8075, SILVER CITY MINERALS LIMITED (ACN 130 933 309), Counties of Farnell and Yancowinna, Map Sheet (7134, 7234), area of 76 units, for Group 1, dated 15 April 2013, for a term until 15 April 2016. As a result of the grant of this title, Exploration Licence No. 5646, Exploration Licence No. 5764, Exploration Licence No. 6002, Exploration Licence No. 6132, Exploration Licence No. 6147 and Exploration Licence No. 6475 have ceased to have effect.

### MINING LEASE APPLICATION

(T12-)

Singleton No. 425, now Mining Lease No. 1683 (Act 1992), CUMNOCK NO.1 COLLIERY PTY LIMITED (ACN 051 932 122) AND ICRA CUMNOCK PTY LTD (ACN 129 006 819), Parish of Liddell, County of Durham; Parish of Ravensworth, County of Durham; and Parish of Vane, County of Durham, Map Sheet (9133-3-S), area of 383.3 hectares, to mine for coal, dated 7 February 2013, for a term until 7 February, 2034. As a result of the grant of this title, Exploration Licence No. 7798 has ceased to have effect and Authorisation No. 385, Coal Lease No. 378 (Act 1973) and Mining Lease No. 1393 (Act 1992) have partly ceased to have effect.

The Hon. CHRIS HARTCHER, M.P.,  
Minister for Resources and Energy

NOTICE is given that the following applications have been refused:

#### EXPLORATION LICENCE APPLICATIONS

(T12-1020)

No. 4476, PARNOSA PTY LTD (ACN 089 489 618), County of Arrawatta and County of Gough, Map Sheet (9138, 9139, 9238, 9239). Refusal took effect on 10 April 2013.

(T12-1021)

No. 4477, PARNOSA PTY LTD (ACN 089 489 618), County of Arrawatta and County of Gough, Map Sheet (9138, 9238). Refusal took effect on 10 April 2013.

(T12-1025)

No. 4481, WINDORA EXPLORATION PTY LTD (ACN 143 563 133), County of Bligh, County of Gordon, County of Lincoln and County of Wellington, Map Sheet (8632, 8732). Refusal took effect on 11 April 2013.

The Hon. CHRIS HARTCHER, M.P.,  
Minister for Resources and Energy

NOTICE is given that the following applications have been withdrawn:

#### EXPLORATION LICENCE APPLICATIONS

(T11-0239)

No. 4332, STEVEN DE GUNST, County of Arrawatta and County of Gough, Map Sheet (9138). Withdrawal took effect on 12 April 2013.

(T12-1119)

No. 4572, FORCE RESOURCES PTY LIMITED (ACN 154 507 310), County of Cunningham, County of Flinders and County of Kennedy, Map Sheet (8232, 8233, 8332). Withdrawal took effect on 12 April 2013.

(T13-1040)

No. 4779, OCHRE RESOURCES PTY LTD (ACN 112 833 351), County of Mouramba, Map Sheet (8133). Withdrawal took effect on 16 April 2013.

The Hon. CHRIS HARTCHER, M.P.,  
Minister for Resources and Energy

NOTICE is given that the following applications for renewal have been received:

(04-0619)

Exploration Licence No. 6407, ILUKA RESOURCES LIMITED (ACN 008 675 018), area of 39 units. Application for renewal received 12 April 2013.

(06-4150)

Exploration Licence No. 6753, GOLDEN CROSS OPERATIONS PTY. LTD. (ACN 050 212 827), area of 18 units. Application for renewal received 16 April 2013.

(13-1379)

Exploration Licence No. 7332, FORTIUS MINES PTY LTD (ACN 140 151 917), area of 95 units. Application for renewal received 11 April 2013.

(10-0162)

Exploration Licence No. 7509, GRANITE POWER LIMITED (ACN 112 714 440), area of 201 units. Application for renewal received 11 April 2013.

(13-1376)

Mining Purposes Lease No. 320 (Act 1973), METROPOLITAN COLLIERIES PTY. LTD. (ACN 003 135 635), area of 7 hectares. Application for renewal received 12 April 2013.

The Hon. CHRIS HARTCHER, M.P.,  
Minister for Resources and Energy

#### RENEWAL OF CERTAIN AUTHORITIES

NOTICE is given that the following authorities have been renewed:

(05-5419)

Exploration Licence No. 5072, COALEX PTY LTD (ACN 000 694 315) AND CLARENCE COAL INVESTMENTS PTY LIMITED (ACN 003 772 174), County of Cook, Map Sheet (8931), area of 616 hectares, for a further term until 11 November 2015. Renewal effective on and from 9 April 2013.

(10-5962)

Exploration Licence No. 5997, HILLGROVE MINES PTY LTD (ACN 102 660 506), County of Sandon, Map Sheet (9236), area of 13 units, for a further term until 26 September 2014. Renewal effective on and from 10 April 2013.

(T03-0836)

Exploration Licence No. 6162, HERA RESOURCES PTY LIMITED (ACN 138 992 999), Counties of Flinders and Mouramba, Map Sheet (8133), area of 49 units, for a further term until 25 November 2013. Renewal effective on and from 10 April 2013.

(07-0087)

Exploration Licence No. 6789, NEO RESOURCES LIMITED (ACN 007 708 429), County of Roxburgh, Map Sheet (8831, 8832), area of 22 units, for a further term until 28 May 2014. Renewal effective on and from 9 April 2013.

(07-0128)

Exploration Licence No. 6873, ELEPHANT MINES PTY LIMITED (ACN 097 799 025), County of King, Map Sheet (8628), area of 9 units, for a further term until 7 September 2015. Renewal effective on and from 10 April 2013.

(T07-0531)

Exploration Licence No. 7195, ICARUS MINES PTY LTD (ACN 140 149 515), County of Argyle, Map Sheet (8828), area of 90 units, for a further term until 28 August 2014. Renewal effective on and from 10 April 2013.

(09-5058)

Exploration Licence No. 7211, WAMBO COAL PTY LIMITED (ACN 000 668 057), County of Hunter, Map Sheet (9032, 9033), area of 967 hectares, for a further term until 29 September 2014. Renewal effective on and from 9 April 2013.

(T09-0171)

Exploration Licence No. 7437, AWATI RESOURCES PTY LTD (ACN 106 020 419), Counties of Evelyn and Tongowoko, Map Sheet (7238), area of 45 units, for a further term until 23 December 2013. Renewal effective on and from 10 April 2013.

(T09-0123)

Exploration Licence No. 7520, CROWL CREEK EXPLORATION LIMITED (ACN 139 933 109), Counties of Cunningham, Flinders and Kennedy, Map Sheet (8232, 8233, 8332), area of 85 units, for a further term until 3 May 2014. Renewal effective on and from 16 April 2013.

(T09-0205)

Exploration Licence No. 7548, NEO RESOURCES LIMITED (ACN 007 708 429), County of Roxburgh, Map Sheet (8831, 8832), area of 78 units, for a further term until 21 May 2014. Renewal effective on and from 9 April 2013.

(T09-0206)

Exploration Licence No. 7549, NEO RESOURCES LIMITED (ACN 007 708 429), Counties of Roxburgh and Wellington, Map Sheet (8831, 8832), area of 98 units, for a further term until 21 May 2014. Renewal effective on and from 9 April 2013.

(T09-0207)

Exploration Licence No. 7550, NEO RESOURCES LIMITED (ACN 007 708 429), Counties of Phillip and Wellington, Map Sheet (8832), area of 85 units, for a further term until 21 May 2014. Renewal effective on and from 9 April 2013.

(T09-0208)

Exploration Licence No. 7551, NEO RESOURCES LIMITED (ACN 007 708 429), Counties of Phillip and Wellington, Map Sheet (8732, 8832, 8833), area of 100 units, for a further term until 21 May 2014. Renewal effective on and from 9 April 2013.

(T09-0210)

Exploration Licence No. 7552, NEO RESOURCES LIMITED (ACN 007 708 429), Counties of Bligh, Phillip and Wellington, Map Sheet (8733, 8833), area of 73 units, for a further term until 21 May 2014. Renewal effective on and from 9 April 2013.

(T09-0264)

Exploration Licence No. 7553, NEO RESOURCES LIMITED (ACN 007 708 429), Counties of Phillip and Wellington, Map Sheet (8732, 8733, 8832, 8833), area of 100 units, for a further term until 21 May 2014. Renewal effective on and from 9 April 2013.



(T10-0040)

Exploration Licence No. 7599, GOLD AND COPPER RESOURCES PTY LIMITED (ACN 124 534 863), County of Ashburnham, Map Sheet (8631), area of 1 units, for a further term until 24 August 2014. Renewal effective on and from 9 April 2013.

The Hon. CHRIS HARTCHER, M.P.,  
Minister for Resources and Energy

---

#### REFUSAL OF APPLICATIONS FOR RENEWAL

NOTICE is given that the applications for renewal in respect of the following authorities have been refused:

(09-7088)

Exploration Licence No. 6894, RIMFIRE PACIFIC MINING NL (ACN 006 911 744), County of Murchison, Map Sheet (9037), area of 8 units. The authority ceased to have effect on 10 April 2013.

(07-0272)

Exploration Licence No. 7125, HILL END GOLD LIMITED (ACN 072 692 365), County of Wakool, Map Sheet (7627), area of 37 units. The authority ceased to have effect on 10 April 2013.

The Hon. CHRIS HARTCHER, M.P.,  
Minister for Resources and Energy

---

#### WITHDRAWAL OF APPLICATIONS FOR RENEWAL

NOTICE is given that the applications for renewal in respect of the following authorities have been withdrawn:

(T08-0159)

Petroleum Exploration Licence No. 472, ENERGETICA RESOURCES PTY LIMITED (ACN 113 926 042), Map Sheet (8028, 8029, 8030, 8127, 8128, 8129, 8130, 8228, 8229), area of 105 blocks. The authority ceased to have effect on 5 April 2013.

(T08-0160)

Petroleum Exploration Licence No. 473, ENERGETICA RESOURCES PTY LIMITED (ACN 113 926 042), Map Sheet (7827, 7828, 7829, 7830, 7928, 7929, 7930, 8028, 8029), area of 105 blocks. The authority ceased to have effect on 5 April 2013.

(T08-0161)

Petroleum Exploration Licence No. 474, ENERGETICA RESOURCES PTY LIMITED (ACN 113 926 042), Map Sheet (7730, 7731, 7830, 7831, 7930, 7931, 8030), area of 105 blocks. The authority ceased to have effect on 5 April 2013.

The Hon. CHRIS HARTCHER, M.P.,  
Minister for Resources and Energy

---

#### REQUESTED CANCELLATION OF AUTHORITY AT REQUEST OF HOLDER

NOTICE is given that the following authority has been requested to be cancelled:

(08-2423)

Exploration Licence No. 5714 (Act 1992), MALACHITE RESOURCES LIMITED (ACN 075 613 268), County of Buller, Map Sheet (9340), area of 3 units. Request of cancellation was received on 11 April 2013.

(T12-1073)

Exploration Licence No. 8002, ARK MINES LTD, (ACN 123 668 717), County of Cowper, Map Sheet (8136, 8137) area of 77 units. Request of cancellation was received on 9 April 2013

(T12-1074)

Exploration Licence No. 8003, ARK MINES LTD, (ACN 123 668 717), County of Cowper, Map Sheet (8136, 8236) area of 79 units. Request of cancellation was received on 9 April 2013.

(T12-1143)

Exploration Licence No. 7969, EMX EXPLORATION PTY LTD, (ACN 139 619 427), County of Young and Yungnulgra, Map Sheet (7435) area of 34 units. Request of cancellation was received on 11 April 2013

The Hon. CHRIS HARTCHER, M.P.,  
Minister for Resources and Energy

---

#### CANCELLATION OF AUTHORITY AT REQUEST OF HOLDER

NOTICE is given that the following authority has been cancelled:

(08-2423)

Exploration Licence No. 5714, MALACHITE RESOURCES LIMITED (ACN 075 613 268), County of Buller, Map Sheet (9340), area of 3 units. Cancellation took effect on 12 April 2013.

The Hon. CHRIS HARTCHER, M.P.,  
Minister for Resources and Energy

---

#### TRANSFERS

(06-0066)

Exploration Licence No. 6627, formerly held by OROYA MINING LIMITED (ACN 009 146 794) has been transferred to NEO RESOURCES LIMITED (ACN 007 708 429). The transfer was registered on 17 December 2012.

(06-0066)

Exploration Licence No. 6628, formerly held by OROYA MINING LIMITED (ACN 009 146 794) has been transferred to NEO RESOURCES LIMITED (ACN 007 708 429). The transfer was registered on 17 December 2012.

(06-0066)

Exploration Licence No. 6629, formerly held by OROYA MINING LIMITED (ACN 009 146 794) has been transferred to NEO RESOURCES LIMITED (ACN 007 708 429). The transfer was registered on 17 December 2012.

(06-0066)

Exploration Licence No. 6789, formerly held by OROYA MINING LIMITED (ACN 009 146 794) has been transferred to NEO RESOURCES LIMITED (ACN 007 708 429). The transfer was registered on 17 December 2012.

(06-0066)

Exploration Licence No. 7548, formerly held by OROYA MINING LIMITED (ACN 009 146 794) has been transferred to NEO RESOURCES LIMITED (ACN 007 708 429). The transfer was registered on 17 December 2012.



(06-0066)

Exploration Licence No. 7549, formerly held by OROYA MINING LIMITED (ACN 009 146 794) has been transferred to NEO RESOURCES LIMITED (ACN 007 708 429). The transfer was registered on 17 December 2012.

(06-0066)

Exploration Licence No. 7550, formerly held by OROYA MINING LIMITED (ACN 009 146 794) has been transferred to NEO RESOURCES LIMITED (ACN 007 708 429). The transfer was registered on 17 December 2012.

(06-0066)

Exploration Licence No. 7551, formerly held by OROYA MINING LIMITED (ACN 009 146 794) has been transferred to NEO RESOURCES LIMITED (ACN 007 708 429). The transfer was registered on 17 December 2012.

(06-0066)

Exploration Licence No. 7552, formerly held by OROYA MINING LIMITED (ACN 009 146 794) has been transferred to NEO RESOURCES LIMITED (ACN 007 708 429). The transfer was registered on 17 December 2012.

(06-0066)

Exploration Licence No. 7553, formerly held by OROYA MINING LIMITED (ACN 009 146 794) has been transferred to NEO RESOURCES LIMITED (ACN 007 708 429). The transfer was registered on 17 December 2012.

(06-0066)

Exploration Licence No. 7756, formerly held by OROYA MINING LIMITED (ACN 009 146 794) has been transferred to NEO RESOURCES LIMITED (ACN 007 708 429). The transfer was registered on 17 December 2012.

The Hon. CHRIS HARTCHER, M.P.,  
Minister for Resources and Energy

NOTICE is given that the following application has been received:

#### WITHDRAWAL OF TRANSFER APPLICATION

T10-0130

Exploration Licence No. 7677 (Act 1992), GOLD FIELDS AUSTRALASIA PTY LTD (ACN 087 624 600) to GOLD FIELDS AUSTRALASIA PTY LTD (ACN 087 624 600) and CLANCY EXPLORATION LIMITED (ACN 105 578 756), County Bogan Gate & Parkes, Map 8431 & 8531, area of 99 units. Withdrawal application received on 18 February 2012.

T10-0130

Exploration Licence No. 7676 (Act 1992), GOLD FIELDS AUSTRALASIA PTY LTD (ACN 087 624 600) to GOLD FIELDS AUSTRALASIA PTY LTD (ACN 087 624 600) and CLANCY EXPLORATION LIMITED (ACN 105 578 756), County Parkes & Peak Hill, Map 8531 & 8532, area of 66 units. Withdrawal application received on 18 February 2012.

T10-0130

Exploration Licence No. 7675 (Act 1992), GOLD FIELDS AUSTRALASIA PTY LTD (ACN 087 624 600) to GOLD FIELDS AUSTRALASIA PTY LTD (ACN 087 624 600) and CLANCY EXPLORATION LIMITED (ACN 105 578 756), County Boona Mount, Map Sheet 8332, area of 100 units. Withdrawal application received on 18 February 2012.

The Hon. CHRIS HARTCHER, M.P.,  
Minister for Resources and Energy

## PRIMARY INDUSTRIES

**EMERGENCY ANIMAL DISEASES AND  
EMERGENCY ANIMAL PESTS ORDER 2013**

under the Animal Diseases and Animal Pests (Emergency Outbreaks) Act 1991

I, KATRINA ANN HODGKINSON, M.P., Minister for Primary Industries, in pursuance of sections 6A and 6B of the Animal Diseases and Animal Pests (Emergency Outbreaks) Act 1991, make the following Order declaring certain animal diseases to be emergency animal diseases and certain animals to be emergency animal pests, for the purposes of that Act.

**1. Name of Order**

This Order is the Emergency Animal Diseases and Emergency Animal Pests Order 2013.

**2. Commencement**

This Order commences on the date it is signed.

Note: Sections 6A (2) (b) and 6B (2) (b) of the Act provide that this Order must be published in the *New South Wales Government Gazette* within 14 days after the date it is signed.

**3. Revocation of previous order declaring emergency animal diseases**

Pursuant to section 6A of the Act, the Order titled “Declaration of Emergency Animal Diseases for the Purposes of the Animal Diseases (Emergency Outbreaks) Act 1991” published in *New South Wales Government Gazette* No. 116 of 1 December 2011 at pages 6792 to 6794, is revoked (as is any Order revived as a result of this revocation).

**4. Definitions**

In this Order:

**animal** has the same meaning as in the Act.

**the Act** means the Animal Diseases and Animal Pests (Emergency Outbreaks) Act 1991.

**5. Declaration of emergency animal diseases**

Pursuant to section 6A of the Act, each animal disease specified in Schedule 1 is declared to be an emergency animal disease for the purposes of the Act.

Note: Section 6A (1) of the Act provides that “bovine spongiform encephalopathy”, “foot and mouth disease” and “rabies” are also emergency animal diseases for the purposes of the Act.

**6. Declaration of emergency animal pests**

Pursuant to section 6B of the Act, each animal specified in Schedule 2 is declared to be an emergency animal pest for the purposes of the Act.

\_\_\_\_\_

SCHEDULE 1 – Emergency Animal Diseases

Abalone viral ganglioneuritis

Acariasis Tracheal mite (*Acaraspis woodi*)

African horse sickness

African swine fever

Anthrax

Aujeszky’s disease

Australian bat lyssavirus

Avian influenza

Avian Paramyxovirus

Bluetongue

Borna disease

Bovine tuberculosis due to *Mycobacterium bovis*

Bovine Virus Diarrhoea Type 2

Braula fly (*Bee louse, Braula coeca*)

Brucellosis (*B.abortus, B.melitensis, B.suis, B.canis*)

Camelpox

Chagas’ disease (*T.cruzi*)

Chronic wasting disease of deer

Classical swine fever

Contagious agalactia

Contagious bovine pleuropneumonia

Contagious caprine pleuropneumonia

Contagious equine metritis

Crimean Congo Haemorrhagic Fever

Devil Facial Tumour Disease

Dourine

East Coast fever and Mediterranean theileriosis

Encephalitides (tick borne)

Enzootic abortion of ewes

Epizootic haemorrhagic disease (clinical disease)

Epizootic lymphangitis

Equine encephalomyelitis (Eastern, Western and Venezuelan)

Equine encephalosis

Equine herpes – virus 1 (neurological strain)

Equine influenza

Equine piroplasmosis (*Babesia equi, Babesia Caballi, Theileria equi*)

Feline spongiform encephalopathy

Fowl Typhoid (*Salmonella gallinarum*)

Getah virus infection

Glanders

Goat pox

Haemorrhagic septicaemia

Heartwater

Hendra virus infection

Infectious bursal disease (hypervirulent and exotic antigenic variant forms)

Japanese encephalitis

Jembrana disease

Leishmaniosis of any species

Lumpy skin disease

Maedi-visna

Malignant catarrhal fever (wildebeest associated)

Menangle virus infection

Nairobi sheep disease

Newcastle disease

Nipah virus infection

Peste des petits ruminants

Porcine enterovirus encephalomyelitis (Teschen)

Porcine reproductive and respiratory syndrome

Post-weaning multi-systemic wasting syndrome

Potomac fever

Pulmonary adenomatosis (Jaagsiekte)

Rift Valley fever

Rinderpest  
 Salmonellosis (*S.abortus-equi*)  
 Salmonellosis (*S.abortus-ovis*)  
 Scrapie  
 Screw-worm fly – New World (*Cochliomyia hominivorax*)  
 Screw-worm fly – Old World (*Cochliomyia bezziana*)  
 Sheep pox  
 Sheep scab  
 Surra (*Trypanosoma evansi*)  
 Swine influenza  
 Swine vesicular disease  
 Transmissible gastroenteritis  
 Transmissible spongiform encephalopathies  
 Trichinellosis  
 Tropilaelaps mite (*Tropilaelaps clareae*)  
 Trypanosomosis (tsetse fly associated)  
 Tularaemia  
 Turkey rhinotracheitis (avian metapneumovirus)  
 Varroasis (*Varroa destructor*)  
 Varroasis (*Varroa jacobsoni*)  
 Vesicular exanthema  
 Vesicular stomatitis  
 Virulent porcine circovirus  
 Warble-fly myiasis  
 Wesselsbron disease  
 West Nile virus infection

## SCHEDULE 2 – Emergency Animal Pests

Acariasis Tracheal mite (*Acaraspis woodi*)  
 Africanised honeybees  
 Asian honeybee (*Apis cerana*)  
 Braula fly (*Bee louse, Braula coeca*)  
 Dwarf honeybee (*Apis florea*)  
 Giant honeybee (*Apis dorsata*)  
 Screw-worm fly – New World (*Cochliomyia hominivorax*)  
 Screw-worm fly – Old World (*Cochliomyia bezziana*)  
 Tropilaelaps mite (*Tropilaelaps clareae*)  
 Varroa mite (*Varroa destructor*)  
 Varroa mite (*Varroa jacobsoni*)  
 Warble-fly  
 Red imported fire ant (*Solenopsis invicta*)  
 African big-headed ant (*Pheidole megacephala*)  
 Electric ant or little fire ant (*Wasmannia auropunctata*)  
 Tropical fire ant (*Solenopsis geminata*)  
 Yellow crazy ant (*Anoplolepis gracilipes*)  
 Argentine ant (*Linepithema humile*)

Dated this 12th day of April 2013.

KATRINA ANN HODGKINSON, M.P.,  
 Minister for Primary Industries

**FISHERIES MANAGEMENT ACT 1994**

Section 8 Notification – Fishing Closure

Murray crayfish (*Euastacus armatus*)

I, GEOFF ALLAN, Executive Director, Fisheries NSW, with the delegated authority of the Minister for Primary Industries and the Director General of the Department of Trade and Investment, Regional Infrastructure and Services pursuant to sections 227 and 228 of the Fisheries Management Act 1994 (“the Act”) and pursuant to section 8 of the Act, do by this notification prohibit the taking of Murray crayfish (*Euastacus armatus*) from all waters except the waters described in Column 1 of the Schedule to this notification and when taken in accordance with the conditions specified in Column 2 of the Schedule.

SCHEDULE

<i>Column 1</i> Waters	<i>Column 2</i> Conditions
<p>1. The waters of the Murrumbidgee River between the Hume Highway road bridge at Gundagai downstream to a line 100m upstream of the weir face at Berembed Weir near Ganmain; and</p> <p>2. The waters of the Murray River between a line 130m below the weir face at Hume Weir near Albury downstream to the Newell Highway road bridge at Tocumwal.</p> <p>In this Schedule: <b>waters</b> includes all tributaries, lakes, lagoons, dams, reservoirs, ponds, canals, channels or waterways of the main channel of the rivers, except Old Mans Creek which is a tributary of the Murrumbidgee River.</p>	<p>1. Murray crayfish may only be taken between 1 June and 31 August (inclusive) in each year;</p> <p>2. Any Murray crayfish taken must have a minimum occipital carapace length measurement (OCL) of 100mm and a maximum OCL of 120mm; and</p> <p>3. In any one day, a person must not:</p> <p>(a) take more than 2 Murray crayfish; and</p> <p>(b) be in possession of more than 4 Murray crayfish.</p>

This fishing closure is effective for a period of five (5) years commencing on publication of this notification, unless sooner amended or revoked.

Dated this 11th day of April 2013.

Dr GEOFF ALLAN,  
Executive Director,  
Fisheries NSW,  
Department of Primary Industries  
(an office within the Department of Trade and Investment Regional Infrastructure and Services)

## LANDS

**DUBBO CROWN LANDS OFFICE****45 Wingewarra Street (PO Box 1840), Dubbo NSW 2830****Phone: (02) 6883 3300 Fax: (02) 6884 2067****APPOINTMENT OF CORPORATION TO MANAGE  
RESERVE TRUST**

PURSUANT to section 95 of the Crown Lands Act 1989, the corporation specified in Column 1 of the Schedule hereunder, is appointed to manage the affairs of the reserve trust specified opposite thereto in Column 2, which is trustee of the reserve referred to in Column 3 of the Schedule.

ANDREW STONER, M.P.,  
Minister for Regional Infrastructure and Services

**SCHEDULE**

<i>Column 1</i>	<i>Column 2</i>	<i>Column 3</i>
Mid-Western Regional Council.	Mudgee Rural Fire Service Reserve Trust.	Reserve No.: 97493. Public Purpose: Bush fire brigade purposes. Notified: 26 October 1984. Reserve No.: 96958. Public Purpose: Bush fire brigade purposes. Notified: 16 September 1983. File No.: DB83 R 66.

For a term commencing this day.

**ESTABLISHMENT OF RESERVE TRUST**

PURSUANT to section 92(1) of the Crown Lands Act 1989, the reserve trust specified in Column 1 of the Schedule hereunder, is established under the name stated in that Column and is appointed as trustee of the reserve specified opposite thereto in Column 2 of the Schedule.

ANDREW STONER, M.P.,  
Minister for Regional Infrastructure and Services

**SCHEDULE**

<i>Column 1</i>	<i>Column 2</i>
Mudgee Rural Fire Service Reserve Trust.	Reserve No.: 97493. Public Purpose: Bush fire brigade purposes. Notified: 26 October 1984. Reserve No.: 96958. Public Purpose: Bush fire brigade purposes. Notified: 16 September 1983. File No.: DB83 R 66.

**APPOINTMENT OF TRUSTEES**

Eurunduree School of Arts

IT is hereby notified that the trustee positions held by Peter Joseph Rheinberger and John Muller have been declared vacant and the undermentioned persons have been elected as trustees at a special meeting of members held in accordance with the provisions of section 14 of the Trustees of Schools of Arts Enabling Act 1902.

I therefore as Minister for Regional Infrastructure and Services, in pursuance of the powers given me in the same section, hereby approve of Doug Grigg, Malcolm Roth, Bruce Stanford, Barry Wells, Glen Sargent and Cassandra Stanford being appointed as the trustees of the aforesaid institution and the land described as Lot 1, DP 921758.

File No.: 13/04003.

The Hon. ANDREW STONER, M.P.,  
Deputy Premier  
and Minister for Regional Infrastructure and Services

**GRAFTON OFFICE**  
**49-51 Victoria Street (PO Box 272), Grafton NSW 2460**  
**Phone: (02) 6640 3400 Fax: (02) 6642 5375**

**DISSOLUTION OF RESERVE TRUST**

PURSUANT to section 92(3) of the Crown Lands Act 1989, the reserve trust specified in Column 1 of the Schedule hereunder, which was established in respect of the reserve specified opposite thereto in Column 2 of the Schedule, is dissolved.

ANDREW STONER, M.P.,  
 Minister for Regional Infrastructure and Services

SCHEDULE

<i>Column 1</i>	<i>Column 2</i>
Nambucca Heads Boy Scouts (R97355) Reserve Trust.	Reserve No.: 97355. Public Purpose: Boy scouts. Notified: 20 July 1984. File No.: 08/6533.

**NOTIFICATION OF CLOSING OF A ROAD**

IN pursuance of the provisions of the Roads Act 1993, the road hereunder described is closed and the lands comprised therein cease to be public road and the rights of passage and access that previously existed in relation to the road is extinguished. Upon closing, title to the land, comprising the former public road, vests in the body specified in the Schedule hereunder.

ANDREW STONER, M.P.,  
 Minister for Regional Infrastructure and Services

Description

*Parish – West Coraki; County – Richmond;*  
*Land District – Casino; L.G.A. – Richmond Valley*  
 Road Closed: Lot 1, DP 1165893.  
 File No.: GF04 H 325.

Schedule

On closing, the land within Lot 1, DP 1165893 remains vested in the State of New South Wales as Crown Land.

**GRIFFITH OFFICE**  
**2nd Floor, Griffith City Plaza,**  
**120–130 Banna Avenue (PO Box 1030), Griffith NSW 2680**  
**Phone: (02) 6960 3600      Fax: (02) 6962 5670**

**NOTIFICATION OF CLOSING OF PUBLIC ROAD**

IN pursuance of the provisions of the Roads Act 1993, the road hereunder described is closed and the land comprised therein ceases to be a public road and the rights of passage and access that previously existed in relation to the road are extinguished. Upon closing, title to the land, comprising the former public road, vests in the body specified in the Schedule hereunder.

ANDREW STONER, M.P.,  
Minister for Regional Infrastructure and Services

Description

*Land District – Mirrool; L.G.A. – Griffith;  
Parish of Stanbridge; County of Cooper*

Lot 1, DP 1180838.

File No.: 11/12119 (W493699).

Schedule

On closing, title for the land in Lot 1, DP 1180838 remains vested in the Griffith City Council as operational land.

**MOREE OFFICE**  
**Frome Street (PO Box 388), Moree NSW 2400**  
**Phone: (02) 6752 5055 Fax: (02) 6752 1707**

**APPOINTMENT OF TRUST BOARD MEMBERS**

PURSUANT to section 93 of the Crown Lands Act 1989, the persons whose names are specified in Column 1 of the Schedules hereunder, are appointed for the terms of office specified, as members of the trust board for the reserve trust specified opposite thereto in Column 2, which has been established and appointed as trustee of the reserve referred to opposite thereto in Column 3 of the Schedules.

ANDREW STONER, M.P.,  
 Minister for Regional Infrastructure and Services

**SCHEDULE 1**

<i>Column 1</i>	<i>Column 2</i>	<i>Column 3</i>
Peter Stephen McDONNELL (new member). Robert Cecil PERCIVAL (re-appointment). Catherine REDDING (re-appointment). Paul REDDING (re-appointment). Jamie ROSS (re-appointment). Leslie Graham RICHARDSON (re-appointment). Christopher Henry DICKINSON (re-appointment).	Narrabri Racecourse Trust.	Dedication No.: 560025. Public Purpose: Racecourse and showground. Notified: 15 May 1912. File No.: ME81 R 87.

**Term of Office**

For a term commencing 22 April 2013 and expiring 21 April 2018.

**SCHEDULE 2**

<i>Column 1</i>	<i>Column 2</i>	<i>Column 3</i>
Cynthia BURBURY (new member). Helga HERNANDEZ-TAYLOR (new member). Helen McCOSKER (new member). Geoffrey Brian McCOSKER (re-appointment). Gweneth Una THOMAS (re-appointment). Margaret ROBINSON (re-appointment). Ivan ROCKEMER (new member).	Wallangra Recreation Reserve Trust.	Dedication No.: 560038. Public Purpose: Hall and war memorial. Notified: 2 December 1955. File No.: ME81 R 56.

**Term of Office**

For a term commencing this day and expiring 18 April 2018.



## NEWCASTLE OFFICE

437 Hunter Street, Newcastle NSW 2300 (PO Box 2185, Dangar NSW 2309)

Phone: (02) 4925 4104 Fax: (02) 4925 3517

## NOTIFICATION OF CLOSING OF A ROAD

IN pursuance of the provisions of the Roads Act 1993, the road hereunder described is closed and the lands comprised therein cease to be public road and the rights of passage and access that previously existed in relation to the road is extinguished. Upon closing, title to the land, comprising the former public road, vests in the body specified in the Schedule hereunder.

ANDREW STONER, M.P.,  
Minister for Regional Infrastructure and Services

## Description

*Parish – Hartington; County – Kennedy;  
Land District – Parkes; L.G.A. – Lachlan*

Road Closed: Lot 2, DP 1181854.

File No.: 08/0047.

## Schedule

On closing, the land within Lot 2, DP 1181854 remains vested in the State of New South Wales as Crown Land.

## Description

*Parish – Fitzroy; County – Kennedy;  
Land District – Parkes; L.G.A. – Lachlan*

Road Closed: Lot 1, DP 1183230.

File No.: CL/00720.

## Schedule

On closing, the land within Lot 1, DP 1183230 remains vested in the State of New South Wales as Crown Land.

## Description

*Parishes – Minjary, Caragabal, Berrigan and Jingerangle;  
Counties – Bland and Gipps;  
Land District – Forbes; L.G.A. – Weddin*

Road Closed: Lots 1 and 3-4, DP 1178106 (subject to easement/right of carriageway created by Deposited Plan 1178106).

File No.: CL/00582.

## Schedule

On closing, the land within Lots 1 and 3-4, DP 1178106 remains vested in the State of New South Wales as Crown Land.

## Description

*Parish – Wambo; County – Hunter;  
Land District – Singleton; L.G.A. – Singleton*

Road Closed: Lot 2, DP 1174927.

File No.: 10/14643.

## Schedule

On closing, the land within Lot 2, DP 1174927 remains vested in the State of New South Wales as Crown Land.

## Description

*Parish – Redbank; County – Gordon;  
Land District – Molong; L.G.A. – Wellington*

Road Closed: Lots 1-5, DP 1183574.

File No.: 11/11753.

## Schedule

On closing, the land within Lots 1-5, DP 1183574 remains vested in the State of New South Wales as Crown Land.

## Description

*Parish – Balfour; County – Westmoreland;  
Land District – Bathurst; L.G.A. – Oberon*

Road Closed: Lot 1, DP 1183045.

File No.: 12/00949.

## Schedule

On closing, the land within Lot 1, DP 1183045 remains vested in the State of New South Wales as Crown Land.

## Description

*Parish – Stannard; County – Beresford;  
Land District – Cooma; L.G.A. – Cooma-Monaro*

Road Closed: Lot 1, DP 1181470.

File No.: 07/4401:BA.

## Schedule

On closing, the land within Lot 1, DP 1181470 remains vested in the State of New South Wales as Crown Land.

## Description

*Parish – Cuddyong; County – Georgiana;  
Land District – Crookwell; L.G.A. – Upper Lachlan Shire*

Road Closed: Lot 1, DP 1182623.

File No.: GB07 H 168:BA.

## Schedule

On closing, the land within Lot 1, DP 1182623 remains vested in the State of New South Wales as Crown Land.

## Description

*Parish – Dananbilla; County – Monteagle;  
Land District – Young; L.G.A. – Young*

Road Closed: Lot 52, DP 1126153.

File No.: 12/05318:BA.

## Schedule

On closing, the land within Lot 52, DP 1126153 remains vested in the State of New South Wales as Crown Land.

## Description

*Parish – Edinburgh; County – Ashburnham;  
Land District – Molong; L.G.A. – Cabonne*

Road Closed: Lot 1, DP 1183575.

File No.: CL/00777.

## Schedule

On closing, the land within Lot 1, DP 1183575 remains vested in the State of New South Wales as Crown Land.

## Description

*Parish – Beneree; County – Bathurst;  
Land District – Orange; L.G.A. – Blayney*

Road Closed: Lot 1, DP 1182386.

File No.: CL/00240.

## Schedule

On closing, the land within Lot 1, DP 1182386 remains vested in the State of New South Wales as Crown Land.

## Description

*Parish – Warrangong; County – Forbes;  
Land District – Cowra; L.G.A. – Cowra*

Road Closed: Lot 1, DP 1182369.

File No.: CL/00841.

## Schedule

On closing, the land within Lot 1, DP 1182369 remains vested in the State of New South Wales as Crown Land.

## Description

*Parish – Bangaroo; County – Bathurst;  
Land District – Cowra; L.G.A. – Cowra*

Road Closed: Lot 3, DP 1183879.

File No.: 08/0043.

## Schedule

On closing, the land within Lot 3, DP 1183879 remains vested in the State of New South Wales as Crown Land.

**NOTICE OF PUBLIC PURPOSE PURSUANT TO  
SECTION 34A (2) (B) OF THE CROWN LANDS ACT  
1989**

PURSUANT to section 34A(2)(b) of the Crown Lands Act 1989, the Crown reserve specified in Column 1 of the Schedule is to be occupied for the additional purpose specified in Column 2 of the Schedule.

ANDREW STONER, M.P.,  
Minister for Regional Infrastructure and Services

## SCHEDULE

*Column 1*

Reserve No.: 65511.  
Public Purpose: Public  
recreation.  
Notified: 4 October 1935.  
Parish: Stanbridge.  
County: Cooper.

*Column 2*

Communication facilities.

**NOWRA OFFICE**  
**5 O'Keefe Avenue (PO Box 309), Nowra NSW 2541**  
**Phone: (02) 4428 9100      Fax: (02) 4421 2172**

**NOTIFICATION OF CLOSING OF A ROAD**

IN pursuance of the provisions of the Roads Act 1993, the road hereunder described is closed and the lands comprised therein cease to be public road and the rights of passage and access that previously existed in relation to the road is extinguished. Upon closing, title to the land, comprising the former public road, vests in the body specified in the Schedule hereunder.

ANDREW STONER, M.P.,  
Minister for Regional Infrastructure and Services

Description

*Parish – Kiama; County – Camden;*  
*Land District – Kiama; L.G.A. – Kiama*

Road Closed: Lot 1, DP 1182152.

File No.: 10/13197.

Schedule

On closing, the land within Lot 1, DP 1182152 remains vested in the State of New South Wales as Crown Land.

**TAMWORTH OFFICE**  
**25-27 Fitzroy Street (PO Box 535), Tamworth NSW 2340**  
**Phone: (02) 6764 5100      Fax: (02) 6766 3805**

**NOTIFICATION OF CLOSING OF A ROAD**

IN pursuance of the provisions of the Roads Act 1993, the road hereunder described is closed and the lands comprised therein cease to be public road and the rights of passage and access that previously existed in relation to the road is extinguished. Upon closing, title to the land, comprising the former public road, vests in the body specified in the Schedule hereunder.

ANDREW STONER, M.P.,  
Minister for Regional Infrastructure and Services

Description

*Parish – Moorowara; County – Parry;  
Land District – Tamworth; L.G.A. – Gunnedah*

Road Closed: Lot 1, DP 1181102.

File No.: 08/1539.

Schedule

On closing, the land within Lot 1, DP 1181102 remains vested in the State of New South Wales as Crown Land.

**WESTERN REGION OFFICE**  
**45 Wingewarra Street (PO Box 1840), Dubbo NSW 2830**  
**Phone: (02) 6883 5400 Fax: (02) 6884 2067**

**ERRATUM**

IN the *New South Wales Government Gazette* of 23 September 1988, under the heading "Reserves from Sale" being Reserve 230050 in the Parishes of Bolaira and Picton, County Yancowinna, the reference to the area should have read approximately 42 hectares and is shown hatched on the amended diagram hereunder.

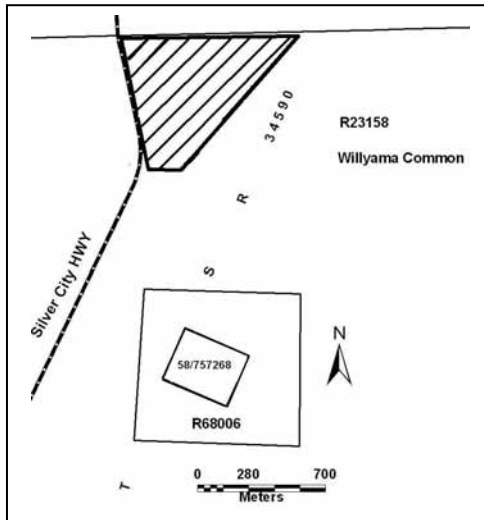

**WATER****WATER ACT 1912**

APPLICATIONS under the section 167 of Part 8 of the Water Act 1912, being within a proclaimed (declared) local area under section 5(4) have been received as follows:

MERAWAH (BOGGABILLA) PTY LIMITED for controlled works consisting of levees and channels on the Macintyre Floodplain, on Lots 54, 55 and 116, DP 756029, Parish Whalan, County Stapylton; Lot 6, DP 1117152; Lots 9 and 11, DP 756009 and Lot 7304, DP 1130811, Parish Merriwa, County Stapylton, on the property known as "Budleigh" (for the prevention of inundation of floodwaters and irrigation and drainage development) (new approval). (Reference: 90CW810816).

Maurice, Winifred Susan and Michael SIMSHAUSER for controlled works consisting of levees, channels and waterways on the Lower Namoi Floodplain, Lot 1, DP 1014459; Lot 341, DP 619108 and Lot 99, DP 803781, Parish Bobbiwaa, County Jamison, on the property known as "Cucabo", Narrabri (for the prevention of inundation of floodwaters and irrigation and drainage development) (new approval). (Reference: 90CW810907).

Jeffrey CAROLAN and Patricia CAROLAN for controlled works consisting of levees, channels and waterways on the Lower Namoi Floodplain, Lot 1, DP 1065140; Lot 1, DP 40676 and Lots 1, 18, 20, 21 and 29, DP 753940, Parish Long Point, County Jamison; Lots 4 and 24, DP 753925, Parish Denham, County Jamison, on the property known as "Widgee", Burren Junction (for the prevention of inundation of floodwaters, irrigation and drainage development and storage of water) (new approval). (Reference: 90CW810918).

R.C. SWANSBRA PTY LTD for controlled works consisting of levees on the Lower Namoi Floodplain, Lot 1, DP 722380 and Lot 2, DP 872142, Parish Gurleigh, County White, on the property known as "Lochelgin", Narrabri (for the prevention of inundation of floodwaters and irrigation and drainage development) (new approval). (Reference: 90CW810994).

Any inquiries regarding the above should be directed to (02) 6799 6621.

Written objections, from any local occupier or statutory authority, specifying grounds and how their interests are affected, must be lodged with the NSW Office of Water, PO Box 383, Narrabri NSW 2390, within 28 days of this publication.

ROBERT ALBERT,  
Senior Water Regulation Officer

## Other Notices

### ASSOCIATIONS INCORPORATION ACT 2009

Reinstatement of Cancelled Association Pursuant  
to Section 84

TAKE notice that the incorporation of EKALESIAMETOTISI SAMOA I BLACKTOWN INC (Y1944801) cancelled on 16 January 2009 is reinstated pursuant to section 84 of the Associations Incorporation Act 2009.

Dated this 17th day of April 2013.

ROBYNE LUNNEY,  
Manager, Case Management,  
Registry Services, NSW Fair Trading,  
Department of Finance & Services

### ASSOCIATIONS INCORPORATION ACT 2009

Reinstatement of Cancelled Association Pursuant  
to Section 84

TAKE notice that the incorporation of INVITATION TO LIFE INC (Y0688304) cancelled on 15 August 2008 is reinstated pursuant to section 84 of the Associations Incorporation Act 2009.

Dated this 17th day of April 2013.

ROBYNE LUNNEY,  
Manager, Case Management,  
Registry Services, NSW Fair Trading,  
Department of Finance & Services

### ASSOCIATIONS INCORPORATION ACT 2009

Reinstatement of Cancelled Association Pursuant  
to Section 84

TAKE notice that the incorporation of THE METHODIST CHURCH OF SAMOA IN MACQUARIEFIELD, AUSTRALIA, INCORPORATED (INC9877280) cancelled on 26/6/2006 is reinstated pursuant to section 84 of the Associations Incorporation Act 2009.

Dated this 17th day of April 2013.

ROBYNE LUNNEY,  
Manager, Case Management,  
Registry Services, NSW Fair Trading,  
Department of Finance & Services

### ASSOCIATIONS INCORPORATION ACT 2009

Reinstatement of Cancelled Association Pursuant  
to Section 84

TAKE notice that the incorporation of THE GOULBURN POLO AND PICNIC RACE CLUB INC. (Y0912531) cancelled on 26 September 2008 is reinstated pursuant to section 84 of the Associations Incorporation Act 2009.

Dated this 17th day of April 2013.

ROBYNE LUNNEY,  
Manager, Case Management,  
Registry Services, NSW Fair Trading,  
Department of Finance & Services

### DISTRICT COURT ACT 1973

District Court of New South Wales

Direction

PURSUANT to section 32 of the District Court Act 1973, I direct that the District Court shall sit in its civil jurisdiction at the place and time shown as follows:

Newcastle 10.00am 29 April 2013 (2 weeks)  
In lieu of 29 April 2013  
(3 weeks)

Dated this 11th day of April 2013.

R. O. BLANCH,  
Chief Judge

### DISTRICT COURT ACT 1973

District Court of New South Wales

Direction

PURSUANT to section 173 of the District Court Act 1973, I direct that the District Court shall sit in its criminal jurisdiction at the place and time shown as follows:

Bathurst 10.00am 21 October 2013 (5 weeks)  
In lieu of 21 October 2013  
(2 weeks)  
**Special Fixture**

Dated this 15th day of April 2013.

R. O. BLANCH,  
Chief Judge

### GEOGRAPHICAL NAMES ACT 1966

PURSUANT to the provisions of section 8 of the Geographical Names Act 1966, the Geographical Names Board hereby notifies that it proposes to assign the names listed hereunder as geographical names.

Any person wishing to make comment upon these proposals may within one (1) month of the date of this notice, write to the Secretary of the Board with that comment.

Proposed Name:	Sunshine Park
Designation:	Reserve
L.G.A.:	Bland Shire Council
Parish:	Ariah
County:	Bourke
L.P.I. Map:	Ariah Park
1:100,000 Map:	Barmedman 8329
Reference:	GNB 5640
Proposed Name:	Doreen Ross Reserve
Designation:	Reserve
L.G.A.:	Blacktown City Council
Parish:	St Matthew
County:	Cumberland
L.P.I. Map:	Riverstone
1:100,000 Map:	Penrith 9030
Reference:	GNB 5645

Proposed Name: Reay Park  
 Designation: Reserve  
 L.G.A.: Liverpool City Council  
 Parish: Cabramatta  
 County: Cumberland  
 L.P.I. Map: Liverpool  
 1:100,000 Map: Penrith 9030  
 Reference: GNB 5321

Proposed Name: Preston Park  
 Designation: Reserve  
 L.G.A.: Liverpool City Council  
 Parish: St Luke  
 County: Cumberland  
 L.P.I. Map: Liverpool  
 1:100,000 Map: Penrith 9030  
 Reference: GNB 5321

Proposed Name: MimosaPark  
 Designation: Reserve  
 L.G.A.: Liverpool City Council  
 Parish: St Luke  
 County: Cumberland  
 L.P.I. Map: Liverpool  
 1:100,000 Map: Penrith 9030  
 Reference: GNB 5321

Proposed Name: Charles Throsby Park  
 Designation: Reserve  
 L.G.A.: Liverpool City Council  
 Parish: Minto  
 County: Cumberland  
 L.P.I. Map: Liverpool  
 1:100,000 Map: Penrith 9030  
 Reference: GNB 5321

Proposed Name: Damour Park  
 Designation: Reserve  
 L.G.A.: Liverpool City Council  
 Parish: Holsworthy  
 County: Cumberland  
 L.P.I. Map: Liverpool  
 1:100 000 Map: Penrith 9030  
 Reference: GNB 5321

Proposed Name: Henry Robertson Park  
 Designation: Reserve  
 L.G.A.: Liverpool City Council  
 Parish: Cabramatta  
 County: Cumberland  
 L.P.I. Map: Liverpool  
 1:100,000 Map: Penrith 9030  
 Reference: GNB 5321

Proposed Name: Joe Daquino Park  
 Designation: Reserve  
 L.G.A.: Liverpool City Council  
 Parish: Cabramatta  
 County: Cumberland  
 L.P.I. Map: Liverpool  
 1:100 000 Map: Penrith 9030  
 Reference: GNB 5321

Proposed Name: Lydia Burton Park  
 Designation: Reserve  
 L.G.A.: Liverpool City Council  
 Parish: Cabramatta  
 County: Cumberland  
 L.P.I. Map: Liverpool  
 1:100 000 Map: Penrith 9030  
 Reference: GNB 5321

Proposed Name: Pavesi Park  
 Designation: Reserve  
 L.G.A.: Liverpool City Council  
 Parish: Cabramatta  
 County: Cumberland  
 L.P.I. Map: Liverpool  
 1:100 000 Map: Penrith 9030  
 Reference: GNB 5321

Proposed Name: GenaircoPark  
 Designation: Reserve  
 L.G.A.: Liverpool City Council  
 Parish: Cabramatta  
 County: Cumberland  
 L.P.I. Map: Liverpool  
 1:100 000 Map: Penrith 9030  
 Reference: GNB 5321

The position and the extent for these features are recorded and shown within the Geographical Names Register of New South Wales. This information can be accessed through the Board's website at [www.gnb.nsw.gov.au](http://www.gnb.nsw.gov.au)

In accordance with section 9 of the Geographical Names Act 1966 all submissions lodged may be subject to a Freedom of Information application and may be viewed by a third party to assist the Board in considering this proposal.

KEVIN RICHARDS,  
 A/Secretary

Geographical Names Board,  
 PO Box 143,  
 Bathurst NSW 2795

#### GEOGRAPHICAL NAMES ACT 1966

Notice of Proposal to Amend Address Locality Boundaries within the Wollongong Local Government Area

PURSUANT to the provisions of section 8 of the Geographical Names Act 1966, the Geographical Names Board hereby notifies that it proposes to amend the address locality boundary between Figtree and Unanderra in the Wollongong Local Government Area as shown on map GNB3686-4-A.

Map GNB3686-4-A may be viewed at the Council Administration Building at 41 Burelli Street, Wollongong and the Unanderra Library at the corner of Factory Road and the Princes Highway from Friday, 19 April 2013 until Monday, 20 May 2013.

A copy of map GNB3686-4-A will also be on display at the office of the Geographical Names Board, Land and Property Information, 346 Panorama Avenue, Bathurst NSW 2795 during the above dates. Details of this proposal may also be viewed and submissions lodged on the Geographical Names Board's internet site at [www.gnb.nsw.gov.au](http://www.gnb.nsw.gov.au).

Any person wishing to make comment upon this proposal may, prior to Monday, 20 May 2013, write to the Secretary of the Board with that comment. In accordance with section 9 of the Geographical Names Act 1966 all submissions lodged may be subject to a freedom of information application and may be viewed by third party to assist the Board in considering this proposal.

K. RICHARDS,  
 Secretary

Geographical Names Board  
 PO Box 143  
 Bathurst NSW 2795



## HOME BUILDING REGULATION 2004

Clause 28 (1)

Instrument

Qualification Requirements for an  
Endorsed Contractor Licence or Supervisor Certificate  
for General Building Work

I, Rod Stowe, Commissioner for Fair Trading, Department of Finance and Services, as the “Director-General” under the Home Building Regulation 2004 (“the Regulation”):

1. revoke all previous instruments in so far as they deal with the same matters as this Instrument; and
2. (a) determine the possession of qualifications or the passing of examinations specified in Column 1 of Table A to Schedule 1; and
  - (b) consider the possession of experience specified in Column 2 of Table A opposite the relevant matter in Column 1,
 to be necessary for an applicant for the issue of a Licence or Certificate.

This Instrument commences on the date on which it is signed (“the Commencement Date”).

Dated this 11th day of April 2013.

ROD STOWE,  
Commissioner for Fair Trading,  
Department of Finance and Services

**Interpretation**

In this Instrument:

The Commissioner for Fair Trading, Department of Finance and Services is the “Director-General” under the Home Building Act 1989 and the Regulation. See:

- paragraph (a) of the definition of “Director-General” in section 3 (1) of the Home Building Act 1989;
- clauses 28 (1) (a) and (3) of the Public Sector Employment and Management (Departmental Amalgamations) Order 2009; and
- clause 29 (1) of the Public Sector Employment and Management (Departments) Order 2011.

“the Act” means the Home Building Act 1989;

“*Australian University*” has the same meaning as in the Higher Education Act 2001 or successor legislation in force for the time being providing for the recognition of Australian universities;

References to “*Certificate*” and “*Licence*” are respectively to a supervisor certificate, or endorsed contractor licence, to do or supervise general building work;

“*Degree*” means a degree of any kind, excluding an associate degree, and in particular includes the degrees of doctor, master and bachelor;

The reference to a “*Diploma*” in Item 8 in Table C of Schedule 1, does not include a Diploma of: Building; Construction; Construction Management; Construction Economics; Applied Science (Building); Structural Engineering; or Quantity Surveying. On every other occasion the term “Diploma” is used in this Instrument it is to be given its ordinary meaning;

“*Experience*” means experience gained by the applicant as:

- (a) an employee of the holder of a contractor licence authorising the holder to do the class of residential building work in which the experience is gained; or
- (b) a person otherwise lawfully engaged by the holder of an endorsed contractor licence or supervisor certificate authorising its holder to supervise the class of residential building work in which the experience is gained and who has supervised and directed the applicant in the doing of the work,

and in respect of which the applicant is financially remunerated for their work during the relevant period;

“*National Training Package*” means a training package endorsed in accordance with the Policy for the Training Package Development and Endorsement Process, or such other similar policy replacing it, which is in force for the time being;

“*Owner-Builder Permit*” means an owner-builder permit issued under the Act or a similar authority issued under an Act of another State or Territory which authorises activities to be carried out which are substantially the same as those authorised by such an owner-builder permit;

“*registered training organisation*” has the same meaning as in the National Vocational Education and Training Regulator Act 2011 (Cth);

The reference to a “*Schedule*” is a reference to that schedule inclusive of any tables thereto.

“*TAFE*” means the New South Wales Technical and Further Education Commission.

## SCHEDULE 1

Table A

<b>Qualifications</b>	
<i>Column 1</i> <i>Qualifications or Examinations</i>	<i>Column 2</i> <i>Experience</i>
1. Completion of Certificate IV in Building and Construction, being: <ol style="list-style-type: none"> <li>(a) (BCG40106/CPC40108/CPC40110 Building); or</li> <li>(b) (BCG40206/CPC40208 Contract Administration) or</li> <li>(c) (BCG40306/CPC40308 Estimating); or</li> <li>(d) (BCG40506/CPC40508 Site Management),</li> </ol> including all of the units of competency listed in <b>Table B</b> .	At least two years’ relevant industry experience in a wide range of building construction work.

<i>Column 1 Qualifications or Examinations</i>	<i>Column 2 Experience</i>	<i>Column 1 Qualifications or Examinations</i>	<i>Column 2 Experience</i>
<p><b>AND</b></p> <p>I. an endorsed contractor licence or supervisor certificate held under the Act for Carpentry or Bricklaying which is current at the date of the application or a qualification approved for the time being under clause 28 (1) of the Regulation for such a licence or certificate; or</p> <p>II. Completion of a Diploma of Building and Construction (Building) (BCG50206/CPC50208/CPC50210) including, in respect of CPC50210 only, all of the units of competency listed in <b>Table C</b>.</p>		<p><b>AND</b></p> <p>Completion of Certificate IV in Building and Construction:</p> <p>(a) (BCG40106/CPC40108/CPC40110 Building); or</p> <p>(b) (BCG40206/CPC40208 Contract Administration); or</p> <p>(c) (BCG40306/CPC40308 Estimating); or</p> <p>(d) (BCG40506/CPC40508 Site Management), which includes <b>all</b> the units of competency listed in <b>Table B</b></p>	
<b>Transitional arrangements</b>			
<i>Column 1 Qualifications or Examinations</i>	<i>Column 2 Experience</i>	<i>Column 1 Qualifications or Examinations</i>	<i>Column 2 Experience</i>
2. Completion of a Degree in: <ul style="list-style-type: none"> <li>(a) Building; or</li> <li>(b) Construction; or</li> <li>(c) Construction Management; or</li> <li>(d) Construction Economics; or</li> <li>(e) Applied Science (Building); or</li> <li>(f) Quantity Surveying, from an Australian University which requires the applicant to undertake the equivalent of four years' full time study and a mandatory work placement.</li> </ul>	At least two years' relevant industry experience in a wide range of building construction work.	4. Existing Licence or Certificate A current Licence or Certificate without any restrictions or conditions held immediately before the Commencement Date.	N/A
3. Completion of a Bachelor of Housing from an Australian University or a Degree in any of the following: <ul style="list-style-type: none"> <li>(a) Civil Engineering; or</li> <li>(b) Structural Engineering; or</li> <li>(c) Architecture; or</li> <li>(d) Housing; or</li> <li>(e) Construction; or</li> <li>(f) Construction Management; or</li> <li>(g) Construction Economics; or</li> <li>(h) Applied Science (Building); or</li> <li>(i) Quantity Surveying, from an Australian University..</li> </ul>	At least two years' relevant industry experience in a wide range of building construction work.	5. Licence or Certificate held before the date of application A Licence or Certificate without any restrictions or conditions held within two years of the date of application for a new Licence or Certificate.	N/A
		6. Superseded Qualifications Any superseded qualification, as set out in <b>Table D</b> : <ul style="list-style-type: none"> <li>(a) which the applicant attained before 18 August 2008; or</li> <li>(b) the course for which the applicant commenced before, but did not complete until after, 18 August 2008, unless the context indicates that the applicant need not have attained, or commenced the course for, the qualification, or an element of the qualification, before 18 August 2008.</li> </ul>	At least 2 years' relevant industry experience in a wide range of building construction work.

TABLE B

Units of competency required for Certificate IV in Building and Construction
<p>The following units must be achieved and indicated in the applicant's transcript of the Certificate IV in Building and Construction qualification:</p> <ul style="list-style-type: none"> <li>(a) BCGBC4001A/CPCCBC4001A – Apply building codes and standards to the construction process for low-rise building projects;</li> <li>(b) BCGBC4002A/CPCCBC4002A – Manage occupational health and safety in the building and construction workplace;</li> <li>(c) BCGBC4003A/CPCCBC4003A – Select and prepare a construction contract;</li> <li>(d) BCGBC4004A/CPCCBC4004A – Identify and produce estimated costs for building and construction projects;</li> <li>(e) BCGBC4005A/CPCCBC4005A – Produce labour and material schedules for ordering;</li> <li>(f) BCGBC4006A/CPCCBC4006A/CPCCBC4006B – Select, procure and store construction materials for low-rise projects;</li> <li>(g) BCGBC4007A/CPCCBC4007A – Plan building or construction work;</li> <li>(h) BCGBC4008A/CPCCBC4008A/CPCCBC4008B – Conduct on-site supervision of the building and construction project;</li> <li>(i) BCGBC4009A/CPCCBC4009A/CPCCBC4009B – Apply legal requirements to building and construction projects;</li> <li>(j) BCGBC4010A/CPCCBC4010A/CPCCBC4010B – Apply structural principles to residential low rise constructions;</li> <li>(k) BCGBC4011A/CPCCBC4011A/CPCCBC4011B – Apply structural principles to commercial low rise constructions;</li> <li>(l) BSBSBM406A – Manage small business finances;</li> <li>(m) BCGBC4012A/CPCCBC4012A – Read and interpret plans and specifications;</li> <li>(n) BCGBC4018A/CPCCBC4018A – Apply site surveys and set out procedures to building and construction projects;</li> <li>(o) BCGBC4024A/CPCCBC4024A – Resolve business disputes.</li> </ul>

TABLE C

Units of competency required for Diploma of Building and Construction (Building) (CPC50210)
<p>The following units must be achieved and indicated in the applicant's transcript of the qualification:</p> <ul style="list-style-type: none"> <li>(a) CPCCBC5004A – Supervise and apply quality standards to the selection of building and construction materials;</li> <li>(b) CPCCBC5005A – Select and manage building and construction contractors;</li> <li>(c) CPCCBC5007A – Administer the legal obligations of a building and construction contract;</li> <li>(d) CPCCBC5009A – Identify services layout and connection methods in medium rise construction projects.</li> </ul>

TABLE D

Superseded Qualifications
<p>The following are superseded qualifications for the purposes of clause 6 of Schedule 1:</p> <ol style="list-style-type: none"> <li>1. Certificate IV in Building (3477) conducted by a Registered Training Organisation or TAFE <b>AND</b> –       <ul style="list-style-type: none"> <li>(a) a Carpentry, Carpentry &amp; Joinery, or Bricklaying Trade Course from TAFE or a Registered Training Organisation; or</li> <li>(b) an endorsed contractor licence or supervisor certificate held under the Act for Carpentry or Bricklaying which is current at the date of the application or a qualification approved for the time being under clause 28 (1) of the Regulation for such a licence or certificate.</li> </ul> </li> <li>2. Diploma in Building (3475) conducted by a Registered Training Organisation or TAFE.</li> <li>3. Advanced Diploma in Building (3471) conducted by a Registered Training Organisation or TAFE.</li> <li>4. Certificate IV in Building Studies (1261) from TAFE <b>AND</b> –       <ul style="list-style-type: none"> <li>(a) a Carpentry, Carpentry &amp; Joinery, or Bricklaying Trade Course from TAFE or a Registered Training Organisation; or</li> <li>(b) an endorsed contractor licence or supervisor certificate held under the Act for Carpentry or Bricklaying which is current at the date of the application or a qualification approved for the time being under clause 28 (1) of the Regulation for such a licence or certificate.</li> </ul> </li> <li>5. Diploma in Building Studies (1262) from TAFE.</li> <li>6. Advanced Diploma in Building Studies (1263) from TAFE.</li> <li>7. Advanced Diploma in Structural Engineering (6443) from TAFE.</li> </ol>

8. A Diploma from an Australian University or a body controlled by an Australia University which is a bridging or pathway course entitling the holder to enrol in a Degree in: Building; Construction; Construction Management; Construction Economics; Applied Science (Building); Structural Engineering; or Quantity Surveying at an Australian University, but only if the applicant has attained the Diploma before the 26 March 2012, **or** commenced the Diploma course before, but did not complete it until after, the 26 March 2012. 9. Certificate of Registration as an Architect under the Architects Act 2003 which is current at the date of the application.
10. Degree in Civil Engineering or Architecture from an Australian University regardless of when it was attained **AND** Certificate IV in Building (3477 or TAFE Course 1261).
11. Diploma of Structural Engineering (2992) from TAFE.
12. Associate Diploma in Applied Science (Building) (5185) TAFE.
13. Certificate in Building (5102) TAFE.
14. Certificate in Building Foreman & Clerk of Works (135) from TAFE.
15. Advanced Certificate in Building Supervision (5189) from TAFE.
16. Advanced Building Studies Course – Diploma in Building Studies Level V (2183) from TAFE.
17. Advanced Building Studies Course – Certificate IV in Building Studies – Residential Level IV (2182) from TAFE **AND** a Carpentry, Carpentry & Joinery, or Bricklaying Trade Course from TAFE or a Registered Training Organisation.
18. Certificate IV in Contractors Management Program conducted by Back to Basics Business Training Pty Ltd ACN 077 042 490 **AND** a Carpentry, Carpentry & Joinery, or Bricklaying Trade Course from TAFE or a Registered Training Organisation.

a period, as specified in the Table to be necessary for an applicant for the issue of a supervisor certificate or endorsed contractor licence in the following categories of residential building work:

- (a) Bricklaying;
- (b) Carpentry;
- (c) Decorating;
- (d) Dry plastering;
- (e) Erection of pre-fabricated metal-framed home additions and structures;
- (f) Fencing;
- (g) General concreting;
- (h) Glazing;
- (i) Joinery;
- (j) Kitchen, bathroom and laundry renovation;
- (k) Metal fabrication;
- (l) Minor maintenance and cleaning;
- (m) Minor tradework;
- (n) Painting;
- (o) Roof plumbing;
- (p) Roof slating;
- (q) Roof tiling;
- (r) Stonemasonry;
- (s) Structural landscaping;
- (t) Swimming pool repair and servicing;
- (u) Wall and floor tiling;
- (v) Waterproofing;
- (w) Wet plastering.

This Instrument commences on the date on which it is signed (“the Commencement Date”).

Dated this 4th day of April 2013.

ROD STOWE,  
Commissioner for Fair Trading,  
Department of Finance and Services

## HOME BUILDING REGULATION 2004

Clause 28 (1)

Instrument

Qualification Requirements for an  
Endorsed Contractor Licence or Supervisor Certificate  
for Residential Building Work in Various Categories

I, Rod Stowe, Commissioner for Fair Trading, Department of Finance and Services, as the “Director-General” under the Home Building Regulation 2004 (“the Regulation”):

1. revoke all previous instruments in so far as they deal with the same matters as this instrument; and
2. determine, pursuant to clauses 28 (1) (a) and (b) of the Regulation, the possession of qualifications or the passing of examinations or practical tests, or both, or the possession of experience of such a kind and for such

### Interpretation

1. In this Instrument:  
“**TAFE**” means the New South Wales Technical and Further Education Commission.
2. The Commissioner for Fair Trading, Department of Finance and Services is the “Director-General” under the Home Building Act 1989 and the Regulation. See:
  - paragraph (a) of the definition of “Director-General” in section 3 (1) of the Home Building Act 1989;
  - clauses 28 (1) (a) and (3) of the Public Sector Employment and Management (Departmental Amalgamations) Order 2009; and
  - clause 29 (1) of the Public Sector Employment and Management (Departments) Order 2011.

TABLE

<i>Category of residential building work</i>	<i>Qualification, examination, or experience</i>	<i>Category of residential building work</i>	<i>Qualification, examination, or experience</i>
Bricklaying	(1) Completion of CPC30111 Certificate III in Bricklaying/Blocklaying; <b>OR</b> (2) Completion of any of the following qualifications: (a) CPC30108 Certificate III in Bricklaying/Blocklaying; or (b) BCG30103 Certificate III in Bricklaying/Blocklaying; or (c) BCG30698 Certificate III in General Construction (Bricklaying/Blocklaying), TAFE course #8064; or (d) Qualification 4640 Certificate III in Bricklaying Trade TAFE course #2160; or (e) Certificate III in Bricklaying Trade TAFE course #5159.	Decorating	(1) Completion of CPC30611 Certificate III in Painting and Decorating; <b>OR</b> (2) Completion of any of the following qualifications: (a) CPC30608 Certificate III in Painting and Decorating; or (b) BCG30603 Certificate III in Painting and Decorating; or (c) BCG30498 Certificate III in General Construction (Painting & Decorating), TAFE course #8063; or (d) Qualification 11766 Certificate III in Painting and Decorating TAFE course #2155; or (e) Certificate III in Painting and Decorating Trade TAFE course #5129.
Carpentry	(1) Completion of: (a) CPC30211 Certificate III in Carpentry; or (b) CPC32011 Certificate III in Carpentry and Joinery; <b>OR</b> (2) Completion of any of the following qualifications: (a) CPC30208 Certificate III in Carpentry; or (b) CPC32008 Certificate III in Carpentry and Joinery; or (c) BCG30203 Certificate III in Carpentry; or (d) BCG30798 Certificate III in General Construction (Carpentry – – Framework/Formwork/Finishing), TAFE course #7078; or (e) Qualification 10888 Certificate III in General Construction (Carpentry)-Housing – – Trade TAFE Course #2192; or (f) Certificate III in Carpentry and Joinery Trade TAFE Course #2149; or (g) Certificate III in Carpentry and Joinery Trade TAFE Course #5158.	Dry plastering	(1) Completion of CPC31211 Certificate III in Wall and Ceiling Lining; <b>OR</b> (2) Completion of any of the following qualifications: (a) CPC31208 Certificate III in Wall and Ceiling Lining; or (b) BCG31203 Certificate III in Wall and Ceiling Lining; or (c) BCG30298 Certificate III in General Construction (Wall and Ceiling Lining) TAFE course #8062; or (d) Qualification 11764 Certificate III in Plastering Fibrous and Plasterboard – – Trade TAFE course #2153; or (e) Certificate III in Fibrous Plaster and Plasterboard – Trade TAFE course #0115.
		Erection of pre-fabricated metal-framed home additions and structures	(1) Completion of: (a) CPCCOHS1011A/CPCCOHS1001A Work safely in the construction industry; and (b) CPCCCM1012A/CPCCCM1002A Work effectively and sustainably in the construction industry; and (c) CPCCCM1013A/CPCCCM1003A Plan and organise work; and



<i>Category of residential building work</i>	<i>Qualification, examination, or experience</i>	<i>Category of residential building work</i>	<i>Qualification, examination, or experience</i>
Erection of pre-fabricated metal-framed home additions and structures (continued)	<ul style="list-style-type: none"> <li>(d) CPM1014A/ CPM1004A Conduct workplace communication; and</li> <li>(e) CPM1015A/ CPM1005A Carry out measurements and calculations; and</li> <li>(f) CPM2001A Read and interpret plans and specifications; and</li> <li>(g) CPCPRF3013A/ CPCPRF3003A Fabricate and install external flashings; and</li> <li>(h) CPM1011A/ CPM1001A Undertake basic estimation and costing; and</li> <li>(i) CPCPCM3011A/ CPCPCM3001A Flash penetrations through roofs and walls; and</li> <li>(j) either: <ul style="list-style-type: none"> <li>(i) CPM2005A – Use construction tools and equipment; or</li> <li>(ii) MEM18001C – Hand Tools and MEM18002B – Use power tools/hand held operations and MEM05005B – Carry out mechanical cutting; and</li> </ul> </li> <li>(k) CPCCBC4008A/ CPCCBC4008B Conduct on-site supervision of the building and construction projects; and</li> <li>(l) BSBCM209A Provide information to clients or BSBCUS201A Deliver a service to customers; and</li> <li>(m) CPCCA3002A Carry out setting out; and</li> <li>(n) CPCPCM2028A/ CPCPCM2008A Cut and join sheet metal; and</li> <li>(o) CPCPRF2012A/ CPCPRF2002A Select and install roof sheeting and wall cladding; and</li> <li>(p) CPCCCO2013A/ CPCCCO2003A Carry out concreting to simple forms; and</li> </ul>	Erection of pre-fabricated metal-framed home additions and structures (continued)	<ul style="list-style-type: none"> <li>(q) CPCCA3010A Install and replace windows and doors; and</li> <li>(r) BSBSMB405A/ BSBSMB405B Monitor and manage business operations;</li> </ul> <p><b>OR</b></p> <ul style="list-style-type: none"> <li>(2) Completion of the following units of competency: <ul style="list-style-type: none"> <li>(a) BCGCM1001B Follow OH&amp;S policies and procedures; and</li> <li>(b) BCGCM1002B Work effectively in the general construction industry; and</li> <li>(c) BCGCM1003B Plan and organise work; and</li> <li>(d) BCGCM1004B Conduct workplace communication; and</li> <li>(e) BCGCM1005B Carry out measurements and calculations; and</li> <li>(f) BCGCM2001B Read and interpret plans and specifications; and</li> <li>(g) BCPRF3003A Fabricate and install external flashings; and</li> <li>(h) BCGVE1004B Undertake basic estimation and costing; and</li> <li>(i) BCPCM3001A Flash penetrations through roofs and walls; and</li> <li>(j) BCGCM2005B Use construction tools; and</li> <li>(k) BCGBC4008A Conduct on-site supervision of the building and construction project or ABC082 Building Site Supervision; and</li> <li>(l) BSBCM209A Provide information to clients; and</li> <li>(m) BCGCA3002B Carry out setting out; and</li> <li>(n) BCGVE2001B Produce construction drawings; and</li> <li>(o) BCPCM2008A Cut and join sheet metal; and</li> <li>(p) BCPRF2002A Select and install roof sheeting and wall cladding; and</li> <li>(q) BCGCO2003B Carry out concreting to simple forms; and</li> </ul> </li> </ul>

<i>Category of residential building work</i>	<i>Qualification, examination, or experience</i>	<i>Category of residential building work</i>	<i>Qualification, examination, or experience</i>
Erection of pre-fabricated metal-framed home additions and structures <i>(continued)</i>	(r) BCGCA3010B Install and replace windows and doors; and BSBSBM405A Monitor and manage business operations.	Fencing <i>(continued)</i>	(b) BCGCM1002B Work effectively in the General Construction industry; and (c) BCGCM1003B Plan and organise work; and (d) BCGCM1004B Conduct workplace communication; and (e) BCGCM1005B Carry out measurements and calculations; and (f) BCGCM2001B Read and interpret plans and specifications; and (g) BCGCM2004B Handle construction materials; and (h) BCGCM2005B Use construction tools and equipment; and (i) BCGCM2006B Apply basic levelling procedures; and (j) BCCCM3001B Construct and dismantle fences and gates; and (k) BCGCM2009B Carry out basic demolition.
Fencing	(1) Completion of CPC10111 Certificate 1 in Construction with the following electives and additional units: (a) CPCCCM1015A Carry out measurements and calculations; and (b) CPCCCM2004A Handle construction materials or MEM05005B Carry out mechanical cutting; and (c) CPCCCM2006A Apply basic leveling procedures; and (d) CPCCCM2009A Carry out basic demolition; and (e) CPCCJN2001A Assemble components; and (f) CPCCOHS2001A Apply OHS requirements, policies and procedures in the construction industry;  <b>OR</b> (2) Completion of CPC10108 – – Certificate 1 in Construction with the following electives and additional units: (a) CPCCCM1005A Carry out measurements and calculations; and (b) CPCCCM2004A Handle construction materials or MEM05005B Carry out mechanical cutting; and (c) CPCCCM2006A Apply basic leveling procedures; and (d) CPCCCM2009A Carry out basic demolition; and (e) CPCCJN2001A Assemble components; and (f) CPCCOHS2001A Apply OHS requirements, policies and procedures in the construction industry;  <b>OR</b> (3) Completion of the following units of competency: (a) BCGCM1001B Follow OH&S policies and procedures; and	General concreting	(1) Completion of CPC30311 Certificate III in Concreting;  <b>OR</b> (2) Completion of any of the following qualifications: (a) CPC30308 Certificate III in Concreting; or (b) CPC31508/ CPC31511 Certificate III in Formwork/ Falsework; or (c) BCG30303 Certificate III in Concreting; or (d) TAFE course 4428 Certificate III in Construction Carpentry; or (e) Qualification 90203 Certificate III in Construction Carpentry Trade TAFE course #8044; or (f) Qualification 11770 Certificate III in Construction Carpentry, Trade TAFE course #7906.

<i>Category of residential building work</i>	<i>Qualification, examination, or experience</i>	<i>Category of residential building work</i>	<i>Qualification, examination, or experience</i>
Glazing	(1) Completion of LMF30611 Certificate III in Glass and Glazing (specialising in Glazing); <b>OR</b> (2) Completion of any of the following qualifications: (a) LMF30602 Certificate III in Glass & Glazing; or (b) TAFE Qualification 5792 Certificate III in Glass and Glazing Trade TAFE course #7958; or (c) Certificate III in Glass and Glazing TAFE course #2135; or (d) Certificate III in Glass Flat TAFE course #0109.	Joinery ( <i>continued</i> )	(k) Qualification 11760 Certificate III in Shopfitting Kitchen and Detailed Joinery, Trade TAFE course #2147; or (l) Certificate III in Shopfitting and Detailed Joinery Trade TAFE course #5122; or (m) MEM30603 Certificate III in Marine Craft Construction.
Joinery	(1) Completion of: (a) CPC31911/CPC31912 Certificate III in Joinery; or (b) CPC32011 Certificate III in Carpentry and Joinery; or (c) CPC31811/CPC31812 Certificate III in Shopfitting; or (d) LMF32109 Certificate III in Cabinet Making; <b>OR</b> (2) Completion of any of the following qualifications: (a) CPC31908 Certificate III in Joinery; or (b) CPC32008 Certificate III in Carpentry and Joinery; or (c) CPC31808 Certificate III in Shopfitting; or (d) LMF32109 Certificate III in Cabinet Making; or (e) BCF30100 Certificate III in Off Site Construction (Shop fitting); or (f) BCF30200 Certificate III in Off Site Construction (Joinery – Timber/Aluminium/Glass); or (g) LMF30302 Certificate III in Furniture Making; or (h) LMF30402 Certificate III in Furniture Making (Cabinet Making); or (i) LMF30502 Certificate III in Furniture Making (Wood Machinery); or (j) MEM30705 Certificate III in Marine Craft Construction; or	Kitchen, bathroom and laundry renovation	Applicants must hold one qualification from Group A <b>and</b> one from Group B, listed below. <b>Group A</b> Applicants must hold one of the following two Group A qualifications/licences: (1) Existing supervisor certificate or endorsed contractor licence in one of the following categories/classes: (a) Carpentry; or (b) Joinery; or (c) Plumbing; or (d) Wall and floor tiling; <b>OR</b> (2) Completion of a qualification from the list below: (a) CPC30211 Certificate III in Carpentry; or (b) CPC31311 Certificate III in Wall and Floor Tiling; or (c) CPC31911 Certificate III in Joinery; or (d) CPC32011 Certificate III in Carpentry and Joinery; or (e) CPC31811 Certificate III in Shopfitting; or (f) LMF32109 Certificate III in Cabinet Making (Kitchens and Bathrooms); or (g) CPC30208 Certificate III in Carpentry; or (h) CPC31308 Certificate III in Wall and Floor Tiling; or (i) CPC30908 Certificate III in Joinery; or (j) CPC32008 Certificate III in Carpentry and Joinery; or (k) CPC31808 Certificate III in Shopfitting; or (l) LMF32109 Certificate III in Cabinet making (Kitchens and Bathrooms); or



<i>Category of residential building work</i>	<i>Qualification, examination, or experience</i>	<i>Category of residential building work</i>	<i>Qualification, examination, or experience</i>
Kitchen, bathroom and laundry renovation <i>(continued)</i>	<p>(m) LMF32109 Certificate III in Cabinet making (Furniture); or</p> <p>(n) BCG30203 Certificate III in Carpentry; or</p> <p>(o) BCF30100 Certificate III in Off Site Construction (Shopfitting); or</p> <p>(p) LMF30302 Certificate III in Furniture Making; or</p> <p>(q) LMF30402 Certificate III in Furniture Making (Cabinet Making); or</p> <p>(r) LMF30502 Certificate III in Furniture Making (Wood Machinery); or</p> <p>(s) MEM30603 or MEM30705 Certificate III in Marine Craft Construction; or</p> <p>(t) BCG31303 Certificate III in Wall and Floor Tiling.</p> <p><b>Group B</b> Applicants must also hold one of the following six Group B qualifications:</p> <p>(1) Completion of the following units of competency:</p> <p>(a) BCGBC4001A/ CPCBC4001A Apply building codes and standards to the construction process for low-rise building projects; and</p> <p>(b) BCGBC4002A/ CPCBC4002A Manage occupational health and safety in the building and construction workplace; and</p> <p>(c) BCGBC4003A/ CPCBC4003A Select and prepare a construction contract; and</p> <p>(d) BCGBC4004A/ CPCBC4004A Identify and produce estimated costs for building and construction projects; and</p> <p>(e) BCGBC4005A/ CPCBC4005A Produce labour and material schedules for ordering; and</p> <p>(f) BCGBC4006A/ CPCBC4006A Select, procure and store construction materials for low-rise projects; and</p> <p>(g) BCGBC4007A/ CPCBC4007A Plan building or construction work; and</p>	Kitchen, bathroom and laundry renovation <i>(continued)</i>	<p>(h) BCGBC4008A/ CPCBC4008A Conduct on-site supervision of the building and construction project; and</p> <p>(i) BCGBC4009A/ CPCBC4009A Apply legal requirements to building and construction projects;</p> <p><b>OR</b></p> <p>(2) Completion of the following module from the TAFE Certificate IV in Plumbing Technology (8081) and units of competency:</p> <p>(a) 1496A Plumbing contracting principles; and</p> <p>(b) BCGBC4001A/ CPCBC4001A Apply building codes and standards to the construction process for low-rise building projects; and</p> <p>(c) BCGBC4004A/ CPCBC4004A Identify and produce estimated costs for building and construction projects; and</p> <p>(d) BCGBC4006A/ CPCBC4006A Select, procure and store construction materials for low-rise projects; and</p> <p>(e) BCGBC4007A/ CPCBC4007A Plan building or construction work;</p> <p><b>OR</b></p> <p>(3) Completion of the following units of competency from LMF40202 Certificate IV in Furnishing Technology and LMF30302 Certificate III in Furniture Making:</p> <p>(a) LMFFT4001A/LMFFT4001B Co-ordinate on site installation of furnishing products; and</p> <p>(b) LMFFT4009A/LMFFT4009B Match furnishing style/ materials to customer requirements; and</p> <p>(c) LMFGN3002A/ LMFGN3002B Estimate &amp; cost job; and</p> <p>(d) LMFFM3013A/ LMFFM3013B Measure &amp; draw site layout for manufactured furniture products; and</p>

<i>Category of residential building work</i>	<i>Qualification, examination, or experience</i>	<i>Category of residential building work</i>	<i>Qualification, examination, or experience</i>
Kitchen, bathroom and laundry renovation <i>(continued)</i>	<p>(e) LMFFM3005A/ LMFFM3005B Fabricate custom furniture; and</p> <p>(f) LMFFM3006A/ LMFFM3006B Install furniture products;</p> <p><b>OR</b></p> <p>(4) Completion of the following modules from Course 3477 Certificate IV in Building:</p> <p>(a) ABC005 Materials 1; and</p> <p>(b) ABC069 Cost Control and Planning 1; and</p> <p>(c) ABC077 Building Quantities and Estimating 1B; and</p> <p>(d) ABC082 Building Site Supervision; and</p> <p>(e) ABC091 Business Management for Building Industry 1A; and</p> <p>(f) ABC092 Business Management for Building Industry 1B; and</p> <p>(g) ABC102 Residential Site Safety; and</p> <p>(h) ABC088 Building Technology 1;</p> <p><b>OR</b></p> <p>(5) Completion of the following modules from the TAFE Certificate IV in Building Studies (1261):</p> <p>(a) 2182L Cost Control and Planning 1; and</p> <p>(b) 2182F Building Quantities and Estimating 1B; and</p> <p>(c) 2182H Building Site Supervision; and</p> <p>(d) 2182G Business Management for Building Industry 1A; and</p> <p>(e) 2182GG Business Management for Building Industry 1B; and</p> <p>(f) 2182J Residential Site Safety; and</p> <p>(g) 2182C Building Technology 1; and</p> <p>(h) 2182B Construction 1;</p> <p><b>OR</b></p> <p>(6) Completion of the following modules from the TAFE Certificate IV in Plumbing Technology (8081) and course 3477 Certificate IV in Building or TAFE Certificate IV in Building Studies (1261):</p>	Kitchen, bathroom and laundry renovation <i>(continued)</i>	<p>(a) 1496A Plumbing contracting principles; and</p> <p>(b) ABC005 Materials 1 or 2182A Materials 1; and</p> <p>(c) ABC077 Building Quantities and Estimating 1B or 2182F Building Quantities and Estimating 1B; and ABC088 Building Technology 1 or 2182C Building Technology 1</p>
		Metal fabrication	<p>(1) Completion of:</p> <p>(a) CPC31111 Certificate III in Steelfixing; or</p> <p>(b) CPC30711 Certificate III in Rigging, including CPCCRI3014A Perform advanced structural steel erection;</p> <p><b>OR</b></p> <p>(2) Completion of any of the following qualifications:</p> <p>(a) CPC31108 Certificate III in Steel Fixing; or</p> <p>(b) MEM30305 Certificate III in Engineering – Fabrication Trade; or</p> <p>(c) CPC30708 Certificate III in Rigging, including CPCCRI3005A Perform advanced structural steel erection; or</p> <p>(d) BCG31103 Certificate III in Steel Fixing; or</p> <p>(e) MEM30305 Certificate III in Engineering – Fabrication Trade; or</p> <p>(f) MEM30398 Certificate III in Engineering – Fabrication Trade; or</p> <p>(g) BCG30703 Certificate III in Rigging, including BCGRI3004B Perform advanced steel erection; or</p> <p>(h) BCG30998 Certificate III in General Construction (Materials Handling) TAFE course #8058; or BCG31298 Certificate III in General Construction (Concreting/Steelfixing).</p>

<i>Category of residential building work</i>	<i>Qualification, examination, or experience</i>	<i>Category of residential building work</i>	<i>Qualification, examination, or experience</i>
Minor maintenance and cleaning	<p>(1) Completion of CPC10111 Certificate I in Construction, including:</p> <ul style="list-style-type: none"> <li>(a) CPCCCM2004A Handle construction materials; and</li> <li>(b) CPCCCM1011A Undertake basic estimation and costing; and</li> <li>(c) additional units.</li> </ul> <p><u>Additional units:</u> Additional units of competency must be completed to support the type of minor maintenance or cleaning work to be undertaken, for example:</p> <ul style="list-style-type: none"> <li>• To undertake pressure washing/graffiti removal/brick cleaning work, in addition to the Certificate I above, completion of CPCCPD3029A Remove graffiti and apply protective coatings.</li> <li>• To undertake repair, resurfacing, or application of a protective coating to bathroom tiles, baths etc, in addition to the Certificate I above, completion of one of the following units: <ul style="list-style-type: none"> <li>– CPCCPD3030A Apply protective paint coating systems; or</li> <li>– CPCCWF3004A Repair wall and floor tiles.</li> </ul> </li> <li>• To undertake non-structural repair work, in addition to the Certificate I above, completion of CPCCPD2013A Remove and replace doors and door and window components.</li> </ul> <p><b>OR</b></p> <p>(2) Completion of CPC10108 Certificate I in General Construction, including:</p> <ul style="list-style-type: none"> <li>(a) CPCCCM2004A Handle construction materials; and</li> <li>(b) CPCCCM1001A Undertake basic estimation and costing; and</li> <li>(c) additional units.</li> </ul> <p><u>Additional units:</u> Additional units of competency must be completed to support the type of minor maintenance or cleaning work to be undertaken, for example:</p> <ul style="list-style-type: none"> <li>• To undertake pressure washing/graffiti removal/brick cleaning work, in addition to the Certificate I above, completion of CPCCPD3009A Remove graffiti and apply protective coatings.</li> </ul>	Minor maintenance and cleaning ( <i>continued</i> )	<ul style="list-style-type: none"> <li>• To undertake repair, resurfacing, or application of a protective coating to bathroom tiles, baths etc, in addition to the Certificate I above, completion of one of the following units: <ul style="list-style-type: none"> <li>– CPCCPD3010A Apply protective paint coating systems; or</li> <li>– CPCCWF3004A Repair wall and floor tiles.</li> </ul> </li> <li>• To undertake non-structural repair work, in addition to the Certificate I above, completion of CPCCPD2003A Remove and replace doors and door and window components.</li> </ul> <p><b>OR</b></p> <p>(3) Completion of BCG10103 Certificate I in General Construction including:</p> <ul style="list-style-type: none"> <li>(a) BCGVE1001B Handle construction materials; and</li> <li>(b) BCGVE1002B Undertake a basic construction project; and</li> <li>(c) BCGVE1004B Undertake basic estimation and costing; and</li> <li>(d) additional units.</li> </ul> <p><u>Additional units:</u> Additional units of competency must be completed to support the type of minor maintenance or cleaning work to be undertaken, for example: To undertake pressure washing/graffiti removal/brick cleaning work, in addition to the Certificate I above, completion of BCGPD3009B Remove graffiti and apply protective coatings.</p> <ul style="list-style-type: none"> <li>• To undertake repair, resurfacing, or application of a protective coating to bathroom tiles, baths etc, in addition to the Certificate I above, completion of one of the following two units: <ul style="list-style-type: none"> <li>– BCGPD3010B Apply protective paint coating systems; or</li> <li>– BCGWF3004B Repair wall and floor tiles.</li> </ul> </li> <li>• To undertake non-structural repair work, in addition to the Certificate I above, completion of the following three units: <ul style="list-style-type: none"> <li>– BCGCA2001B Handle carpentry materials; and</li> </ul> </li> </ul>

<i>Category of residential building work</i>	<i>Qualification, examination, or experience</i>	<i>Category of residential building work</i>	<i>Qualification, examination, or experience</i>
Minor maintenance and cleaning <i>(continued)</i>	<ul style="list-style-type: none"> <li>– BCGCA2002B Use carpentry tools and equipment; and</li> <li>– BCGPD2003B Remove and replace doors and door and window furniture.</li> </ul> <p><b>OR</b></p> <p>(4) Completion of BCG10198 Certificate I in Construction TAFE course #1206.</p>	Minor tradework <i>(continued)</i>	<p><b>OR</b></p> <p>(3) Completion of:</p> <p>(a) all of the following:</p> <ul style="list-style-type: none"> <li>(i) BCG10103 Certificate I in General Construction, including BCGVE1001B Handle construction materials; and</li> <li>(ii) BCGVE1002B Undertake a basic construction project; and</li> <li>(iii) BCGVE1004B Undertake basic estimation and costing; and</li> </ul> <p>(b) the following five units:</p> <ul style="list-style-type: none"> <li>(i) BCCCM2002B Use small plant and equipment; and</li> <li>(ii) BCCCM2007B Spread and compact materials manually; and</li> <li>(iii) BCCBS2001B Conduct tack coat spraying operations; and</li> <li>(iv) BCCBS2003B Safely handle bituminous materials; and</li> <li>(v) BCCBS2002B Hand spread asphalt.</li> </ul>
Minor tradework	<p>(1) Completion of:</p> <ul style="list-style-type: none"> <li>(a) CPC10111 Certificate I in Construction, including CPCCCM2004A Handle construction materials and CPCCCM1011A Undertake basic estimation and costing; and</li> <li>(b) additional units.</li> </ul> <p><u>Additional Units</u></p> <p>Additional units must be completed to support the type of minor trade work to be undertaken</p> <p><b>OR</b></p> <p>where there is no relevant unit, training by the relevant manufacturer, industry or supplier, must be undertaken</p> <p><b>OR</b></p> <p>alternative Certificate qualification must be completed where identified in this instrument.</p> <ul style="list-style-type: none"> <li>• To undertake <b>other</b> minor tradework, in addition to the Certificate I above, training by the relevant manufacturer, industry or supplier, must be completed.</li> <li>• To undertake <b>paving</b> minor tradework, completion of: <ul style="list-style-type: none"> <li>– CPC31611 Certificate III in Paving; or</li> <li>– CPC31608 Certificate III in Paving.</li> </ul> </li> <li>• To undertake <b>bituminous surfacing</b> minor tradework: <ul style="list-style-type: none"> <li>(1) Completion of RII20809 Certificate II in Bituminous Surfacing;</li> </ul> </li> </ul> <p><b>OR</b></p> <ul style="list-style-type: none"> <li>(2) Completion of RII31009 Certificate III in Bituminous Surfacing;</li> </ul>		<ul style="list-style-type: none"> <li>• To undertake <b>splash-backs</b> minor tradework, <ul style="list-style-type: none"> <li>(1) Completion of LMF10108 Certificate I in Furnishing including LMFGG2005C Move glass sheets by hand and LMFGG2001C Use glass and glazing sector hand and power tools</li> </ul> </li> </ul> <p><b>OR</b></p> <ul style="list-style-type: none"> <li>(2) Completion of LMF10102 Certificate I in Furnishing including LMFGG2001B Use glass and glazing sector hand and power tools</li> </ul> <ul style="list-style-type: none"> <li>• To undertake <b>kitchen/bathroom bench installation</b> minor tradework: <ul style="list-style-type: none"> <li>(1) Completion of LMF20309 Certificate II in Furniture Making;</li> </ul> </li> </ul>

<i>Category of residential building work</i>	<i>Qualification, examination, or experience</i>	<i>Category of residential building work</i>	<i>Qualification, examination, or experience</i>
Minor tradework (continued)	<p><b>OR</b></p> <p>(2) Completion of:</p> <p>(a) CPC10111 Certificate I in Construction, including CPCCCM2004A Handle construction materials and CPCCCM1011A Undertake basic estimation and costing; and</p> <p>(b) the following three units:</p> <p>(i) CPCCST2001A Prepare for stonemasonry construction process; and</p> <p>(ii) CPCCCA2011A Handle carpentry materials; and</p> <p>(iii) CPCCCA2002A Use carpentry tools and equipment;</p> <p><b>OR</b></p> <p>(1) Completion of:</p> <p>(a) CPC10108 Certificate I in Construction including CPCCCM2004A Handle construction materials and CPCCCM1001A Undertake basic estimation and costing; and</p> <p>(b) the following three units:</p> <p>(i) CPCCST2001A Prepare for stonemasonry construction process; and</p> <p>(ii) CPCCCA2001A Handle carpentry materials; and</p> <p>(iii) CPCCCA2002A Use carpentry tools and equipment;</p> <p><b>OR</b></p> <p>(2) Completion of:</p> <p>(a) BCG10103 Certificate I in General Construction including BCGVE1001B Handle construction materials and BCGVE1002B Undertake a basic construction project and BCGVE1004B Undertake basic estimation and costing; and</p>	Minor tradework (continued)	<p>(b) the following three units:</p> <p>(i) BCF1000A Prepare for construction process stonemasonry; and</p> <p>(ii) BCGCA2001B Handle carpentry materials; and</p> <p>(iii) BCGCA2002B Use carpentry tools and equipment.</p> <p>• To undertake <b>shower screen enclosure installation</b> minor tradework:</p> <p>(1) Completion of LMF10108 Certificate I in Furnishing including LMFGG2005C Move glass sheets by hand, LMFGG2001C Use glass and glazing sector hand and power tools; and LMFGG3015C Fabricate and install shower screen and wardrobe doors</p> <p><b>OR</b></p> <p>(2) Completion of:</p> <p>(a) CPC10111 Certificate I in Construction, including CPCCCM2004A Handle construction materials and CPCCCM1011A Undertake basic estimation and costing; and</p> <p>(b) the following four units:</p> <p>(i) CPCCSH2003A Apply and install sealant and sealant devices; and</p> <p>(ii) CPCCJN2001A Assemble components; and</p> <p>(iii) LMFGG1001A/ LMFGG1001B Complete a basic glass and glazing project; and</p> <p>(iv) LMFGG3015A/ LMFGG3015B Fabricate and install shower screen and wardrobe doors;</p>



<i>Category of residential building work</i>	<i>Qualification, examination, or experience</i>	<i>Category of residential building work</i>	<i>Qualification, examination, or experience</i>
Minor tradework (continued)	<p><b>OR</b></p> <p>(3) Completion of:</p> <p>(a) CPC10108 Certificate I in Construction, including CPCCCM2004A Handle construction materials and CPCCCM1001A Undertake basic estimation and costing; and</p> <p>(b) the following four units:</p> <p>(i) CPCCSH2003A Apply and install sealant and sealant devices; and</p> <p>(ii) CPCCJN2001A Assemble components; and</p> <p>(iii) LMFGG1001B Complete a basic glass and glazing project; and</p> <p>(iv) LMFGG3015B Fabricate and install shower screen and wardrobe doors;</p> <p><b>OR</b></p> <p>(4) Completion of:</p> <p>(a) BCG10103 Certificate I in General Construction, including BCGVE1001B Handle construction materials and BCGVE1002B Undertake a basic construction project and BCGVE1004B Undertake basic estimation and costing; and</p> <p>(b) the following four units:</p> <p>(i) BCF2018A Apply and install sealant and sealant devices; and</p> <p>(ii) BCF2013A Assemble components; and</p> <p>(iii) LMFGG1001A Complete a basic glass and glazing project; and</p> <p>(iv) LMFGG3015A Fabricate and install shower screen and wardrobe doors;</p>	Minor tradework (continued)	<ul style="list-style-type: none"> <li>• To undertake <b>shade sails and shade systems installation</b> minor tradework: <ul style="list-style-type: none"> <li>(1) Completion of: <ul style="list-style-type: none"> <li>(a) CPC10111 Certificate I in Construction, including CPCCCM2004A Handle construction materials and CPCCCM1011A Undertake basic estimation and costing; and</li> <li>(b) the following two units: <ul style="list-style-type: none"> <li>(i) CPCCCO2013A Carry out concreting to simple forms; and</li> <li>(ii) CPCCCM3003A Work safely around power sources, services and assets;</li> </ul> </li> </ul> </li> </ul> </li> </ul> <p><b>OR</b></p> <ul style="list-style-type: none"> <li>(2) Completion of LMF21108 Certificate II in Blind and Awnings.</li> </ul> <ul style="list-style-type: none"> <li>• To undertake <b>ducting and mechanical ventilation</b> minor tradework, a minimum of two years acceptable practical experience in carrying out ducting or mechanical ventilation work. Applicants are required to undertake a Licence Skills Assessment conducted by the Building Industry Skills Centre.</li> </ul>
		Painting	<p>(1) Completion of CPC30611 Certificate III in Painting and Decorating;</p> <p><b>OR</b></p> <p>(2) Completion of any of the following qualifications:</p> <ul style="list-style-type: none"> <li>(a) CPC30608 Certificate III in Painting and Decorating; or</li> <li>(b) BCG30603 Certificate III in Painting and Decorating; or</li> <li>(c) BCG30498 Certificate III in General Construction (Painting &amp; Decorating) TAFE course #8063; or</li> <li>(d) Qualification 11766 Certificate III in Painting and Decorating TAFE course #2155; or</li> <li>(e) Certificate III in Painting and Decorating, Trade TAFE course #5129.</li> </ul>

<i>Category of residential building work</i>	<i>Qualification, examination, or experience</i>	<i>Category of residential building work</i>	<i>Qualification, examination, or experience</i>
Roof plumbing	<p>(1) Completion of:</p> <p>(a) CPC32611/CPC32612 Certificate III in Roof Plumbing; or</p> <p>(b) CPC32411/CPC32512 Certificate III in Plumbing including the roofing stream;</p> <p><b>OR</b></p> <p>(2) Completion of any of the following qualifications:</p> <p>(a) CPC32608 Certificate III in Roof Plumbing; or</p> <p>(b) CPC32408 Certificate III in Plumbing including the roofing stream; or</p> <p>(c) Certificate III in Plumbing TAFE course 1270; or</p> <p>(d) BCP30303 Certificate III in Roof Plumbing; or</p> <p>(e) BCP30103 Certificate III in Plumbing including the roofing stream; or</p> <p>(f) Qualification 90119 Certificate III in Metal Roofing Trade TAFE course #7997; or Qualification Certificate in Metal Roofing Trade TAFE course #1424.</p>	Roof tiling	<p>(1) Completion of CPC30811/ CPC30812 Certificate III in Roof Tiling;</p> <p><b>OR</b></p> <p>(2) Completion of any of the following qualifications:</p> <p>(a) CPC30808 Certificate III in Roof Tiling; or</p> <p>(b) BCG30803 Certificate III in Roof Tiling; or</p> <p>(c) BCG30898 Certificate III in General Construction (Roof Tiling) TAFE course #7074; or</p> <p>(d) Qualification 5688 Certificate III in Roof Tiling Trade TAFE course #7948.</p>
Roof slating	<p>(1) Completion of CPC30811/ CPC30812 Certificate III in Roof Tiling including CPCCRT3005A Slate a roof.</p> <p><b>OR</b></p> <p>(2) Completion of any of the following qualifications:</p> <p>(a) CPC30808 Certificate III in Roof Tiling including CPCCRT3005A Slate a roof; or</p> <p>(b) BCG30803 Certificate III in Roof Tiling including BCGRT3005B Slate a roof; or</p> <p>(c) BCG30898 Certificate III in General Construction (Roof Tiling) TAFE course #7074; or Qualification 5688 Certificate III in Roof Tiling Trade TAFE course #7948.</p>	Stonemasonry	<p>(1) Completion of CPC32311 Certificate III in Stonemasonry (Monumental/Installation);</p> <p><b>OR</b></p> <p>(2) Completion of any of the following qualifications:</p> <p>(a) CPC32308 Certificate III in Stonemasonry (Monumental/Installation); or</p> <p>(b) BCF30600 Certificate III in Stonemasonry (Monumental/Installation); or</p> <p>(c) Completion of Qualification 15765 Certificate III in Stonemasonry TAFE course #8032; or</p> <p>(d) Qualification Certificate III in Stonemasonry TAFE course #2109; or</p> <p>(e) Certificate III in Stonemasonry, Trade TAFE course #5138.</p>
		Structural Landscaping	<p>(1) Completion of AHC30910 Certificate III in Landscape Construction;</p> <p><b>OR</b></p> <p>(2) Completion of any of the following qualifications:</p> <p>(a) RTF30403 Certificate III in Horticulture (Landscape); or</p> <p>(b) RUH30498 Certificate III in Horticulture (Landscape) TAFE course #0672; or</p> <p>(c) Certificate III in Landscaping TAFE course #1581.</p>

<i>Category of residential building work</i>	<i>Qualification, examination, or experience</i>	<i>Category of residential building work</i>	<i>Qualification, examination, or experience</i>
Swimming pool repairs and servicing	(1) Completion of CPP31212 Certificate III Swimming Pool and Spa Service; <b>OR</b> (2) Completion of 91520NSW Certificate III in Swimming Pool Repairs, Servicing and Interior Finishes.	Wet plastering	(1) Completion of CPC31011 Certificate III in Solid Plastering; <b>OR</b> (2) Completion of any of the following qualifications: (a) CPC31008 Certificate III in Solid Plastering; or (b) BCG31003 Certificate III in Solid Plastering; or (c) BCG30398 Certificate III in General Construction (Solid Plastering) TAFE course #8065; or (d) Qualification 11762 Certificate III in Plastering Solid Trade TAFE course #2154; or (e) Certificate III in Solid Plastering, Trade TAFE course #0114.
Wall and floor tiling	(1) Completion of CPC31311 Certificate III in Wall and Floor Tiling; <b>OR</b> (2) Completion of any of the following qualifications: (a) CPC31308 Certificate III in Wall and Floor Tiling; or (b) BCG31303 Certificate III in Wall and Floor Tiling; or (c) BCG30198 Certificate III in Wall and Floor Tiling TAFE course #8061; or (d) Qualification 11768 Certificate III in Tiling Wall and Floor TAFE course #2157; or (e) Certificate III in Tiling Wall and Floor Trade TAFE course #5123.	Any of the above categories	<b>Existing supervisor certificate or endorsed contractor licence immediately before the Commencement Date</b> A New South Wales supervisor certificate or endorsed contractor licence in the same category held immediately before the Commencement Date.
Waterproofing	(1) Completion of CPC31411 Certificate III in Construction Waterproofing; <b>OR</b> (2) Completion of one of the following qualifications: (a) CPC31408 Certificate III in Construction Waterproofing; or (b) BCG31403 Certificate III in Waterproofing (General Construction); or (c) Qualification 90464 Certificate III in General Construction (Waterproofing) TAFE course #8126.	Any of the above categories	<b>Supervisor certificate or endorsed contractor licence held before the Commencement Date but not at the Commencement Date</b> A New South Wales supervisor certificate or endorsed contractor licence in the same category ever held before the Commencement Date but not at the Commencement Date, will meet the requirement for issue of an equivalent authority.

### LOCAL GOVERNMENT ACT 1993

#### Proclamation

The Hon. Thomas Frederick Bathurst,  
Lieutenant-Governor

I, the Honourable Thomas Frederick Bathurst, Lieutenant-Governor of the State of New South Wales, with the advice of the Executive Council, and in pursuance of section 218B of the Local Government Act 1993, hereby alter the boundaries of the Area of Gunnedah Shire as described by Proclamation in *New South Wales Government Gazette* No. 61 of 7 May 2010, the Area of Liverpool Plains Shire as described by Proclamation in *New South Wales Government Gazette* No. 86 of 19 May 2004 and the Area of Warrumbungle Shire as described by Proclamation in *New South Wales Government Gazette* No. 61 of 7 May 2010, by transferring part of the



Area of Gunnedah Shire described in Schedule A hereto and adding it to the Area of Liverpool Plains Shire, by transferring part of the Area of Liverpool Plain Shire described in Schedule B hereto and adding it to the Area of Gunnedah Shire and by transferring part of the Area of Warrumbungle Shire described in Schedule C hereto and adding it to the Area of Gunnedah Shire, so that the boundary of the Area of Gunnedah Shire, the boundary of the Area of Liverpool Plains Shire and the boundary of the Area of Warrumbungle Shire shall be as described in Schedules D, E and F hereto.

Signed and sealed at Sydney, this 10th day of April 2013.

By His Excellency's Command,

DON PAGE, M.P.,  
Minister for Local Government

GOD SAVE THE QUEEN!

—————  
SCHEDULE A:

Areas to be transferred from Gunnedah Shire  
to Liverpool Plains Shire

Area about 317.7 hectares: Being Part of Lot 31,  
DP 1165474

—————  
SCHEDULE B:

Areas to be transferred from Liverpool Plains Shire  
to Gunnedah Shire

Area about 1.19 hectares: Being Part of Lot 2, DP 596840

—————  
SCHEDULE C:

Areas to be transferred from Warrumbungle Shire  
to Gunnedah Shire

Area about 1 786.94 hectares: Being Part of Lot 78,  
DP 755479

—————  
SCHEDULE D:

Gunnedah Shire (as altered)

Area about 4899.64 square kilometres: Commencing at the confluence of Bomera and Cocks Creeks; and bounded thence by Bomera Creek upwards to the north-eastern corner of Portion 42, Parish of Tambar, County of Pottinger; by the northern and part of the western boundary of that portion westerly and southerly to the north-eastern corner of Portion 46; by the northern boundary of that portion and Portion 9, a line, the northernmost boundary of Portion 33, Parish of Wilson, and the generally northern boundary of Portion 18, generally westerly to the north-western corner of the said Portion 18; by a line north to the southern boundary of Portion 63, Parish of Urangera; by part of that boundary, the generally southern boundary of Portion 43, the generally western boundary of the said Portion 43 and Portions 24, 54 and 44 of that parish and Portion 15, Parish of Nombi, generally westerly and northerly to the north-western corner of the said Portion 15; by the northern boundary of that portion and Portion 9 and part of the northern boundary of Portion 29, Parish of Bingle, easterly to the south-western corner of Portion 25; by the western boundary of that portion and the westernmost and part of the westernmost northern boundary of Portion 100, northerly and easterly to the south-western corner of Portion 33; by a line along the western boundary of that portion and Portion 34, northerly to the southern boundary of Portion 87; by part of that boundary and the eastern boundary of that portion; easterly and northerly; by a line

along the generally northernmost northern boundary of Portion 101 and the northern boundary of Portion 105 and its prolongation generally easterly to Cocks Creek, aforesaid; by that creek downwards to the generally southern boundary of the Parish of Coagal; by that boundary generally westerly and part of the generally western boundary of that parish northerly, the south-eastern and north-eastern boundaries of Portion 195, north-easterly and north-westerly, the north-eastern boundary of Lot 1, DP 254370, north-westerly to the generally western boundary of the Parish of Coagal; again by part of that boundary generally northerly to the northernmost southern boundary of Portion 191; by that boundary and its prolongation easterly to the southern prolongation of the westernmost western boundary of Portion 54; by that prolongation and boundary and the western boundaries of Portion 53, a line, Lot 6, DP 700969, Portions 50, a line, 194, 49 and the westernmost western boundary of Portion 46 and its prolongation northerly to the southern side of the road from Derwentville Homestead to Oak Vale Homestead; by that side of that road westerly to the southern prolongation of the eastern boundary of Portion 85, Parish of Denison; by that prolongation and boundary and the northern and the western (and its prolongation) boundaries of that portion, northerly, westerly and southerly to the generally northern boundary of the Parish of Brigalow; by part of that boundary generally westerly to Kerringle Creek; by that creek upwards to a point about 221.3 metres east of the south-western corner of Portion 7, Parish of Denison West; by a line south to a point east of the south-eastern corner of Portion 2; by a line west to that corner; by the generally southern boundary of that portion and the southern and western boundaries of Lot 157, DP 755492, generally south-westerly to the western prolongation of the southern boundary of that lot, westerly to the boundaries of Lot 78, DP 755479, by these boundaries southerly, easterly, southerly, westerly and northerly, by part of the generally southern and north-western boundaries of the Parish of Denison West generally westerly and north-easterly to its intersection with a line along the northern boundary of Portion 11; by that line and the northern boundary of Portions 11, 12 and 10, easterly to the western boundary of Portion 17; by a line along that boundary northerly to the southern boundary of Portion 16; by a line along that boundary and a line along the western boundary of Portions 25, 26 and 3, easterly and northerly to the southern boundary of Portion 55, Parish of Walla Walla West; by part of that boundary, the generally southern boundary of Portion 45 and a line along the eastern boundary of that portion and Portion 33 generally easterly and northerly to the south-eastern corner of Portion 48; by boundaries of that portion westerly, northerly and easterly to a line along the eastern boundary of Portion 38; by that line northerly to the southern boundary of Portion 15, by part of that boundary, the eastern and part of the northern boundary of that portion, easterly, northerly and westerly to the westernmost south-western corner of Portion 47; by the westernmost boundary of that portion and a line, northerly to the southernmost south-western corner of Portion 20; by a line along the southernmost boundary of that portion and the southern boundary of Portions 12 and 56, easterly to the westernmost south-western corner of Portion 50, Parish of Walla Walla; by boundaries of that portion, a line along the northern boundary of Portion 38 and the generally northern boundary of Portion 27, northerly, easterly, southerly and generally easterly to the north-western corner of Portion 53; by the northernmost northern boundary of that portion, the northern boundaries of Portions 86 and 54, a line and the northern boundary of Portion 17, generally easterly to Cocks Creek, aforesaid; by that creek downwards to the northern

boundary of Portion 39, Parish of Gulligal; by that boundary, the generally western and a line along the southern boundary of Portion 198, easterly, generally southerly and again easterly to the western boundary of Portion 173; by part of the western and southern boundaries of that portion southerly and easterly to the centreline of the North Western Railway lands; by that centreline south-easterly to the generally southern boundary of the said Parish of Gulligal; by part of that boundary generally easterly to the western boundary of Portion 35; by a line along that boundary and the western boundary of Portion 34 northerly to the Namoi River; by that river downwards to the southernmost corner of Portion 141, Parish of Boggabri, County of Nandewar; by part of the generally northern boundary of the Parish of Bentry generally easterly to the north-western corner of Portion 27; by the northern boundary of that portion and a line easterly to the western boundary of Portion 31, Parish of Tulcumba; by part of the generally western boundary of that parish, the generally western and northern boundaries of the Parish of Willuri, generally northerly and generally easterly to Barneys Spring Creek; by that creek, upwards to the generally eastern boundary of the Parish of Mihi; by that boundary, generally northerly, the south-eastern boundary of Portion 14, north-westerly to the generally north-western boundary of the Parish of Rangira; by part of that boundary, the generally north-eastern and generally south-eastern boundaries of that parish, generally north-westerly, generally south-easterly and generally south-westerly, the generally eastern boundary of the Parish of Willuri and part of the generally eastern boundary of the Parish of Tulcumba, generally southerly to the north-western corner of Portion 74, Parish of Namoi, County of Darling; by the northern and eastern boundaries of that portion and part of the eastern boundary of Portion 56, easterly and southerly to a point west of the south-western corner of Portion 82, Parish of Dowe; by a line east to a point south of the southernmost south-eastern corner of Portion 68; by a line north to that corner; by a line east to Namoi River, aforesaid; by that river upwards to the northern boundary of Portion 246, Parish of Keepit; by that boundary and part of the eastern boundary of that portion easterly and southerly to the intersection of the latter boundary with a line along the northern boundary of Portion 119; by that line, that boundary, part of the eastern boundary of that portion and the northern, eastern and a line along the southern boundary of Portion 118, generally easterly, southerly and westerly to the eastern boundary of Portion 58; by part of that boundary and a line along the southern boundary of that portion and Portions 59 and 60, southerly and westerly to the eastern boundary of Portion 22; by a line along that boundary and the eastern boundary of Portions 63 and 69, southerly to the south-eastern corner of the said Portion 69; by the southern boundary of that portion, the southern boundary and a line along the south-western boundary of Portion 64, westerly and north-westerly to the north-eastern corner of Portion 250; by the north-eastern and south-eastern boundaries of that portion, south-easterly and south-westerly, part of the north-eastern boundary of Portion 41 and the north-eastern boundaries of Portions 185, 186, 187, 224, 188, 161 and 227, south-easterly, by a southern, an eastern, again a southern, a western, again a southern and an eastern boundary of the said Portion 227, westerly, southerly, again westerly, northerly, again westerly and southerly to the east most north-eastern corner of Portion 226; by an eastern, a southern, again an eastern, again a southern and again an eastern boundary of that portion, southerly, westerly, again southerly, again westerly and again southerly to the Namoi River, aforesaid; by that river downwards and the Peel River upwards to the northern prolongation of the eastern boundary

of portion 44, Parish of Moorowara, County of Parry; by that prolongation, boundary and part of the southern boundary of that portion, southerly and westerly, the west most western boundary of Portion 97 and it's prolongation, southerly to the generally south-western boundary of the County of Parry; by part of that boundary, generally south-easterly, the generally eastern boundary of the Parish of Babbinsboon, County of Buckland; by that boundary and part of the generally eastern boundary of the parish of Denver, generally southerly, part of the north-eastern, the south-eastern and part of the south-western boundaries of Lot 152, DP 751012, south-easterly, south-westerly and north-westerly, again, the generally eastern boundary of the Parish of Denver, generally southerly, part of the northern and part of the eastern boundaries of the Parish of Mooki, easterly and southerly, the generally northern, the generally western and the generally south-eastern boundaries of Lot 7, DP 182211, generally westerly, generally southerly and generally north-easterly, again, the eastern and part of the southern boundaries of the Parish of Mooki, southerly to the north-eastern corner of Lot 31, DP 1165474, by the generally northern and western boundaries of that lot, generally westerly, southerly and easterly to the generally eastern boundary of the Parish of Ferrier; by that boundary and southern boundaries of the Parish of Ferrier, generally southerly and westerly to the north-eastern corner of portion 108, Parish of Wallala; by a line along the eastern boundary of the said portion 108 southerly, the south-eastern boundaries of Lots 3, 2 and 1, DP 1045187, south-westerly, the eastern and northern boundaries of Lot 105, DP 751032, northerly and westerly, a line westerly, part of the eastern, northern and western boundaries of Lot 91, DP 751032, northerly, westerly and southerly, the eastern prolongation of the southern boundary of Lot 101, DP 751032 and that boundary, westerly, the southern and western boundaries of Lot 100, DP 751032, westerly and northerly, the northern boundary of Lot 68, DP 751032 and it's prolongation, westerly, the northern boundary of Lot 71, DP 751032 and it's prolongation, westerly to Mooki River; by that river upwards to the eastern prolongation of the northern boundary of Lot 214, DP755494; by that prolongation, boundary and the western boundary of that lot, westerly and southerly to the generally southern boundary of the Parish of Doone, County of Pottinger; by the generally southern boundary of that parish and the generally southern boundary and part of the western boundary of the Parish of Brothers generally westerly and northerly to the north-western corner of portion 137, of the latter parish; by a line north to the southern boundary of portion 25, Parish of Brown; by part of the southern boundary of the said portion 25 westerly to the south-western corner of that portion; by part of the generally eastern boundary and the northern boundary of the Parish of Howes Hill generally northerly and westerly to the north-western corner of portion 12; by the generally eastern boundary and part of the generally southern boundary of the parish of Calala, generally southerly and westerly to a point about 166 chains west of the western boundary of portion 116; by a line southerly to the northern boundary of Lot 67, DP 755521; by part of that boundary, the north-western and the generally south-western boundaries of that lot, westerly, south-westerly and generally south-easterly, a line southerly, the western and part of the generally south-western boundaries of Lot 2, DP 819370, southerly and generally south-easterly to again the line southerly from a point 166 chains west of the western boundary of portion 116, aforesaid; by that line southerly to a point about 13 chains south of the westerly prolongation of the northern boundary of portion 74, parish of Trinkey; by a line east to the western boundary of that portion; by a line along that boundary of that portion southerly

to the northern boundary of portion 118, Parish of Lawson, by part of the northern and eastern boundaries of the said portion 118, easterly and southerly to the road from Breeza to Binnaway; by that road generally westerly to the western prolongation of the northern boundary of Lot 2, DP 596840, by that line easterly and the northern and south eastern boundaries of the aforesaid lot easterly and generally westerly to the road from Breeza to Binnaway; by that road generally westerly to Coxs Creek, aforesaid and by that creek downwards to the point of commencement.

SCHEDULE E:

Liverpool Plains Shire (as altered)

Area about 5005.47 square kilometres. Commencing at the junction of the Liverpool Range and the generally south-western boundary of the County of Buckland, near Omaleah Cliffs: and bounded thence by that range generally easterly to the generally south-eastern boundary of the County of Buckland, aforesaid; by that boundary generally north-easterly to the generally southern boundary of Lot 2, DP 732462; by that boundary and the generally eastern boundary of that lot generally easterly and northerly, part of the generally south-western, the generally south-western, the generally south-eastern and the generally north-eastern boundaries of Lot 1, DP 732462, generally south-easterly, generally north-easterly and generally north-westerly and part of the generally western boundary of Lot 222, DP 750952, generally northerly and westerly to the Great Dividing Range; by that range generally north-westerly to the generally north-eastern boundary of the Parish of Parnell, County of Buckland; by part of that boundary, generally north-westerly to the north-western corner of Portion 172; by the range forming the north-western watershed of Wiles Gully, generally north-westerly to the northern boundary of Portion 146; by that boundary, westerly and part of the eastern boundary of Portion 112, northerly, to the range forming the north-western watershed of Wiles Gully, aforesaid; by that range, generally north-westerly to the generally north-eastern boundary of Portion 181, Parish of Evan; by that boundary, generally north-westerly and the northern boundary of Portion 193, westerly to the range forming the watershed dividing Spring and Sugar Loaf Creeks; by that range generally north-westerly to the to the generally south-western boundary of the County of Parry; by that boundary, generally north-westerly, the northern boundaries of Lots 138 and 139, DP 751014 and their prolongation westerly, the generally eastern boundary of Lot 273, DP 751034, generally northerly, the generally north-eastern and the generally northern boundaries of Lot 247, DP 751011, generally north-westerly and generally westerly, part of the southern and the western boundaries of Lot 163, DP 751011, westerly and northerly, the western boundary of Lot 29, DP 751011, northerly, the western and northern boundaries of Lot 28, DP 751011 and its prolongation, northerly and easterly to Currabubulla Creek; by that creek, downwards to the eastern prolongation of the southern boundary of Lot 1, DP 780038; by that prolongation, boundary and the generally north-western boundary of that lot, westerly and generally north-easterly, the western boundary of Lot 257, DP 751011, northerly, a line, north-westerly, the eastern boundary of Lot 92, DP 751011 and its prolongation, northerly, part of the southern and the western boundaries of Lot 93, DP 751011, westerly and northerly and part of the southern and the western boundaries of Lot 2, DP 880436 and its prolongation, westerly and northerly to again Currabubulla Creek; by creek downwards to the southern prolongation of the eastern

boundary of Lot 84, DP 751011; by that prolongation, boundary and the northern boundary of that lot, northerly and westerly, the generally north-eastern boundary of Lot 1, DP 748602, generally north-westerly, the eastern boundary of Lot 1, DP 728396 and a line, northerly, part of the southern, western and northern boundaries of Lot 109, DP 751011, westerly, northerly and easterly, part of the generally south-western boundary of the County of Parry, generally northerly, to the south-western corner of Lot 30, DP 755344; by a line westerly to the generally south-eastern boundary of Lot 267, DP 751011; by part of that boundary and the southern boundary of that lot, generally south-westerly and westerly, the generally southern and western boundaries of Lot 197, DP 751011, generally westerly and northerly, the western boundary of Lot 266, DP 751011, northerly, again, part of the generally south-western boundary of the County of Parry, generally north-westerly, the southern boundary of Lot 55, DP 751025, westerly to the generally eastern boundary of the Parish of Babbinboon, County of Buckland; by that boundary and part of the generally eastern boundary of the parish of Denver, generally southerly, part of the north-eastern, the south-eastern and part of the south-western boundaries of Lot 152, DP 751012, south-easterly, south-westerly and north-westerly, again, the generally eastern boundary of the Parish of Denver, generally southerly, part of the northern and part of the eastern boundaries of the Parish of Mooki, easterly and southerly, the generally northern, the generally western and the generally south-eastern boundaries of Lot 7, DP 182211, generally westerly, generally southerly and generally north-easterly, again, the eastern and part of the southern boundaries of the Parish of Mooki, southerly to the north-eastern corner of Lot 31, DP 1165474, by the generally northern and western boundaries of that lot, generally westerly, southerly and easterly to the generally eastern boundary of the Parish of Ferrier; by that boundary and southern boundaries of the Parish of Ferrier, generally southerly and westerly to the north-eastern corner of portion 108, Parish of Wallala; by a line along the eastern boundary of the said portion 108 southerly, the south-eastern boundaries of Lots 3, 2 and 1, DP 1045187, south-westerly, the eastern and northern boundaries of Lot 105, DP 751032, northerly and westerly, a line westerly, part of the eastern, northern and western boundaries of Lot 91, DP 751032, northerly, westerly and southerly, the eastern prolongation of the southern boundary of Lot 101, DP 751032 and that boundary, westerly, the southern and western boundaries of Lot 100, DP 751032, westerly and northerly, the northern boundary of Lot 68, DP 751032 and its prolongation, westerly, the northern boundary of Lot 71, DP 751032 and its prolongation, westerly to Mooki River; by that river upwards to the eastern prolongation of the northern boundary of Lot 214, DP 755494; by that prolongation, boundary and the western boundary of that lot, westerly and southerly to the generally southern boundary of the Parish of Doone, County of Pottinger; by the generally southern boundary of that parish and the generally southern boundary and part of the western boundary of the Parish of Brothers generally westerly and northerly to the north-western corner of portion 137, of the latter parish; by a line north to the southern boundary of portion 25, Parish of Brown; by part of the southern boundary of the said portion 25 westerly to the south-western corner of that portion; by part of the generally eastern boundary and the northern boundary of the Parish of Howes Hill generally northerly and westerly to the north-western corner of portion 12; by the generally eastern boundary and part of the generally southern boundary of the parish of Calala, generally southerly and westerly to a point



about 166 chains west of the western boundary of portion 116; by a line southerly to the northern boundary of Lot 67, DP 755521; by part of that boundary, the north-western and the generally south-western boundaries of that lot, westerly, south-westerly and generally south-easterly, a line southerly, the western and part of the generally south-western boundaries of Lot 2, DP 819370, southerly and generally south-easterly to again the line southerly from a point 166 chains west of the western boundary of portion 116, aforesaid; by that line southerly to a point about 13 chains south of the westerly prolongation of the northern boundary of portion 74, Parish of Trinkey; by a line east to the western boundary of that portion; by a line along that boundary of that portion southerly to the northern boundary of portion 118, Parish of Lawson; by part of the northern and eastern boundaries of the said portion 118, easterly and southerly to the road from Breeza to Binnaway; by that road generally westerly to the western prolongation of the northern boundary of Lot 2, DP 596840, by that line easterly and the northern and south eastern boundaries of the aforesaid lot easterly and generally westerly to the road from Breeza to Binnaway; by that road south-westerly and westerly to the northernmost corner of portion 114, Parish of Bomera; by a line along an eastern boundary of that portion southerly to a point about 13 chains south of its intersection with the northern boundary of portion 119; by a line east to the easternmost boundary of portion 119; by part of that boundary of that portion and the southern and easternmost boundaries of portion 78, northerly, easterly and again northerly to the southern boundary of portion 5, Parish of Clarke; by boundaries of the said portion 5, westerly, northerly and easterly to Cox's or Bone Creek; by that creek upwards to the generally southern boundary of the Parish of Clarke; by that boundary generally westerly to the Warrumbungle Range and by that range and the Liverpool Range, aforesaid, generally south-easterly and generally easterly to the point of commencement.

#### SCHEDULE F:

##### Warrumbungle Shire (as altered)

Area about 12483.49 square kilometres: Commencing at the junction of the eastern boundary of the Parish of Bungaba, County of Bligh with Talbragar River and bounded thence by part of that boundary southerly, the generally northern boundary of the Parish of Bligh generally easterly and part of the generally south-eastern boundary of the Parish of Nandoura northerly to the generally south-western boundary of Portion 138; by that boundary and the generally north-western and northern boundaries of that portion generally north-westerly, generally north-easterly and generally easterly to the generally south-eastern boundary of the Parish of Nandoura; again by part of that boundary generally north-easterly to the Great Dividing Range; by that range generally north-easterly to the generally south-eastern boundary of the Parish of Nandoura; again by part of that boundary and the generally northern boundary of that parish generally north-easterly and generally westerly to Talbragar River, aforesaid; by that river upwards to the generally northern boundary of Portion 77, Parish of Warung; by part of that boundary generally easterly and part of the generally western boundary of Portion 12, Parish of Cunna easterly and northerly to the generally northern boundary of the County of Bligh; by part of that boundary and part of the generally south-eastern boundary of the Parish of Moredevil, County of Pottinger generally north-westerly to the generally south-western boundary of Portion 191, of Parish of Bundella; by that boundary and the generally south-western boundaries of Portions 189, 187 and 195 (part) generally

north-westerly, the generally eastern boundary of Portion 186 generally southerly and part of the generally north-eastern, the generally south-eastern and the southern boundaries of Portion 143 south-easterly, generally south-westerly and westerly to Cox Creek; by that creek upwards to the north-eastern prolongation of the south-eastern boundary of Portion 58; by that prolongation and boundary south-westerly to the generally south-western boundary of the County of Pottinger; by part of that boundary generally north-westerly, the generally southern boundary of the Parish of Clarke, County of Pottinger generally easterly to Coxs Creek, aforesaid; by that creek downwards to the eastern prolongation of a southern boundary of Portion 147, Parish of Premer; by that prolongation and part of that boundary westerly to a point 400 metres east of the west most western boundary of Portion 151, a line 100 metres southerly, a line 260 metres easterly, a line 100 metres southerly, a line westerly to the generally eastern boundary of Portion 104, Parish of Bomera; by part of that boundary and part of the generally eastern boundary of Portion 119 generally southerly to a point 260 metres south of the north boundary of Portion 119, a line westerly to the southern prolongation of the western boundary of Portion 140; by that prolongation, boundary and its prolongation northerly to the road from Breeza to Binnaway and by that road generally easterly to Coxs Creek; by that creek downwards and Bombera Creek, upwards to the eastern prolongation of northern boundary of Portion 42, Parish of Tambar, County of Pottinger; by that prolongation, boundary and part of the western boundary of that portion westerly and southerly to the north-eastern corner of Portion 46; by the northern boundary of that portion and Portion 9, a line, the northernmost boundary of portion 33, Parish of Wilson, and the generally northern boundary of Portion 18, generally westerly to the north-western corner of the said Portion 18; by a line north to the southern boundary of Portion 63, Parish of Urangera; by part of that boundary, the generally southern boundary of Portion 43, the generally western boundary of that portion and Portions 24, 54 and 44 and Portion 15, Parish of Nombi, generally westerly and northerly, the northern boundary of that portion and Portion 9 and part of the northern boundary Portion 29, Parish of Bingle, easterly, the western boundary of that portion and the westernmost and part of the westernmost northern boundary of Portion 100, northerly and easterly, the western boundary of that portion and Portion 34, northerly, by part of the southern boundary and the eastern boundary of Portion 87, easterly and northerly, the generally northernmost northern boundary of Portion 101 and the northern boundary of Portion 105, generally easterly to Coxs Creek, aforesaid, by that creek downwards to the eastern prolongation of the generally southern boundary of the Parish of Coogal; by that prolongation and boundary and part of the generally western boundary of that parish generally westerly and northerly, the south-eastern and north-eastern boundaries of Portion 195, north-easterly and north-westerly, the north-eastern boundary of Lot 1, D.P. 254370, north-westerly, again the generally western boundary of the Parish of Coogal generally northerly to the north-western corner of the south-western boundary of Portion 191; by a line due east for a distance of 705.9 metres and a line due north for a distance of 2 845 metres; by a line westerly to the westernmost south-western corner of Portion 54; by the westernmost western boundary of that portion and Portion 53 northerly, by the western boundary of that Portion 50, Portion 194 and Portion 49, the westernmost boundary of Portion 46 and a line northerly to the westernmost northern boundary of Portion 86, Parish of Denison; by that boundary westerly, by a line along the eastern boundary of Portion 85, by the northern boundary and by a line along the western boundary of that

portion, northerly, westerly and southerly to the generally northern boundary of the Parish of Brigalow; by part of that boundary generally westerly to Kerringle Creek; by that creek upwards to a point about 221.3 metres east of the south-western corner of Portion 7, Parish of Denison West; by a line south to a line point east of the south-eastern corner of Portion 2; by a line west to that corner; by the generally southern boundary of that portion and the southern boundary of Lot 157, DP 755492, generally south westerly to the western prolongation of the southern boundary of that lot, westerly to the boundaries of Lot 78, DP 755479, by these boundaries southerly, easterly, southerly, westerly and northerly, part of the generally southern and part of the generally north-western boundaries of the Parish of Denison West generally westerly and generally north-easterly, the eastern prolongation of the southernmost southern boundary of the Parish of Galloway, County of White; by that prolongation, boundary and its prolongation westerly to Borah Creek; by that creek downwards to the southernmost southern boundary of Portion 5, Parish of Cocaboy; by a line south-westerly to a line parallel to and distance 650 metres south of the southern boundary of Portion 1, Parish of Loftus; by that line westerly to a point south-east of the intersection of the eastern prolongation of the southern boundary of the Parish of Denobollie and Timmallallie Creek; by a line north-westerly to that point; by the eastern prolongation and the southern boundary of the Parish of Denobollie westerly to its junction with the generally eastern boundary of the County of Baradine; by a line south-westerly to a point on the eastern boundary of Portion 23, Parish of Coolangoola distant 440 metres north of the south-eastern corner of that portion; by a line north-westerly to a point on the northern boundary of Portion 7, Parish of Cumbil distant 280 metres west of the north-eastern corner of that portion; by the continuation of that line for a further 200 metres; by a line south-westerly to the south-western corner of that portion; by Etoo Creek downwards to the north-eastern corner of Portion 3, Parish of Euligal; by a line generally westerly to a point on the southern boundary of Portion 11 distant 1 220 metres west of the south-eastern corner of that portion; by a line north-westerly to a point on the southernmost southern boundary of Portion 1, Parish of Boorimah distant 940 metres west of the southernmost south-eastern corner of that portion; by a line north-easterly to a point on the western boundary of Portion 2 distant 400 metres north of the south-western corner of that portion; by that boundary north 760 meters; by a line north-westerly to a point on the north-western boundary of Portion 48, Parish of Wangan distant 1 380 metres south-west of the northern corner of that portion; by a line south-westerly to the north-eastern corner of Portion 3; by the northern boundary of that portion and its prolongation westerly to the road from Pilliga to Baradine via Gwabegar; by that road southerly to Baradine Creek; by that creek upwards to its intersection with the Gwabegar Branch Railway; by a line south-westerly to Merriwee Creek; by a line north-westerly to the southern prolongation of the western boundary of Portion 2, Parish of Gwabegar; by a line south-westerly to a point on the western boundary of the Parish of Ceelnoy distant 2 200 metres north of the south-western corner of that parish; by part of the western boundaries of the last mentioned parish and the Parish of White generally southerly, part of the north-eastern and south-eastern boundaries of the Parish of Terembone, County of Leichhardt south-easterly and south-westerly to Teridgerie Creek; by that creek upwards to the generally eastern boundary of the Parish of Teridgerie; by part of that boundary and part of the generally eastern boundary of the Parish of Narratigah generally southerly and the northern boundary of the Parish of Goorianawa easterly to Warrumbungle Range; by that range generally south-easterly to the generally

western boundary of the Parish of Woorut; by part of that boundary generally southerly, part of the generally northern, the generally western and part of the generally southern boundaries of the Parish of Gowang generally westerly, generally south-westerly and generally easterly to Wallumburrawang Creek; by that Creek downwards to the western prolongation of the northern boundary of portion 44, Parish of Kirban, County of Gowen; by that prolongation and boundary, a line and the northern boundaries of Portions 66, 67, 56 and 57 and its prolongation easterly to Yarragrinn Creek; by that creek and Castlereagh River, downwards to the generally western boundary of the Parish of Richardson, County of Lincoln; by that boundary and part of the generally southern boundary of that parish generally southerly and generally easterly and the eastern boundary of the Parish of Brelong South and its prolongation southerly to a point approximately 310 metres south of the southern boundary of Portion 2, Parish of Spring Creek; by a line westerly to Spring Creek; by that creek downwards to the northern prolongation of the eastern boundary of Portion 5; by that prolongation, boundary and its prolongation southerly to Talbragar River, aforesaid; by that river and Sandy Creek upwards to the generally western boundary of the Parish of Dapper; by part of that boundary generally southerly to the southernmost southern boundary of Portion 89; by that boundary easterly and the southern prolongation of the westernmost eastern boundary of that portion southerly to a point west of the westernmost south-western corner of Portion 82; by a line easterly to that corner; by part of the generally south-eastern boundary of the County of Lincoln generally north-easterly to the southern boundary of Portion 44, Parish of Rouse, County of Bligh; by part of that boundary and the southern boundaries of Portions 33 and 184 easterly and the eastern boundary of the last mentioned portion and its prolongation northerly to the southern boundary of Portion 26; by part of that boundary easterly, part of the western, the southern and the eastern boundaries of Portion 25 southerly, easterly and northerly and the eastern boundaries of Portions 24, 23, a line, 29 and 119 northerly to the south-eastern boundary of the County of Lincoln, aforesaid; by part of that boundary generally northerly and part of the generally southern boundary of the Parish of Wargundy, County of Bligh, generally easterly, generally northerly and easterly to Talbragar River, aforesaid, and by that river upwards to the point of commencement.

#### NATIONAL PARKS AND WILDLIFE ACT 1974

##### Notice of Reservation of a Nature Reserve

I, the Honourable Thomas Frederick Bathurst, Lieutenant-Governor of the State of New South Wales, with the advice of the Executive Council, reserve the lands described in the Schedule below, as part of Koorawatha Nature Reserve, under the provisions of section 30A (1) of the National Parks and Wildlife Act 1974.

Signed and sealed at Sydney this 10th day of April 2013.

THOMAS FREDERICK BATHURST,  
Lieutenant-Governor

By His Excellency's Command,

ROBYN PARKER, M.P.,  
Minister for the Environment

GOD SAVE THE QUEEN!

## SCHEDULE

*Land District – Young; LGA – Young*

County Monteagle, Parish Illunie, about 1.07 hectares, being the Crown public road separating Lots 94, 95 and 134, DP 754593, from Koorawatha Nature Reserve.

Papers OEH/12/10331.

**NATIONAL PARKS AND WILDLIFE ACT 1974**

## ERRATUM

THE following notice which was published in *New South Wales Government Gazette* No. 44 of 12 April 2013 on page 962 is republished due to an error. The gazettal date remains 12 April 2013.

**NATIONAL PARKS AND WILDLIFE ACT 1974**

Notice of Reservation of a National Park

I, the Honourable Thomas Frederick Bathurst, Lieutenant-Governor of the State of New South Wales, with the advice of the Executive Council, reserve the lands described in the Schedule below, as part of Wollemi National Park, under the provisions of section 30A (1) of the National Parks and Wildlife Act 1974.

Signed and sealed at Sydney this 3rd day of April 2013.

THOMAS FREDERICK BATHURST,  
Lieutenant-Governor

By His Excellency's Command,

ROBYN PARKER, M.P.,  
Minister for the Environment

GOD SAVE THE QUEEN!

## SCHEDULE

*Land District – Rylstone; LGA – Lithgow City*

County Hunter, Parish Coorongooba, 32.38 hectares, being Lot 25, DP 753777.

Papers OEH/12/2345.

**PARENTS AND CITIZENS ASSOCIATIONS INCORPORATION ACT 1976**

Incorporation of Parents and Citizens Associations

THE following associations are hereby incorporated under the Parents and Citizens Associations Incorporation Act 1976.

1. James Erskine Public School
2. Gresford Public School
3. Tanilba Bay Public School

ADRIAN PICCOLI, M.P.,  
Minister for Education

**STATUTORY AND OTHER OFFICES REMUNERATION ACT 1975**

Withdrawal

THE Report and Determination of the Statutory and Other Offices Remuneration Tribunal in respect of the Assistant Commissioner, NSW Crime Commission, published in the *New South Wales Government Gazette* on 5 April 2013, is hereby withdrawn effective from 27 March 2013.

Officers holding the position of Assistant Commissioner, NSW Crime Commission shall receive an annual salary of \$401,255, in accordance with the Report and Determination for the Public Office Holders Group – Determination No. 1, dated 9 November 2012.

**TRANSPORT ADMINISTRATION ACT 1988**

## LAND ACQUISITION (JUST TERMS COMPENSATION) ACT 1991

Notice of Compulsory Acquisition of Land for the Purposes of Transport for NSW

TRANSPORT FOR NSW, with the approval of His Excellency the Lieutenant-Governor, declares that the land described in the Schedule hereto is acquired by compulsory process under the provisions of the Land Acquisition (Just Terms Compensation) Act 1991 for the purposes of Transport for NSW, as authorised by the Transport Administration Act 1988.

Dated this 12th day of April 2013.

TERRY BRADY,  
General Manager, Country Rail Contracts,  
Transport Services Division

## SCHEDULE

All those pieces or parcels of land situated in the localities of Belford, Greta, Allandale and Harper Hill in the Local Government Areas of Singleton, Cessnock and Maitland, Parishes of Belford, Allandale and Branxton, County of Northumberland and State of New South Wales, being identified as Lots 201 and 203 in Deposited Plan 1141522, Lots 305 and 306 in Deposited Plan 1141523, Lots 402 and 404 in Deposited Plan 1141524, Lot 1007 in Deposited Plan 1141530 and Lot 252 in Deposited Plan 1159418 and having an area of 3.740 hectares and said to be in the ownership of the Minister Administering the Crown Lands Act 1989.

**TRANSPORT ADMINISTRATION ACT 1988**

## LAND ACQUISITION (JUST TERMS COMPENSATION) ACT 1991

Notice of Compulsory Acquisition of Land for the Purposes of Transport for NSW

TRANSPORT FOR NSW, with the approval of His Excellency the Lieutenant-Governor, declares that the land described in the Schedule hereto is acquired by compulsory process under the provisions of the Land Acquisition (Just Terms Compensation) Act 1991 for the purposes of Transport for NSW, as authorised by the Transport Administration Act 1988.

Dated this 12th day of April 2013.

TERRY BRADY,  
General Manager, Country Rail Contracts,  
Transport Services Division

## SCHEDULE

All those pieces or parcels of land situated in the localities of Allandale and Lochinvar in the Local Government Area of Maitland, Parishes of Gosforth and Branxton, County of Northumberland and State of New South Wales, being identified as Lots 1101 and 1103 in Deposited Plan 1141531 and Lot 1306 in Deposited Plan 1141533, having an area of 1,547.9 square metres and said to be in the ownership of Maitland City Council.

**PROTECTION OF THE ENVIRONMENT OPERATIONS (WASTE) REGULATION 2005**

General Exemption Under Part 6, Clause 51 and 51A

The coal ash exemption 2013

**Name**

1. This exemption is to be known as 'The coal ash exemption 2013'.

**Commencement**

2. This exemption commences on 22 April 2013.

**Duration**

3. This exemption is valid unless revoked by the Environment Protection Authority (EPA) by notice published in the *New South Wales Government Gazette*. 'The coal ash exemption 2010' which commenced on 14 June 2011, is revoked on 22 April 2013.

**Legislation**

4. Under the Protection of the Environment Operations (Waste) Regulation 2005 (the Regulation):
  - 4.1. Clause 51 (2) authorises the EPA to grant an exemption in relation to any matter or thing including an activity or class of activities, and
  - 4.2. Clause 51A authorises the EPA to exempt a person from any of the following provisions in relation to an activity or class of activities relating to certain waste that is to be land applied or used as a fuel:
    - the provisions of sections 47 to 49 and 88 of the Protection of the Environment Operations Act 1997 (the Act),
    - the provisions of Schedule 1 to the Act, either in total or as they apply to a particular activity, and
    - the provisions of Part 3 and clauses 45 and 47 of the Regulation.

**Exemption**

5. In this Notice of Exemption:
  - 5.1. The responsible person listed in Column 1 of Table 1 is exempt from the provision/s listed in Column 2 of that table but only:
    - in relation to activities involving the relevant waste, and
    - only where the responsible person complies with the conditions referred to in Column 3 of the table, and
    - in the case of a consumer, in relation to the premises where the waste is applied to land as permitted by clause 7.2.

However, this Notice of Exemption does not exempt the responsible person from the provisions specified in Column 2 where the relevant waste is received at premises that are, despite this exemption, required to be licensed for waste disposal (application to land) activities under the provisions of the Act.
  - 5.2. Where a responsible person complies with the conditions of this Notice of Exemption, the activity referred to in Schedule 1 from which that person is exempt is taken to be a non-scheduled activity for the purposes of the Act.

TABLE 1

<i>Column 1</i>	<i>Column 2</i>	<i>Column 3</i>
<i>Responsible person</i>	<i>Provisions from which the responsible person is exempt</i>	<i>Conditions to be met by the responsible person</i>
Generator	section 48 of the Act in respect of clause 39 of Schedule 1 to the Act Part 3 of the Regulation	all requirements specified in section 7 and 8
Processor	section 48 of the Act in respect of clause 39 of Schedule 1 to the Act Part 3 of the Regulation	all requirements specified in section 7 and 9
Consumer	section 48 of the Act in respect of clauses 39 and 42 of Schedule 1 to the Act Part 3 of the Regulation section 88 of the Act clause 47 of the Regulation	all requirements specified in section 7 and 10

This Notice of Exemption is a general exemption for the purposes of clause 51 (3) of the Regulation.



**Definitions**

6. In this Notice of Exemption:

**Brine conditioned ash** means coal ash that has been conditioned or treated with brine concentrator waste from process water treatment.

**Burning New South Wales (NSW) black coal** means burning coal that was mined in NSW. It is recognised that small quantities of other substances, such as oil, may be used as ignition start-up fuels. Burning NSW black coal is taken to include the use of such materials during the start-up process.

**Characterisation** means sampling and testing that must be conducted on the coal ash for the range of chemicals and other attributes listed in Column 1 of Table 2.

**Cementitious mixes** means coal ash blended with general purpose cement, lime and other activators for use in bound applications, where the materials must be chemically bound together.

**Composite sample** means a sample that combines 5 discrete sub-samples into a single sample for the purpose of analysis.

**Consumer** means a person who applies, causes, or permits the application to land of coal ash within the definitions of “application to land” in accordance with the Regulation. The consumer may be the landholder responsible for the land to which coal ash is applied. Where a person responsible for transporting the coal ash to the land application site is also the party applying the coal ash, this person must also meet the responsibilities of the consumer.

**Coal ash** means coal combustion products (CCPs), fly ash or furnace bottom ash from burning NSW black coal. This does not include brine conditioned or treated ash or salts.

**Crushed concrete** means waste concrete that has been processed into an engineered material, and meets the conditions of a resource recovery exemption.

**Generator** means a person who generates, supplies, causes, or permits the supply of coal ash to a processor or consumer.

**Once-off sampling** means sampling and testing that must be conducted only once on a batch, truckload or stockpile of coal ash that is not repeated, reproduced and does not form part of a continuous process.

**NA** means not applicable.

**Non-cementitious mixes** means coal ash that is not blended with general purpose cement, lime and other activators or used in bound applications.

**Processor** means a person who processes, mixes, blends, or otherwise incorporates coal ash into a material for supply to a supplier or a consumer. The generator may also be the processor.

**Relevant waste** means coal ash that meets the requirements of section 7.

**Routine sampling** means sampling and testing that must be conducted on the coal ash on an ongoing and regular basis.

**Supplier** means a person who supplies, causes, or permits the supply of cementitious mixes to a consumer. The supplier does not undertake any processing.

**General conditions**

7. This Notice of Exemption is subject to the following conditions:

7.1. The chemical concentration or other attribute of the coal ash listed in Column 1 of Table 2 must not exceed any of the following:

7.1.1. the absolute maximum concentration or other value listed in Column 4 of Table 2,

7.1.2. for characterisation or once-off tests, the maximum average (based on the arithmetic mean) concentration or other value listed in Column 2 of Table 2, and

7.1.3. for routine tests, the maximum average (based on the arithmetic mean) concentration or other value listed in Column 3 of Table 2.

7.2. The coal ash can only be applied to land:

7.2.1. in cementitious mixes such as concrete, and

7.2.2. in non-cementitious mixes such as an engineered fill, stabiliser, filter or drainage material or as a sand substitute as follows:

(a) pipe bedding material,

(b) selected backfill adjacent to structures,

(c) road pavement, base and sub-base structures,

(d) composite filler in asphalt pavements,

(e) rigid and composite pavement structures,

(f) select layers which act as working platforms at the top of earthworks,

(g) fill for reinforced soil structures (including geo-grid applications).

7.3. The coal ash can be applied to land consistent with section 7.2 when blended with other exempted materials, provided that the blended materials have been validated as compliant with the conditions of each individual exemption, for the use specified in each exemption.



- 7.4. Coal ash with a pH below the range of attributes specified in 7.1 (i.e. acidic coal ash) can be applied to land consistent with section 7.2.2, only when mixed, blended or incorporated into lime, natural quarried rock, coal ash, coal washery rejects, recovered railway ballast, crushed concrete, blast furnace slag, steel furnace slag and electric arc furnace slag that meets the pH requirements listed in Row 13 of Table 2. Acidic coal ash can only be blended at less than or equal to 20% by weight, provided that the blended materials have been validated as compliant with the pH requirements listed in Row 13 of Table 2 and testing frequencies of Column 3 of Table 3. Coal ash cannot be blended with any material that contains asbestos.

#### **Generator responsibilities**

8. The following conditions must be met by the generator for this exemption to apply:
  - 8.1. Sampling must be undertaken in accordance with Australian Standard 1141.3.1-1996 *Methods for sampling and testing aggregates* – Sampling – Aggregates (or equivalent). Sampling and information on sample storage and preparation must be detailed in a written sampling plan.
  - 8.2. Where the coal ash is generated as part of a continuous process, the generator must undertake characterisation and routine sampling according to the requirements listed in Column 1 and Column 2 of Table 3, for the range of chemicals and other attributes listed in Column 1 of Table 2.
  - 8.3. Where the coal ash is not generated as part of a continuous process, the generator may undertake once-off sampling of a batch, truckload or stockpile of coal ash according to the requirements listed in Column 3 of Table 3, for the range of chemicals and other attributes listed in Column 1 of Table 2.
  - 8.4. Where there is a change in inputs that is likely to affect the properties in the coal ash, characterisation must be repeated. Characterisation samples can be used for routine testing and subsequent calculations.
  - 8.5. Generators must keep a written record of all characterisation, routine and/or once-off test results for a period of five years.
  - 8.6. Records of the quantity of coal ash supplied to the processor or consumer and the processor's or consumer's name and address must be kept for a period of five years.
  - 8.7. The generator of coal ash must provide a written statement of compliance to the processor or consumer with each transaction, certifying that the coal ash complies with the relevant conditions of this exemption.
  - 8.8. The generator of coal ash must make information on the latest characterisation and routine test results available to the processor or consumer.
  - 8.9. The generator of coal ash must use due diligence to ensure that the relevant waste is utilised in applications that are consistent with the conditions of this exemption.

#### **Processor responsibilities**

9. This Notice of Exemption is subject to the following conditions:
  - 9.1. A processor who blends coal ash into cementitious mixes must maintain records of the quantity of coal ash received from the generator, and the generators name and address. These records must be kept for a period of five years. This condition does not have to be met by suppliers.
  - 9.2. The following conditions must be met by the processor of coal ash into non-cementitious mixes for this exemption to apply:
    - 9.2.1. Coal ash with a pH below the range of attributes specified in 7.1 must be blended at less than or equal to 20% by weight with lime, natural quarried rock, coal ash, coal washery rejects, recovered railway ballast, crushed concrete, blast furnace slag, steel furnace slag and electric arc furnace slag that meets the pH requirements listed in Row 13 of Table 2. The processor must test the pH of the blended material according to the requirements of Table 3, and validate the pH as compliant with the requirements listed in Row 13 of Table 2.
    - 9.2.2. Records of the quantity of coal ash received by the processor from the generator, and the generators name and address, must be kept for a period of five years.
    - 9.2.3. Records of the quantity of coal ash supplied to the consumer and the consumer's name and address must be kept for a period of five years.
  - 9.3. The processor of coal ash must provide a written statement of compliance to the consumer with each transaction, certifying that the coal ash complies with the relevant conditions of this exemption. Where a processor provides coal ash in cementitious mixes to a supplier, the processor must provide the supplier with a statement of compliance.
  - 9.4. The processor of coal ash must use due diligence to ensure that the relevant waste is utilised in applications that are consistent with the conditions of this exemption

#### **Consumer responsibilities**

10. This Notice of Exemption is subject to the following conditions:
  - 10.1. In cementitious mixes, where coal ash is not provided by a supplier (as defined in section 6), the consumer can only apply coal ash to land consistent with section 7.2.1 where it complies with a relevant specification or Australian Standard or supply agreement/s.

- 10.2. The following conditions must be met by the consumer of coal ash in non-cementitious mixes for this exemption to apply:
- 10.2.1. The coal ash can only be applied to land consistent with section 7.2.2 where:
- it complies with a relevant specification or Australian Standard or supply agreement/s, or
  - planning or development consent that has specifically considered the use of coal ash has been granted for the project.
- 10.2.2. The coal ash must not be applied in or beneath water including groundwater.
- 10.2.3. Records of the quantity and use of the coal ash received by the consumer and the providers' name and address must be kept for a period of five years.
- 10.3. The consumer should note that regardless of having an exemption, the use of coal ash remains subject to all other relevant environmental regulations within the Act and Regulations, including but not limited to land pollution (section 142A) and water pollution (section 120).
- 10.4. The consumer must land apply the relevant waste within a reasonable period of time.

#### Chemical and other material property requirements

11. This Notice of Exemption only applies to coal ash where the chemical and other attributes listed in Column 1 of Table 2 comply with the chemical concentrations and other values listed in Column 2, Column 3 and Column 4 of Table 2, when analysed according to test methods specified in Column 5 of Table 2. Note that while limits are not included for electrical conductivity (or for pH in cementitious mixes), this must be tested in each sample and records kept of results.

TABLE 2

<i>Column 1</i>	<i>Column 2</i>	<i>Column 3</i>	<i>Column 4</i>	<i>Column 5</i>
<i>Chemicals and other attributes</i>	<i>Maximum average concentration for characterisation (mg/kg 'dry weight' unless otherwise specified)</i>	<i>Maximum average concentration for routine testing (mg/kg 'dry weight' unless otherwise specified)</i>	<i>Absolute maximum concentration (mg/kg 'dry weight' unless otherwise specified)</i>	<i>Test method specified within Section</i>
1. Mercury	0.5	Not required	1	13.1
2. Cadmium	0.5	0.5	1	13.2
3. Lead	25	25	50	13.2
4. Arsenic	10	Not required	20	13.2
5. Boron	75	Not required	150	13.2
6. Chromium (total)	25	25	50	13.2
7. Copper	20	Not required	40	13.2
8. Molybdenum	10	Not required	20	13.2
9. Nickel	25	25	50	13.2
10. Selenium	10	10	20	13.2
11. Zinc	35	35	70	13.2
12. Electrical Conductivity	NA	NA	NA	13.3
13. pH* in non-cementitious mixes	7 to 12.5	7 to 12.5	6 to 13	13.3
14. pH in cementitious mixes	NA	NA	NA	13.3

\* Note: The ranges given for pH in non-cementitious mixes are for the minimum and maximum acceptable pH values in the coal ash.

**Sampling and testing requirements**

12. This Notice of Exemption only applies to coal ash sampled according to the requirements in Table 3.

TABLE 3

<i>Column 1</i>	<i>Column 2</i>	<i>Column 3</i>
<i>Characterisation sampling frequency</i>	<i>Routine sampling frequency</i>	<i>Once-off sampling frequency</i>
20 composite samples, by taking 1 composite sample from a different batch, truckload or stockpile. This must be repeated every 2 years.	Either 5 composite samples per 10,000 tonnes or 5 composite samples per 6 months.	10 composite samples per 4,000 tonnes e.g. discrete once-off delivery or ship load.

**Test methods**

13. All testing must be undertaken by analytical laboratories accredited by the National Association of Testing Authorities (NATA), or equivalent. All chemicals and other attributes listed in Column 1 of Table 2 must be measured in accordance with the test methods specified below:

13.1. Test method for measuring the mercury concentration in coal ash:

13.1.1. Particle size reduction & sample splitting may be required.

13.1.2. Analysis using USEPA SW-846 Method 7471B Mercury in solid or semisolid waste (manual cold-vapor technique), or an equivalent analytical method with a detection limit < 20% of the stated absolute maximum concentration in Table 2, Column 4 (i.e. 0.2 mg/kg dry weight).

13.1.3. Report as mg/kg dry weight.

13.2. Test methods for measuring chemicals 2 – 11 in coal ash:

13.2.1. Particle size reduction & sample splitting may be required.

13.2.2. Sample preparation by digestion using USEPA SW-846 Method 3051A Microwave assisted acid digestion of sediments, sludges, soils, and oils.

13.2.3. Analysis using USEPA SW-846 Method 6010C Inductively coupled plasma – atomic emission spectrometry, or an equivalent analytical method with an appropriate detection limit.

13.2.4. Report as mg/kg dry weight.

13.3. Test methods for measuring the electrical conductivity and pH in coal ash:

13.3.1. Sample preparation by mixing 1 part coal ash with 5 parts distilled water.

13.3.2. Analysis using Method 103 (pH) and 104 (Electrical Conductivity). In Schedule B (3): Guideline on Laboratory Analysis of Potentially Contaminated Soils, National Environment Protection (Assessment of Site Contamination) Measure 1999 (or an equivalent analytical method).

13.3.3. Report electrical conductivity in deciSiemens per metre (dS/m).

**Exemption Granted**

CHRISTOPHER McELWAIN,  
Manager, Waste and Resource Strategy,  
Environment Protection Authority  
by delegation

**Notes**

The EPA may amend or revoke this exemption at any time. It is the responsibility of the generator, processor and consumer to ensure that they comply with all relevant requirements of the most current exemption. The current version of an exemption will be available on the EPA website: [www.epa.nsw.gov.au](http://www.epa.nsw.gov.au)

In gazetting this general exemption, the EPA is exempting the relevant waste from the specific requirements of the Act and Regulations as stated in this exemption. The EPA is not in any way endorsing the use of this substance or guaranteeing that the substance will confer benefit.

The use of exempted material remains subject to other relevant environmental regulations within the Act and Regulations. For example, a person who pollutes land (section 142A) or water (section 120), or does not meet the special requirements for asbestos waste (clause 42), regardless of having an exemption, is guilty of an offence and subject to prosecution.

For the purposes of arrangements between a generator, a processor and a consumer, a 'transaction' is taken to mean the contractual agreement between the two parties which specifies the exchange of waste material from one party to another. A 'statement of compliance' must be in writing and be provided with each transaction.

The conditions set out in this exemption are designed to minimise the risk of potential harm to the environment, human health or agriculture, however, neither this exemption nor these conditions guarantee that the environment, human health or agriculture will not be harmed.

The consumer should assess whether or not the exempted material is fit for the purpose the material is proposed to be used and whether this use will cause harm. The consumer may need to seek expert engineering or technical advice.

This exemption does not apply to any material received at a premises that is required to be licensed for waste disposal (application to land) activities under the provisions of the Act. This exemption does not remove the need for a site at which processing occurs to be licensed, if required under Schedule 1 of the Act.

This exemption does not alter the requirements of any other relevant legislation that must be met in utilising this material, including for example, the need to prepare a Material Safety Data Sheet (MSDS).

Regardless of any exemption provided by the EPA, the person who causes or permits the application of the substance to land must ensure that the action is lawful and consistent with the development consent requirements of the land.

All records required to be kept under this exemption must be made available to authorised officers of the EPA upon request.

Failure to comply with the conditions of this Notice of Exemption may constitute an offence under clause 51 of the Regulation and the responsible person will be required to comply with the normal regulatory provisions.

---

# PRIVATE ADVERTISEMENTS

## COUNCIL NOTICES

### ALBURY CITY COUNCIL

Roads Act 1993

Land Acquisition (Just Terms Compensation) Act 1991

Notice of Compulsory Acquisition of Land

ALBURY CITY COUNCIL declares with the approval of Her Excellency the Governor that the lands described in the Schedule below, excluding any mines or deposits of minerals in the lands, are acquired by compulsory process in accordance with the provisions of the Land Acquisition (Just Terms Compensation) Act 1991, for a public road. Dated at Albury, this 17th day of December 2012. FRANK ZAKNICH, General Manager, Albury City Council, PO Box 323, Albury NSW 2640.

#### SCHEDULE

Lot 1, DP 1173227 and Lot 2, DP 1173227. [6981]

### DUNGOG SHIRE COUNCIL

Roads Act 1993

Roads (General) Regulation 2008

Naming of Public Roads

NOTICE is hereby given that Dungog Shire Council, pursuant to section 162 of the Roads Act 1993, has named the following roads:

<i>Location</i>	<i>Name</i>
Subdivision of Lot 21, DP 964046, 1286 Limeburners Creek Road, Clarence Town.	Waterview Road.

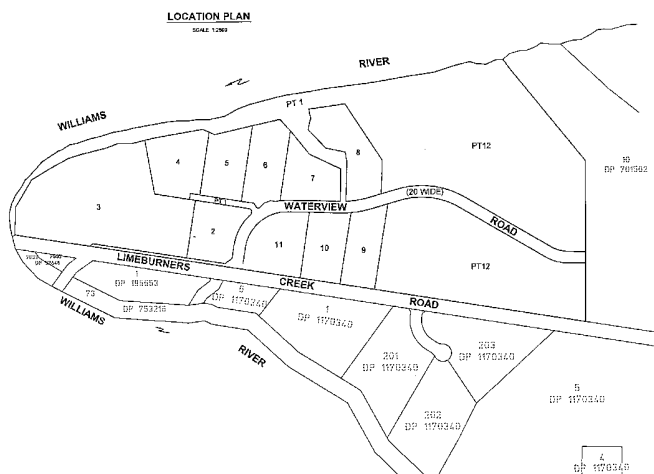

Authorised by resolution of Council on 17th July 2012. CRAIG DEASEY, PSM, General Manager, Dungog Shire Council, 198 Dowling Street, Dungog NSW 2420. [6982]

### DUNGOG SHIRE COUNCIL

Roads Act 1993

Roads (General) Regulation 2008

Naming of Public Roads

NOTICE is hereby given that Dungog Shire Council, pursuant to section 162 of the Roads Act 1993, has named the following roads:

*Location:*

Subdivision of Lot 204, DP 1176402, off Limeburners Creek Road and East Seaham Road, Clarence Town.

*Names:*

- Road 1 – Yoke Way.
- Road 2 – Oxbow Place.
- Road 3 – Jinker Circuit.



Authorised by resolution of Council on 20 November 2012. CRAIG DEASEY, PSM, General Manager, Dungog Shire Council, 198 Dowling Street, Dungog NSW 2420.

[6983]

### EUROBODALLA SHIRE COUNCIL

Roads Act 1993

Dedication of Land as Public Road

NOTICE is hereby given that Eurobodalla Shire Council in pursuance of section 10 of the Roads Act 1993 dedicates the lands described in Schedule 1 hereunder as public road. PAUL ANDERSON, General Manager, Eurobodalla Shire Council, PO Box 99, Moruya NSW 2537.

#### SCHEDULE 1

Lot 3, DP 857141 and Lot 4, DP 857141, Berrima Parade,  
Surfside, Parish East Nelligen, County St Vincent. [6984]

### GLEN INNES SERVERN COUNCIL

Roads Act 1993

NOTICE is hereby given that pursuant to section 162 of the Roads Act 1993, Council has named the roads described hereunder:

<i>Location</i>	<i>Road Name</i>
Glen Innes – Lane off Bourke Street through Lot 7, DP 800501.	Dodd Lane.

<i>Location</i>	<i>Road Name</i>
Glen Innes – Lane off Williams Street.	Bewley Lane
Glen Innes – Lane off Grovers Lane through Lot 2, DP 737058.	Rule Lane.
Glen Innes – Lane next to Church Street Administration Office running through to VRA building.	Sachs Lane.
Glen Innes – Lane off Church Street between Caltex Service Station and New England Motor Lodge.	Scholes Lane.
Glen Innes – Lane off Church Street to Town Hall carpark.	Fitzhardinge Lane.
Glen Innes – Lane off Bourke Street to Town Hall carpark.	Sommerlad Lane.
Glen Innes – Lane off Blue Hills Road.	McGauran Lane.
Glen Innes – Lane off Torrington Street.	Fulton Lane.
Red Range – Road off Coopers Road.	Goodwin Road.
Aqua Park – Road off Aqua Park Road.	Gardner Road.
Deepwater – Laneway between Cadell and Bourke Streets.	Dean Lane.
Deepwater – Laneway between Bourke and Alice Streets.	Barratt Lane.
Deepwater – Laneway between Gough and Forbes Streets north of Young Street.	Davidson Lane.
Deepwater – Laneway between Severn and Forbes Streets.	Collins Lane.
Deepwater – Laneway between Dundee and Young Streets.	Grigg Lane.
Deepwater – Laneway between Forbes and Gough Streets south of Young Street.	King Lane.
Deepwater – Laneway between Tenterfield and Severn Streets.	McSpedden Lane.
Deepwater – Laneway between Blythe and Ward Streets.	Robertson Lane.
Deepwater – Laneway between Short and Ward Streets.	Noakes Lane.
Deepwater – Laneway between Fraser and Tenterfield Streets.	Macansh Lane.
Deepwater – Street immediately west of railway line, between New England Highway and Lachlan Street.	Gough Street.

HEIN BASSON, General Manager, Glen Innes Severn Council, PO Box 61, Glen Innes NSW 2370. [6985]

### GOULBURN MULWAREE COUNCIL

#### ERRATUM

THE notice published in the *New South Wales Government Gazette* Special Supplement No. 45, dated 12 April 2013, under the heading LOCAL GOVERNMENT ACT 1993 LAND ACQUISITION (JUST TERMS COMPENSATION)

ACT 1991, Notice of Compulsory Acquisition of Land, was published showing an incorrect land description in Schedule 1 on Folio 974:

“Easement shown in DP 1171366 as ‘(A) Proposed easement for pipeline and water supply 6 wide’ over Lot 6 240164 located at Sutton Forest” is incorrect.

The correct description in relation to this parcel of land, the subject of the Notice of Compulsory Acquisition of Land is:

Easement shown in DP 1171366 as ‘(A) Proposed easement for pipeline and water supply 6 wide’ over Lot 6 DP 240164 located at Sutton Forest

This notice corrects that error and the gazettal date remains the same. CHRIS BERRY, General Manager, Goulburn Mulwaree Council, Locked Bag 22, Goulburn NSW 2580. [6986]

### HAWKESBURY CITY COUNCIL

Roads Act 1993, Section 162

#### Naming of Newly Created Public Roads

NOTICE is hereby given that Hawkesbury City Council in accordance with section 162 of the Roads Act 1993, has named the newly created public roads contained within DP 1169445 in the suburb of Pitt Town as the following:

Fernadell Drive (extension of existing road) – bounded by Boston Street, Pastoral Street, Quarry Street, Lots 2001 to 2010, DP 1169445; Lots 2027 to 2036, DP 1169445 and Lot 2053, DP 1169445.

Pastoral Street (extension of existing road) – bounded by Boston Street, Fernadell Drive and Lots 2037 to 2053, DP 1169445.

Quarry Street – bounded by Buckingham Street, Fernadell Drive and Lots 2010 to 2027, DP 1169445.

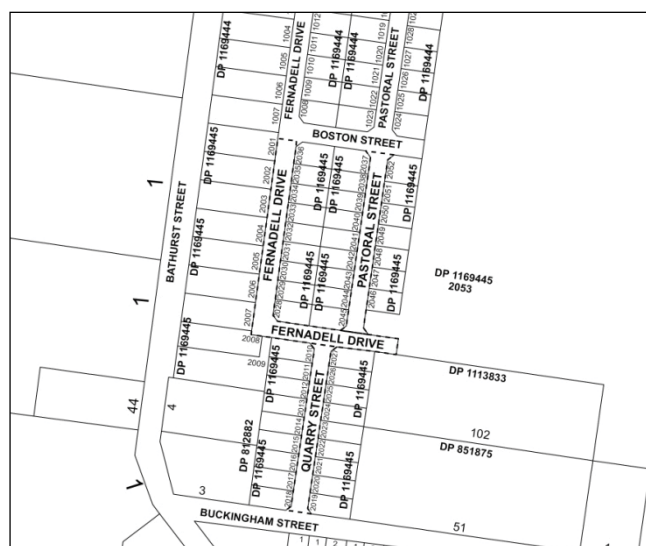

PETER JACKSON, General Manager, Hawkesbury City Council, PO Box 146, Windsor NSW 2756. [6987]



**LAKE MACQUARIE CITY COUNCIL**

## Naming of Roads

LAKE MACQUARIE CITY COUNCIL advises that in accordance with section 162.1 of the Roads Act 1993 and Part 2, Division 2, Clauses 7-10, Roads Regulations 2008, it has named the following road:

<i>Location/Description</i>	<i>Road Name</i>
Naming of one road in the subdivision of Lot 182, DP 558572 and Lot 62, DP 1038369, Hampton Street, Toronto.	Jonquil Close.

*Origin of Name:* The site has prolific abundance of the Jonquil flower in spring time.

No objection to the proposed name was received within the advertising period. Brian Bell, General Manager, Lake Macquarie City Council, Box 1906, Hunter Region Mail Centre NSW 2310. [6988]

**LISMORE CITY COUNCIL**

## Roads Act 1993, Section 162

## Naming of Public Road

NOTICE is given that Lismore City Council, pursuant to the Roads Act 1993, section 162 and Roads Regulation 2008, has named the new road described below:

<i>Location/Description</i>	<i>New Road Name</i>
Road running southerly off Oliver Avenue, Goonellabah.	O'Mahoney Drive.

Submissions concerning the proposed name were received and considered. THE GENERAL MANAGER, Lismore City Council, PO Box 23A, Lismore NSW 2480. [6989]

**MAITLAND CITY COUNCIL**

## Naming of Public Roads

NOTICE is hereby given that Maitland City Council, in pursuance of section 162 of the Roads Act 1993 and Part 2 of the Roads Regulation 2008, has approved the following new road name/s for gazettal:

Deposited Plan:	DP 1092466
Location:	Off Canterbury Drive, Raworth
Road Name:	Isla Street

The above road names have been advertised and notified. No objections to the proposed name/s have been received during the prescribed 28 day period. DAVID EVANS, General Manager, Maitland City Council, High Street (PO Box 220), Maitland NSW 2320. [6990]

**MAITLAND CITY COUNCIL**

## Naming of Public Roads

NOTICE is hereby given that Maitland City Council, in pursuance of section 162 of the Roads Act 1993 and Part 2 of the Roads Regulation 2008, has approved the following new road name/s for gazettal:

Deposited Plan	DP 1178574
Location	Off Pennparc Drive, Windella
Road Name	Orlando Close

The above road names have been advertised and notified. No objections to the proposed name/s have been received during the prescribed 28 day period. DAVID EVANS, General Manager, Maitland City Council, High Street (PO Box 220), Maitland NSW 2320. [6991]

**PORT MACQUARIE-HASTINGS COUNCIL**

## Local Government Act, 1993 – Section 553

## Waste Water Service Extensions

NOTICE is hereby given pursuant to section 553 of the Local Government Act 1993, that Council's Sewermains have been extended to service the land described hereunder:

Lots 41-42, 54, 56 and 183, DP 754405, Herons Creek Road, Herons Creek.

Lot 55, DP 651209, Herons Creek Road, Herons Creek.

Lots 1-2, DP 714841, Herons Creek Road, Herons Creek.

Lot 58, DP 661701, Herons Creek Road, Herons Creek.

Lot 1, DP 393810, Herons Creek Road, Herons Creek.

Lots A and B, DP 378311, Herons Creek Road, Herons Creek.

Land that is not connected thereto shall become rateable for waste water availability charges after (60) days from the date of this notice, or from the date upon which the land is connected to Council's service, whichever is the earlier. Any further enquiries, please contact Mary Klower on (02) 6581 8111 or email to mary.klower@pmhc.nsw.gov.au. T. HAYWOOD, General Manager, Port Macquarie-Hastings Council, PO Box 84 Port Macquarie NSW 2444. [6992]

**ESTATE NOTICES**

NOTICE of intended distribution of estate. – Estate of the Late VERONICA NOLA GREEN. – Probate was granted on 5 April 2013. – Any person having any claim upon the estate of Veronica Nola Green, late of 53 Wentworth Street, Randwick in the State of New South Wales, who died on 14 December 2012, married woman, must send particulars of their claim to the legal representatives for the estate, Ralph Eric Green and Neil Timothy Green, care of Bennett Stewart & Shirvington, Solicitors, Level 1, 1 York Street, Sydney NSW 2000, within 30 days from publication of this notice. After that time and after six months from the date of death of the deceased the legal representative intends to distribute the property in the estate having regard only to the claims of which the legal representatives have notice at the time of distribution. BENNETT STEWART & SHIRVINGTON, Solicitors, Level 1, 1 York Street, Sydney NSW 2000, tel.: (02) 9247 5563, fax: (02) 9247 5585. Ref.: Peter Court. [6993]

NOTICE of intended distribution of estate. – Estate of the Late RONALD THOMAS MEADE. – Probate was granted on 2 April 2013. – Any person having any claim upon the estate of Ronald Thomas Meade, late of Clermont Nursing Home, 10 Clermont Avenue, Ryde (formerly of Top Ryde), in the State of New South Wales, who died on 29 December 2012, retired electrical fitter, must send particulars of their claim to the legal representative for the estate, Brett Gregory Meade, care of Bennett Stewart & Shirvington, Solicitors, Level 1, 1 York Street, Sydney NSW 2000, within 30 days from publication of this notice. After that time and after six months from the date of death of the deceased the legal representative intends to distribute the property in

the estate having regard only to the claims of which the legal representatives have notice at the time of distribution. BENNETT STEWART & SHIRVINGTON, Solicitors, Level 1, 1 York Street, Sydney NSW 2000, tel.: (02) 9247 5563, fax: (02) 9247 5585. Reference: Peter Court. [6994]

NOTICE of intended distribution of estate. – Any person having any claim upon the estate of EDWIN JOHN POULTON, late of Beecroft, retired pharmacist, who died on 11 June 2012, must send particulars of the claim to the executor, Francis Mervyn Deane, at c.o. Frank M. Deane & Co. (in association with Adams Raves Marsh & Co.), Solicitors, Level 13, 227 Elizabeth Street, Sydney NSW 2000 within one calendar month from publication of this notice. After that time, the assets of the Estate will be distributed having regard only to the claims of which at the time of distribution the executor has notice. Probate was granted in New South Wales on 14 September 2012. FRANK M. DEANE & CO. (in association with Adams Raves Marsh & Co.), Solicitors, Level 13, 227 Elizabeth Street, Sydney NSW 2000 (DX 255 Sydney), tel.: (02) 9283 5127. [6995]

## COMPANY NOTICES

NOTICE of members' final meeting – I J PLUMBING SERVICES PTY LIMITED (In Liquidation) – Notice is hereby given that in the terms of section 509 of the Corporations Law a final general meeting of the company will be held at the offices of the liquidator, 154 Elizabeth Street, Sydney on the 20 May 2013 at 9.00 am for the purpose of having laid before it by the liquidator an account showing how the winding-up has been conducted and the property of the company was disposed. COLIN J. WILSON, Wilson Porter Services Pty, Liquidators, Level 2, 154 Elizabeth Street, Sydney NSW 2000, tel.: (02) 9283 4377. [6996]

Authorised to be printed

ISSN 0155-6320

TONY DUCKMANTON, Government Printer.