



Government Gazette

of the State of

New South Wales

Number 339–Crown Land

Friday, 4 August 2023

The New South Wales Government Gazette is the permanent public record of official NSW Government notices. It also contains local council, non-government and other notices.

Each notice in the Government Gazette has a unique reference number that appears in parentheses at the end of the notice and can be used as a reference for that notice (for example, (n2019-14)).

The Gazette is compiled by the Parliamentary Counsel's Office and published on the NSW legislation website (www.legislation.nsw.gov.au) under the authority of the NSW Government. The website contains a permanent archive of past Gazettes.

To submit a notice for gazettal, see the Gazette page.

ROADS ACT 1993

ORDER

Transfer of Crown Road to a Council

In pursuance of the provisions of Section 152I of the *Roads Act 1993*, the Crown Road specified in Schedule 1 is transferred to the roads authority specified in Schedule 2 hereunder as from the date of publication of this notice and as from that date the road specified in Schedule 1 ceases to be a Crown road.

The Hon. Stephen Kamper MP
Minister for Lands and Property

SCHEDULE 1

Parish: Hearne
County: Roxburgh
Land District: Cherry Tree Hill
LGA: Mid-Western Regional Council

DESCRIPTION: Crown Road south of Lots 1 and 2 DP 1097011 and Lot 102 DP 1293060 approx. 4.618ha, as shown in red outline on the diagram below.
Classified Urban.

SCHEDULE 2

Roads Authority: Mid-Western Regional Council
DPE Ref: 23/04827

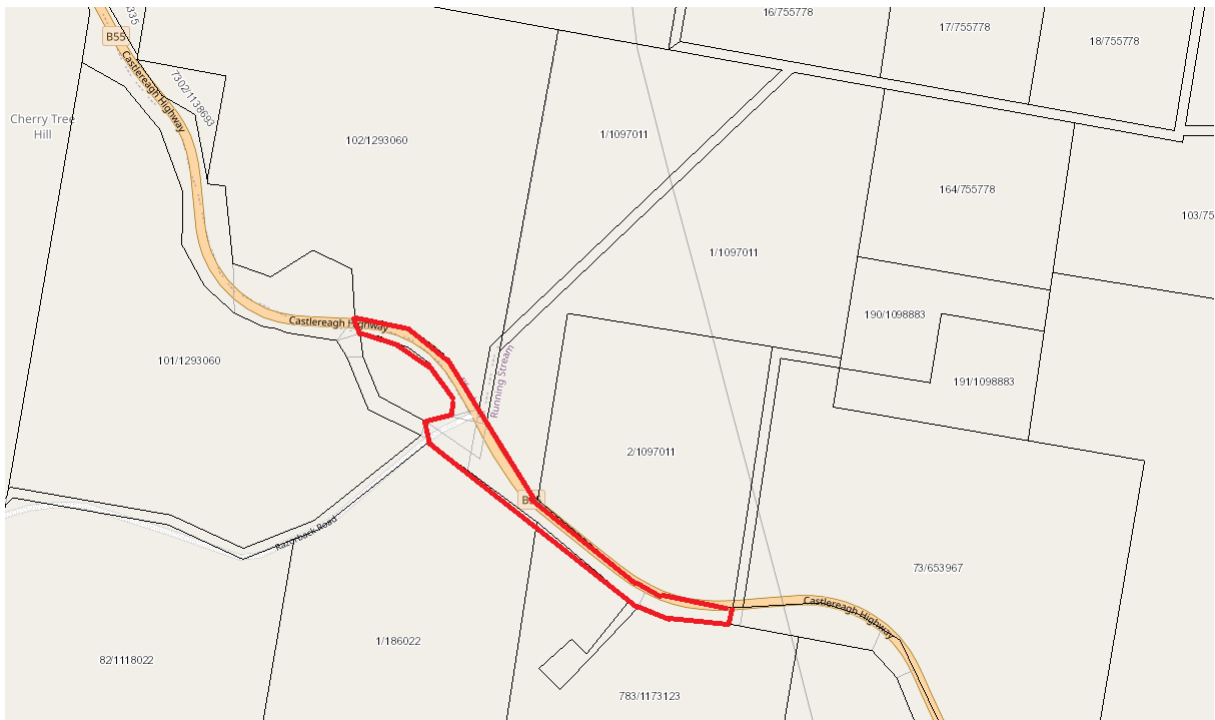

ROADS ACT 1993

ORDER

Transfer of Crown Road to a Council

In pursuance of the provisions of Section 152I of the *Roads Act 1993*, the Crown road specified in Schedule 1 is transferred to the roads authority specified in Schedule 2 hereunder as from the date of publication of this notice and as from that date the road specified in Schedule 1 ceases to be a Crown road.

The Hon. Stephen Kamper MP
Minister for Lands and Property

SCHEDULE 1

Parish: Hay South
County: Waradgery
Land District: Hay
LGA: Hay Shire Council

DESCRIPTION: Crown road east of Lots 130 & 135 DP756756 known as Old Common Road and comprising an area of approx. 2.759ha, as shown by red edge on the diagram below.

SCHEDULE 2

Roads Authority: Hay Shire Council
DPE Ref: 23/03870



ROADS ACT 1993

ORDER

Transfer of Crown Road to a Council

In pursuance of the provisions of Section 152I of the *Roads Act 1993*, the Crown Road specified in Schedule 1 is transferred to the roads authority specified in Schedule 2 hereunder as from the date of publication of this notice and as from that date the road specified in Schedule 1 ceases to be a Crown road.

The Hon. Stephen Kamper MP
Minister for Lands and Property

SCHEDULE 1

Parish: Hearne
County: Roxburgh
Land District: Cherry Tree Hill
LGA: Mid-Western Regional Council

DESCRIPTION: Crown Road North of Lot 2 DP 569979, Lot 82 DP 1118022 and Lot 1 DP 186022 approx. 4.82ha, as shown in red outline on the diagram below.
Classified Urban.

SCHEDULE 2

Roads Authority: Mid-Western Regional Council
DPE Ref: 23/04743

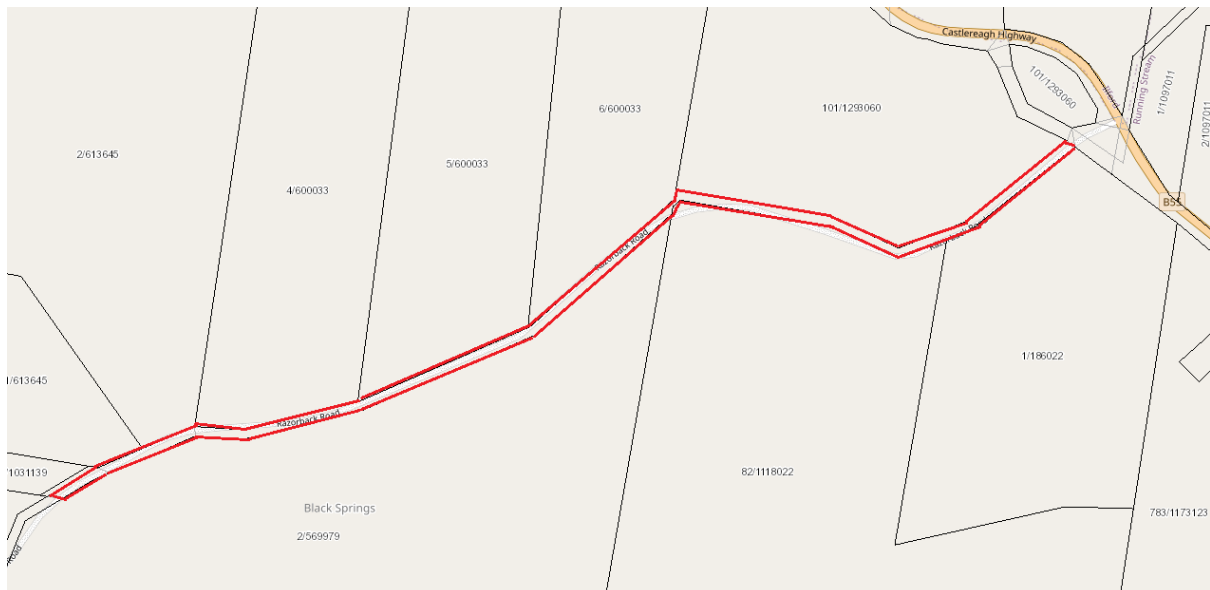

ROADS ACT 1993

ORDER

Transfer of Crown Road to a Council

In pursuance of the provisions of Section 152I of the *Roads Act 1993*, the Crown Road specified in Schedule 1 is transferred to the roads authority specified in Schedule 2 hereunder as from the date of publication of this notice and as from that date the road specified in Schedule 1 ceases to be a Crown road.

The Hon. Stephen Kamper MP
Minister for Lands and Property

SCHEDULE 1

Parish: Mudgee
County: Wellington
Land District: Mudgee
LGA: Mid-Western Regional Council

DESCRIPTION: Crown Road East of Lot 20 DP 1262637 and North of Lot 404 DP 756894 approx. 7081m², as shown in red outline on the diagram below.
Classified Urban.

SCHEDULE 2

Roads Authority: Mid-Western Regional Council
DPE Ref: 23/05134

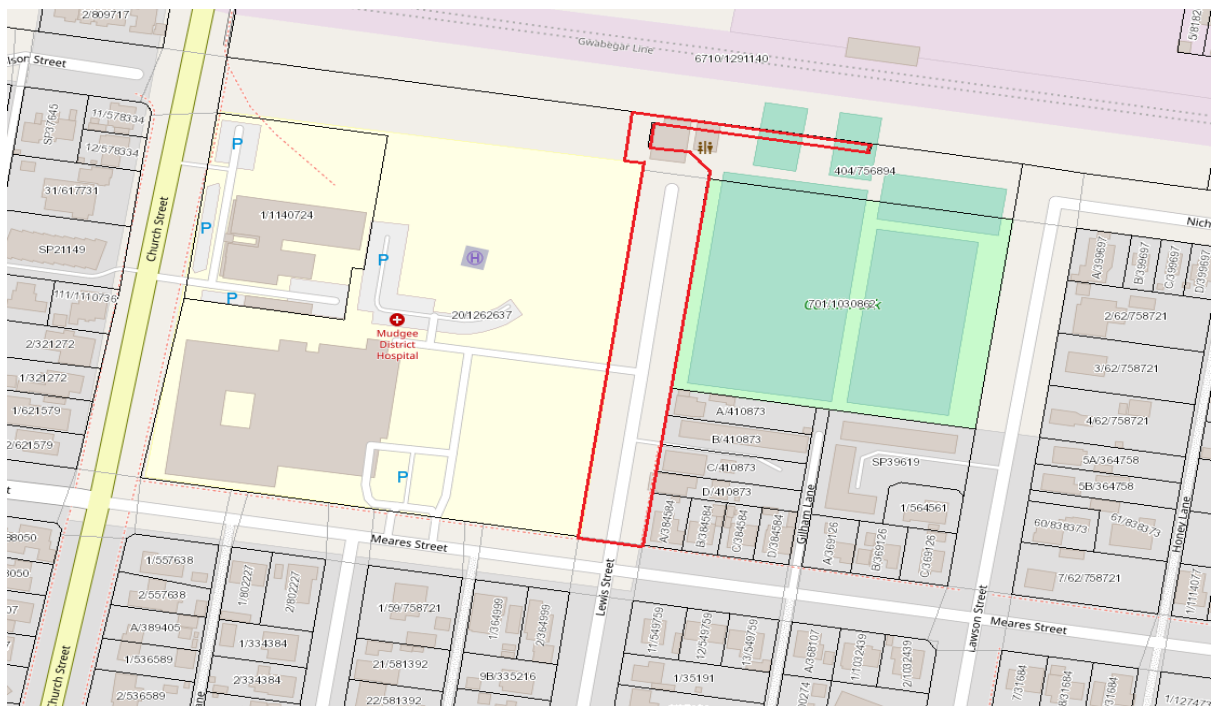

APPOINTMENT OF CROWN LAND MANAGER

Pursuant to clause 3.3 of Part 3 to the *Crown Land Management Act 2016*, the persons specified in Column 1 of the Schedule hereunder are appointed, for the terms of office specified in that Column, as Crown land manager of the land referred to in Column 2 of the Schedule.

It is a condition of the appointment that the employees, contractors, volunteers and board members of the appointed organisation specified in Column 1 must comply with the Department of Industry *Crown reserve code of conduct: for non-council Crown land managers and commons trusts* (as may be amended or replaced from time to time) when performing duties as Crown land manager.

The Hon. Steve Kamper, MP
Minister for Lands and Property

Schedule

Column 1	Column 2
Director General of Department of Primary Industries - Fisheries	Reserve No. 1040552 Public Purpose: Artificial Reef Notified: 28-Jul-2023
For a term commencing date of this notice.	Reserve No. 1040553 Public Purpose: Artificial Reef Notified: 28-Jul-2023
	File Reference: 22/02194#02

CROWN LAND MANAGEMENT ACT 2016
APPOINTMENT OF ADMINISTRATOR TO MANAGE CROWN LAND

Pursuant to Schedule 5, Section 29(1) of the *Crown Lands Management Act 2016*, the person specified in Column 1 of the Schedule hereunder is appointed as administrator for the term also specified in Column 1, of the Statutory Land Manager specified opposite thereto in Column 2, which is manager of the reserve referred to in Column 3 of the Schedule.

The Hon. Stephen Kamper MP
Minister for Lands and Property

	Schedule	
Column 1 Mr Simon Spicer	Column 2 Wentworth Park Sporting Complex Land Manager	Column 3 Reserve No. 500010 Purpose: Public Park Notified: 10-Nov-1885
For a term commencing 11-Oct-2023 and expiring 10-Oct-2024		Reserve No. 1002206 Purpose: Public Park Notified: 10-Nov-1885
		File Reference: APPTADMIN061/001

CROWN LAND MANAGEMENT ACT 2016
NOTICE - CROWN LAND TO BE USED OR OCCUPIED FOR OTHER PURPOSE UNDER S 2.18(2)(b)

Pursuant to section 2.18(2)(b) of the Crown Land Management Act 2016, the Crown land specified in Column 2 of the following Schedule is proposed to be used or occupied under a relevant interest granted for the purpose(s) specified in Column 1 of the following Schedule.

The Hon. Stephen Kamper MP
Minister for Lands and Property

Column 1

Jetty (relevant interest - Licence 637970)
Pontoon (relevant interest - Licence 637970)
Ramp (relevant interest - Licence 637970)

Schedule

Column 2

Reserve No. 56146
Public Purpose: Generally
Notified: 11-May-1923
File Reference: R56146/PURP720/001

Column 1

Jetty (relevant interest - Licence 637970)
Pontoon (relevant interest - Licence 637970)
Ramp (relevant interest - Licence 637970)

Schedule

Column 2

Reserve No. 1011268
Public Purpose: Future Public Requirements
Notified: 3-Feb-2006
File Reference: R1011268/PURP782/001

**CROWN LAND MANAGEMENT ACT 2016
RESERVE OF CROWN LAND**

Pursuant to section 2.8 of the *Crown Land Management Act 2016*, the Crown land specified in Column 1 of the following Schedule is reserved for the purpose(s) as specified opposite in Column 2 of the Schedule.

The Hon. Stephen Kamper, MP
Minister for Lands and Property

Schedule

Column 1

Land District: Taree
Local Government Area: Mid-Coast
Locality: Land below the mean high water mark near Forster being
Crown land depicted by co-ordinates on the diagram below

Column 2

Reserve No.1040553
Purpose: artificial reef

Parish Forster
County Gloucester

Area: Approx 358,646m²

File Reference: 22/02194#02

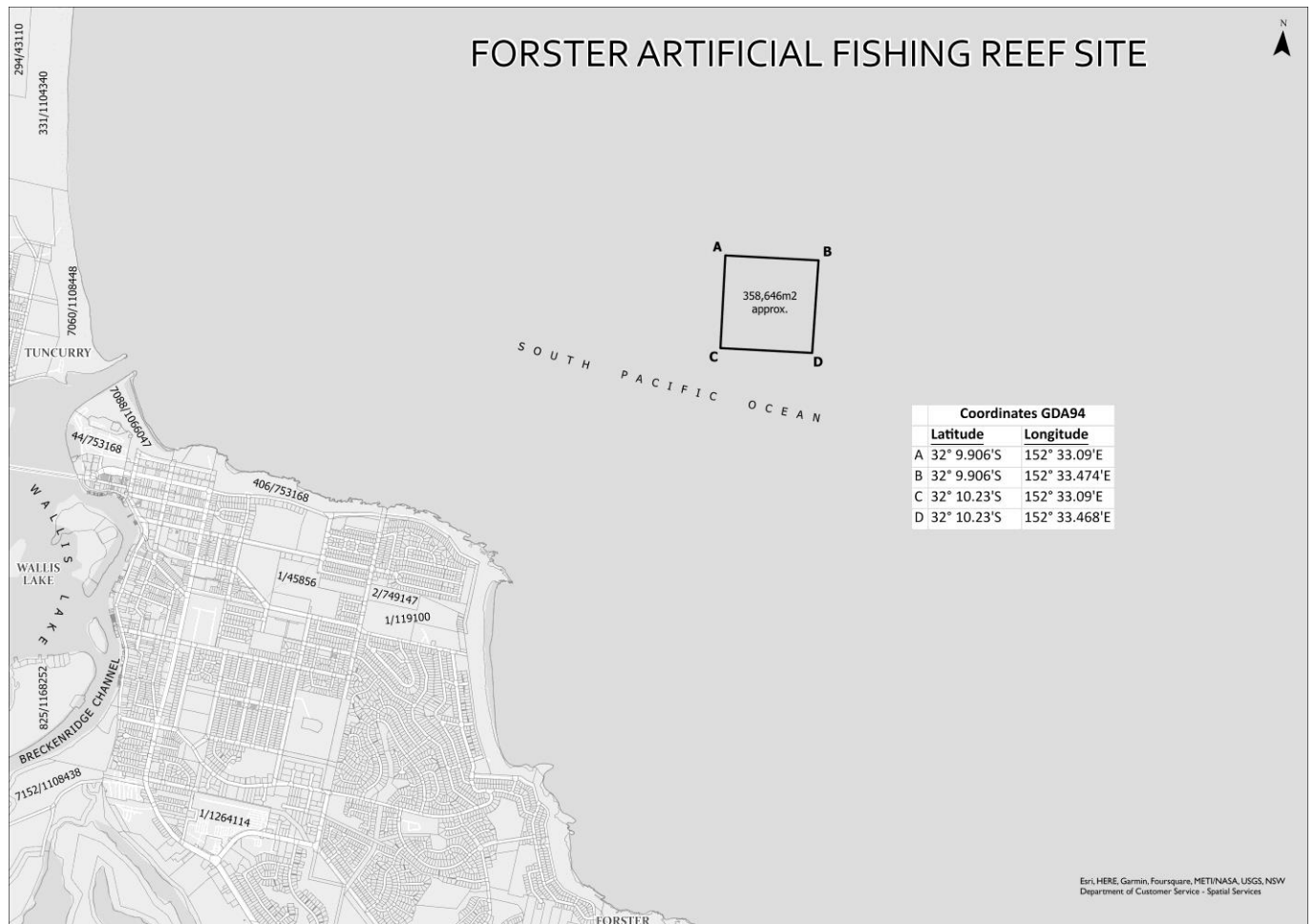

**CROWN LAND MANAGEMENT ACT 2016
RESERVE OF CROWN LAND**

Pursuant to section 2.8 of the *Crown Land Management Act 2016*, the Crown land specified in Column 1 of the following Schedule is reserved for the purpose(s) as specified opposite in Column 2 of the Schedule.

The Hon. Stephen Kamper, MP
Minister for Lands and Property

Schedule

Column 1

Land District: Gosford
Local Government Area: Central Coast
Locality: Land below the mean high water mark near Terrigal being
Crown land depicted by co-ordinates on the diagram below

Column 2

Reserve No.1040552
Purpose: artificial reef

Parish Kincumber
County Northumberland

Area: Approx 365,302m²

File Reference: 22/02194#02

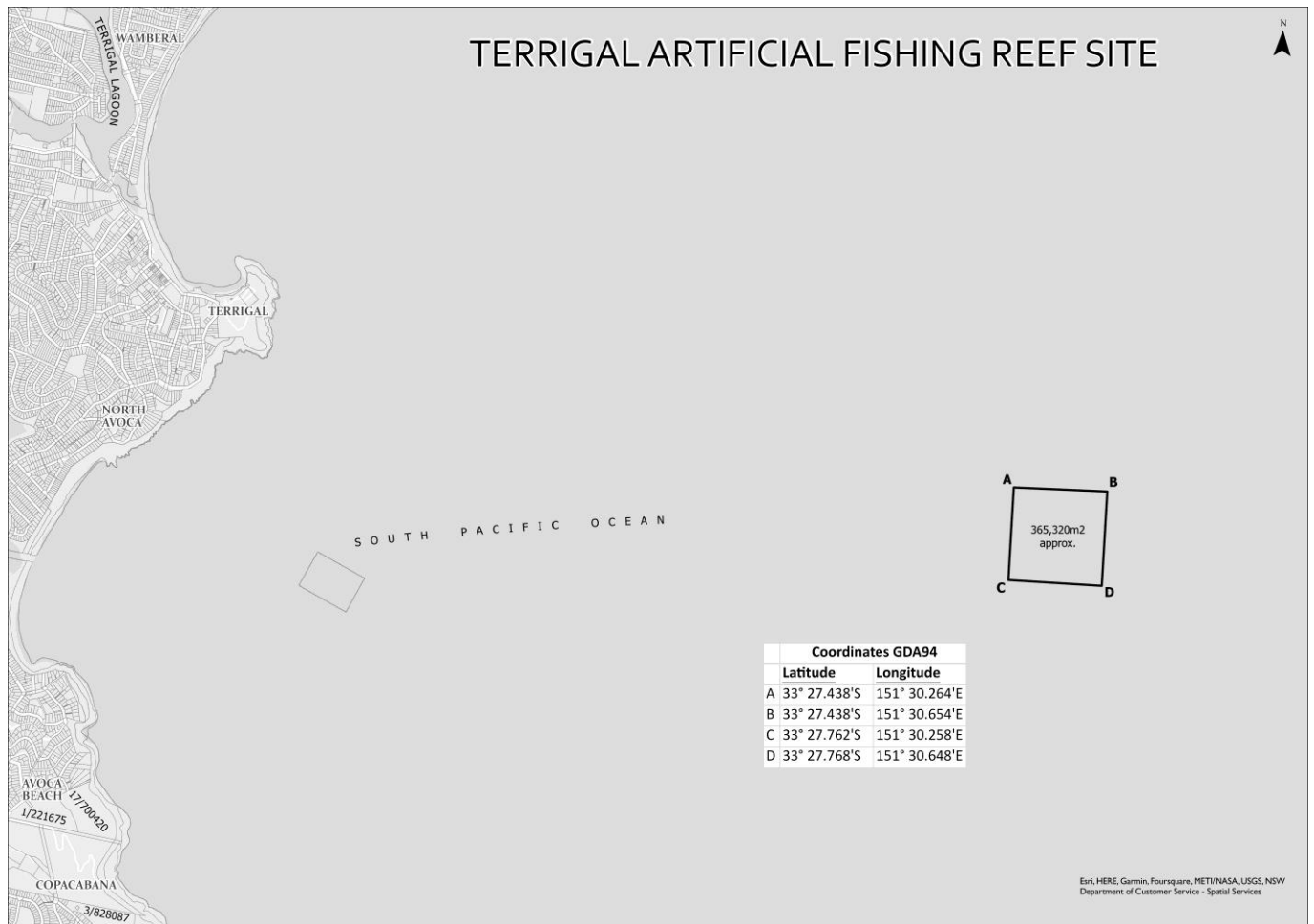

CROWN LAND MANAGEMENT ACT 2016
APPOINTMENT OF STATUTORY LAND MANAGER BOARD MEMBERS

Pursuant to clause 4(1) of Schedule 5 to the *Crown Land Management Act 2016*, the persons specified in Column 1 of the Schedule hereunder are appointed, for the terms of office specified in that Column, as board members for the statutory land manager specified opposite in Column 2, which has been appointed as Crown land manager of the land referred to in Column 3 of the Schedule. It is a condition of the appointment that the board member must comply with the Department of Planning and Environment - Crown Lands *Crown reserve code of conduct: For non-council Crown land managers and commons trusts* (as may be amended or replaced from time to time).

The Hon. Stephen Kamper MP
Minister for Lands and Property

<hr/> Schedule <hr/>		
Column 1	Column 2	Column 3
Mrs Megan Elizabeth Cross	Eumungerie Recreation Reserve Land Manager	Reserve No. 47512 Purpose: Public Recreation Notified: 21-Feb-1912
Mr Darrel Joseph Raines		File Reference: SLM/APP753/001
Mr James Victor Kelly		
For a term commencing 5-Sep-2023 and expiring 04-Sep-2028		

CROWN LAND MANAGEMENT ACT 2016
APPOINTMENT OF STATUTORY LAND MANAGER BOARD MEMBERS

Pursuant to clause 4(1) of Schedule 5 to the *Crown Land Management Act 2016*, the persons specified in Column 1 of the Schedule hereunder are appointed, for the terms of office specified in that Column, as board members for the statutory land manager specified opposite in Column 2, which has been appointed as Crown land manager of the land referred to in Column 3 of the Schedule. It is a condition of the appointment that the board member must comply with the Department of Planning and Environment - Crown Lands *Crown reserve code of conduct: For non-council Crown land managers and commons trusts* (as may be amended or replaced from time to time).

The Hon. Stephen Kamper MP
Minister for Lands and Property

<hr/> Schedule <hr/>		
Column 1	Column 2	Column 3
Mrs Heather Elizabeth Cole	Moonbi Recreation Hall Land Manager	Reserve No. 81418 Purpose: Public Hall Public Recreation Notified: 27-Feb-1959
Mr Richard Cole		File Reference: SLM/APP711/001
Mrs Maureen Dora Jackson		
Mr Field Marshall Jackson		
Ms Yasmin Narelle Guymer		
For a term commencing date of this notice and expiring 3-Aug-2028		

CROWN LAND MANAGEMENT ACT 2016
APPOINTMENT OF STATUTORY LAND MANAGER BOARD MEMBERS

Pursuant to clause 4(1) of Schedule 5 to the *Crown Land Management Act 2016*, the persons specified in Column 1 of the Schedule hereunder are appointed, for the terms of office specified in that Column, as board members for the statutory land manager specified opposite in Column 2, which has been appointed as Crown land manager of the land referred to in Column 3 of the Schedule. It is a condition of the appointment that the board member must comply with the Department of Planning and Environment - Crown Lands *Crown reserve code of conduct: For non-council Crown land managers and commons trusts* (as may be amended or replaced from time to time).

The Hon. Stephen Kamper MP
Minister for Lands and Property

<hr/> Schedule <hr/>		
Column 1	Column 2	Column 3
Mr Michael Karl Fiedler (re-appointment)	Tathra Forest Wildlife Reserve Land Manager	Reserve No. 180014 Purpose: Promotion Of The Study And Conservation Of Native Flora And Fauna Notified: 10-Apr-1987
Mr David McCreery (re-appointment)		
Mr Bruce Alexander Hamilton (re-appointment)		
		File Reference: SLM/APP742/001
For a term commencing 30-Aug-2023 and expiring 29-Aug-2028		
